

PLANS AND SPECIFICATIONS  
 NO. 862-B  
 TO ESTABLISH GRABES  
 IN KAWERS AVENUE  
 BETWEEN 10th AND 11th STREETS  
 CITY OF ALBANY  
 ALBANY, N.Y.  
 DEPT. OF PUBLIC WORKS  
 1917

*M. J. Quinn*  
 ENGINEER  
 277 BROADWAY

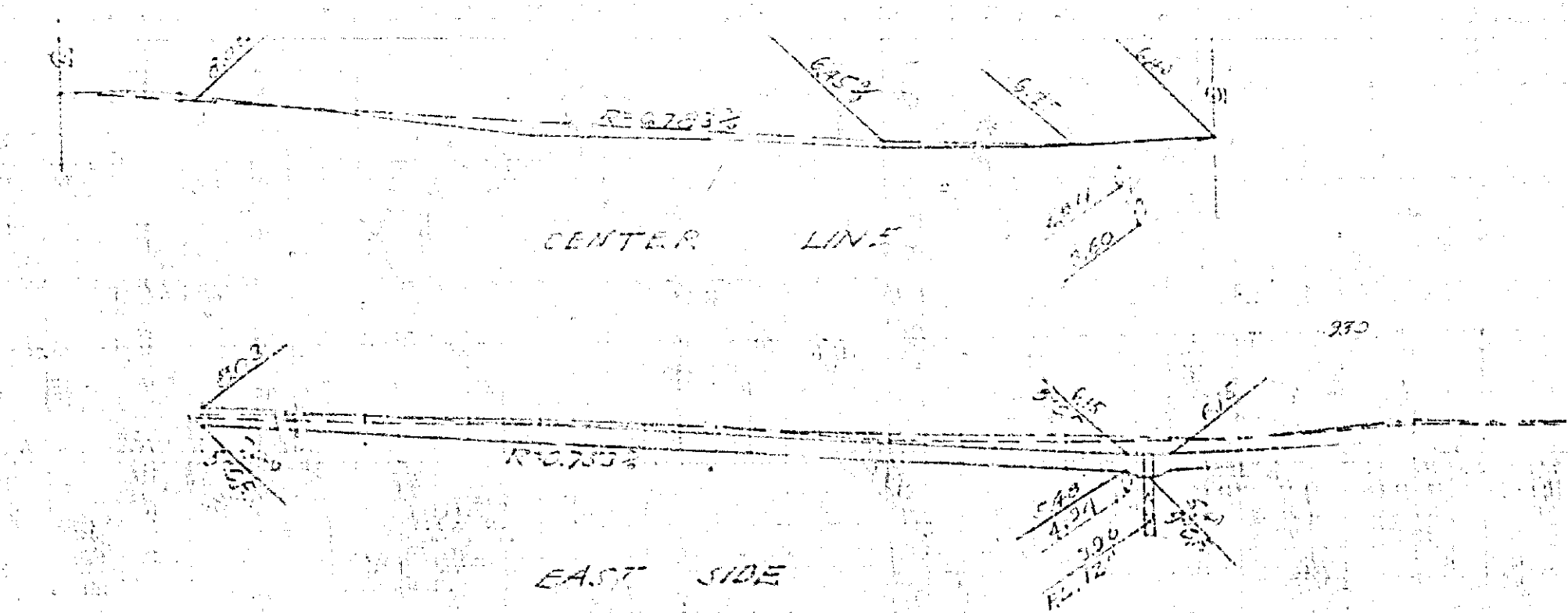
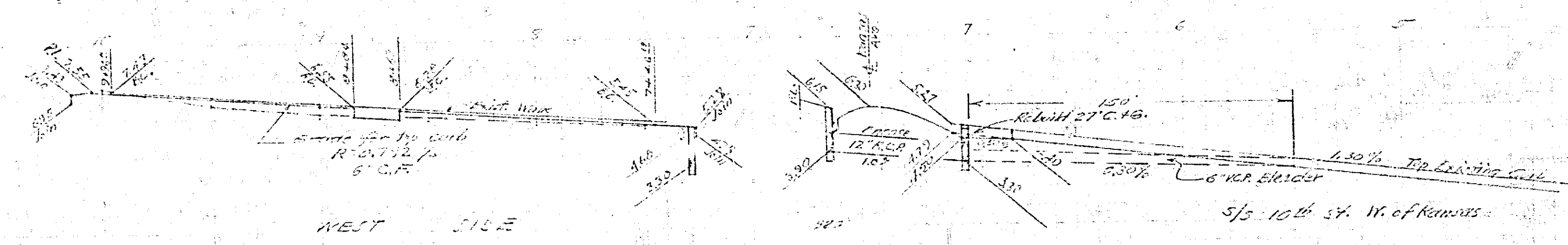

Drawings Estimate

Removal 30'-8" 18"-1 1/2" pipe	@ 12	=	360
" 27' 6" 12" C.C.P.	@ 100	=	2700
Conct. 2' 3/4" C.C.P.	@ 75	=	150
" 60'-12" R.C.P.	@ 4	=	240
" 150'-6" R.C.P.	@ 12	=	1800
" 27' 6" Concl. C.C.P.	@ 15	=	405
" 15' " " "	@ 15	=	225
		Total	7005
Plus labor & profit			500
			7505

862B