

# MAP SHOWING PROPOSED LIGHTING SYSTEM FOR NEW MAGNOLIA AVENUE & TERRACINA DRIVE

A. P. CAMPBELL CITY ENGINEER 1926.

SCALE  
1 INCH = 200 FEET

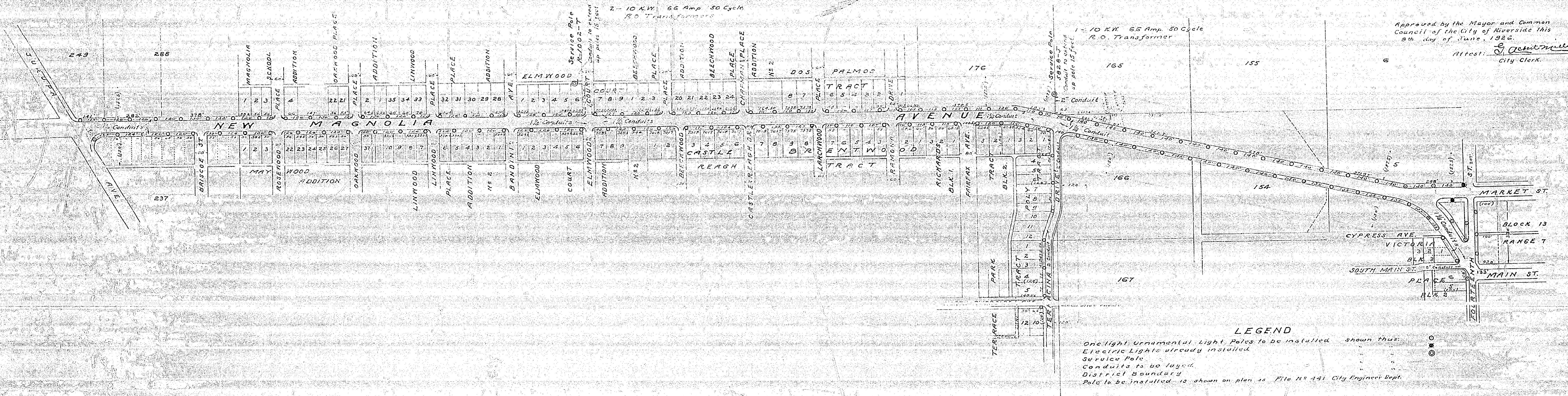

2 - 10 KW. 66 Amp. 50 Cycle  
R.O. Transformer

1 - 10 KW. 66 Amp. 50 Cycle  
R.O. Transformer

Approved by the Mayor and Common  
Council of the City of Riverside this  
8th day of June, 1926.  
Attest: *S. O'Connell*  
City Clerk.

### LEGEND

- One light ornamental Light Poles to be installed shown thus: ○
- Electric Lights already installed shown thus: ●
- Service Pole shown thus: ○
- Conduits to be laid shown thus: —
- District Boundary shown thus: - - -
- Pole to be installed is shown on plan as File No. 441 City Engineer Dept.

869