

MAP OF PROPOSED IMPROVEMENT ON
MARLBOROUGH AVE. & THIRTY FOOT ST.
A.P. CAMPBELL, CITY ENGINEER, 1926.

SCALE
1 INCH = 50 FEET

Approved by the Mayor and Common
Council of the City of Riverside this
22nd day of June, 1926.
Attest: *[Signature]*
City Clerk.

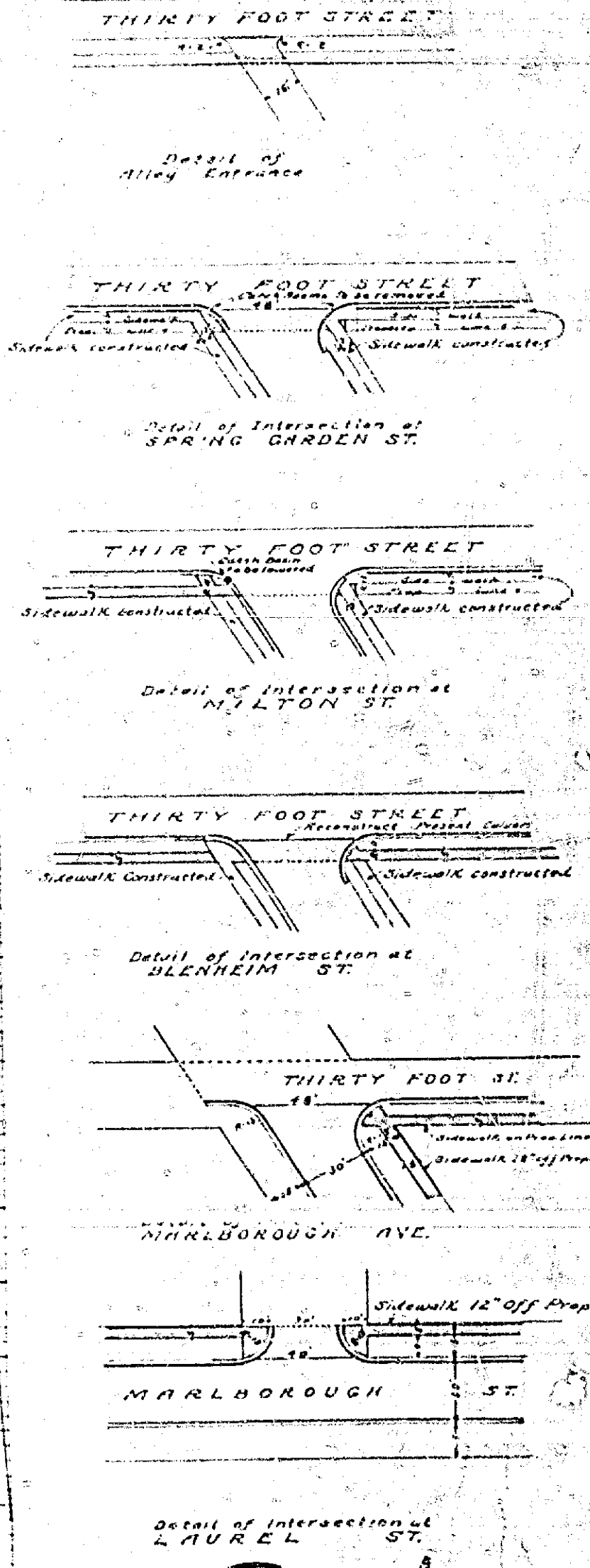
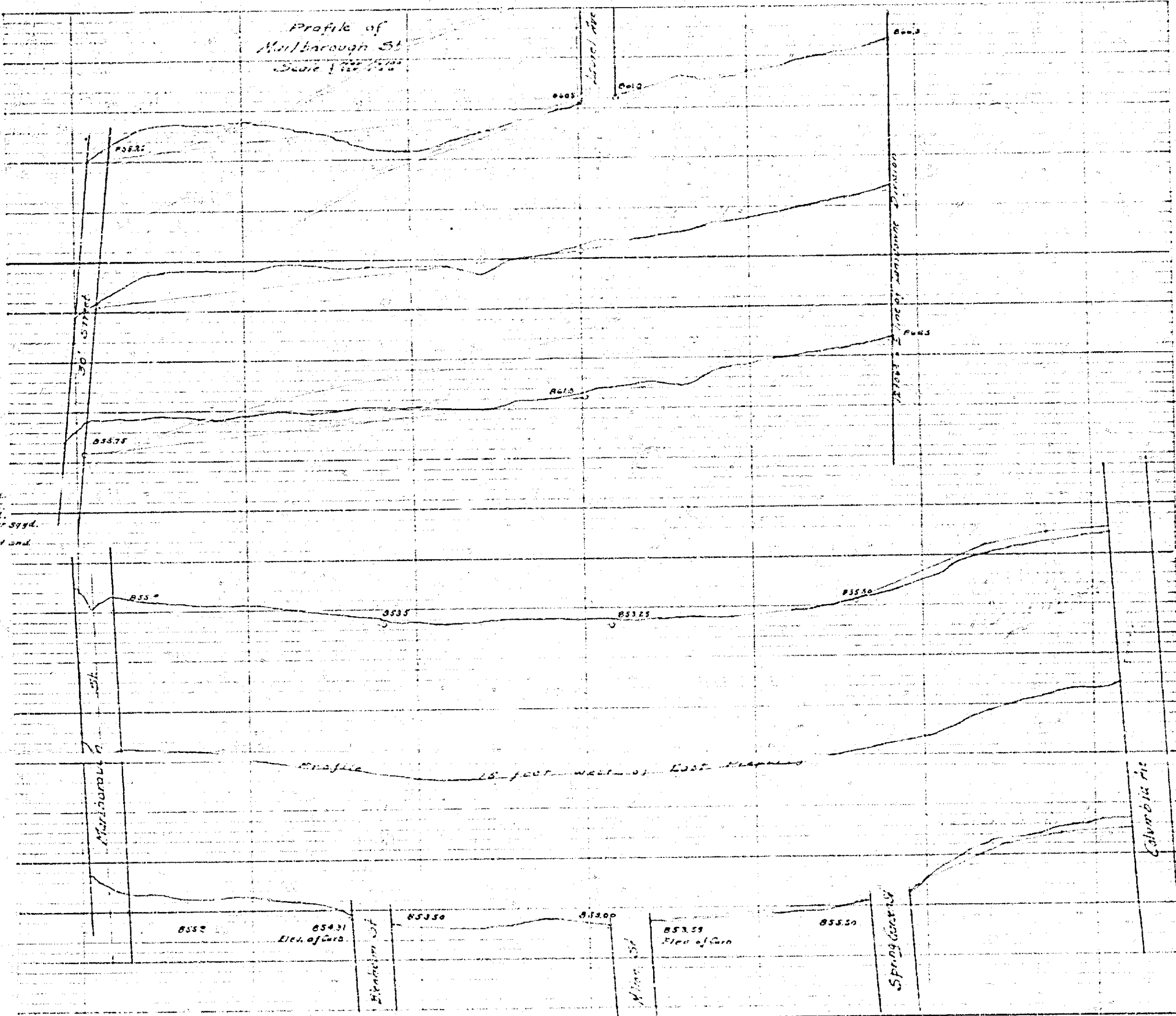
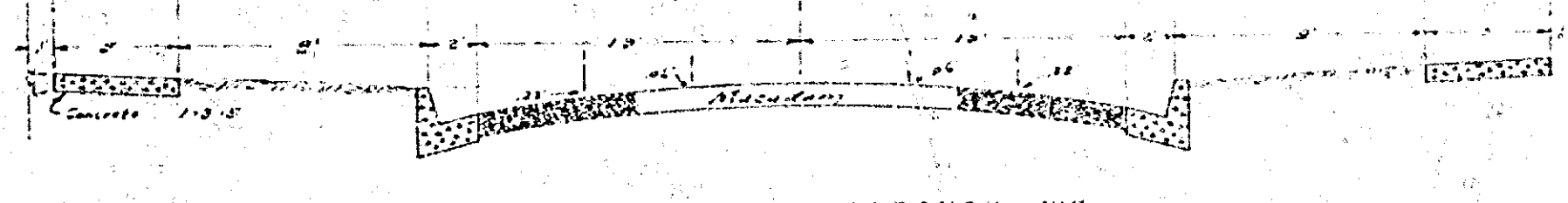
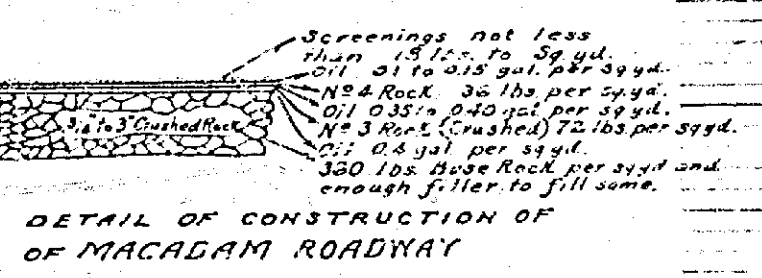
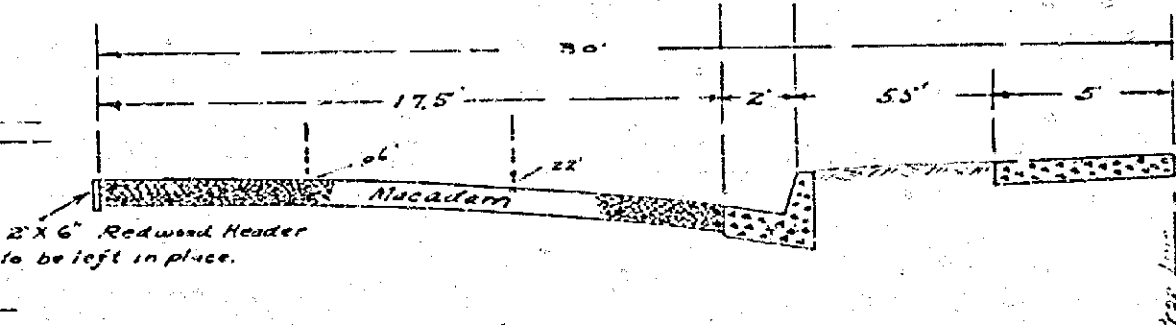
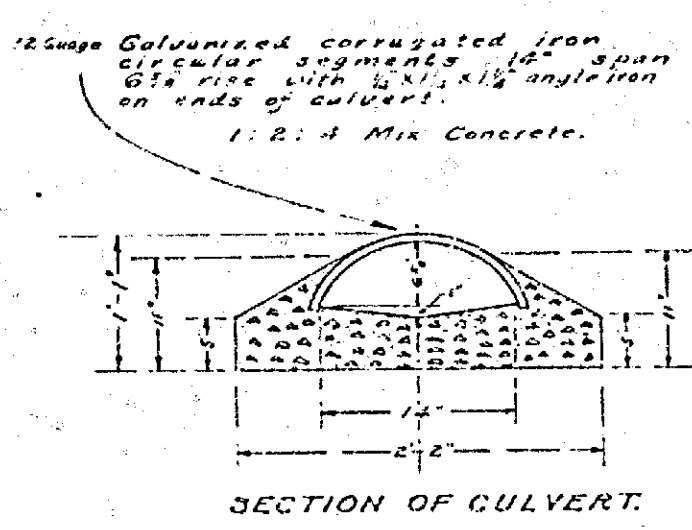
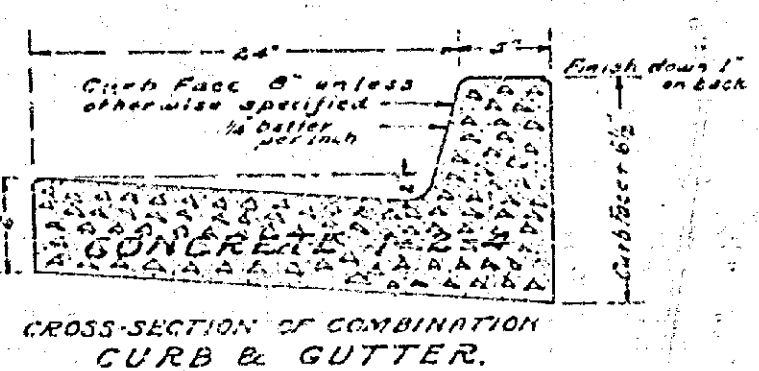
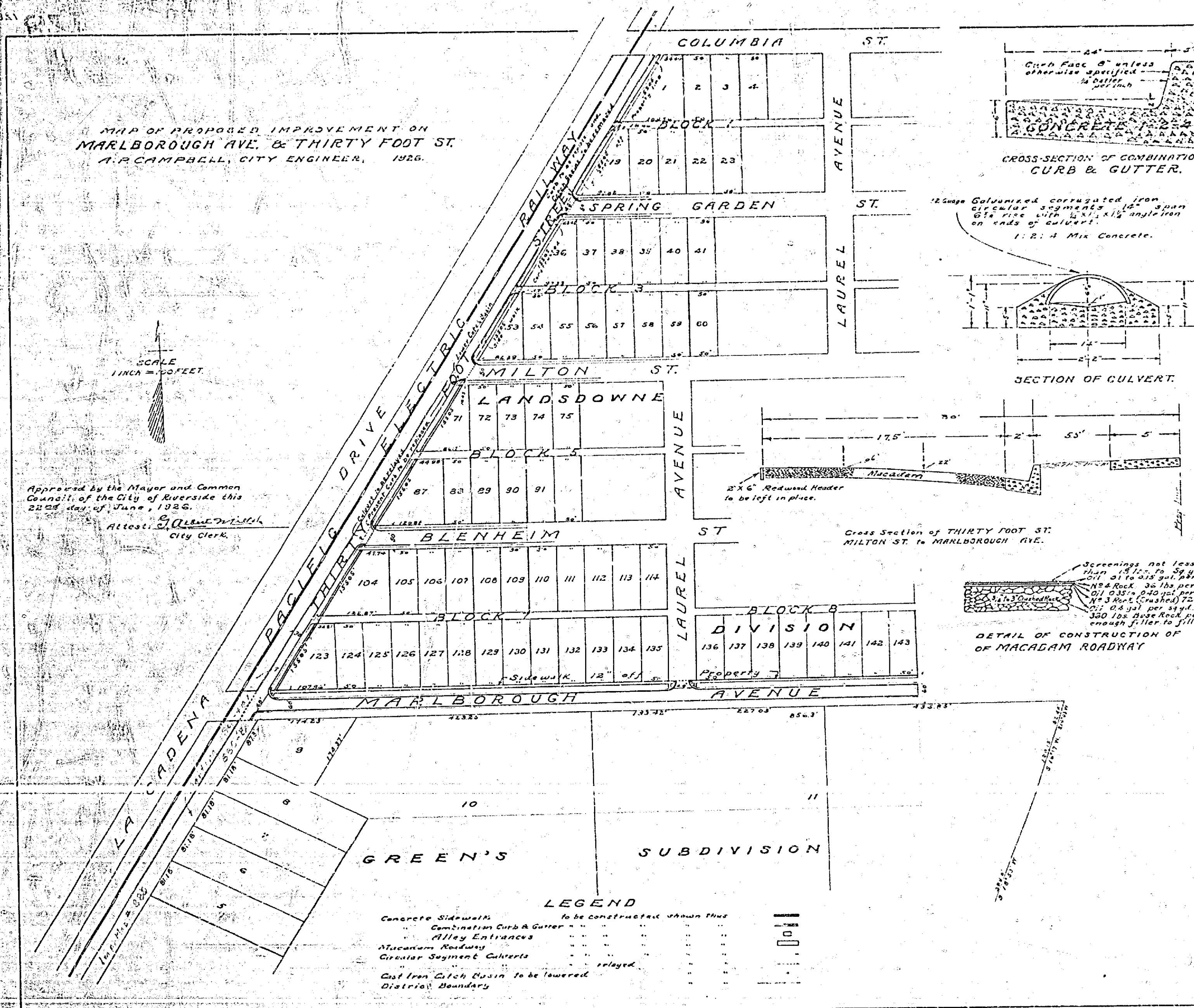

871