

27

11

11

58

8.5"

11"

17"

22"

55

11

11

82

28

11

11

55

Map No. 879

# MAP OF PROPOSED IMPROVEMENT ON BEATTY DRIVE

A. R. CAMPBELL, CITY ENGINEER 1926

Approved by the Mayor and Common Council this 4th day of November 1926  
Attest: G. O. [Signature]  
City Clerk

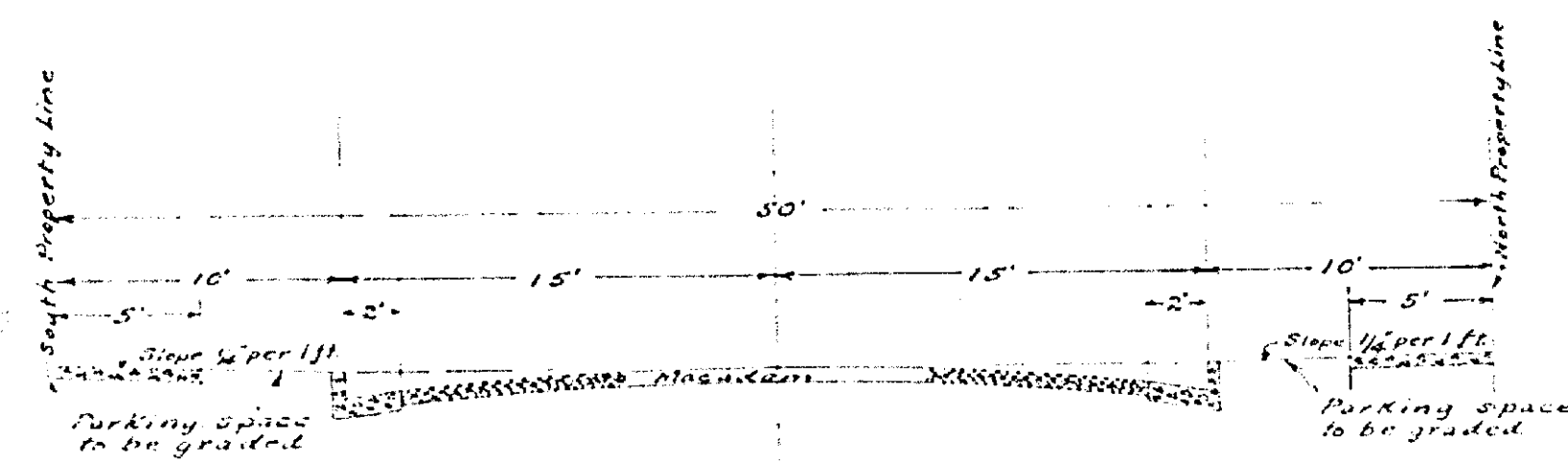

CROSS-SECTION OF STREET

SCALE - 1 INCH = 100 FEET

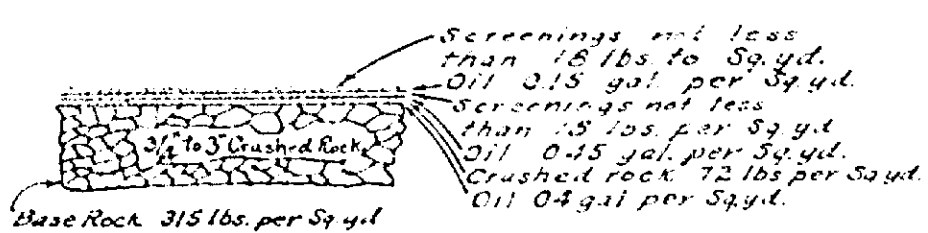

DETAIL OF CONSTRUCTION OF MACADAM ROADWAY

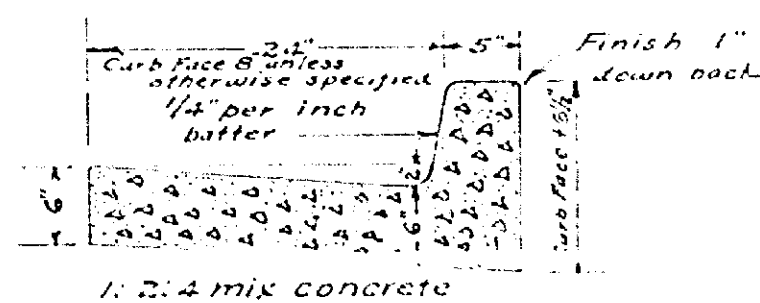

SECTION OF COMBINATION CURB AND GUTTER

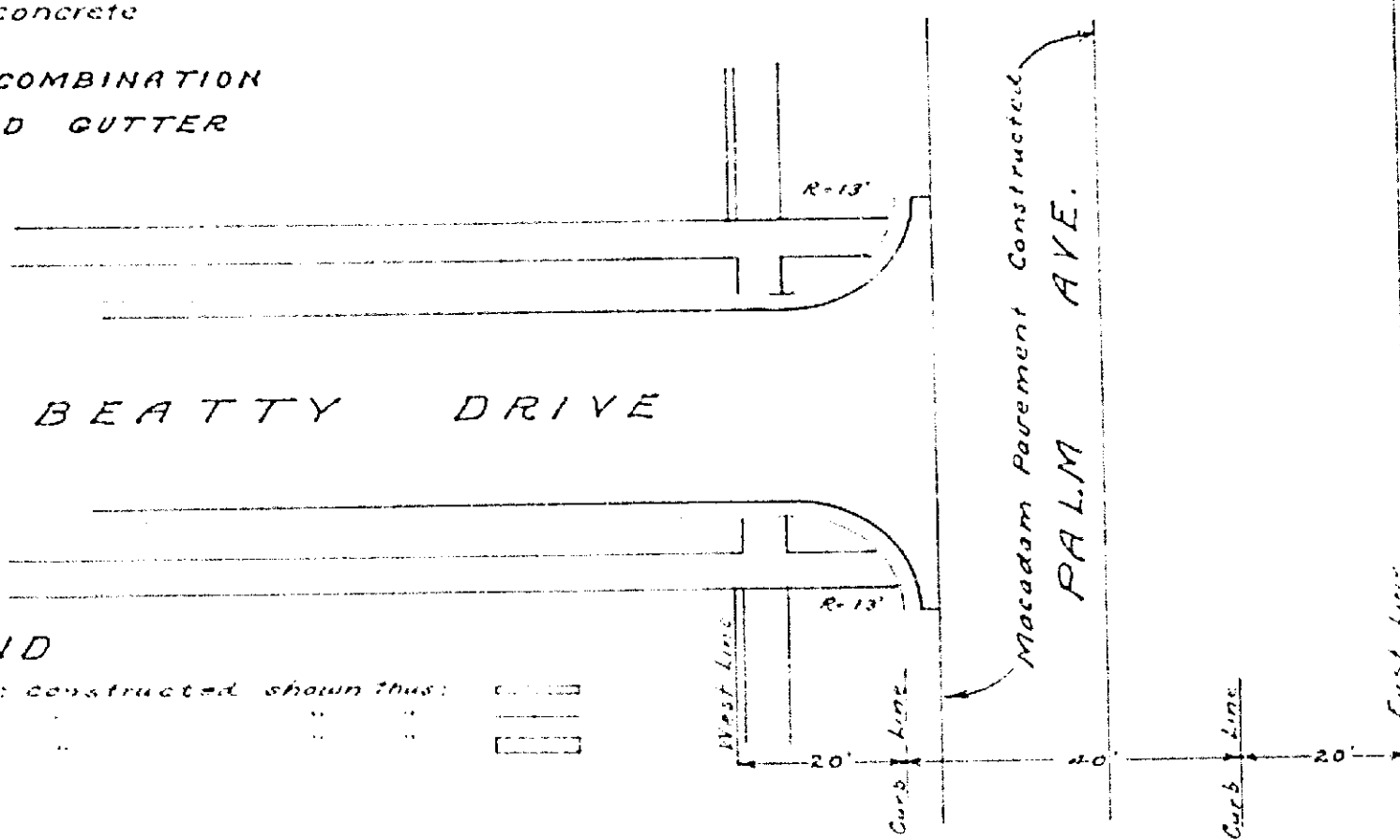

DETAIL OF INTERSECTION AT PALM AVENUE

LEGEND  
Sidewalk  
Combination Curb and Gutter  
Macadam Pavement

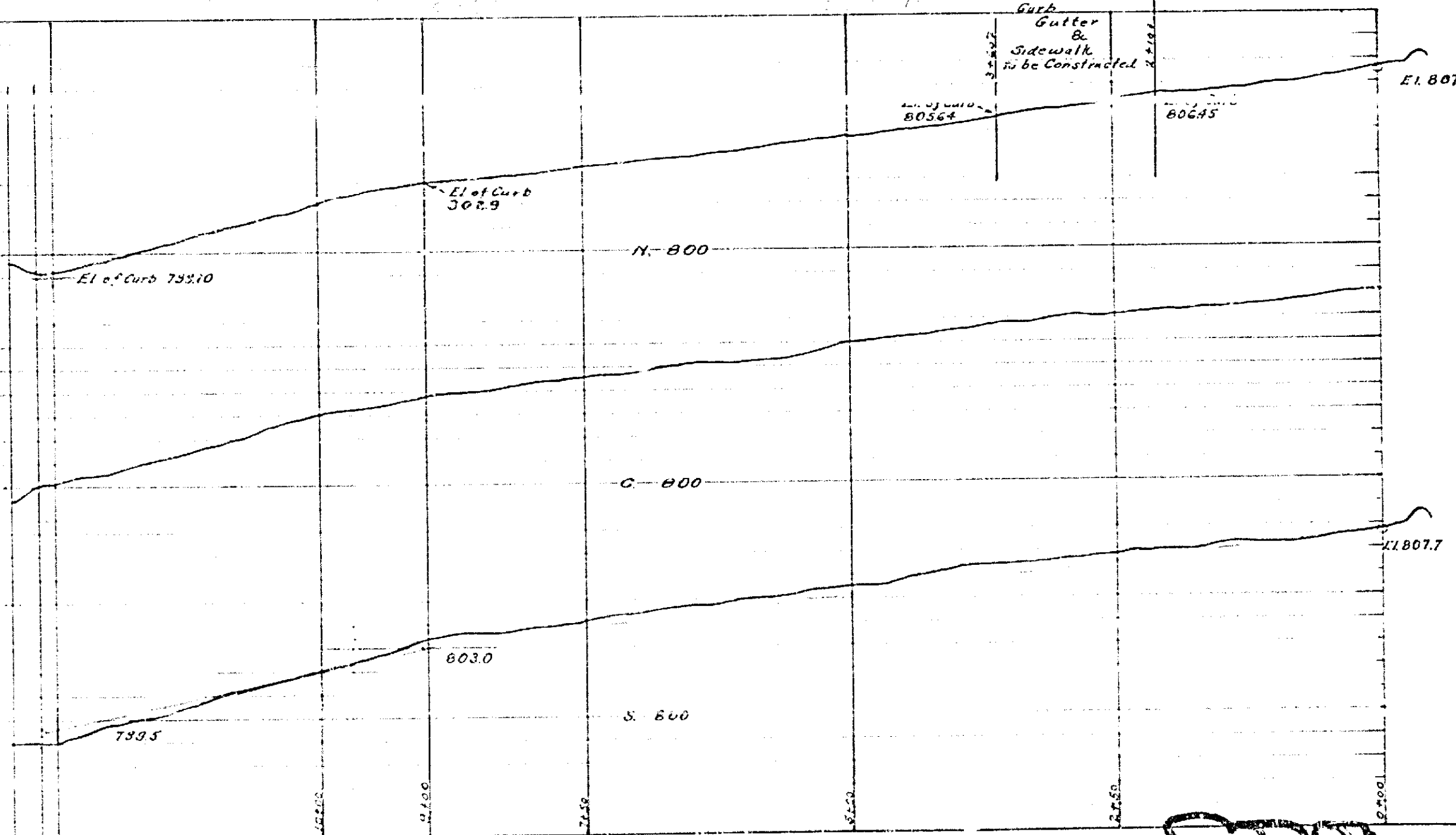
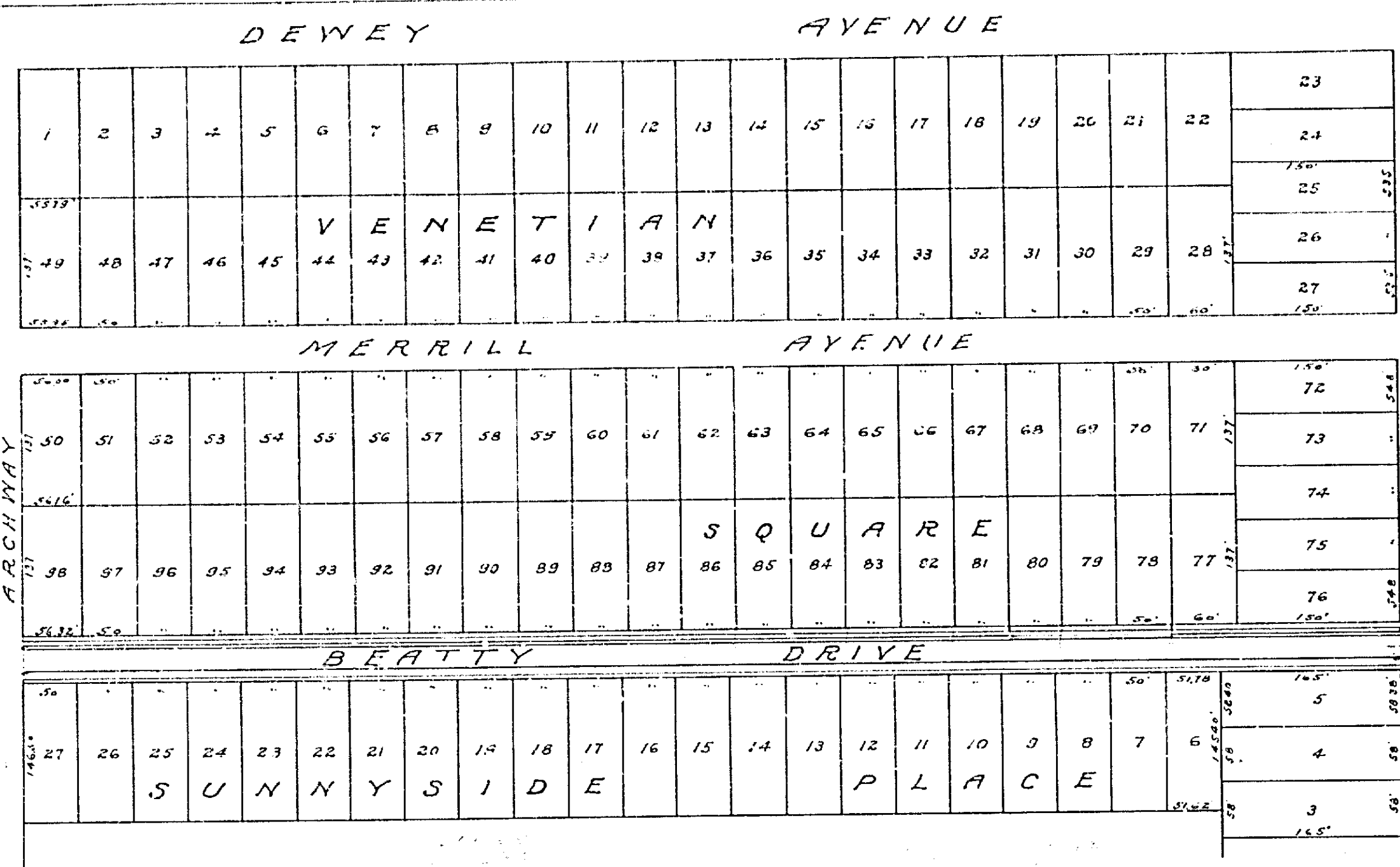

879

Map No. 879