

MAP OF PROPOSED IMPROVEMENT
 SOUTH BROCKTON AVENUE & STEWART DRIVE
 FROM JURUPA AVE. TO ARLINGTON AVE., FROM BROCKTON TO PALM AVE.
 H. P. CAMPBELL 1927. CITY ENGINEER.

MAP NO. 420
 SHEET NO. 1

LEGEND
 Asphaltic Concrete pavement
 Combination Curb & Gutter
 Concrete Sidewalk
 Driveway & Alley entrances
 Dips for drainage
 Curb in place
 Curb to be constructed
 Catch Basins
 District Resisted

Adopted by the Mayor and Common Council of the City of Brockton, Mass. on the 20th day of April, 1927.
 H. P. CAMPBELL
 Clerk of the City of Brockton.

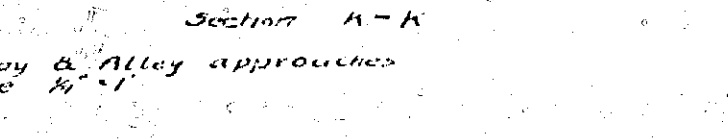
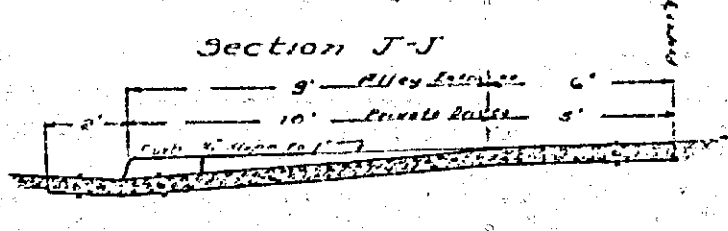
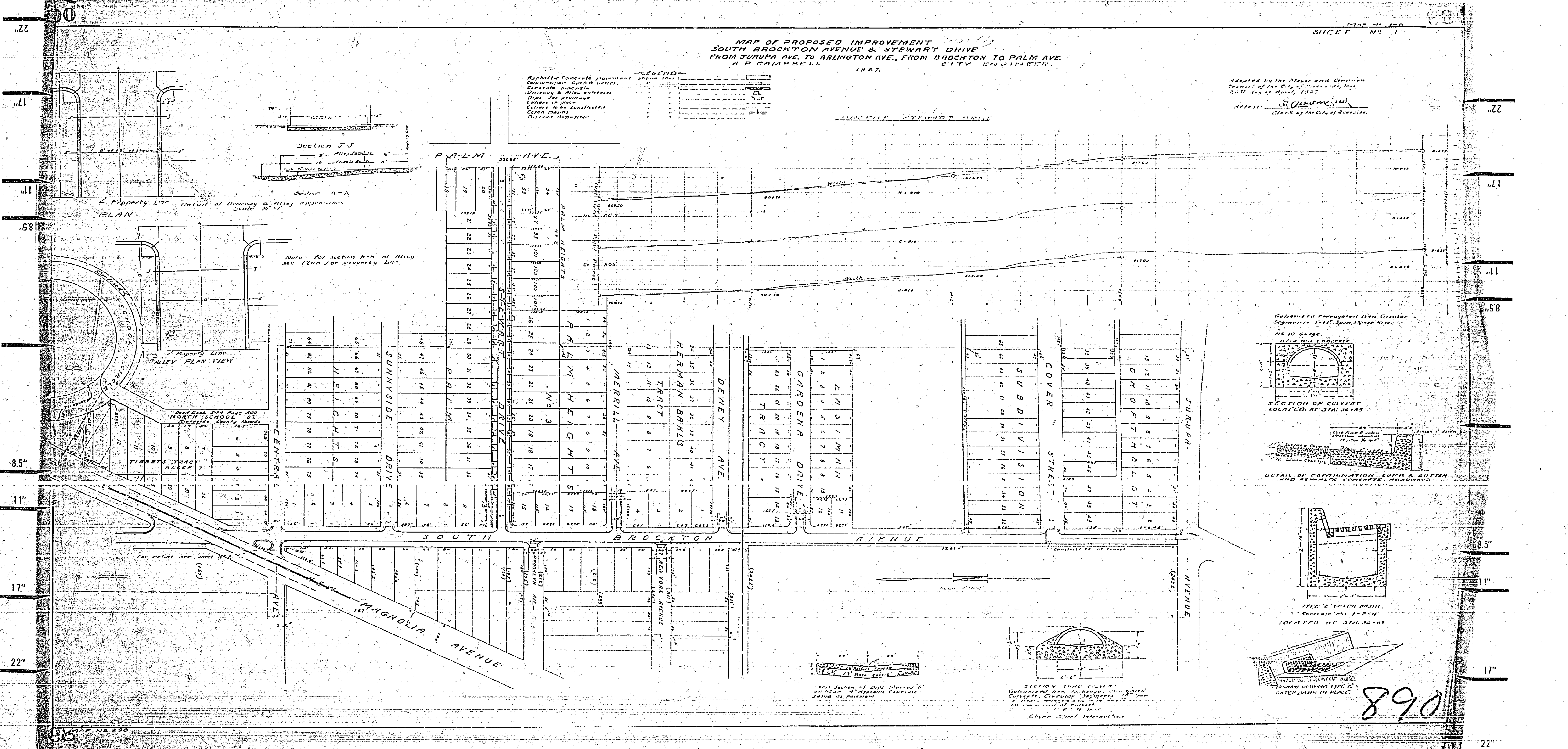

Note: For section A-K of Alley see plan for property line

Note: For section A-K of Alley see plan for property line

Submerged through-flow Circular Segment - 12ft. Span, 3 ft. Rise

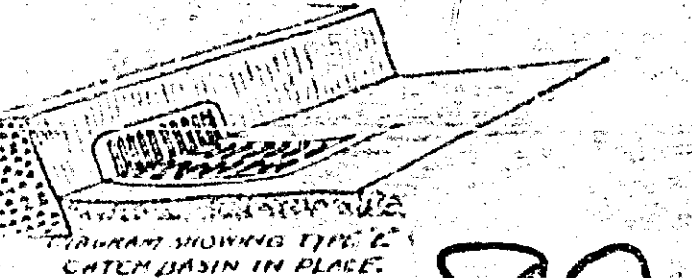
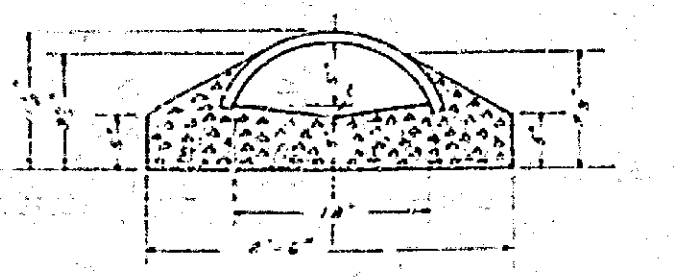
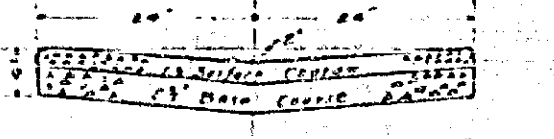
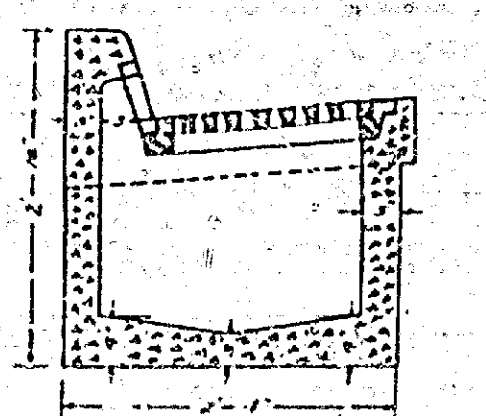
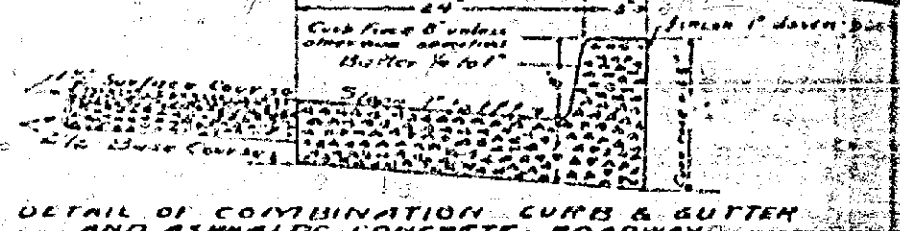
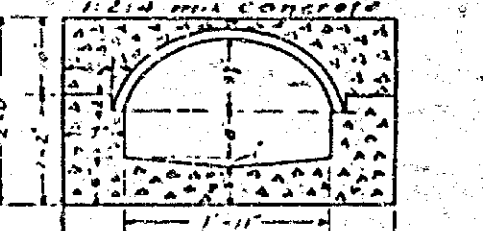

890

MAP 6530

SHEET NO. 2

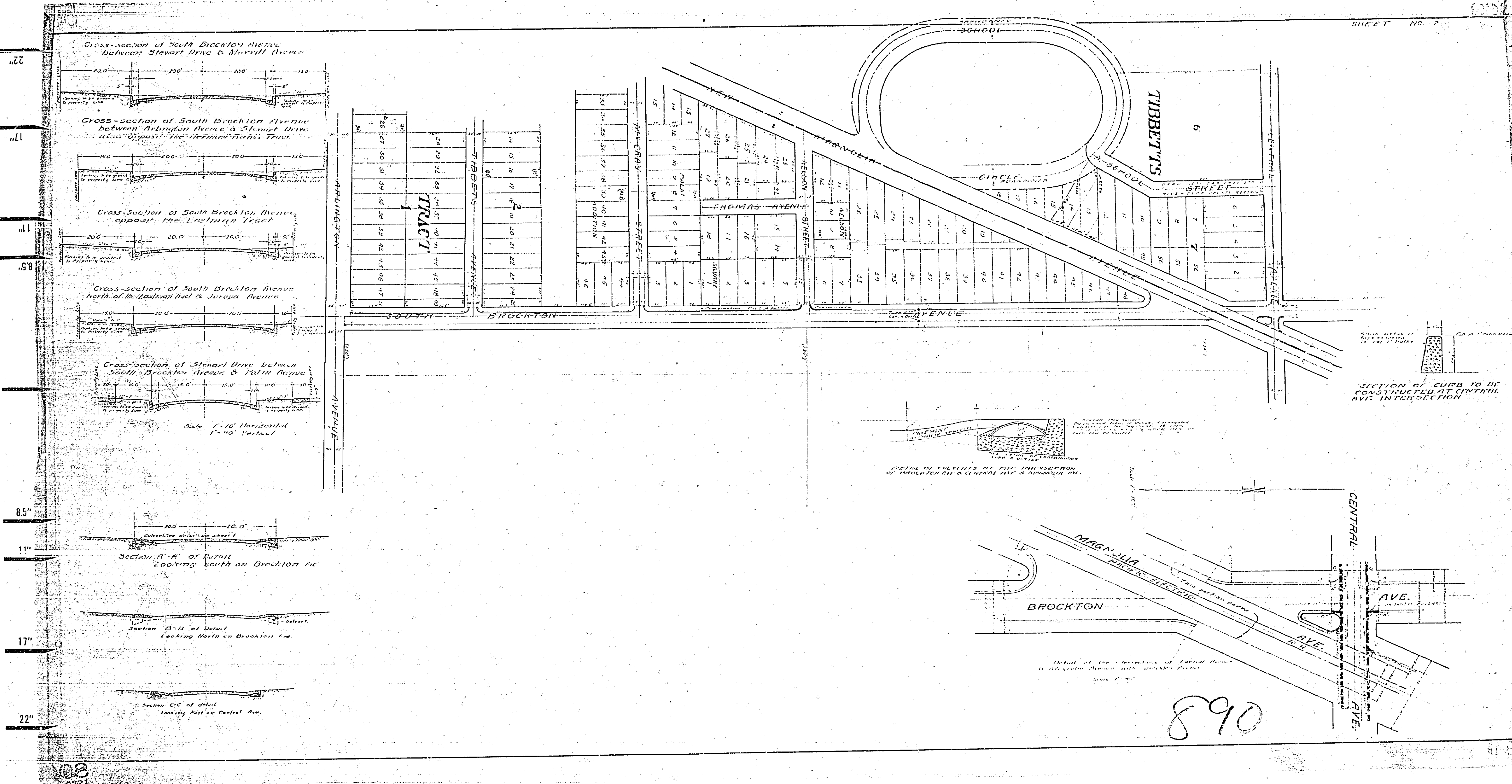

22"

22"

11"

11"

11"

11"

5.8"

5.8"

8.5"

8.5"

11"

11"

17"

17"

22"

22"

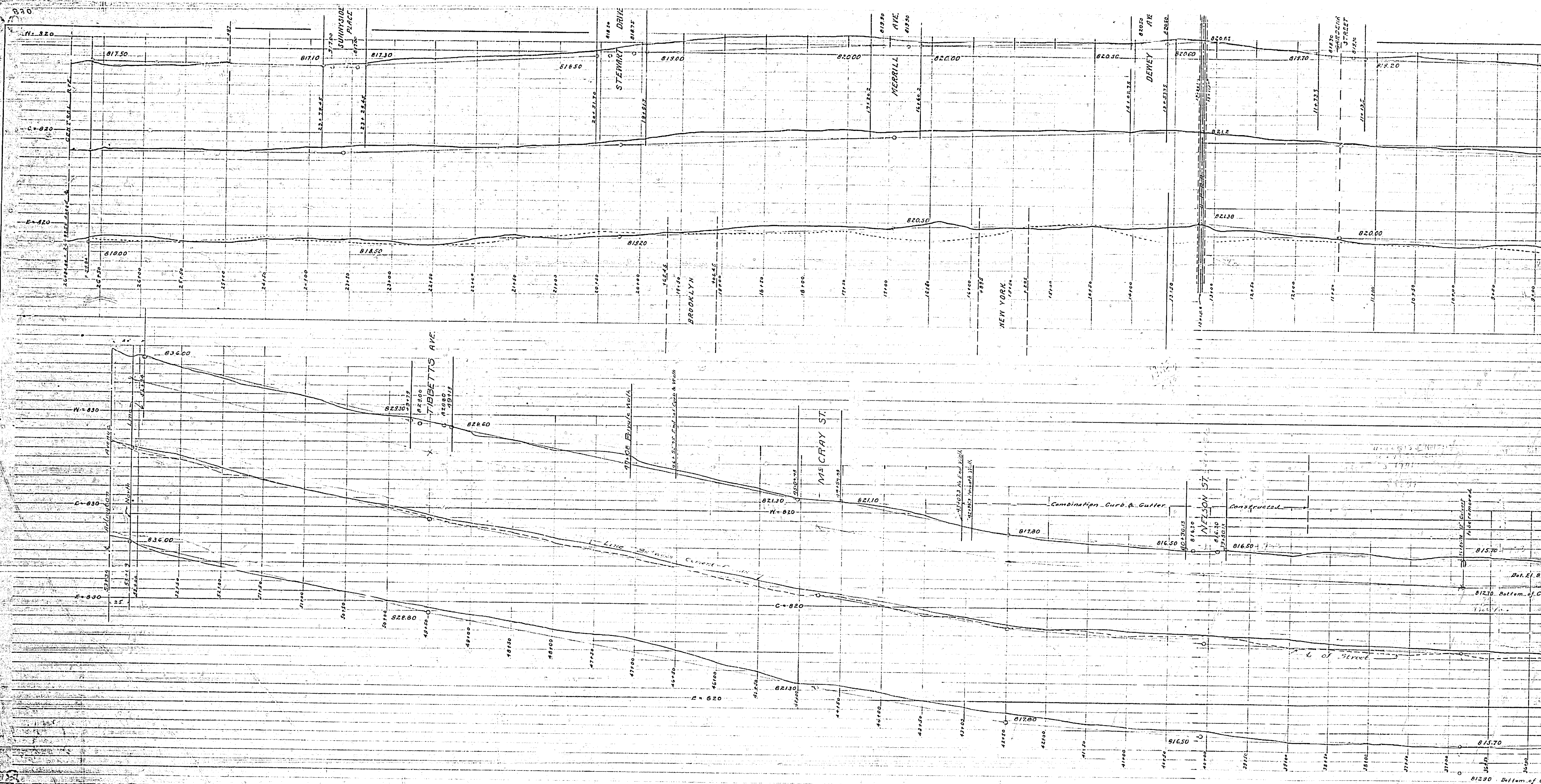

MAP NO. 890 SHEET NO. 3

Bot. E. 814.57
 812.10 Bottom of Culvert
 813.90 Bottom of Culvert

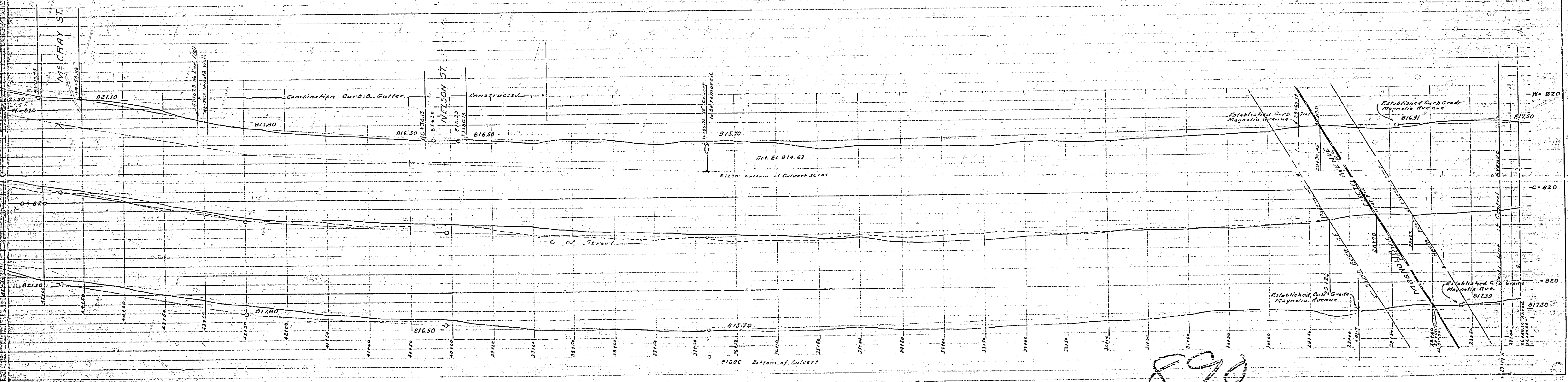
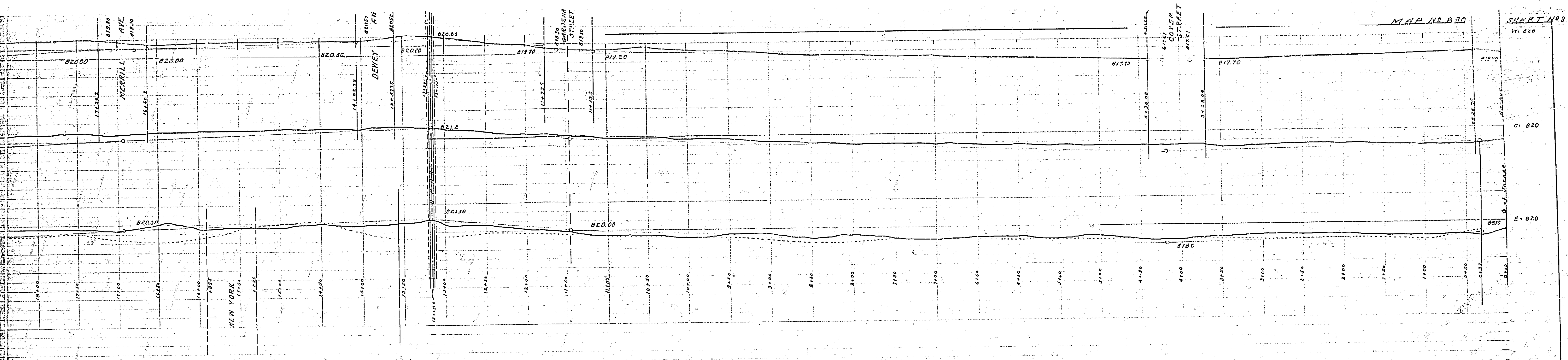

MAP NO B20

SHEET NO 3

77

71

71

85

85

11

17

22