

PLAN & PROFILE
 NO. 9
 PROPOSED DRAIN
 ON SCHOOL EASEMENT
 BETWEEN
 MISSION STREET & GARFIELD STREET
 CITY OF RIVERSIDE, CALIFORNIA
 NOVEMBER 1949
 FB 367 PG. 77

APPROVED *M.H. Irvine*
 M.H. IRVINE REG. C.E. NO. 3011
 CITY ENGINEER

PLAN
 SCALE: 1 IN. = 40 FT.

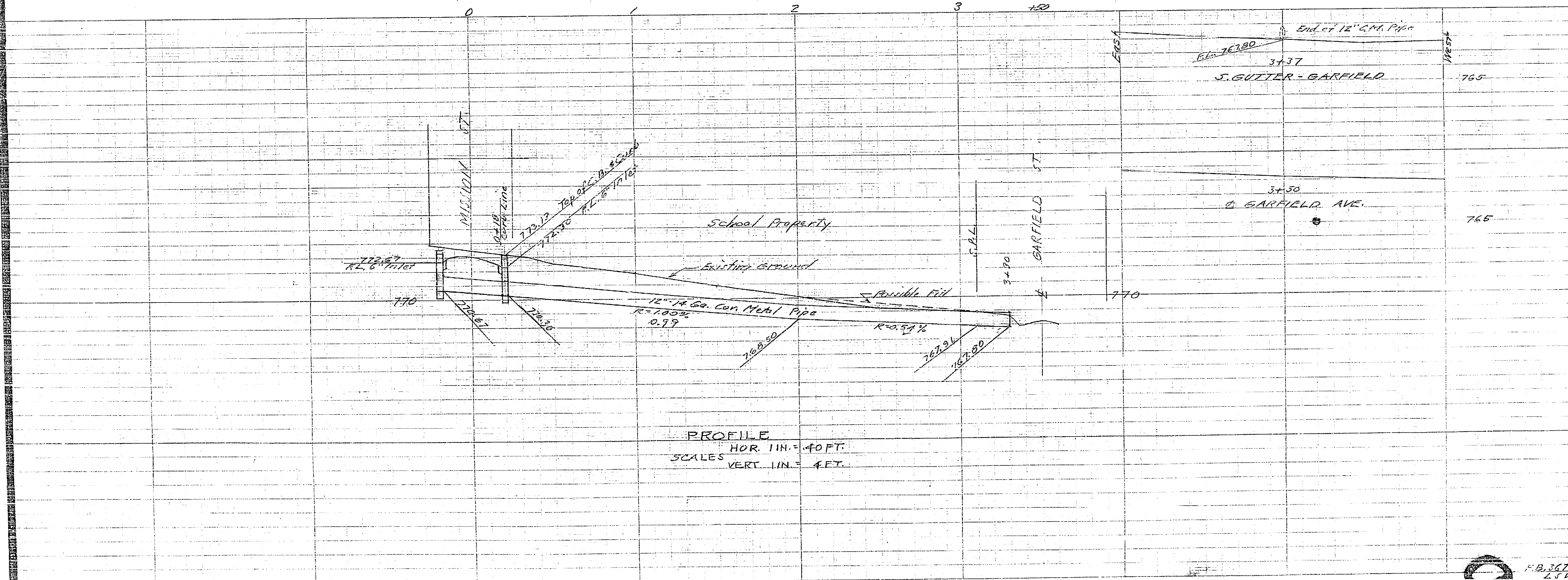

PROFILE
 HOR. 1 IN. = 40 FT.
 VERT. 1 IN. = 4 FT.

9