

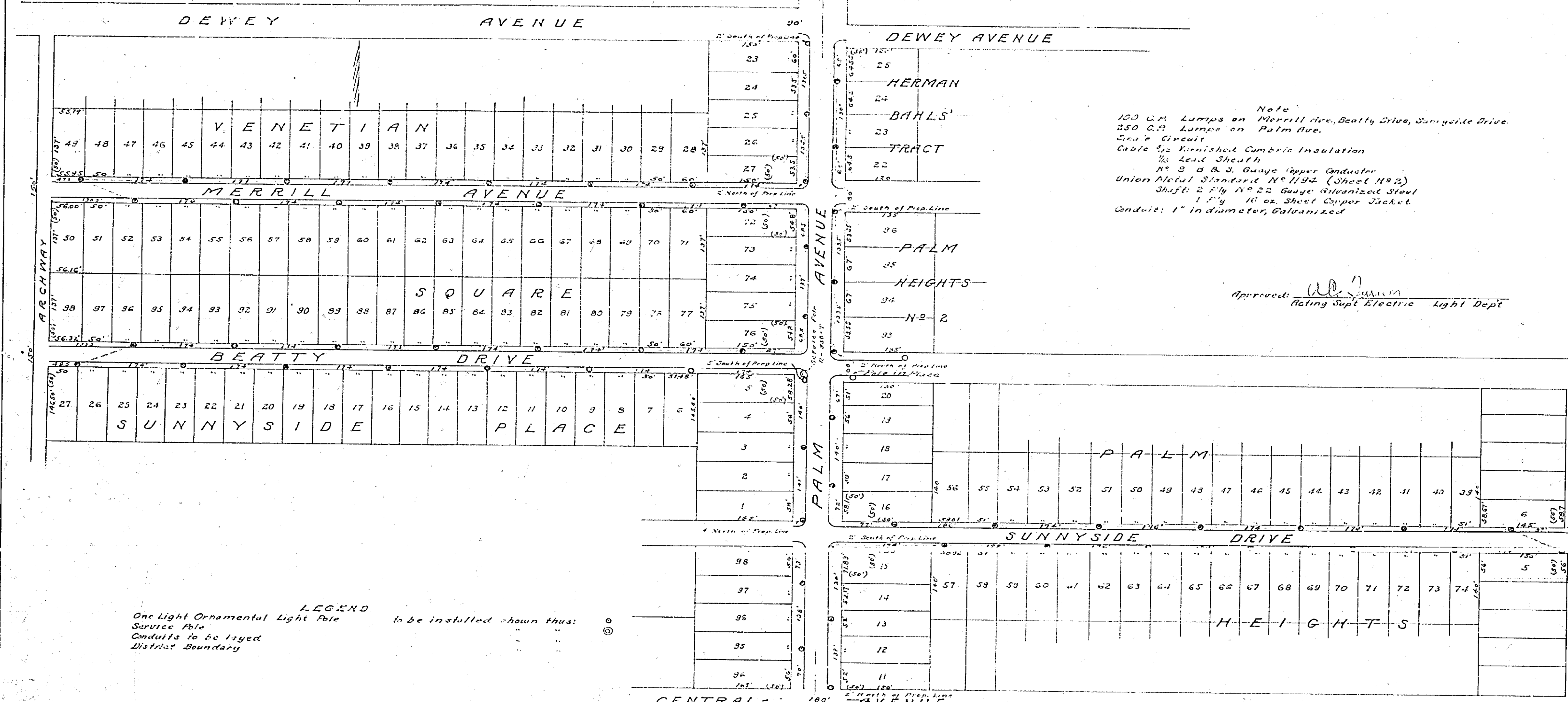



MAP OF PROPOSED LIGHTING SYSTEM ON  
 PALM AVE, MERRILL AVE, BEATTY DRIVE & SUNNYSIDE DRIVE  
 A.P. CAMPBELL, CITY ENGINEER, 1927.

SCALE  
 1 INCH = 100 FEET



Note  
 100 C.R. Lamps on Merrill Ave, Beatty Drive, Sunnyside Drive  
 250 C.R. Lamps on Palm Ave.  
 500' Circuit  
 Cable 3/2 Varnished Cambric Insulation  
 1/2 Lead Sheath  
 No. 8 B. & S. Gauge Copper Conductor  
 Union Metal Standard No. 1192 (Sheet No. 2)  
 Shift: 2 Ply No. 22 Gauge Galvanized Steel  
 1 1/4" 40 oz. Sheet Copper Jacket  
 Conduit: 1" in diameter, Galvanized

Approved: *W. J. ...*  
 Acting Supt. Electric Light Dept.

LEGEND  
 One Light Ornamental Light Pole to be installed shown thus:   
 Service Pole " "   
 Conduits to be laid " "   
 District Boundary " " 

Adopted by the Mayor and Common Council  
 of the City of Riverside, this 20th day of December, 1927.  
 Attest: *S. C. ...*  
 Clerk of the City of Riverside.

906

MAP N° 906

300

34"  
 27"  
 17"  
 11"  
 58"  
 85"  
 8.5"  
 11"  
 17"  
 22"

34"  
 27"  
 17"  
 11"  
 58"  
 85"  
 8.5"  
 11"  
 17"  
 22"