

22"
17"
11"
8.5"
11"
17"
22"

34.
33.
32.
31.
30.
29.
28.
27.
26.
25.
24.
23.
22.
21.
20.
19.
18.
17.
16.
15.
14.
13.
12.
11.
10.
9.
8.
7.
6.
5.
4.
3.
2.
1.

MAP OF PROPOSED SEWER CENTRAL AVE. TO RUBIDOUX AVE. R.E. BROWN, CITY ENGINEER 1928.

SCALE
1 INCH = 300 FEET

LEGEND

Sanitary Sewer	As constructed	Proposed
Manhole	As constructed	Proposed
Cleanout	As constructed	Proposed
Street	As constructed	Proposed
District Boundary	As constructed	Proposed

Approved by the Mayor and Common Council of the City of St. Louis, Missouri, on the 21st day of January, 1928.

City Engineer
R. E. Brown

City Clerk
C. C. G. R.

Notes:
1. See Standard Manhole Book, Section Type "A" Drawing, N.P. 229, prepared by the Mayor and Common Council of the City of St. Louis, June 16, 1925.
2. Cover, manhole not less than 12" dia.
3. Cleanout, not less than 4" dia.
4. Manhole, not less than 36" dia.

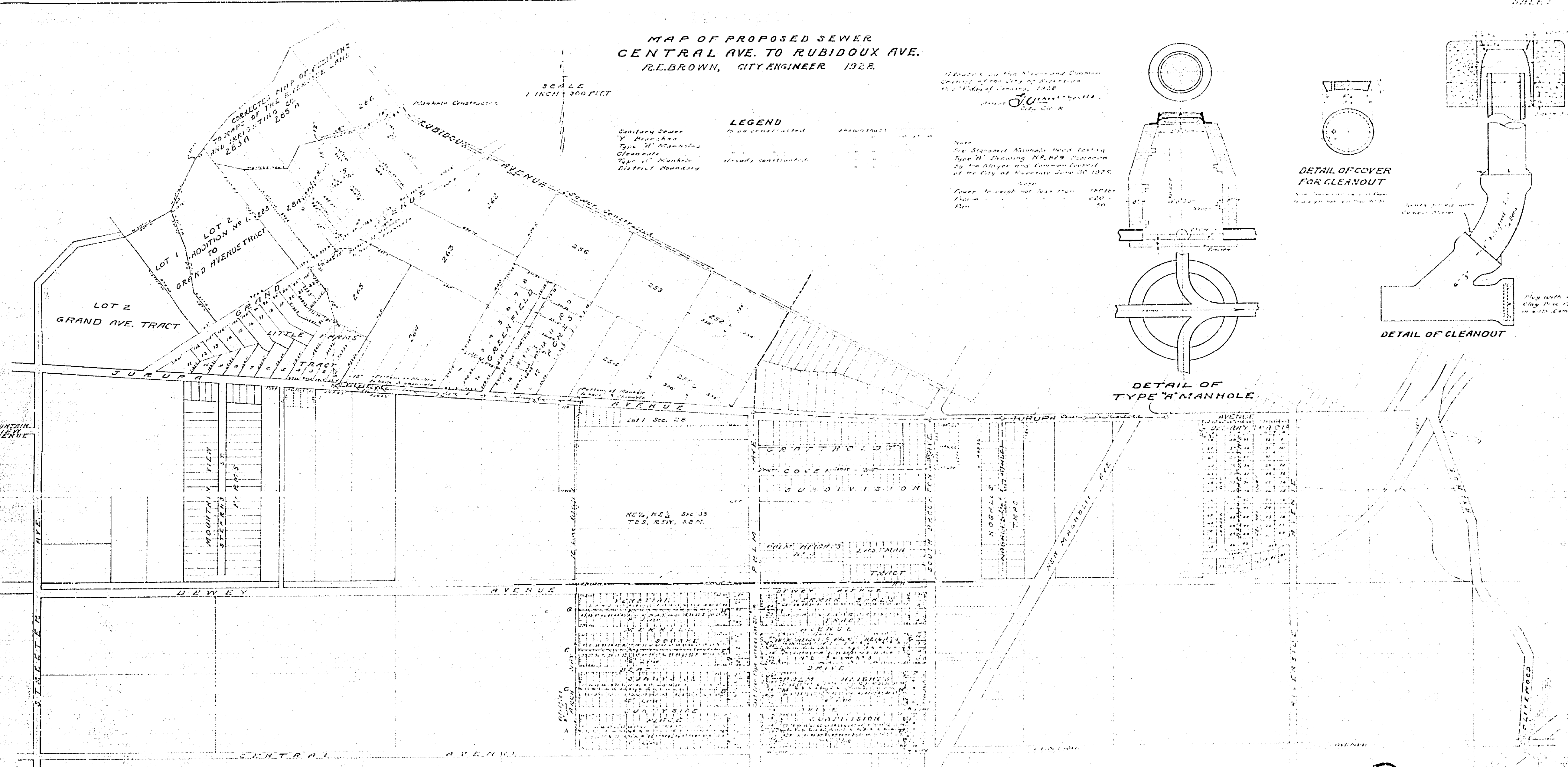
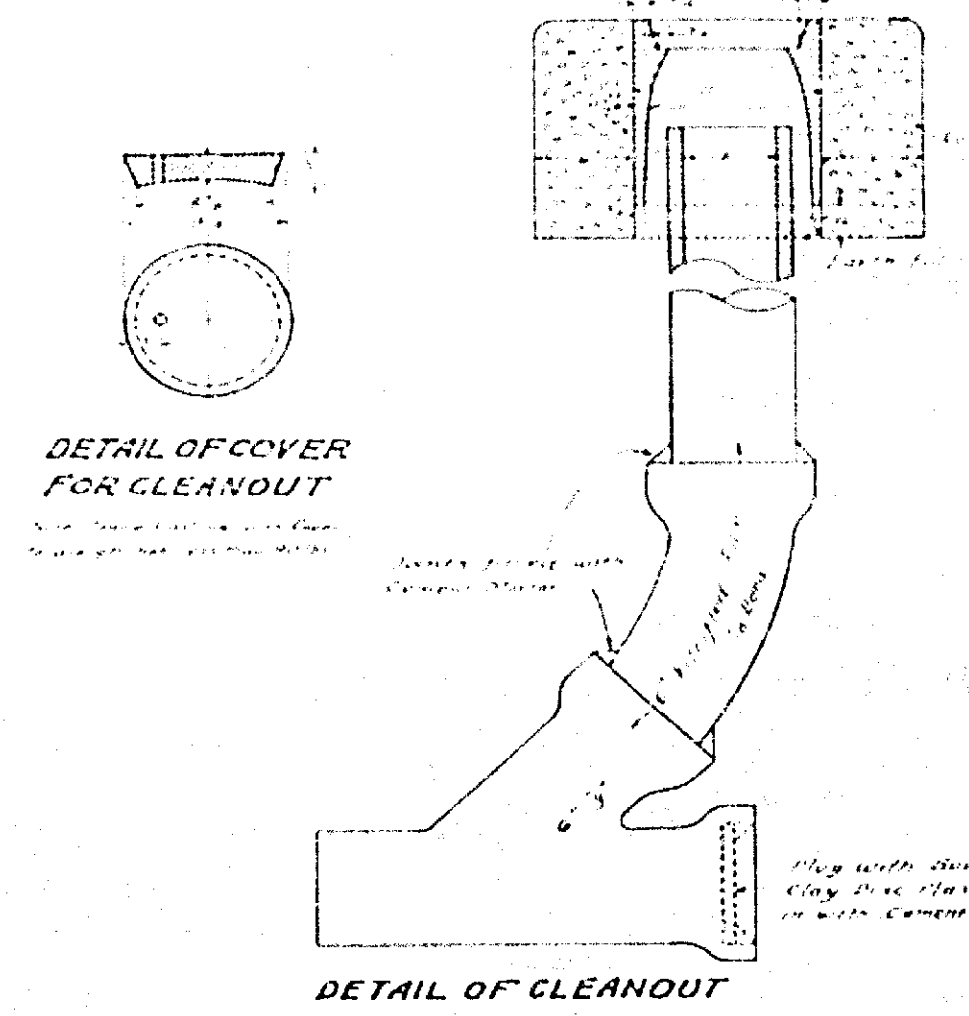
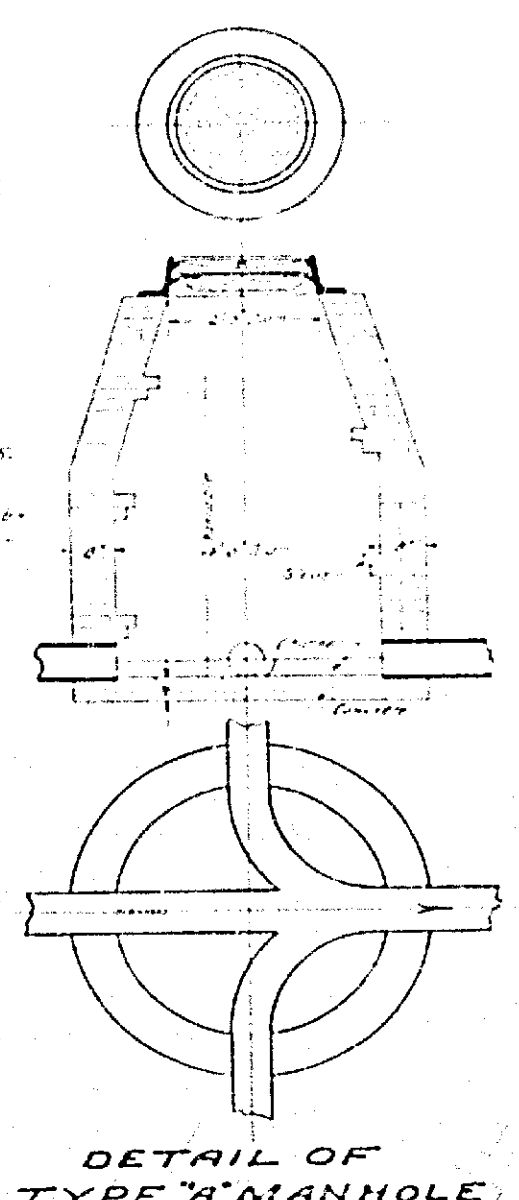

2 SHEETS
JOB SHEET 1

908

34

34

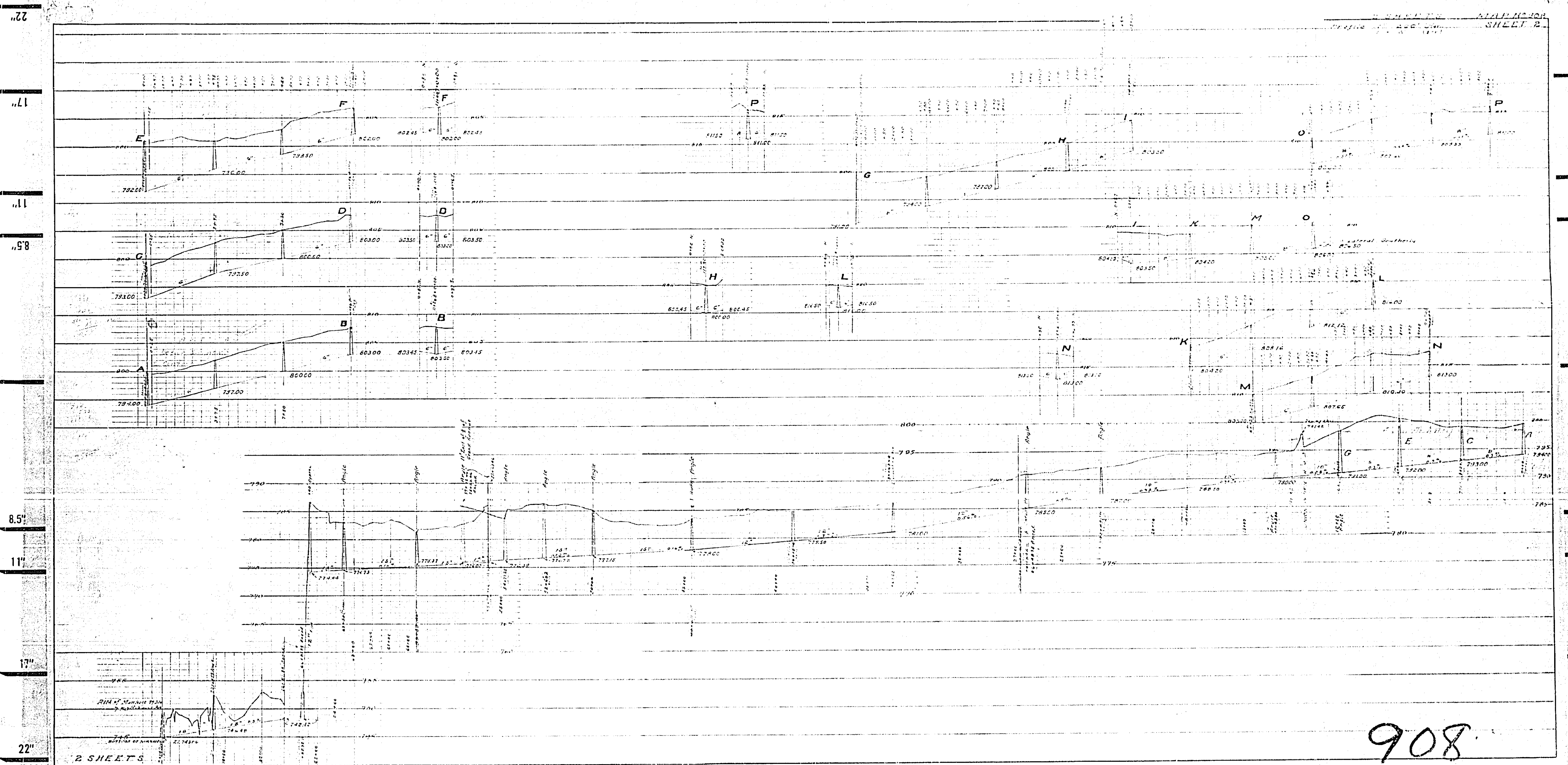

22

17

11

8.5

11

17

22

33

31

29

27

25

23

21

19

17

34

2 SHEETS

BOEING

908