

MAP OF PROPOSED IMPROVEMENT OF CENTRAL AVENUE

P. E. BROWN, CITY ENGINEER 1928.

Adopted by the Mayor and Common Council of the
City of Houston, Texas, on May 12, 1928.
Artist: *George A. ...*
City Clerk

SCALE
1 INCH = 100 FT

LEGEND
Cement concrete gutter to be constructed
Cement concrete slab
Macadam base
Concrete curb
Concrete curb gutter
District Boundary

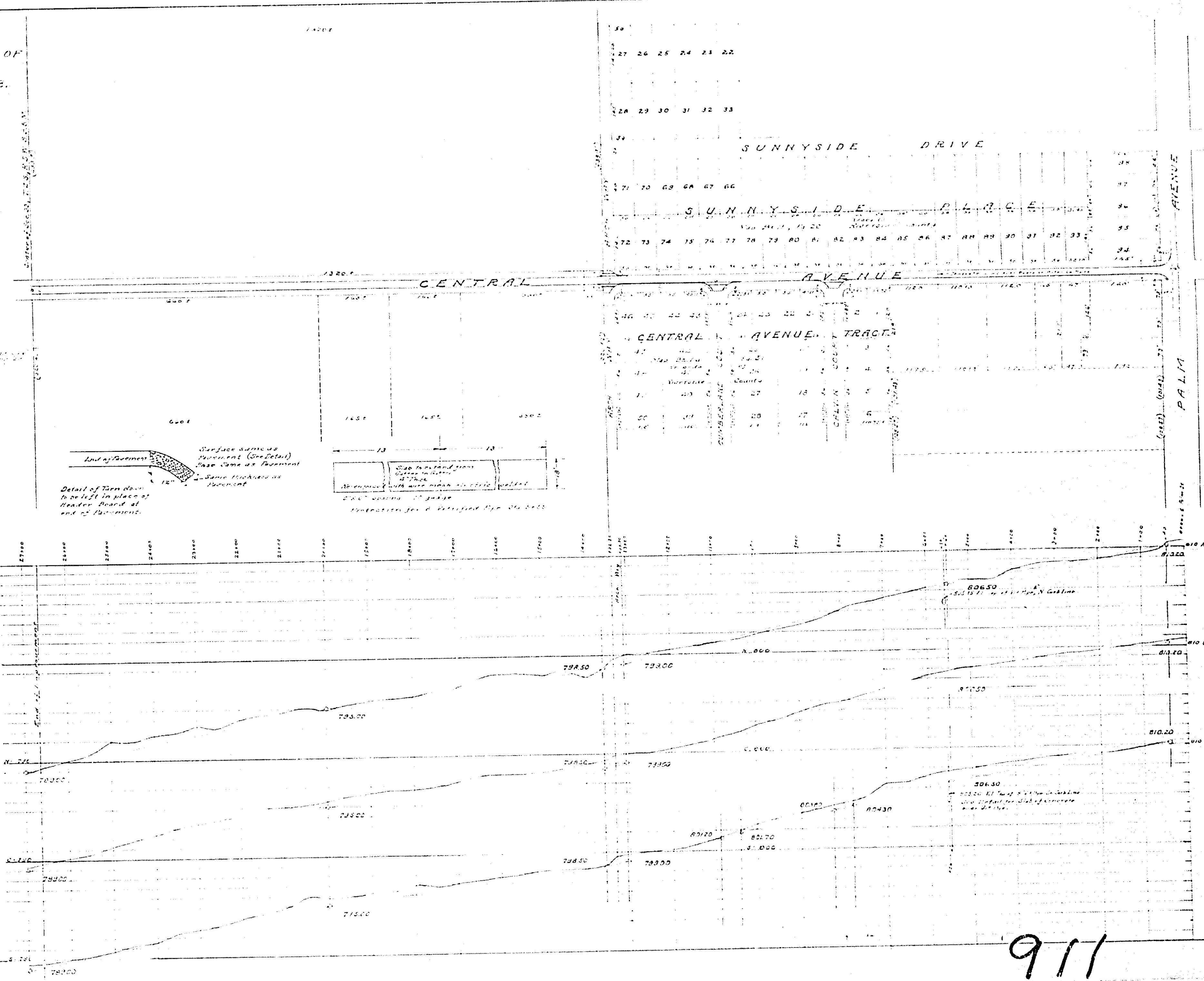
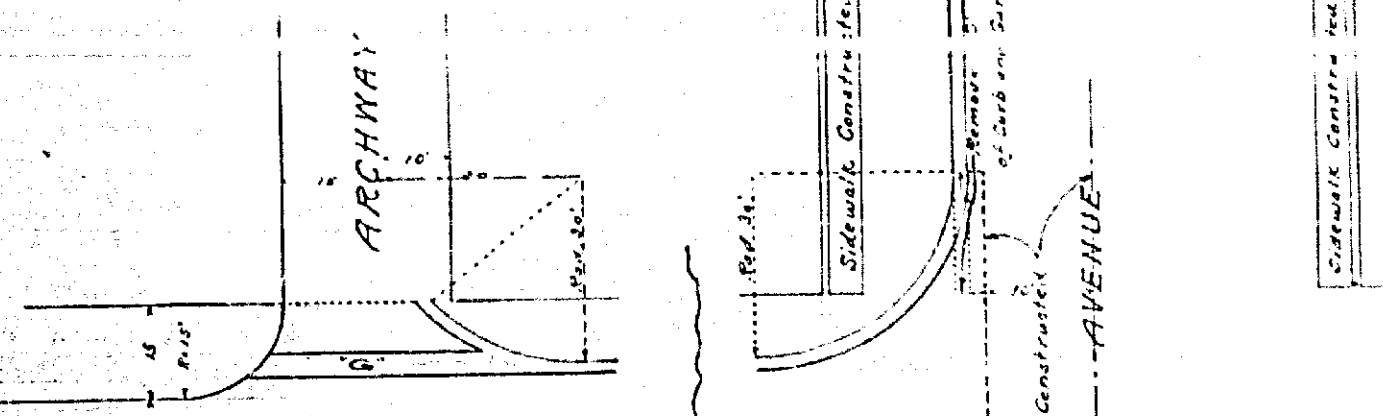
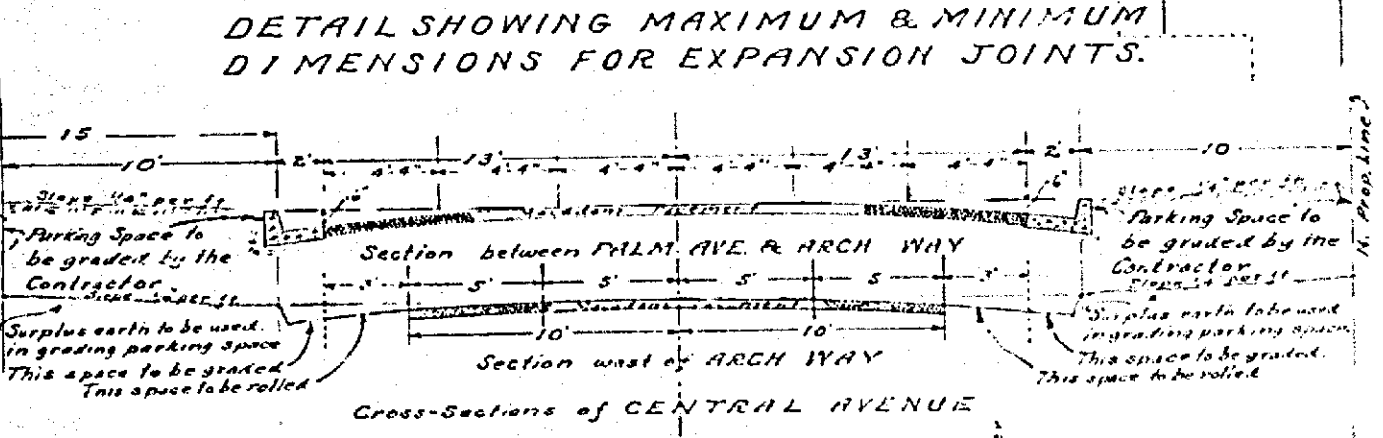
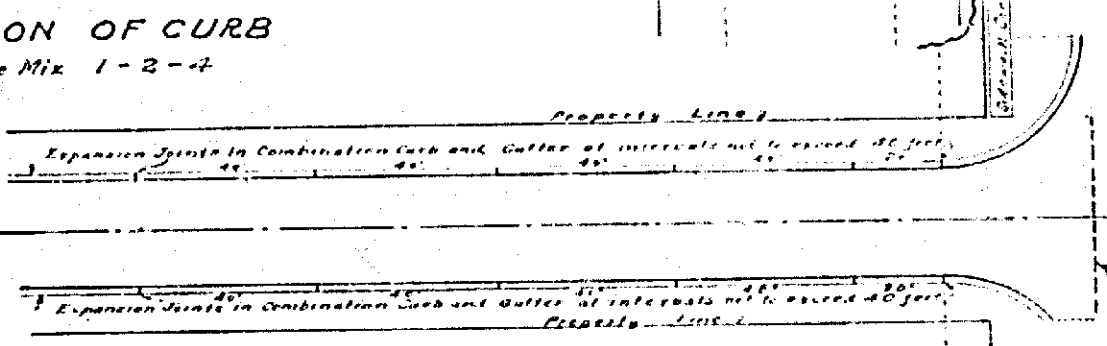
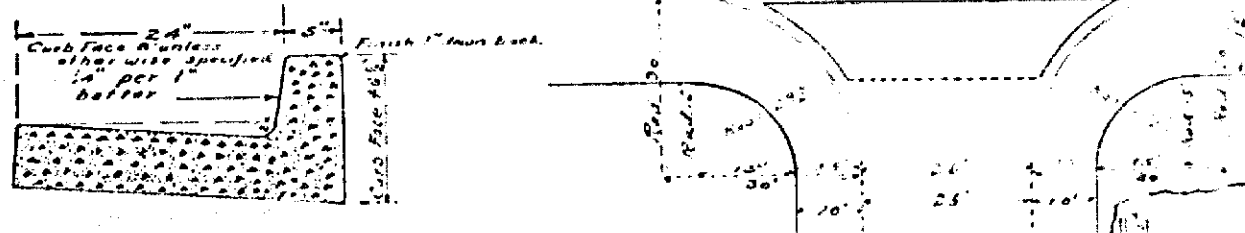
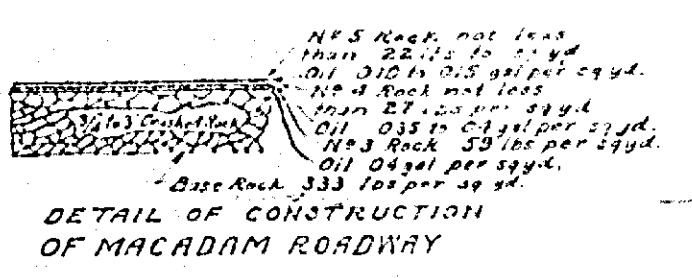

911