

PLANS AND PROFILES
OF THE PROPOSED STORM DRAIN
 BROCKTON AVE, RIGHT-OF-WAY, NEW MAGNOLIA AVE, SCHOOL CIRCLE, SCHOOL ST. AND PALM AVE.
 FROM SOUTH BROCKTON AVENUE TO PALM AVENUE

ENGINEERING DEPT. CITY OF RIVERSIDE SCALE 1/4" = 40 FT. SEPTEMBER 1929

PLANS PROFILES & MAPS NO. CONSISTING OF 2 SHEETS

INSTRUCTIONS TO CONTRACTOR
 FOLDER CONTAINING INSTRUCTIONS TO CONTRACTOR AND DETAIL PLANS NUMBERS 104 AND 120 ARE A PART OF THESE PLANS AND SPECIFICATIONS. 23.83 FEET IS TO BE ADDED TO THE ELEVATIONS OF THE SUPERSEDED DATUM PLANE ON THIS PLAN TO CORRECT FOR ELEVATIONS OF PRESENT OFFICIAL RIVERSIDE CITY DATUM PLANE ADOPTED BY ORDENANCE NUMBER 5114 SERIES DATED JULY 30, 1928.

ADOPTED BY THE MAYOR AND COUNCIL OF THE CITY OF RIVERSIDE THIS ... OF ... 1928.

CITY ENGINEER CITY OF RIVERSIDE

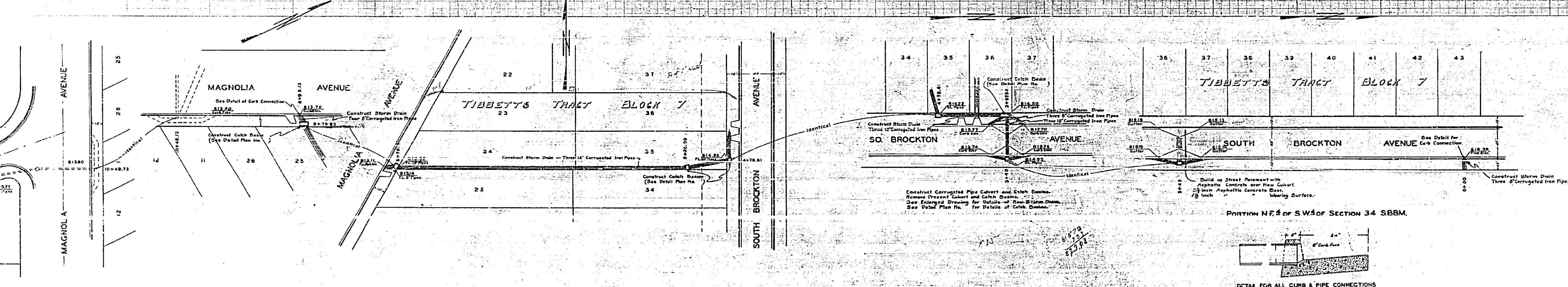

939A

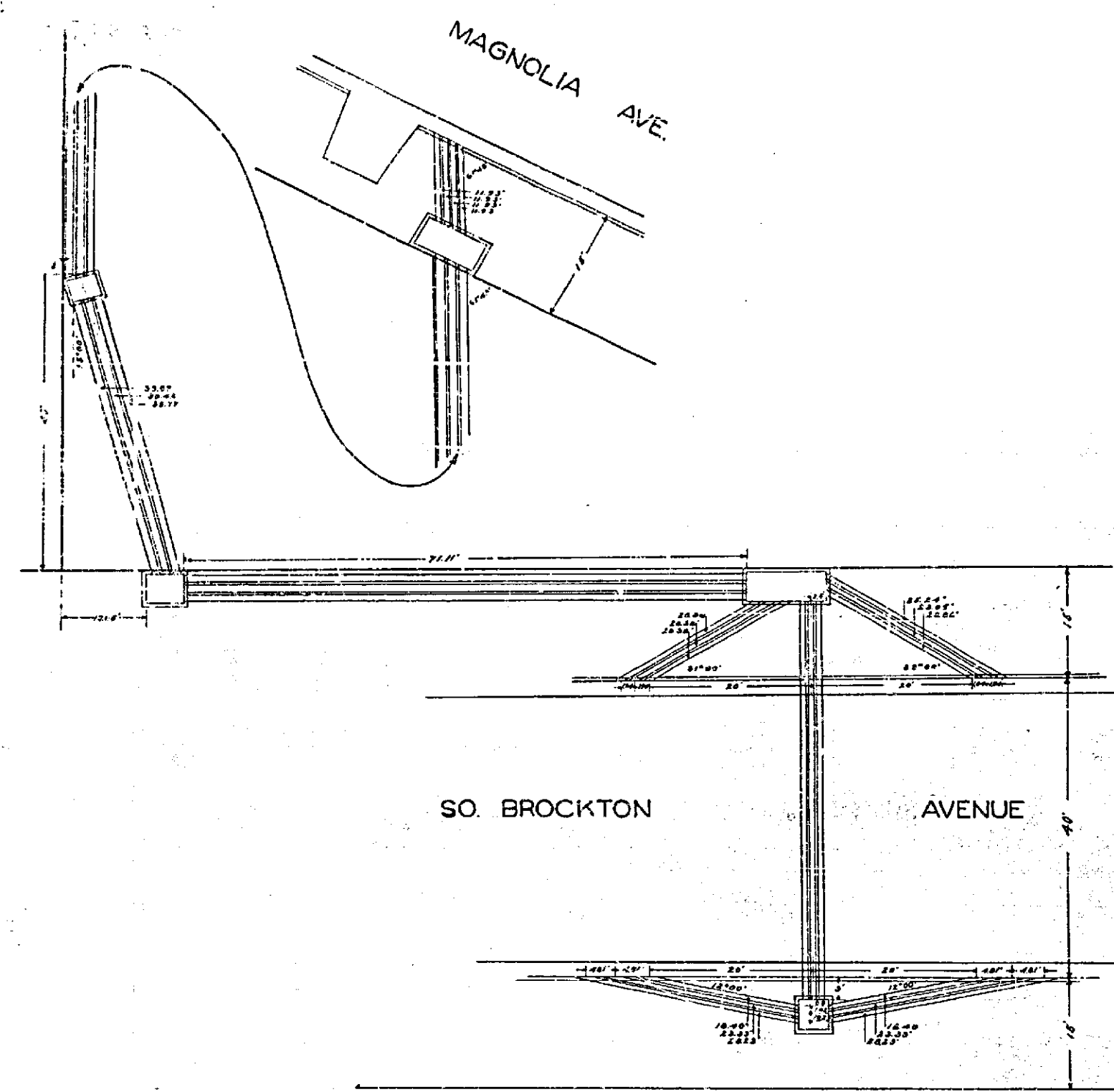

ENLARGED DETAIL OF STORM DRAIN IN BROCKTON AVENUE.
Scale 1"=10'

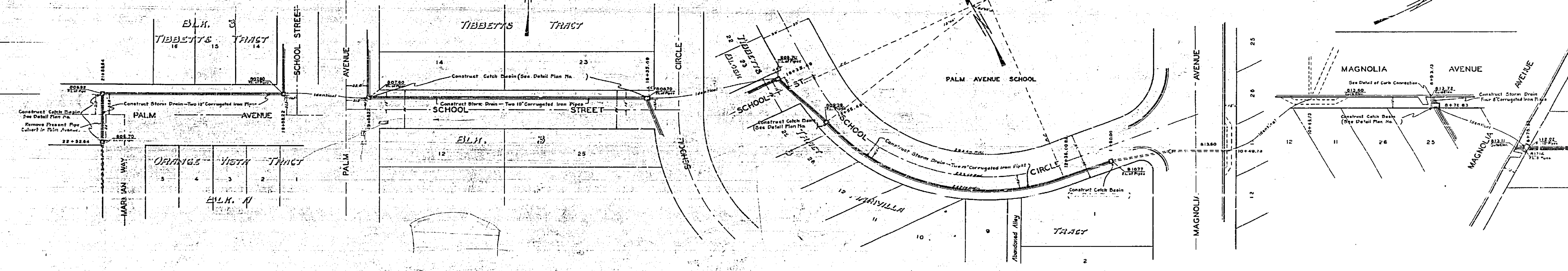
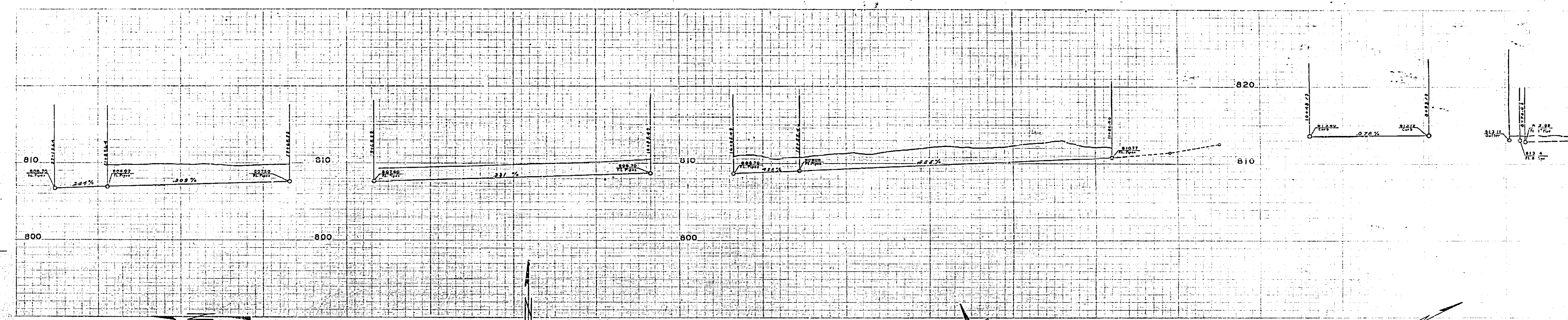

Plan No. 10000

A-188