

PLANS AND PROFILES
 OF THE PROPOSED STREET IMPROVEMENT OF
INDIANA AVENUE
 BETWEEN MADISON STREET AND ARLINGTON AVENUE
 AND PORTIONS OF
MARY STREET, JANE STREET AND RIVERSIDE AVENUE
 ENGINEERING DEPARTMENT, CITY OF RIVERSIDE. OCTOBER 1929

PLANS, PROFILES AND MAPS NUMBER 940,
 CONSISTING OF 12 SHEETS
 SHEETS NUMBERED 1, 2, 3 & 4 STREET IMPROVEMENT OF INDIANA AVENUE BETWEEN MADISON STREET AND
 ARLINGTON AVENUE AND PORTIONS OF MARY STREET, JANE STREET AND
 RIVERSIDE AVENUE
 SHEETS NUMBERED 5, 6, 7 & 8 MAP OF THE DISTRICT TO BE ASSESSED FOR THE IMPROVEMENTS

INSTRUCTIONS TO CONTRACTOR
 FOLDER CONTAINING INSTRUCTIONS TO CONTRACTOR AND DETAIL PLANS NUMBERED 103, 104, 107 & 123
 ARE A PART OF THESE PLANS AND SPECIFICATIONS

FIELD BOOKS
 BOOK 200 PAGES 53 TO 58
 BOOK 201 PAGES 2 TO 77

*Not Constructed
 2-1-35*

ADOPTED BY THE MAYOR AND COUNCIL OF THE CITY OF RIVERSIDE
 THIS 5th DAY OF OCTOBER, 1929

*J. C. ...
 CITY CLERK, CITY OF RIVERSIDE*

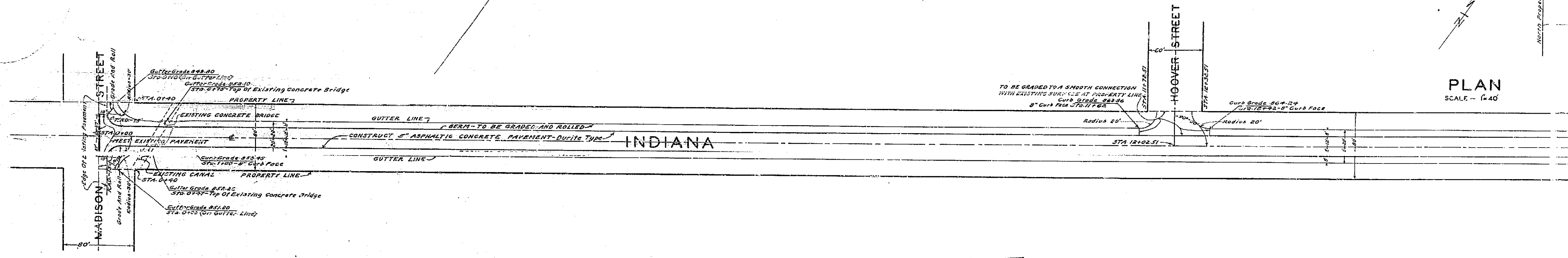
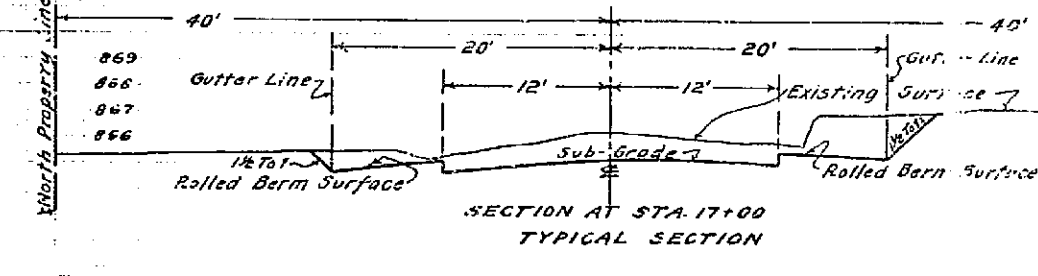
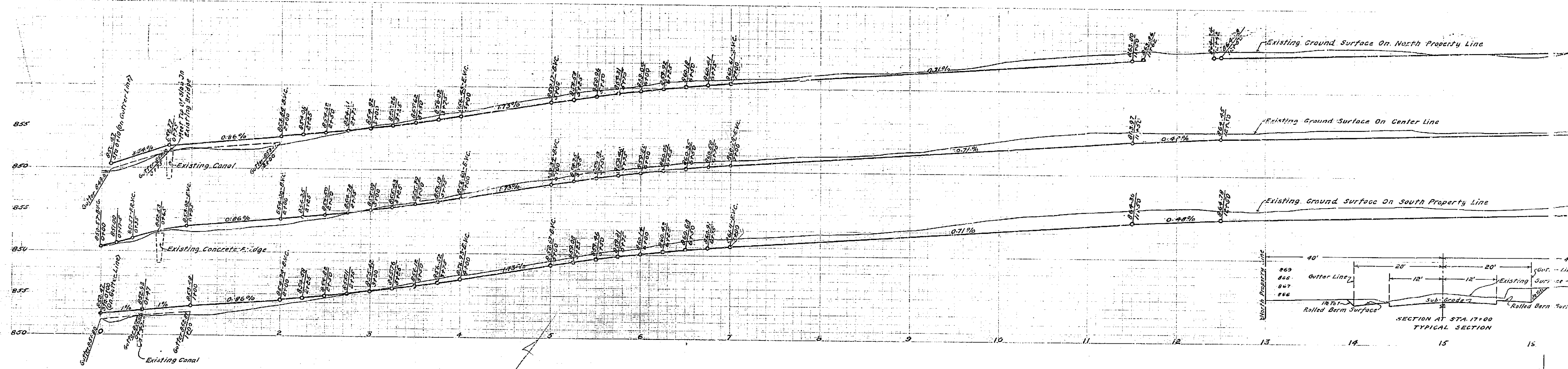

PLAN No 940
 SHEET No. 1 OF 12 SHEETS

FILED