

944 D

PROFILE TO QUISQUITE STORM DRAIN
PINE ST. TO U.P.R.R.
ENG. DEPT. CITY OF RIVERSIDE
EB. 316-RG. 1 MAR. 1939
SCALE - 1" = 100' HOR.
1" = 4' VERT.

Profile of Topography
and Proposed Storm Drain

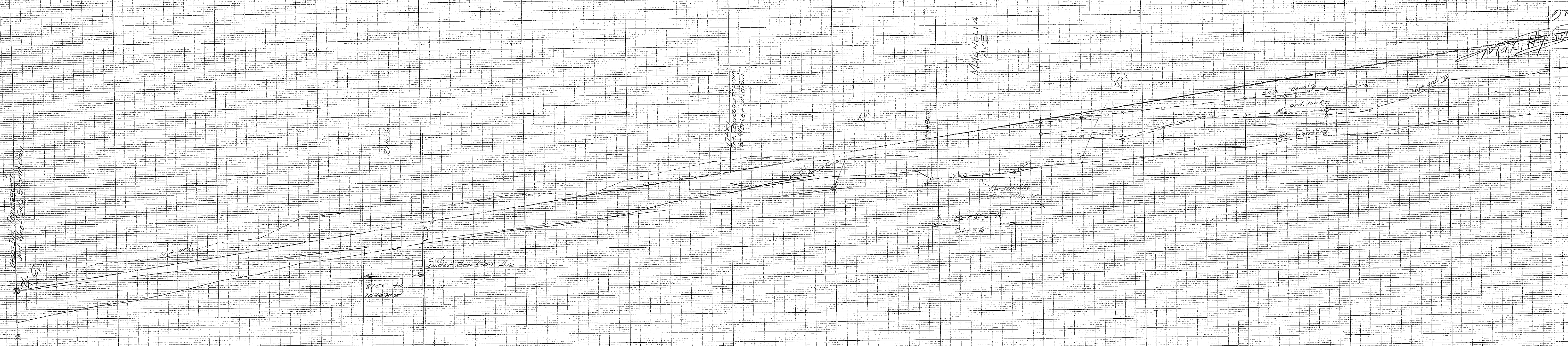

770

