

**PLAN AND PROFILE**  
 OF  
**CENTRAL AVENUE**  
 BETWEEN  
 MAGNOLIA AVENUE AND A. T. & S.F.R.R.  
 ENGINEERING DEPT. CITY OF RIVERSIDE  
 PLAN NUMBER  
 CONSISTING OF 3 SHEETS  
 JULY 1932  
 ELEVATIONS SHOWN HEREON ARE U.S.G.S. DATUM  
 FIELD BOOK 264 PAGES 4 TO 70

*Constructed  
8-1-32  
all maps for  
location*

*See Map N-1061*

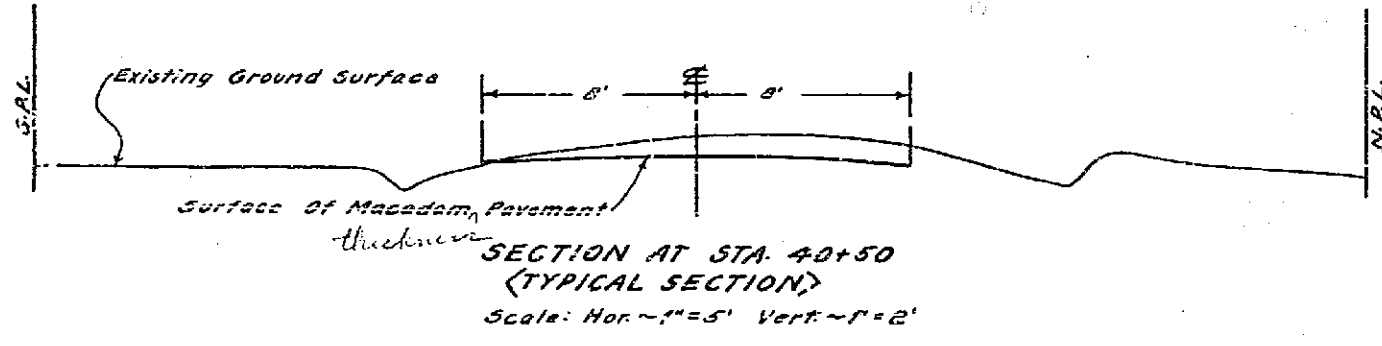

ADOPTED BY THE MAYOR AND COUNCIL OF THE CITY OF RIVERSIDE  
THIS \_\_\_\_\_ DAY OF \_\_\_\_\_ 1932

CITY CLERK, CITY OF RIVERSIDE

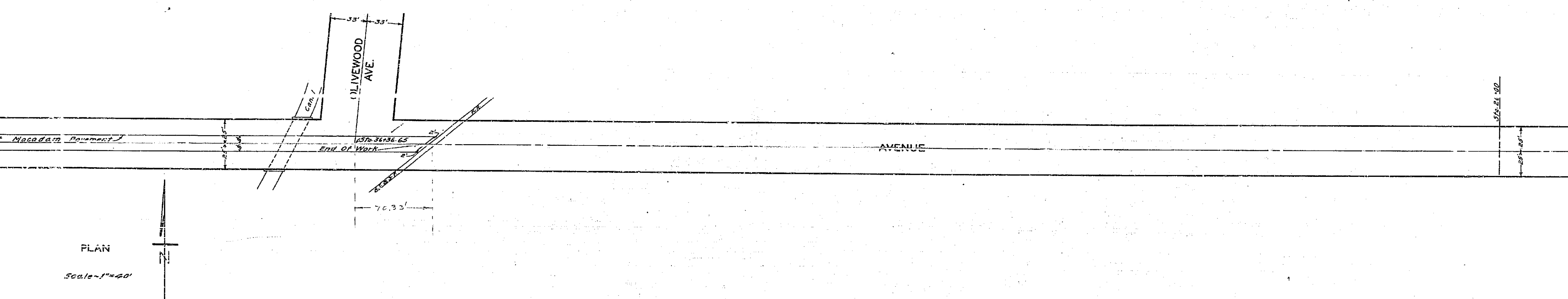

FRAME 112

948  
SHEET No 1 OF 3 SHEETS



948

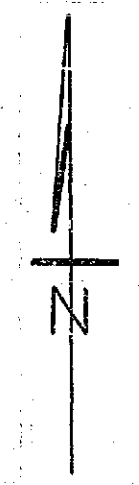
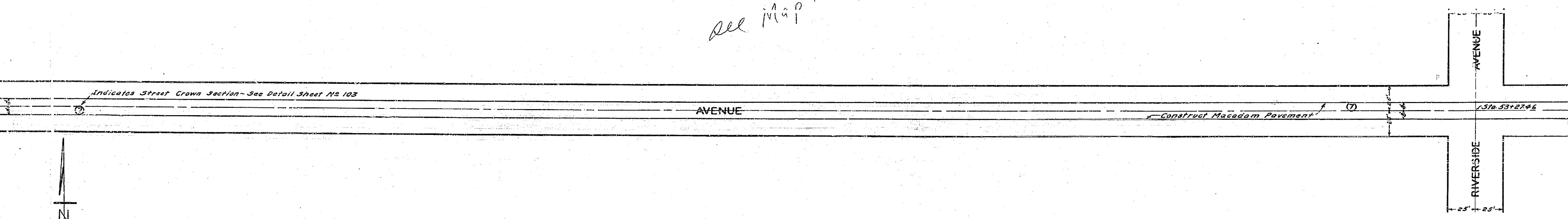
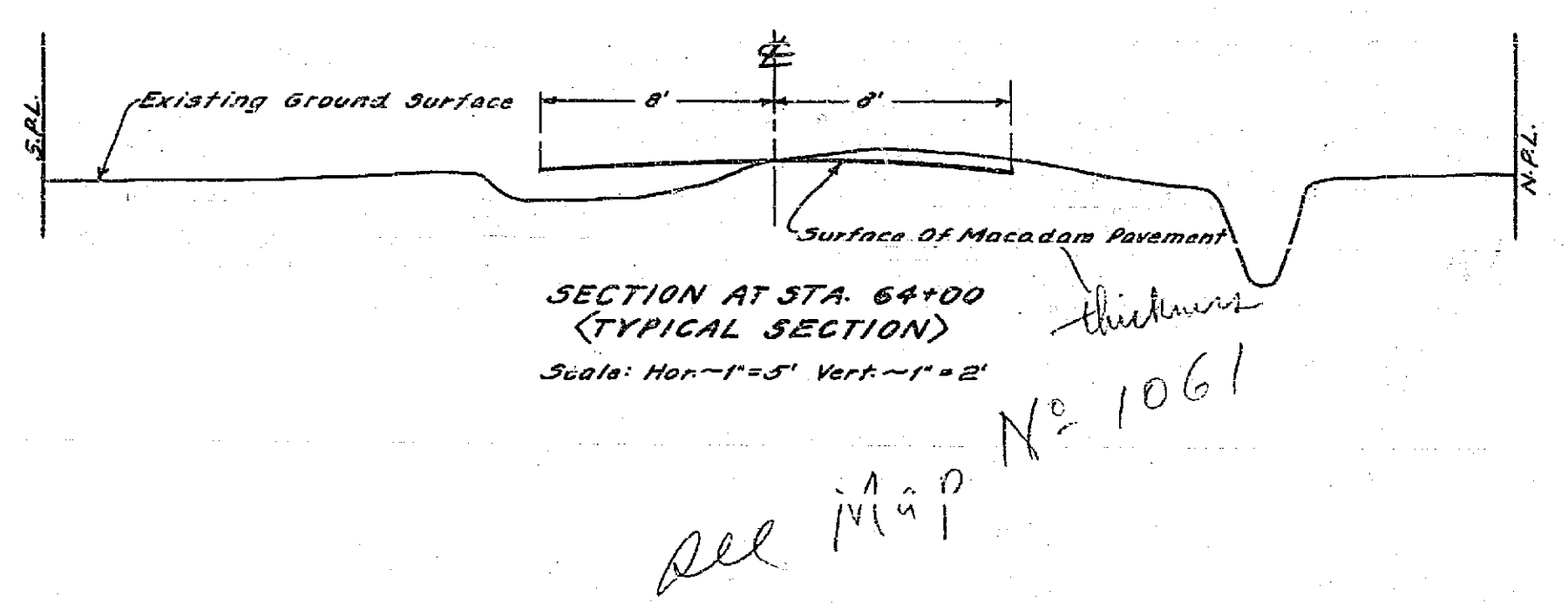
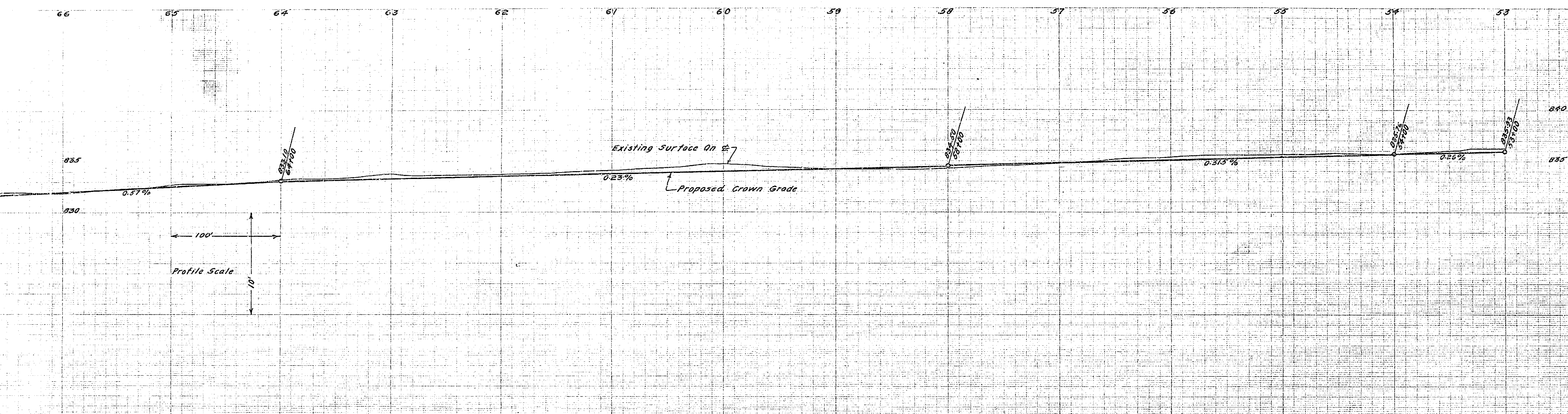

948

PLAN No  
ENGINEERING DEPT.-CITY OF RIVERSIDE  
SHEET 2 OF 3 SHEETS

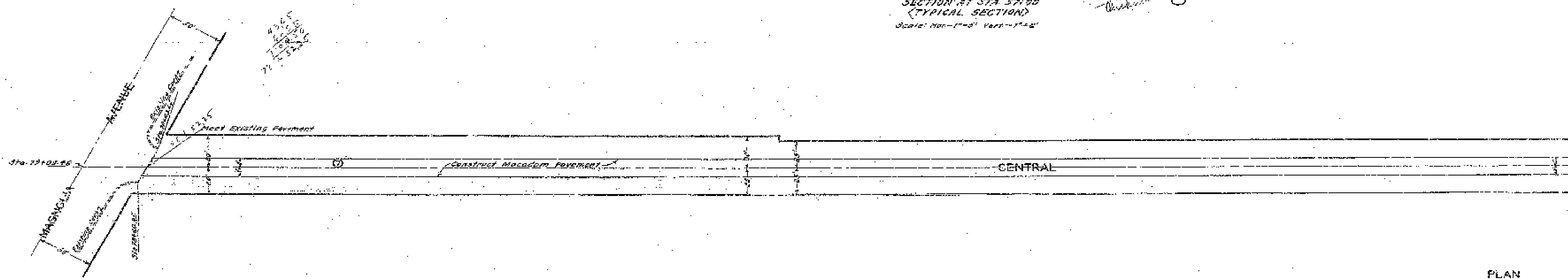
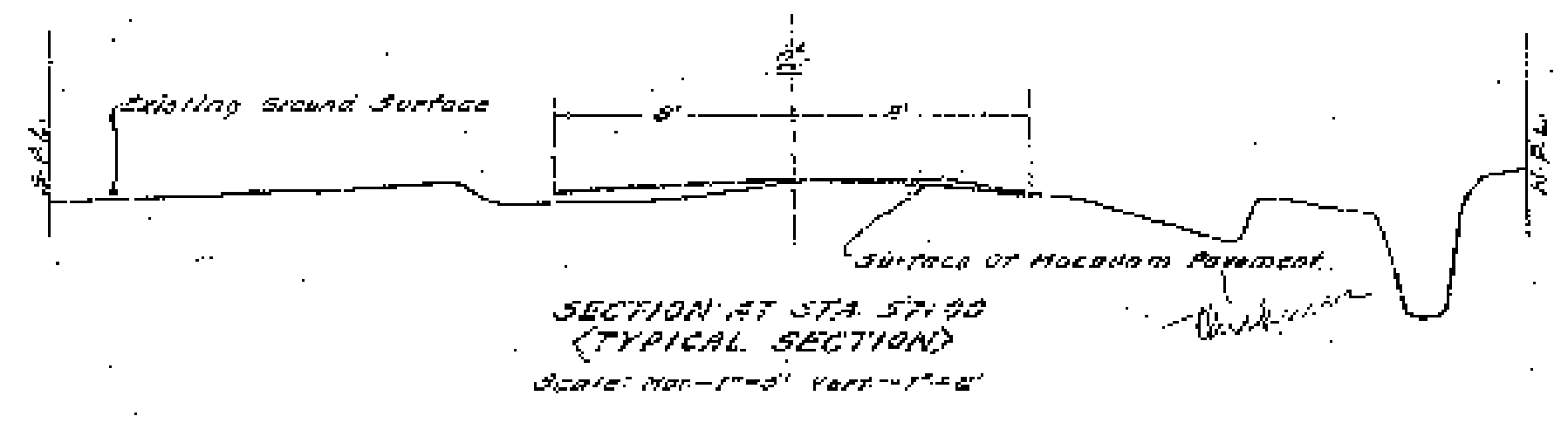
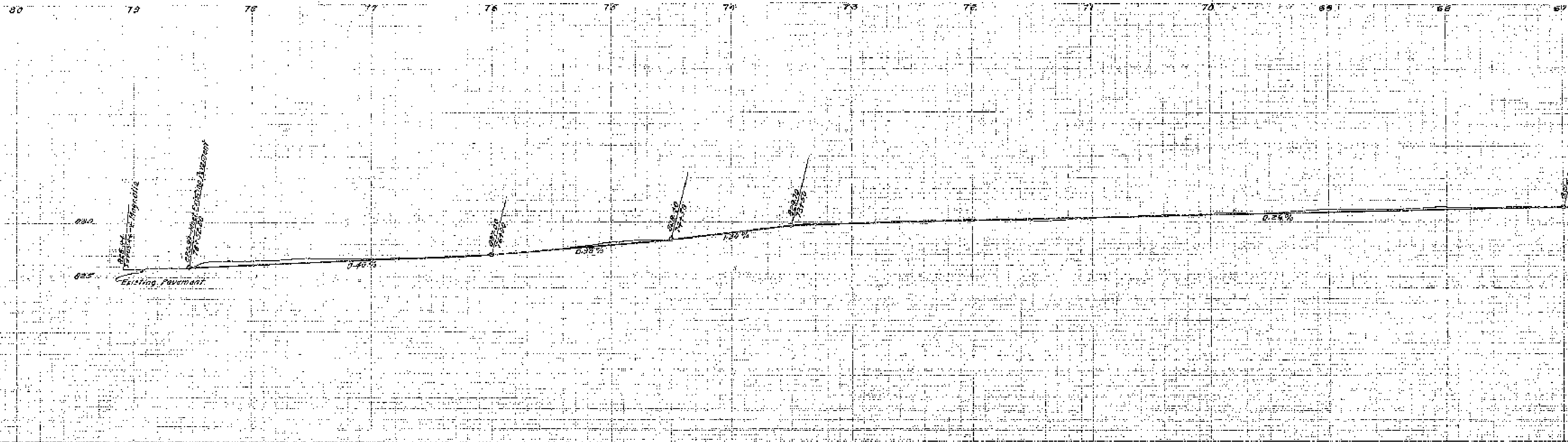

PLAN No  
NEEDING DEPT - CITY OF RIVERSIDE  
SHEET No 2 OF 3 SHEETS

DATE: 1/1/16

PLAN  
Scale - 1" = 40'