

PROFILE

Scale
Vert. 1 inch = 4 feet.
Horiz. 1 inch = 40 feet.

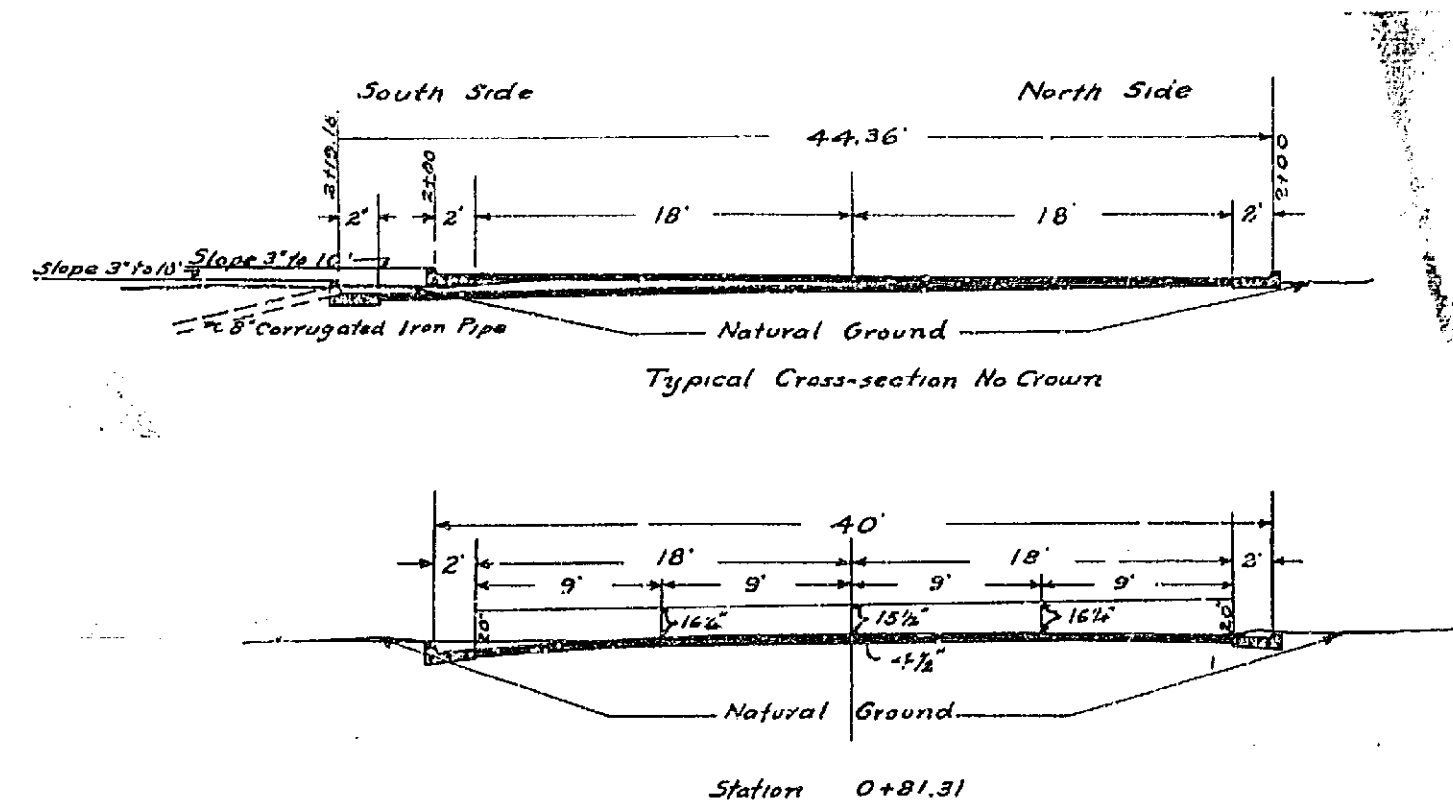

CROSS-SECTIONS

PLANS AND PROFILES

OF THE PROPOSED IMPROVEMENT OF

VICTORIA AVENUE, CRIDGE STREET, NORTH STREET, PACHAPPA AVENUE & OLIVEWOOD AVENUE.

- VICTORIA AVENUE**
FROM CRIDGE STREET SOUTHERLY TO A POINT 123 FEET SOUTHERLY FROM THE NORTHERLY END OF VICTORIA BRIDGE.
- CRIDGE STREET**
FROM PACHAPPA AVENUE EASTERLY FOR A DISTANCE OF 8 FEET, AND FROM VICTORIA AVENUE EASTERLY FOR A DISTANCE OF 8 FEET.
- NORTH STREET**
BETWEEN PACHAPPA AVENUE AND OLIVEWOOD AVENUE.
- PACHAPPA AVENUE**
FROM CRIDGE STREET NORTHERLY 14 FEET AND CRIDGE STREET SOUTHERLY 14 FEET.
- OLIVEWOOD AVENUE**
FROM NORTH STREET NORTHERLY FOR A DISTANCE OF 22.58 FEET.

PLAN

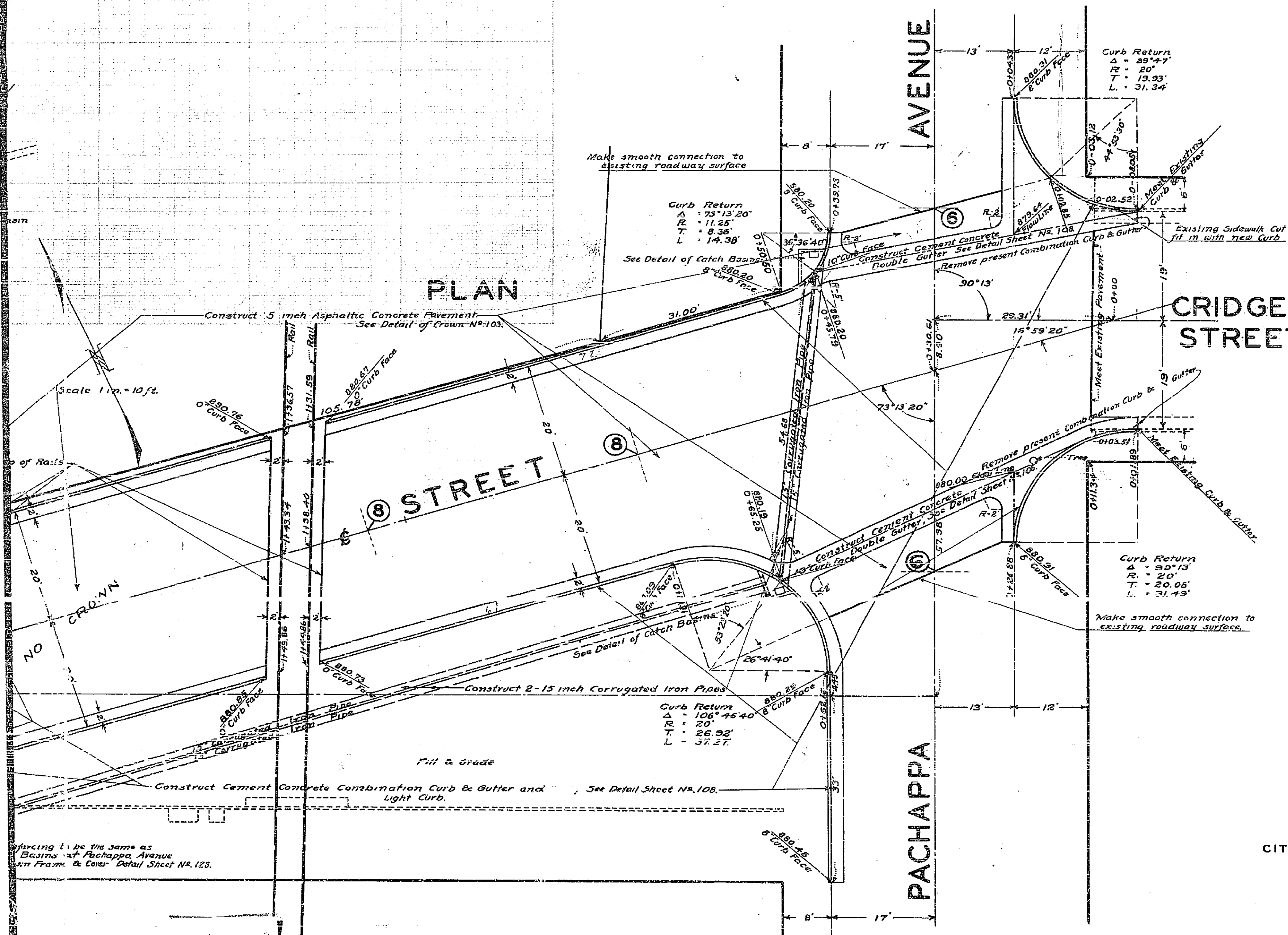

ENGINEERING DEPARTMENT

CITY OF RIVERSIDE

NOVEMBER 1930.

PLANS PROFILES AND MAPS NUMBER 959 CONSISTING OF 11 SHEETS.

SHEET NUMBER 1 IMPROVEMENT OF A PORTION OF CRIDGE ST., PACHAPPA AVE., NORTH ST. & OLIVEWOOD AVE.
 SHEET NUMBER 2 & 3 IMPROVEMENT OF A PORTION OF VICTORIA AVENUE.
 SHEET NUMBER 103, 108, 123, 130. DETAIL SHEETS FOR THE IMPROVEMENT.
 SHEET NUMBER 81, 82, 83, 79 MAPS OF THE DISTRICT TO BE ASSESSED.

ELEVATIONS SHOWN HEREON ARE U., S., C., S. DATUM WHICH IS THE OFFICIAL RIVERSIDE CITY DATUM PLANE ORDINANCE NO. 551 NEW SERIES.

FIELD BOOK	BOOK	PAGE
	202	PAGE 26 TO 46. PAGE 56 TO 70.
	205	PAGE 69 TO 79.
	203	PAGE 33 TO 69.
	212	PAGE 70 TO 75.
	223	PAGE 1 TO 14.

ADOPTED BY THE MAYOR AND COUNCIL OF THE CITY OF RIVERSIDE THIS 8TH DAY OF DECEMBER 1930.

[Signature]
CLERK OF THE CITY OF RIVERSIDE.

959

PLANS PROFILES AND MAPS
SHEET 1 OF 11 SHEETS.
ENGINEERING DEPT. CITY OF RIVERSIDE

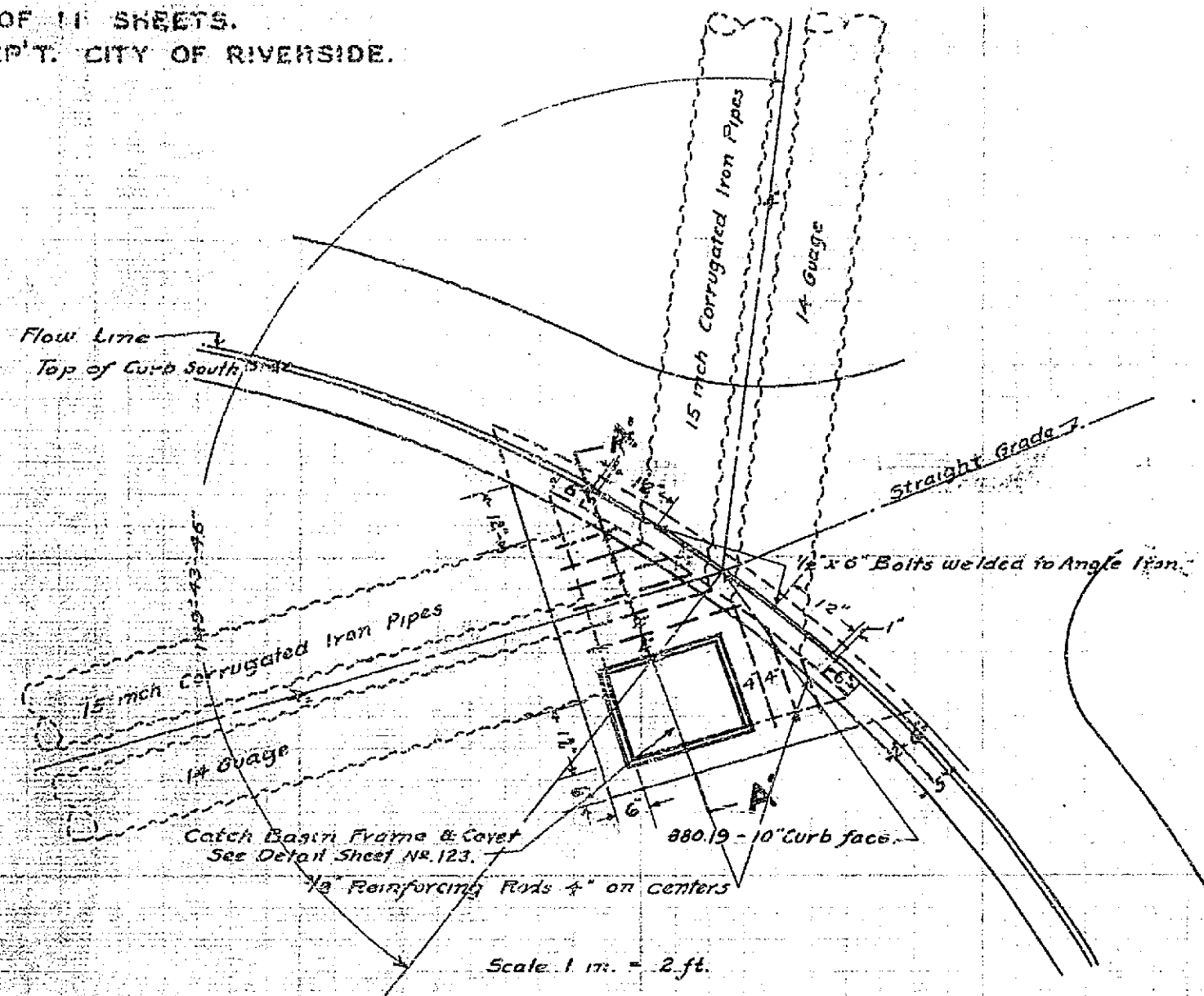

PLAN OF CATCH BASIN STA 0+65.25.
 Scale 1 in. = 2 ft.

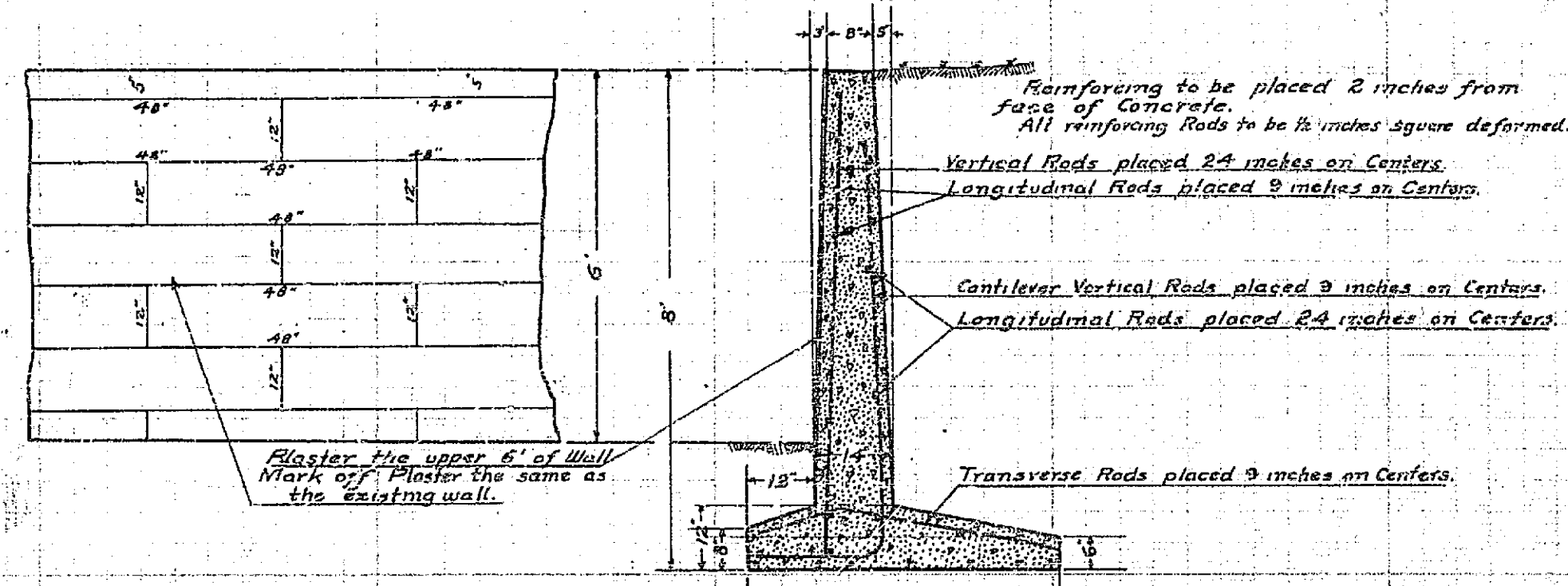

DETAIL OF CEMENT CONCRETE WALL
 Scale 1/4 inch = 1 foot.

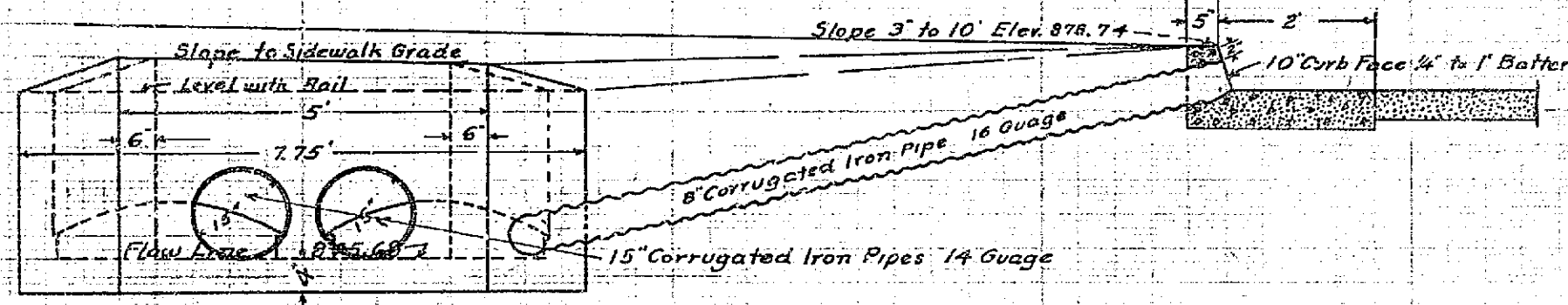

DETAIL OF CATCH BASIN STA 2+24.73 AND CURB STA 2+19.18
 Scale 1 inch = 2 feet.

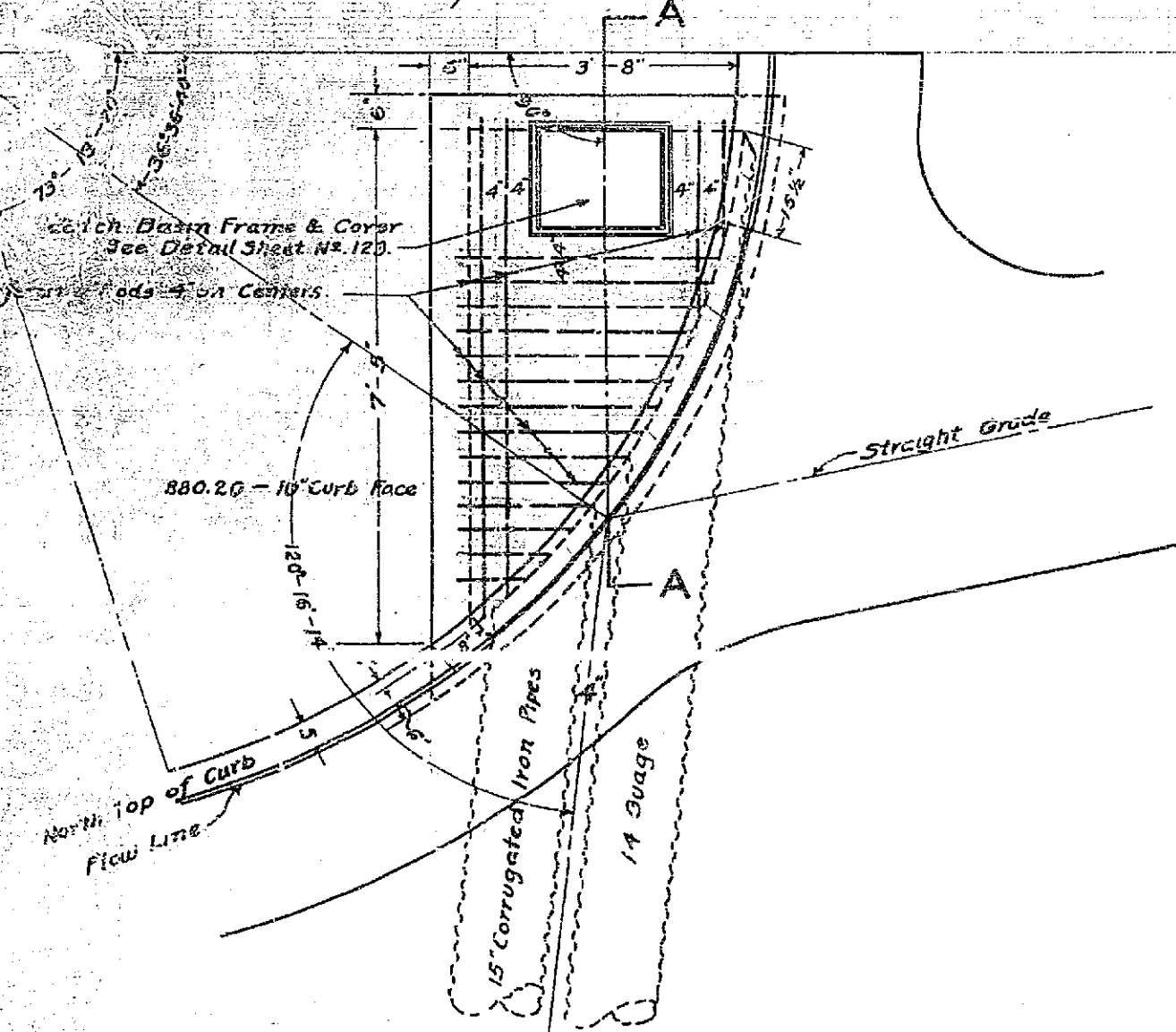
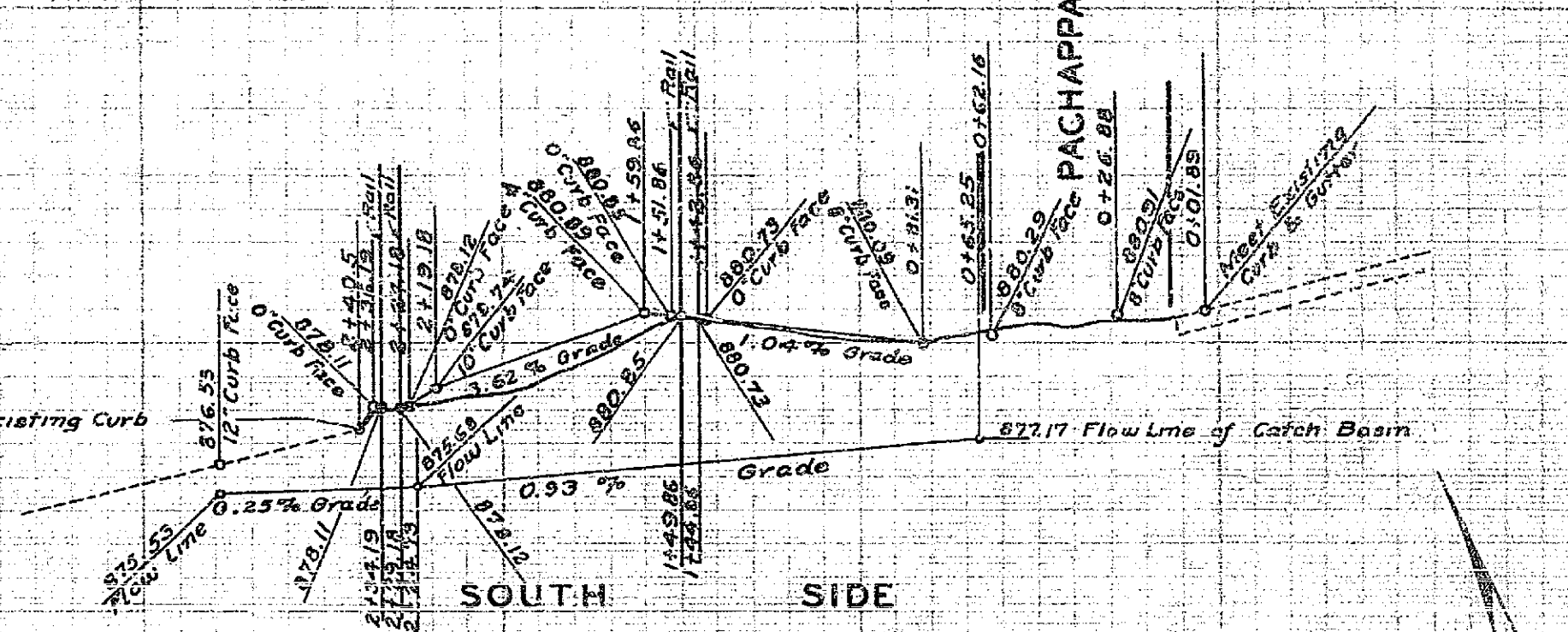
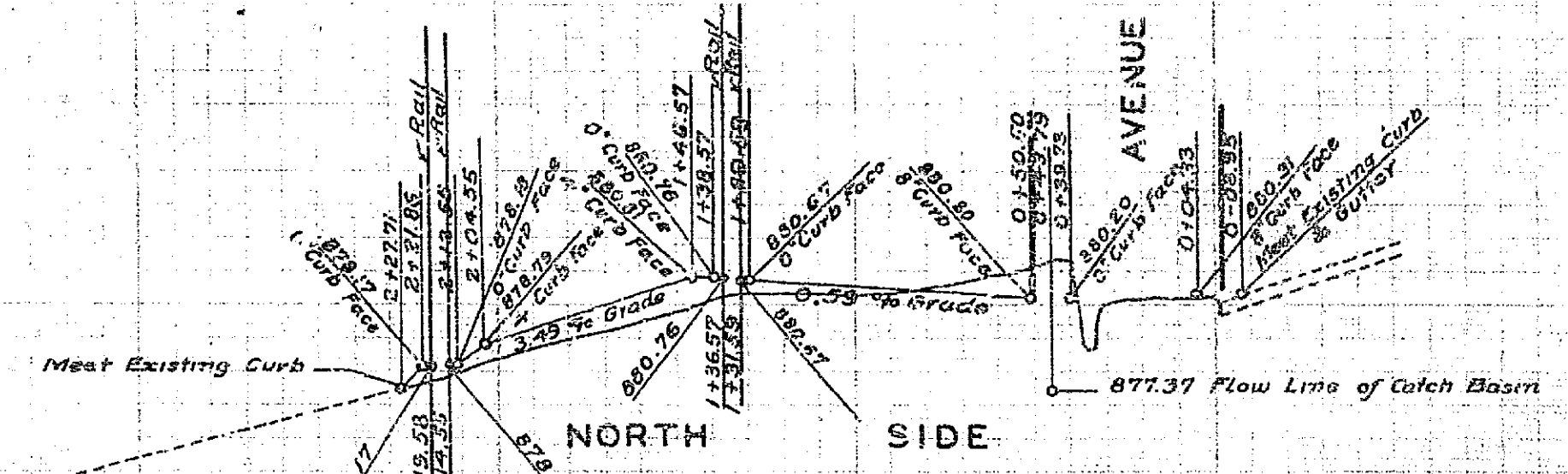

PLAN OF CATCH BASIN STA. 0+43.79
 Scale 1 in. = 2 ft.

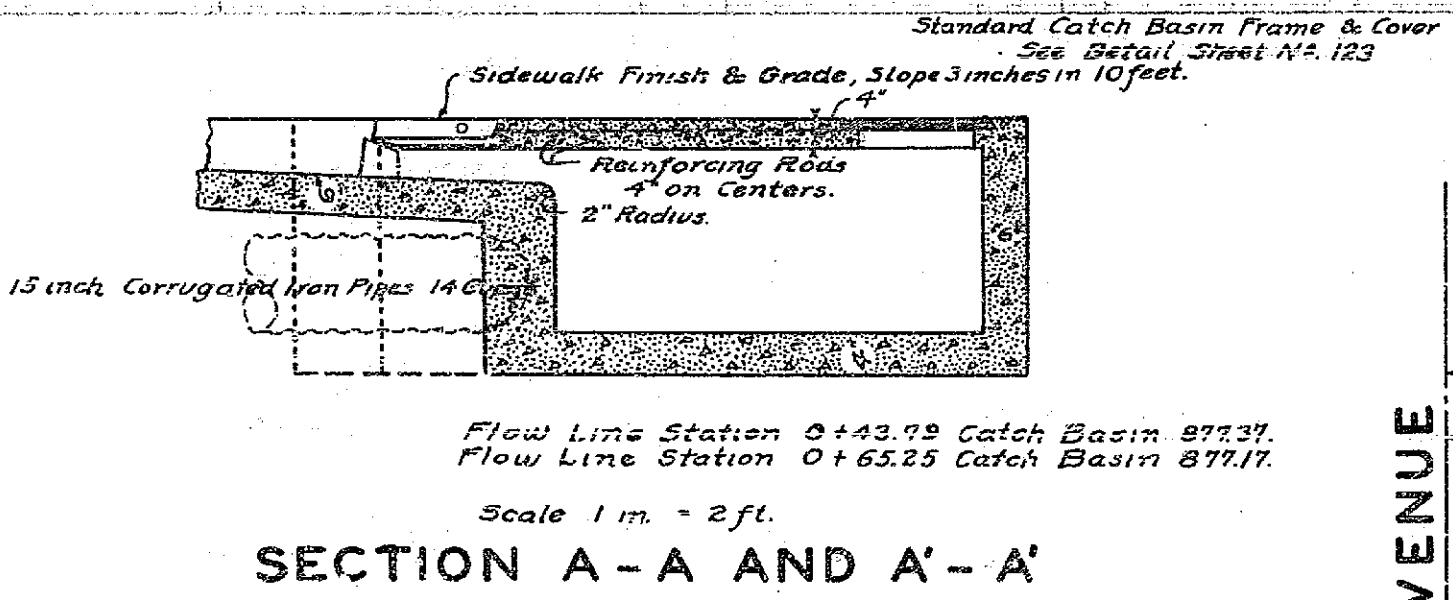

SECTION A-A AND A'-A'
 Scale 1 in. = 2 ft.

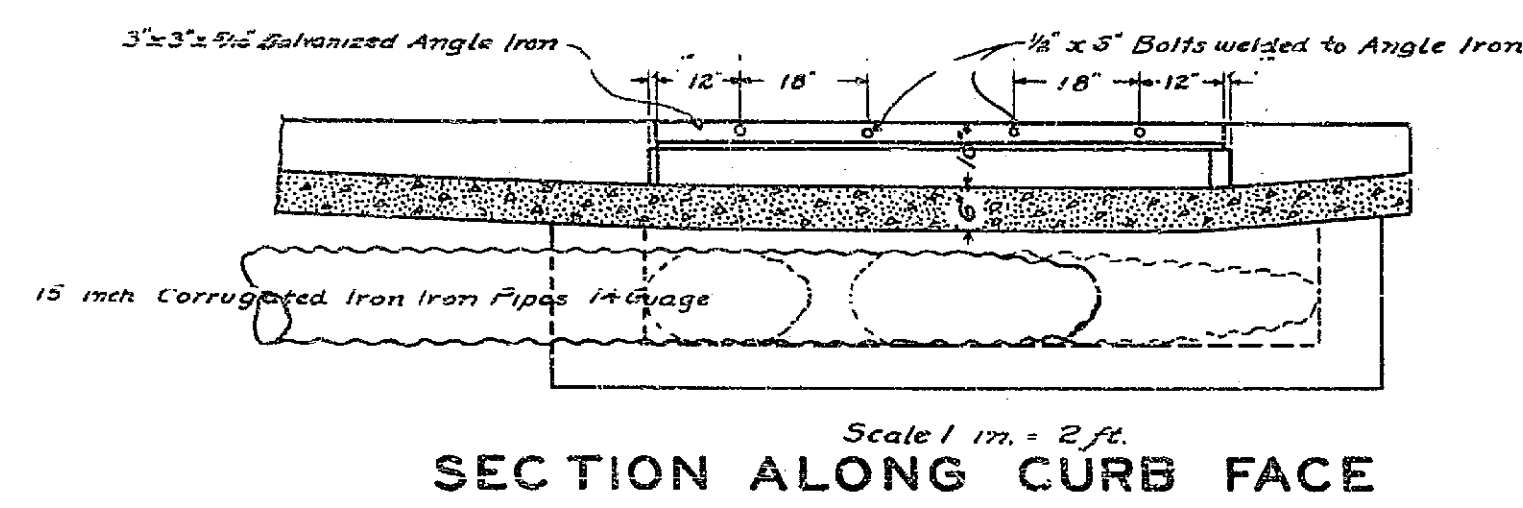

SECTION ALONG CURB FACE
 Scale 1 in. = 2 ft.

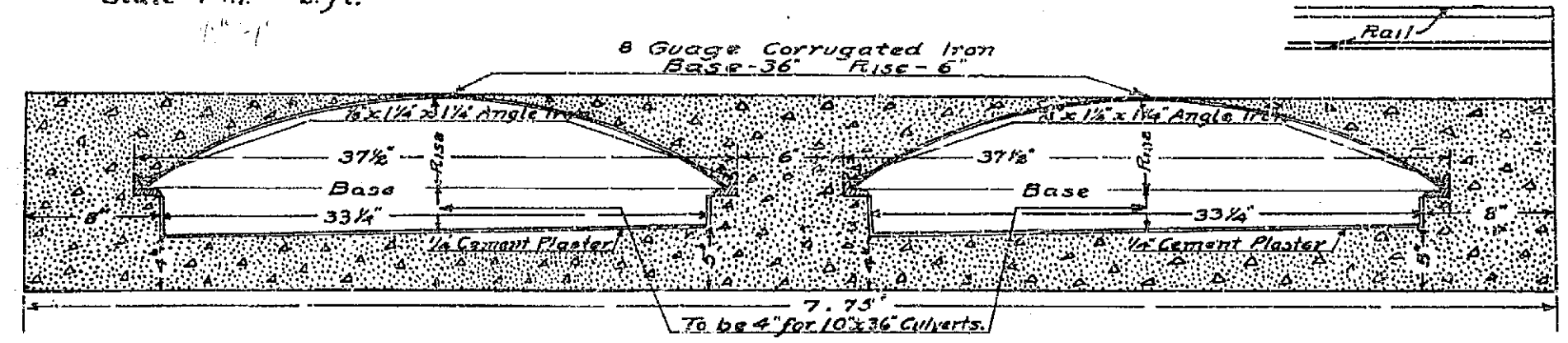

DETAILS OF IRON CROSS SECTION OF 36" CORRUGATED IRON AND CONCRETE CULVERTS.
 Scale 1 1/2 inch = 1 foot.

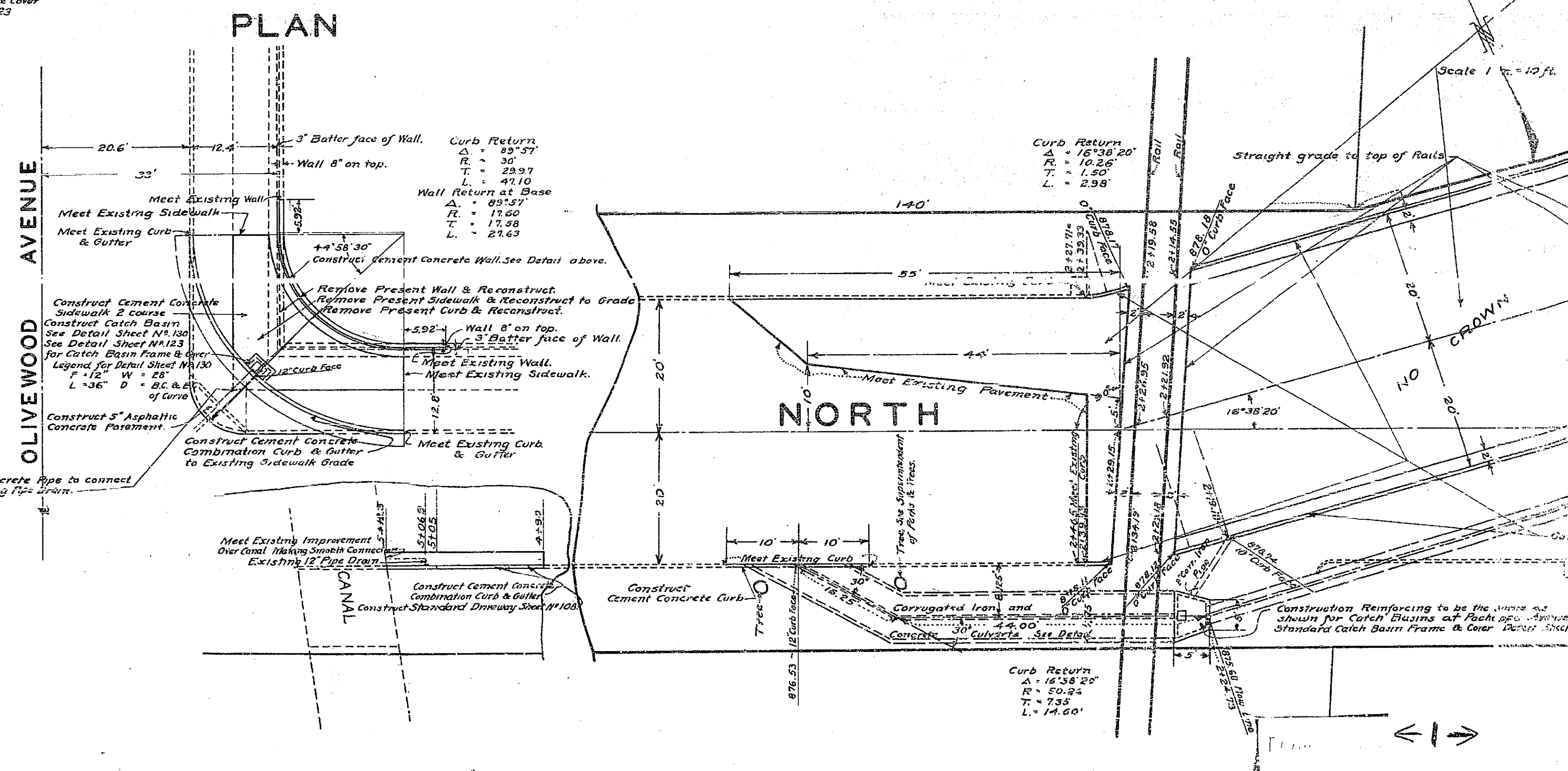

PLAN

OLIVE WOOD AVENUE

PACHAPPA AVENUE

NORTH

NO CROWN

PROFILE

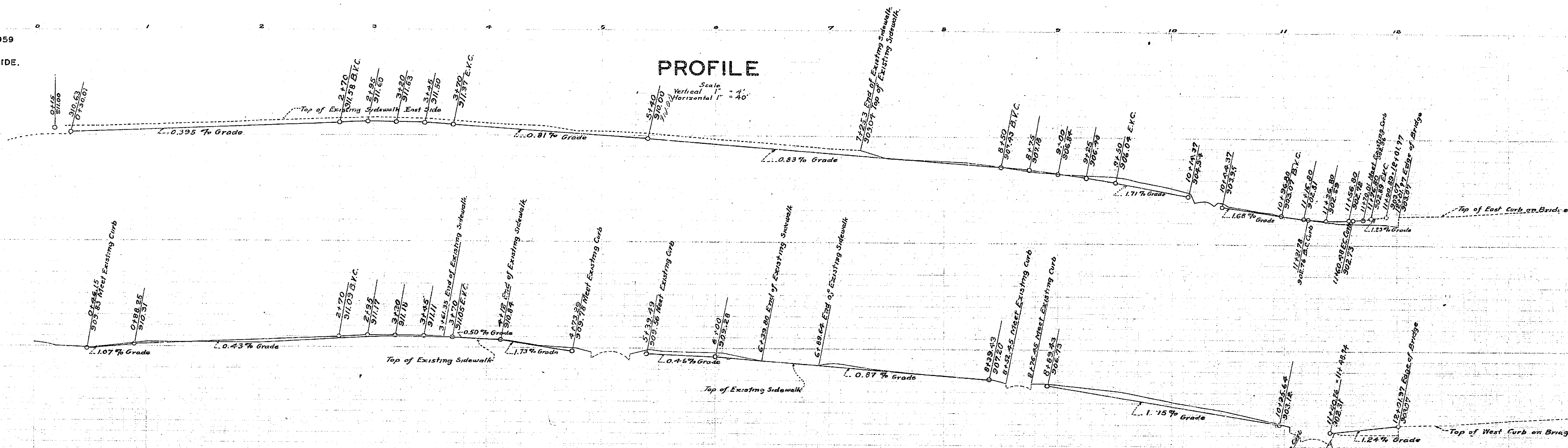

PLAN

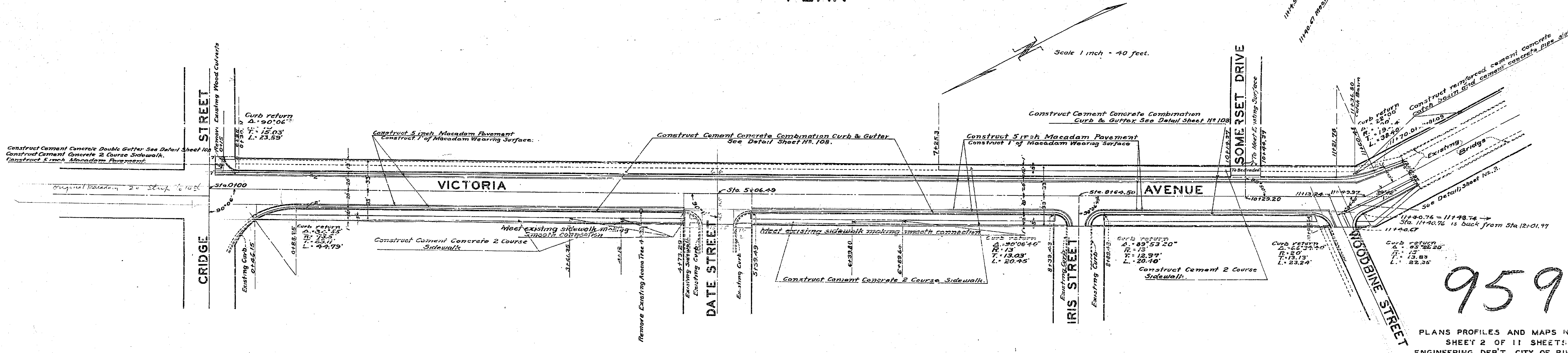

959

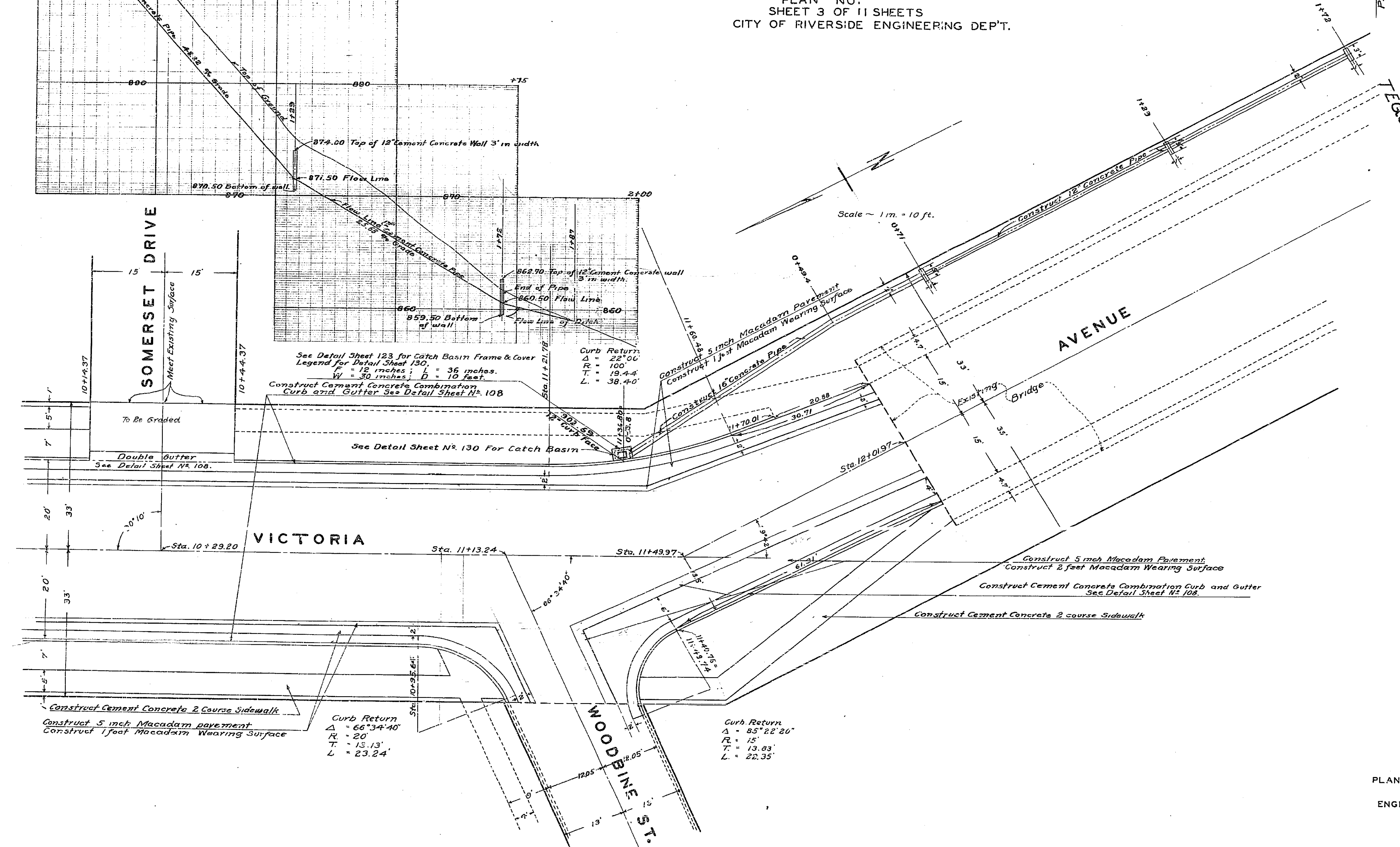
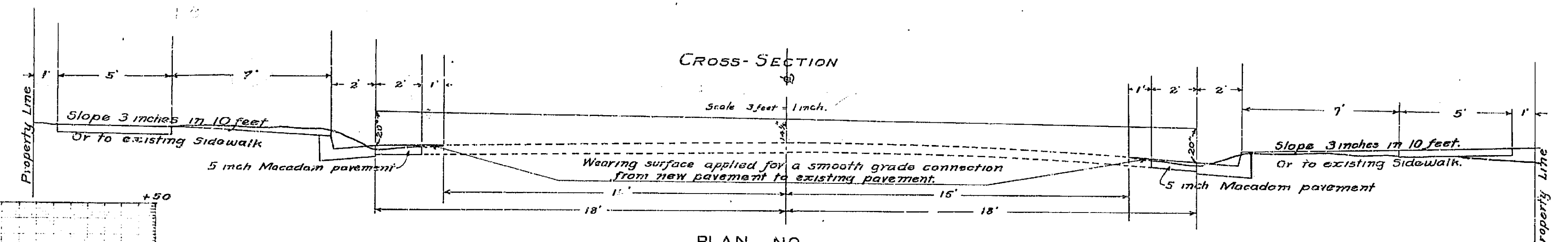
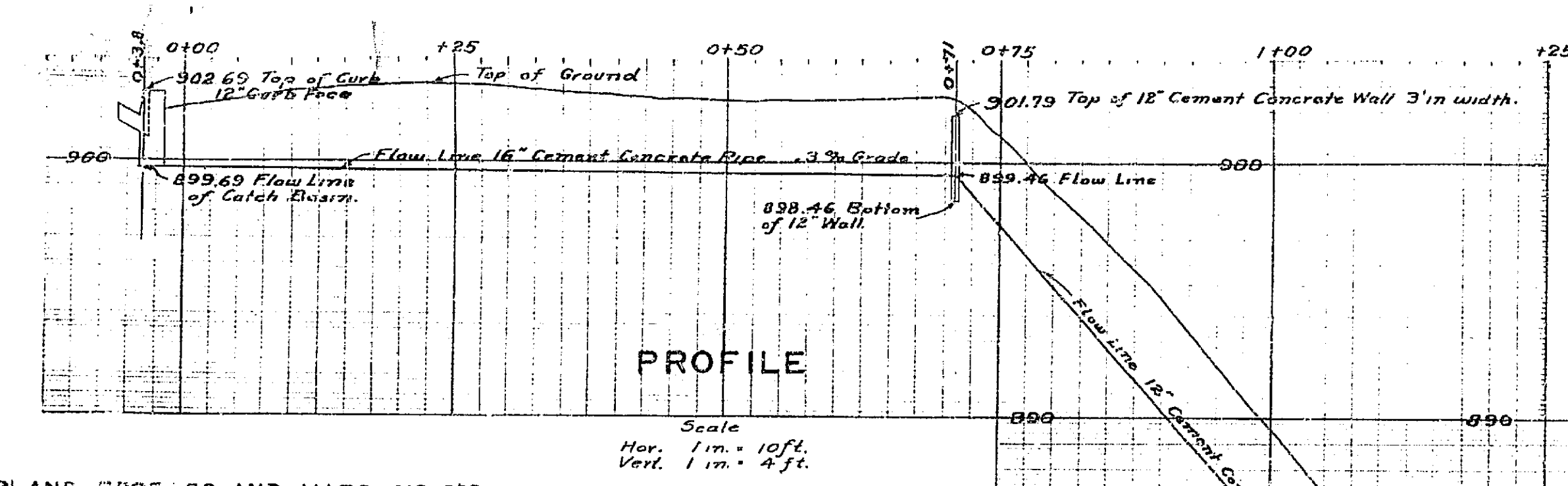

959