

43 42 41 40 39 38 37 36 35 34 33 32

PROFILE OF ARLINGTON AVE. SHOWING GRADES FOR IMPROVEMENT

Scale - Hor. - 1 in = 40'
Vert. - 1 in = 4 ft

Eng. Dept. City of Riverside April-1933

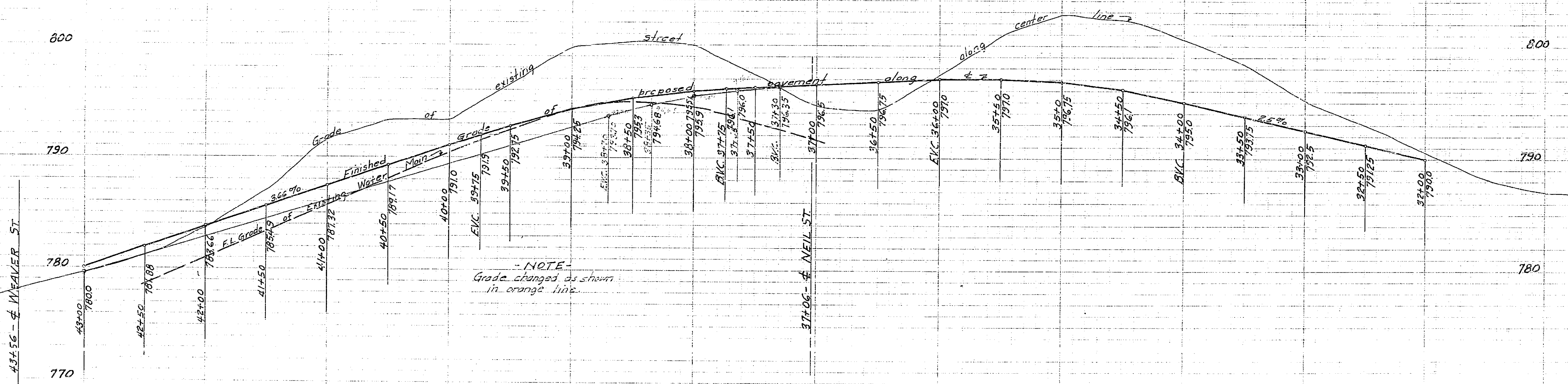

- NOTE -
Grade changed as shown
in orange line.

968 B