

HARDMAN TRACT No 2  
PLANS & PROFILES  
Jan. 1948 Scale 1"=40'  
Donald J. McKee I.S.

PROPERTY OF  
CITY OF RIVERSIDE  
CITY ENGINEERING DEPT.

PROPERTY OF  
CITY OF RIVERSIDE  
CITY ENGINEERING DEPT.

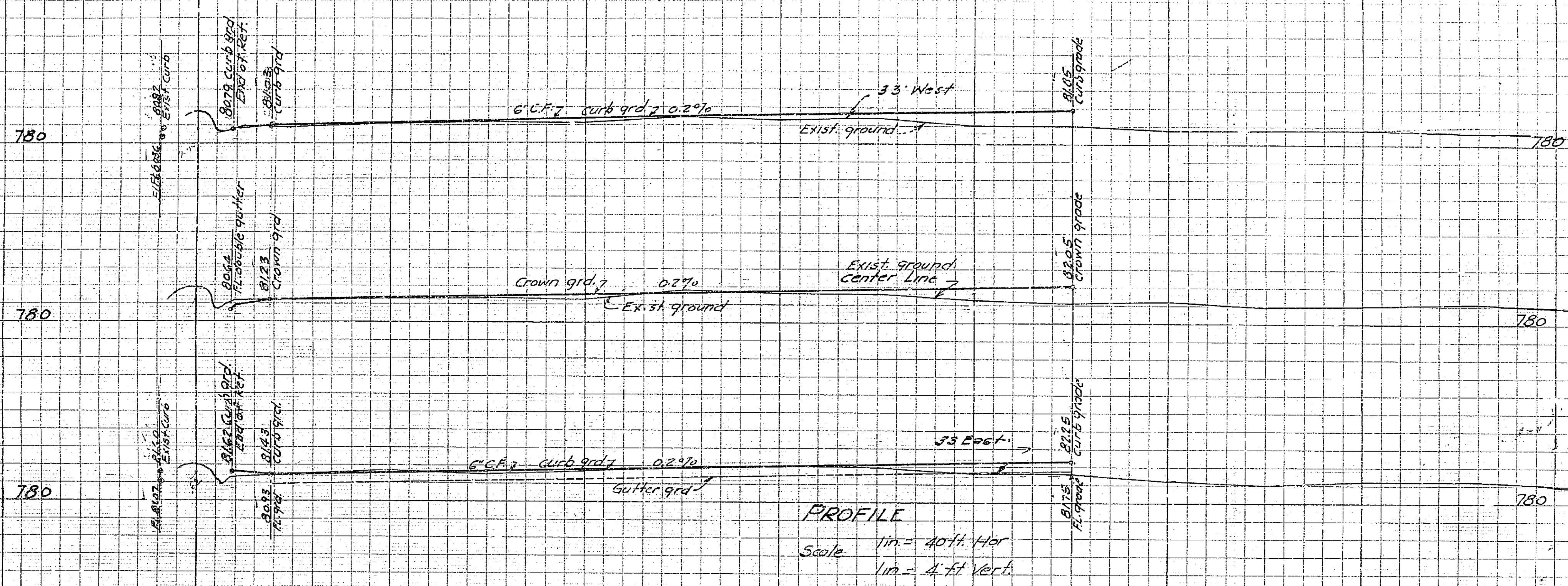

PROFILE  
Scale 1"=40ft Hor  
1"=4ft Vert

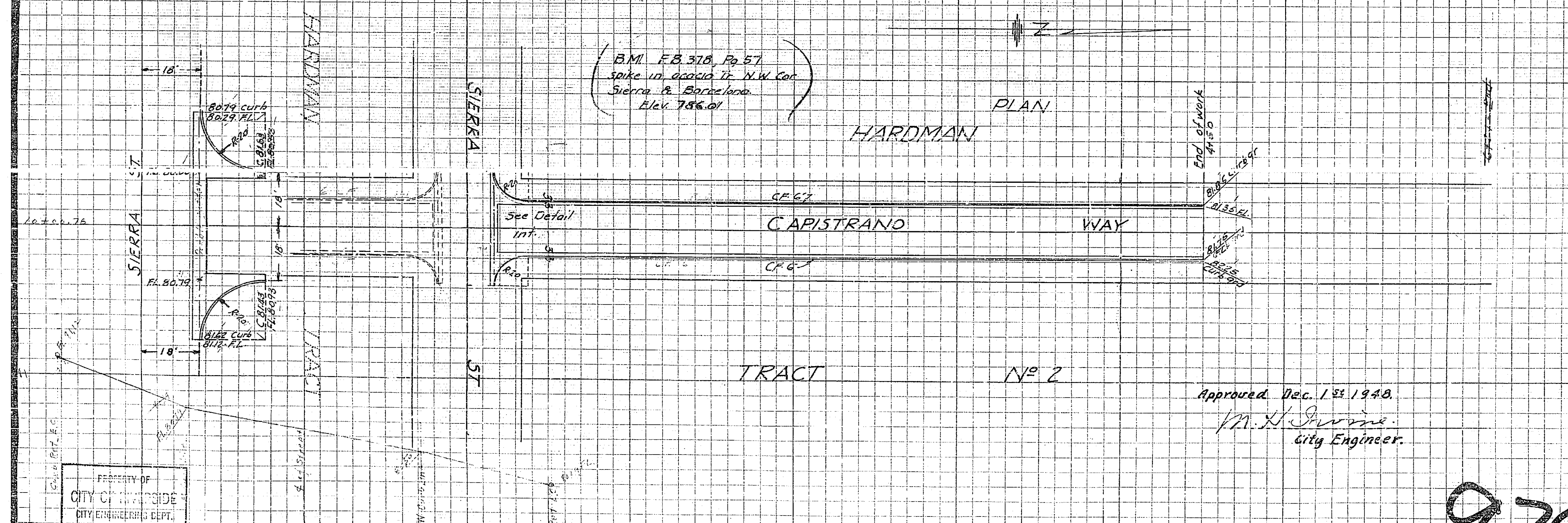

B.M. F.B. 318, Pg 57  
spike in ground at NW Cor.  
Sierra & Barcelona.  
Elev. 786.01

Approved Dec. 1<sup>st</sup> 1948  
M. H. Irvine  
City Engineer.

PROPERTY OF  
CITY OF RIVERSIDE  
CITY ENGINEERING DEPT.

PROPERTY OF  
CITY OF RIVERSIDE  
CITY ENGINEERING DEPT.

9700

PROPERTY OF  
CITY OF INVERSIDE  
CITY ENGINEERING DEPT.

PROPERTY OF  
CITY OF INVERSIDE  
CITY ENGINEERING DEPT.

PROFILE WEST to STREETER

Scale 1" = 40' Hor.  
1" = 4' Vert.

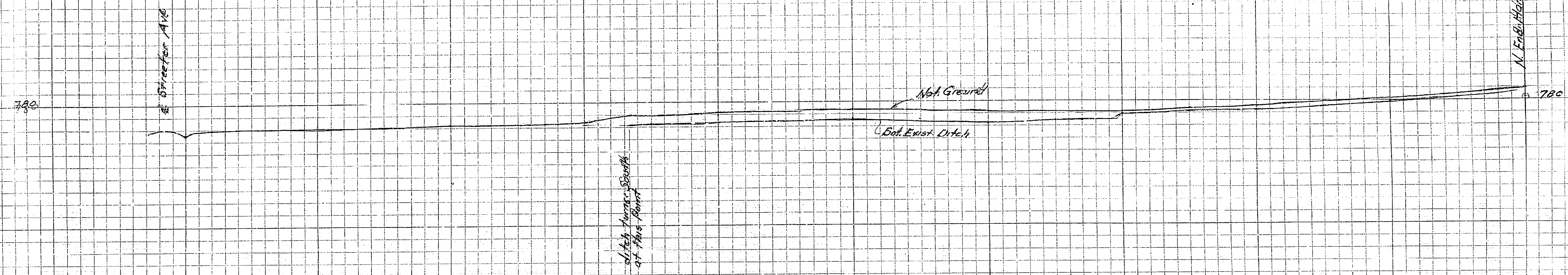

9700

PROPERTY OF  
CITY OF INVERSIDE  
CITY ENGINEERING DEPT.

PROPERTY OF  
CITY OF INVERSIDE  
CITY ENGINEERING DEPT.