

3-178

3-178

PROPOSED CHANGE IN ISLANDS
 IN FIRST ST.
 AT MAIN AND MARKET STS.
 BEING A PORTION OF STATE HIGHWAY NO. 43

ENGINEERING DEPT CITY OF RIVERSIDE
 MAY 1940

REGISTERED CIVIL ENG. NO. 1312

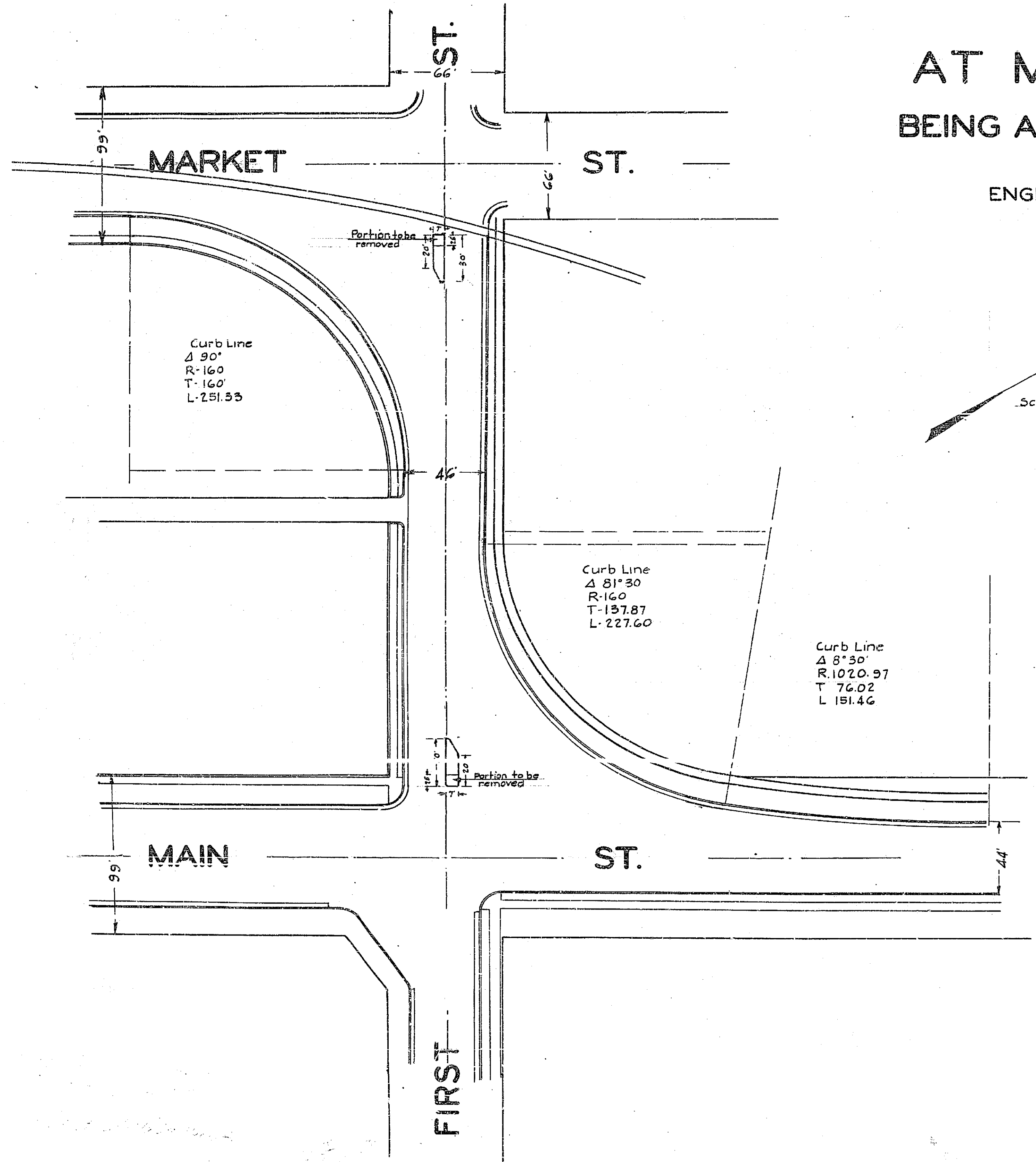

Scale: 1 in. = 40 ft.

97/C

3-178

3-178