

PROFILE
EIGHTH STREET
BETWEEN
MULBERRY ST. & CORN AVE.
Eng. Dept - City of Riverside

Field Books
E. Survey 250
Topography 250 July 1931
Levels 250

Surveyed By Butler
Platted By Wright

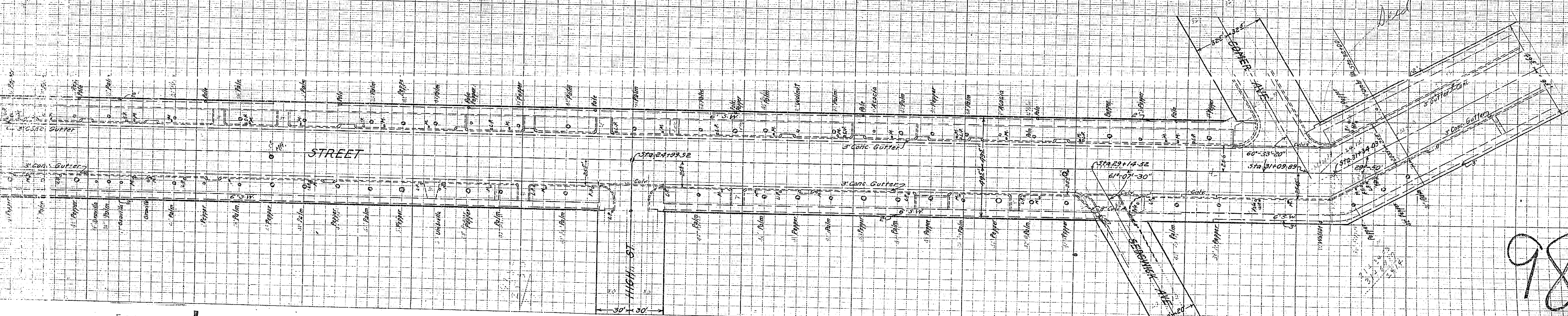
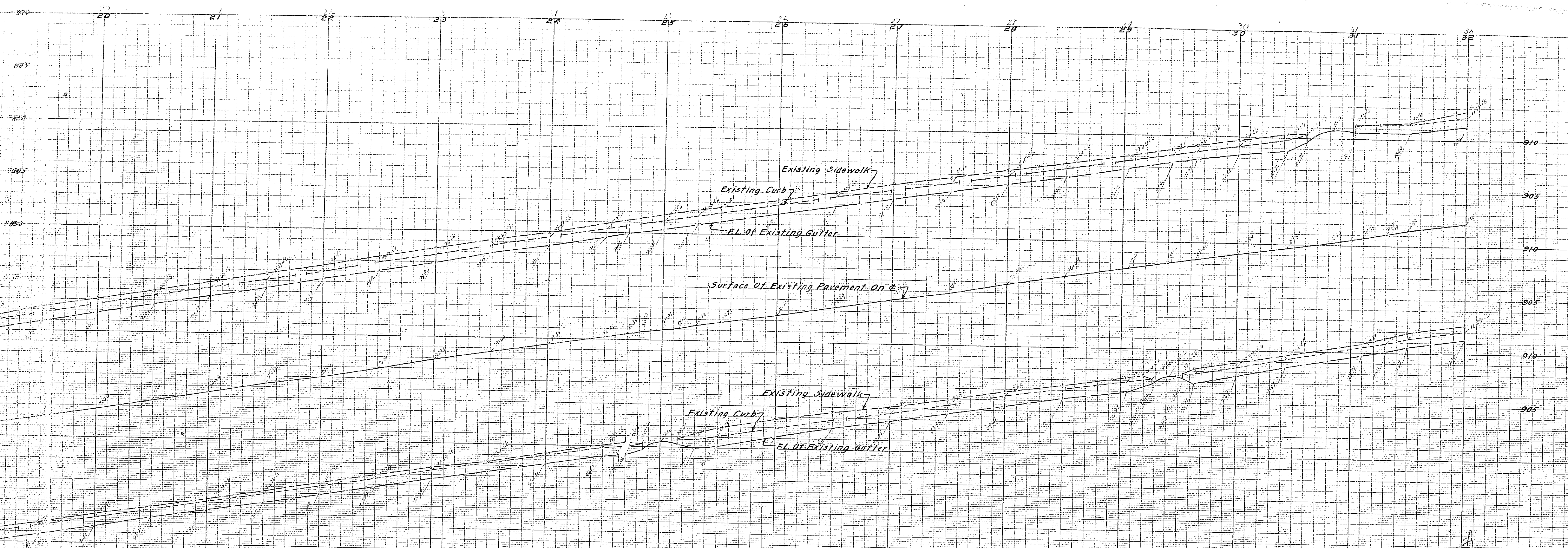

9877

FRAME 1 of 3 | 5.5' — 25.5'

"DIEPO" DIETERICH-POST CO.
PROFILE PLATE A.

250
250
1931

"DIE"

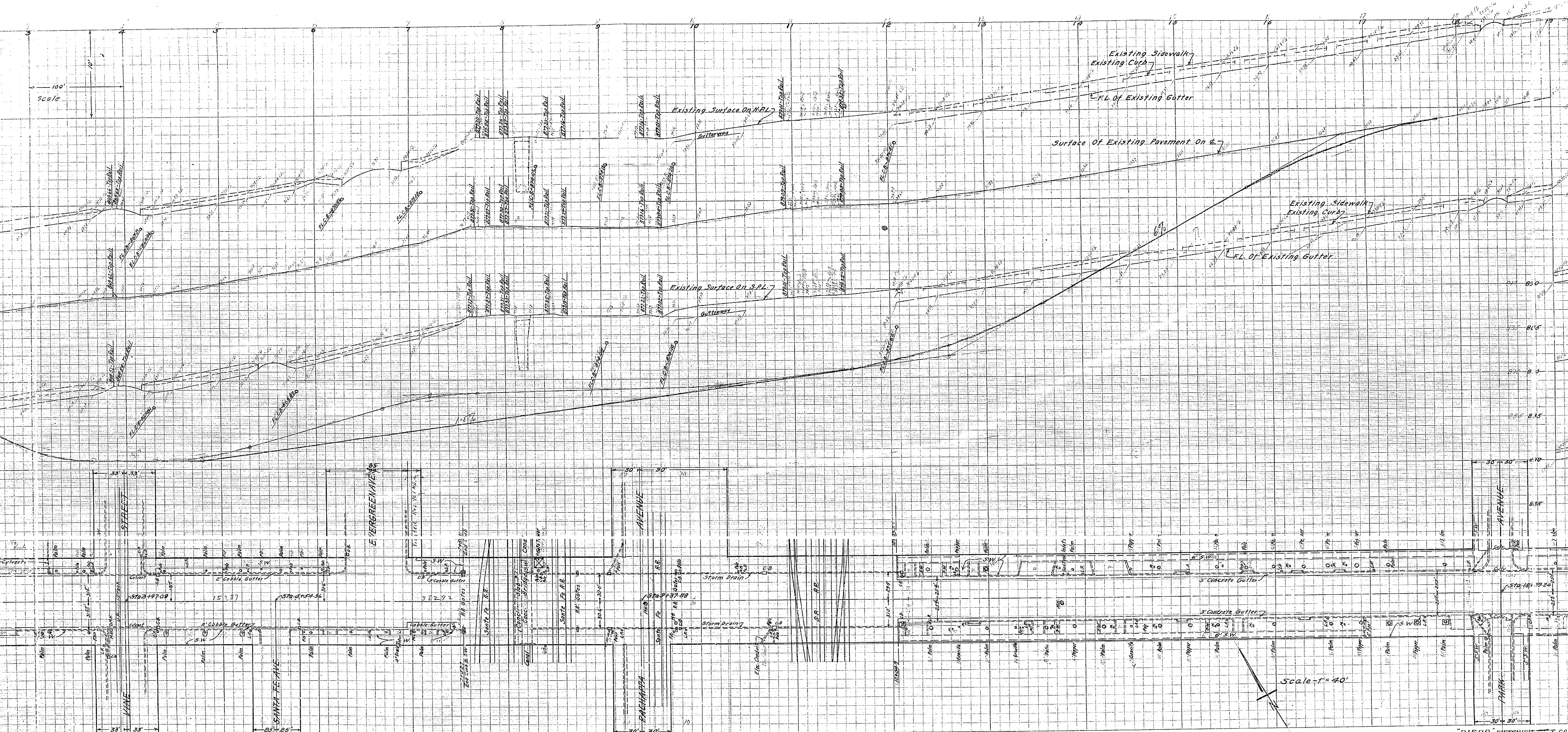

DIETZ-DIETERICH-POST CO. PROFILE PLATE A.

FRONT 215

545496
349764
15181

9737.88
5454.96
3497.64
1518.1

9437.97
2447.24
46.77

4437.87
272.72
116.72

51.2

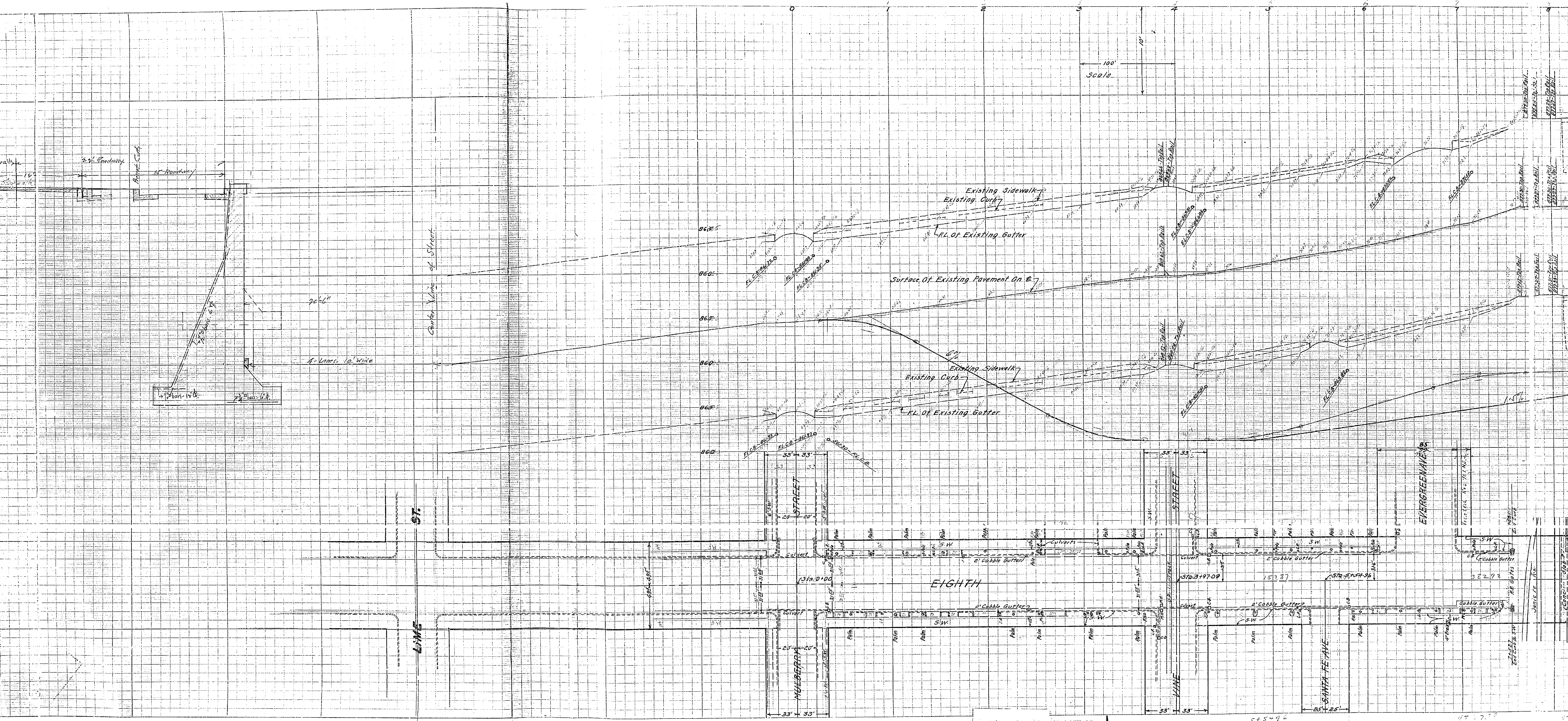

100'
Scale

20'-0"
A-Lines 10' Wide

Center Line of Street

Existing Sidewalk
Existing Curb
C.L. of Existing Gutter

Surface of Existing Pavement on E

Existing Sidewalk
Existing Curb
C.L. of Existing Gutter

EIGHTH

EVERGREENWAY

PLANS 311-POST
E.A.

5+5-96
3+97.09
1 5137

47 1 2 3 4 5 6 7 8 9 10 11 12 13 14 15 16 17 18 19 20 21 22 23 24 25 26 27 28 29 30 31 32 33 34 35 36 37 38 39 40 41 42 43 44 45 46 47 48 49 50 51 52 53 54 55 56 57 58 59 60 61 62 63 64 65 66 67 68 69 70 71 72 73 74 75 76 77 78 79 80 81 82 83 84 85 86 87 88 89 90 91 92 93 94 95 96 97 98 99 100