

EIGHTH STREET			
PACHAPPA AVE. TO KANSAS AVE.			
Drawing No.	Sheet No.	Total Sheets	Field Book
987	1	3	250
Designed		Checked	
W.A.H. 11.2.30		H.L. Lundy 11.2.30	

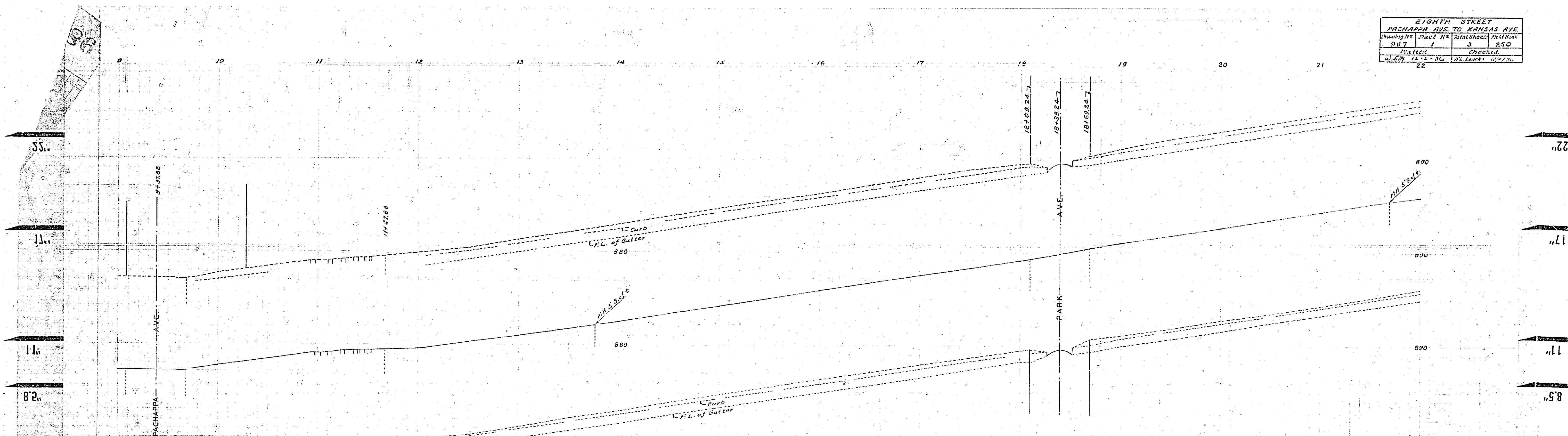

PLAN AND PROFILE
OF THE PROPOSED IMPROVEMENT ON
EIGHTH STREET
BETWEEN PACHAPPA AVE. & KANSAS AVE.

ENGINEER DEPT. RIVERSIDE CALIF. 1936.
CITY (U.S.G.S.) DATUM PLANE
FIELD BOOK 250 PAGES 6-75

SCALE HOR. 1" = 10'
VER. 1" = 4'

APPROVED *[Signature]*
CITY ENGINEER.

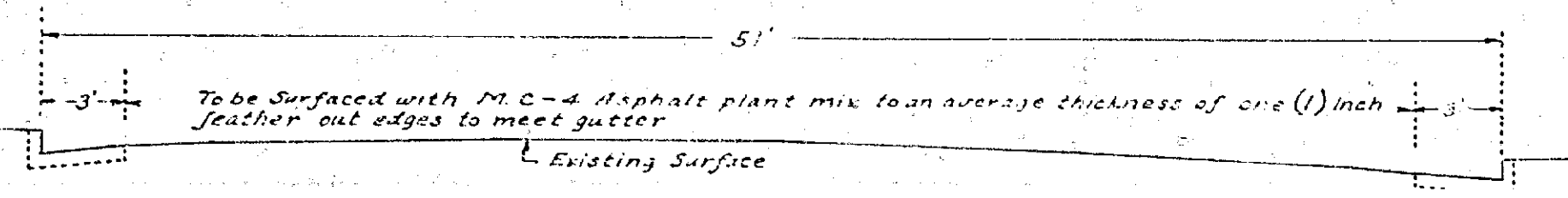

TYPICAL SECTION
West of Angle near Comer Ave.

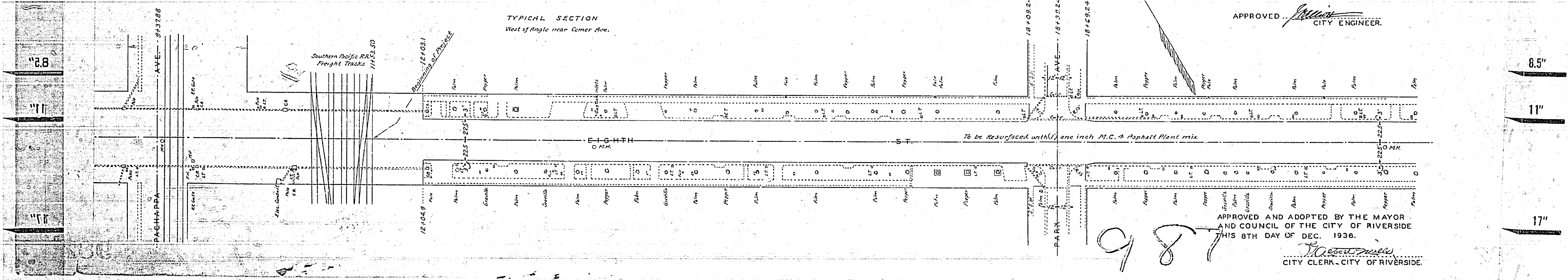

APPROVED AND ADOPTED BY THE MAYOR
AND COUNCIL OF THE CITY OF RIVERSIDE
THIS 8TH DAY OF DEC. 1936.

[Signature]
CITY CLERK, CITY OF RIVERSIDE.

987

EIGHTH STREET			
DACHSUNG AVE TO KANSAS AVE			
Drawing No.	Sheet No.	Total Sheets	Total Nos.
987	2	3	250
Plotted		Checked	
(J. E. M. 12-2-26)		H. C. Lewis 12-7-26	

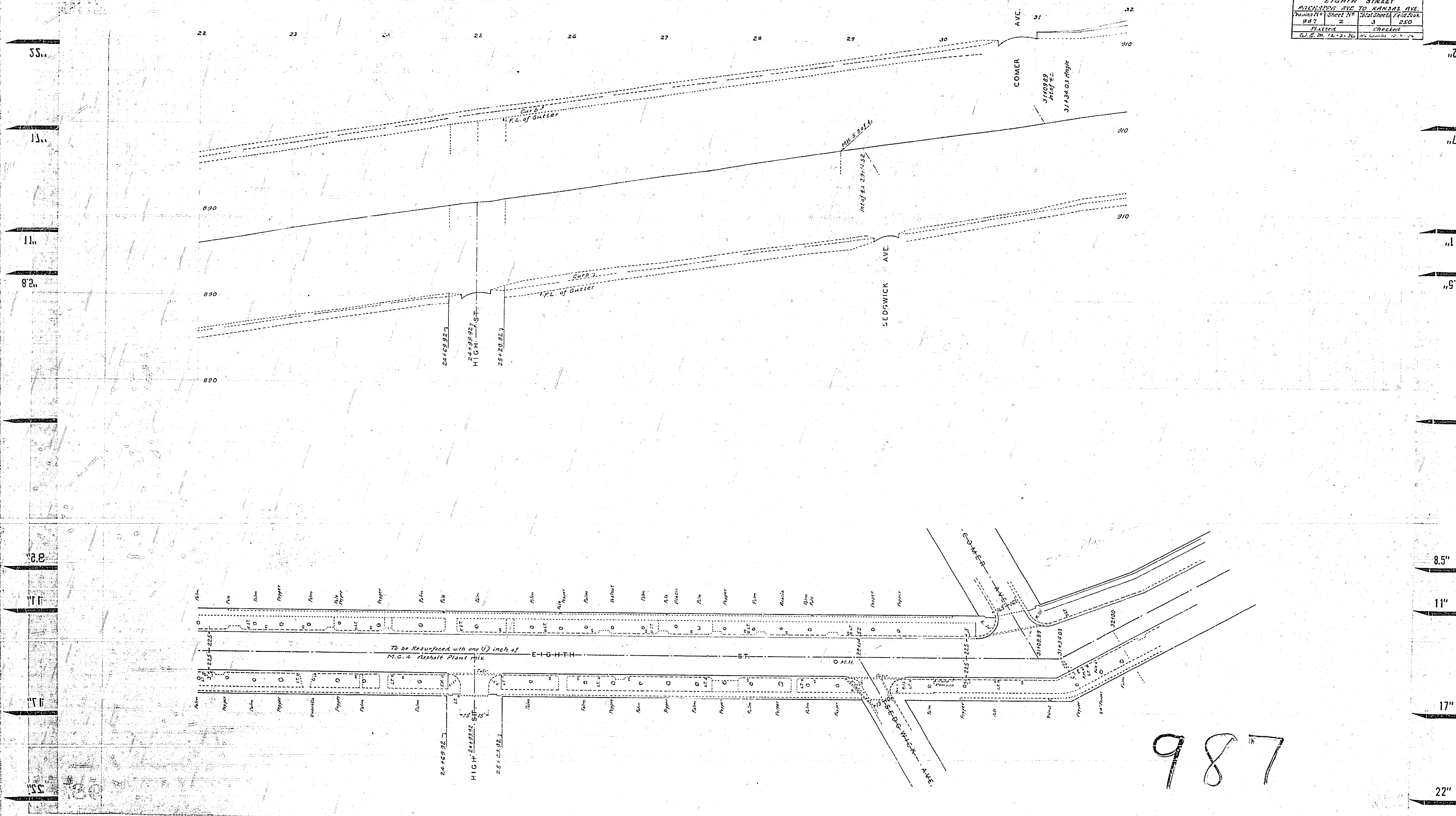

987

EIGHTH STREET PACHAPPA AVE TO KANSAS AVE			
Drawing No.	Sheet No.	Total Sheets	Field Book
287	3	3	250
Plotted	Checked		
W.E.M. 12-2-36	H.S. Lewis 12-4-36		

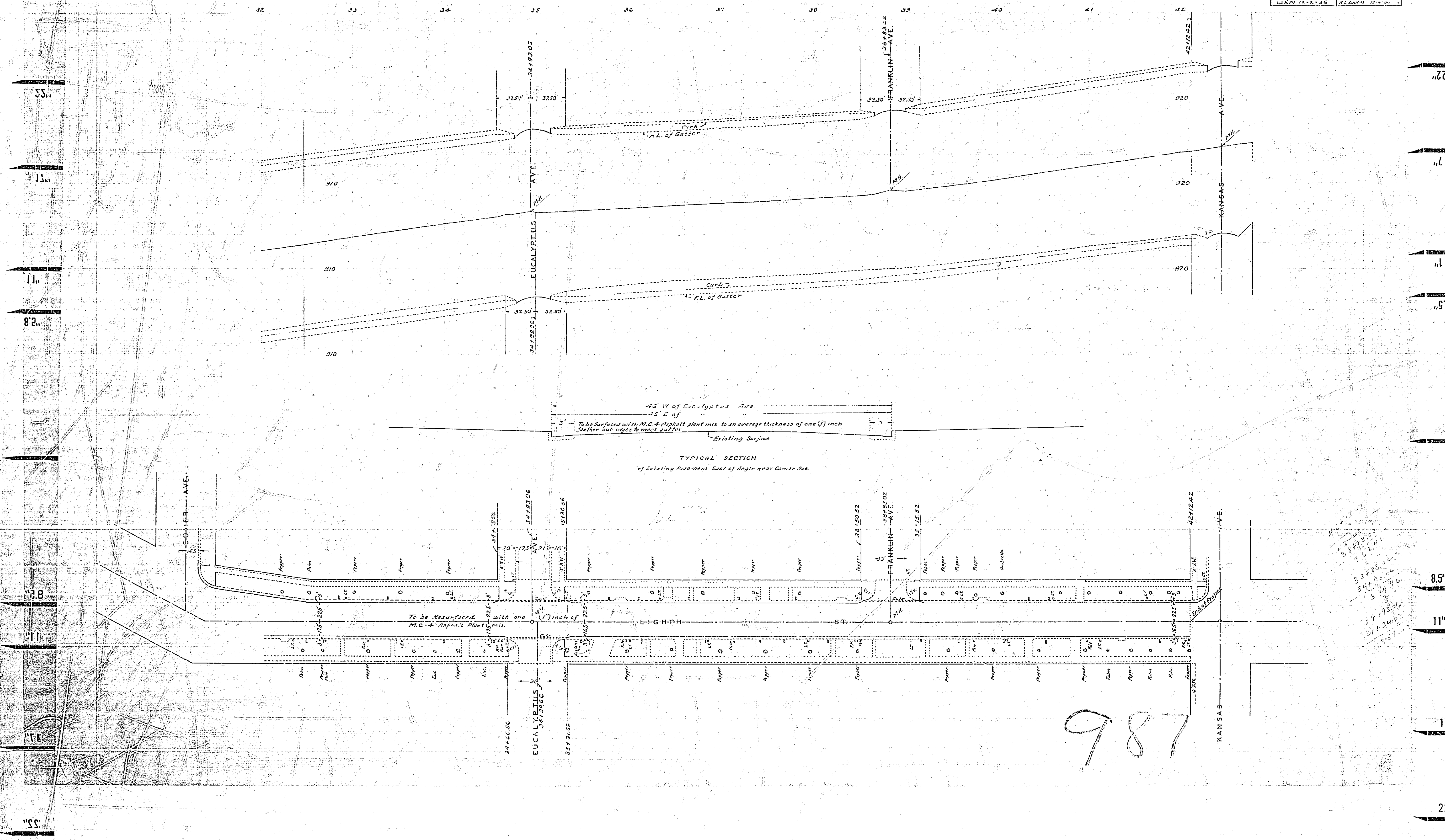

186

3478
 3479
 3480
 3481
 3482
 3483
 3484
 3485
 3486
 3487
 3488
 3489
 3490
 3491
 3492
 3493
 3494
 3495
 3496
 3497
 3498
 3499
 3500