

|                |              |              |             |
|----------------|--------------|--------------|-------------|
| DRAWING NUMBER | SHEET NUMBER | TOTAL SHEETS | FIELD BOOKS |
| 996            | 1            | 2            | 403         |
| DRAWN BY       | CHECKED BY   | APPROVED BY  |             |
| DAYTON         |              |              |             |

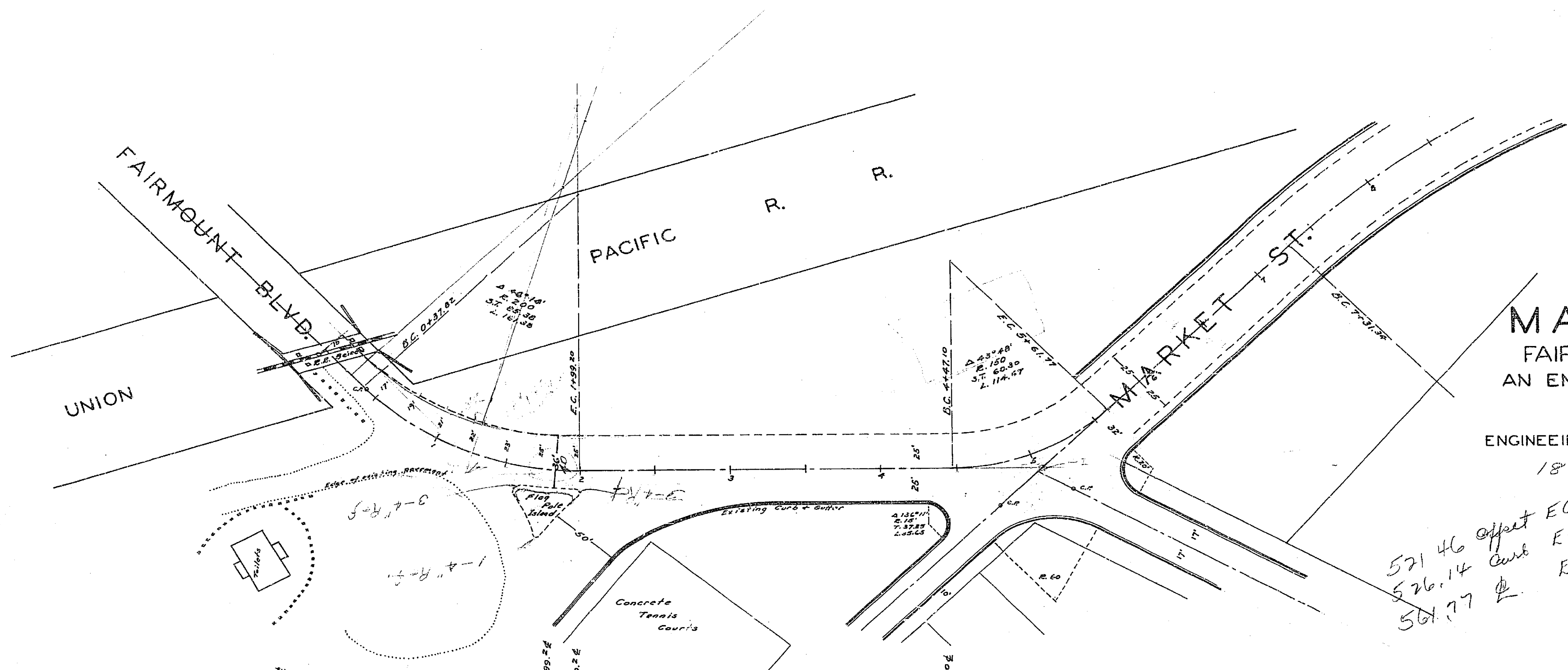

# MARKET STREET

FAIRMOUNT BLVD. TO RIDGE RD.  
AN ENTRANCE TO FAIRMOUNT PARK

ENGINEERING DEPARTMENT CITY OF RIVERSIDE CALIF.  
1850 LF, 60' Wide 12333 Sq Yds  
21000 Gal - SC 3014

571.46 Offset EC  
526.14 Curb EC  
561.77  $\Phi$  EC

10600 sq yds + Beam 19120 sqd.

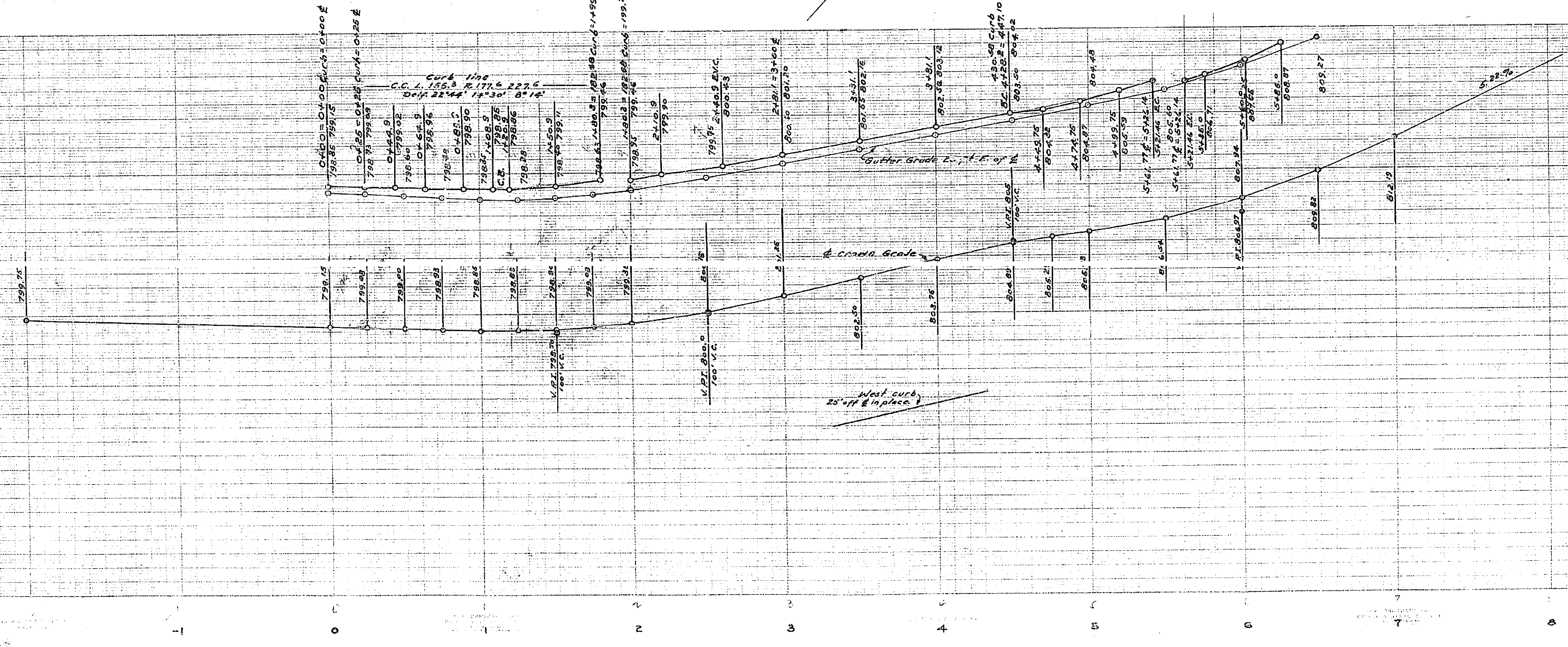

996

| DRAWING NUMBER | SHEET NUMBER | TOTAL SHEETS | FIELD BOOKS |
|----------------|--------------|--------------|-------------|
| 996            | 2            | 2            | 468         |
| DRAWN BY       | CHECKED BY   | APPROVED BY  |             |
| DAYTON         |              |              |             |

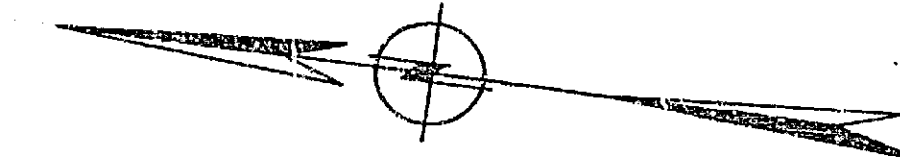

SCALE = 1" = 40'

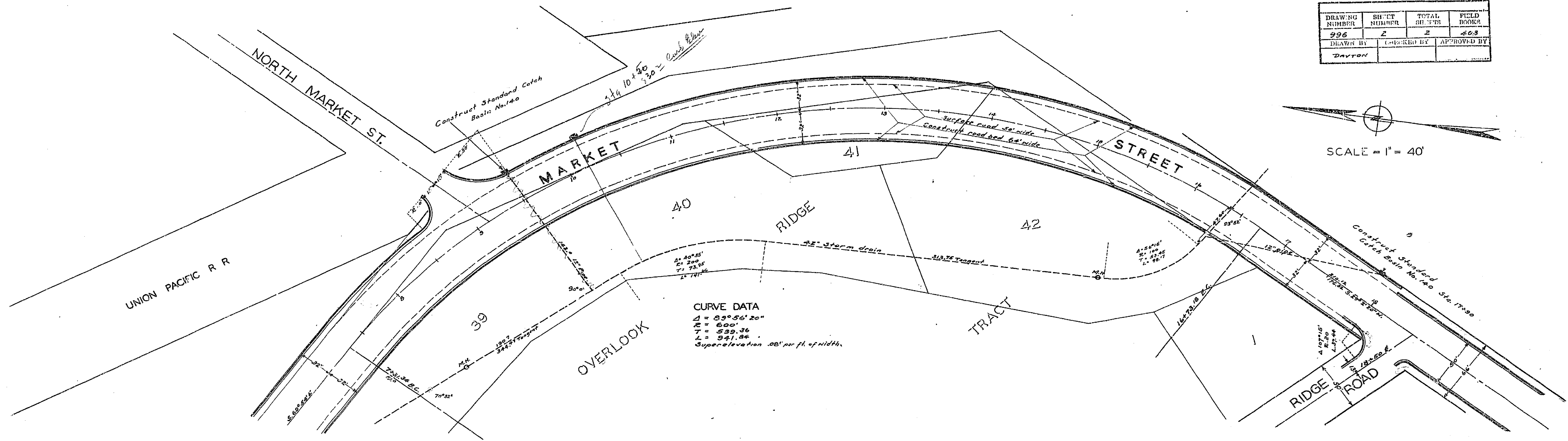

**CURVE DATA**  
 $\Delta = 85^\circ 56' 20''$   
 $R = 600'$   
 $T = 539.36'$   
 $L = 341.84'$   
 Superelevation .08' per ft. of width.

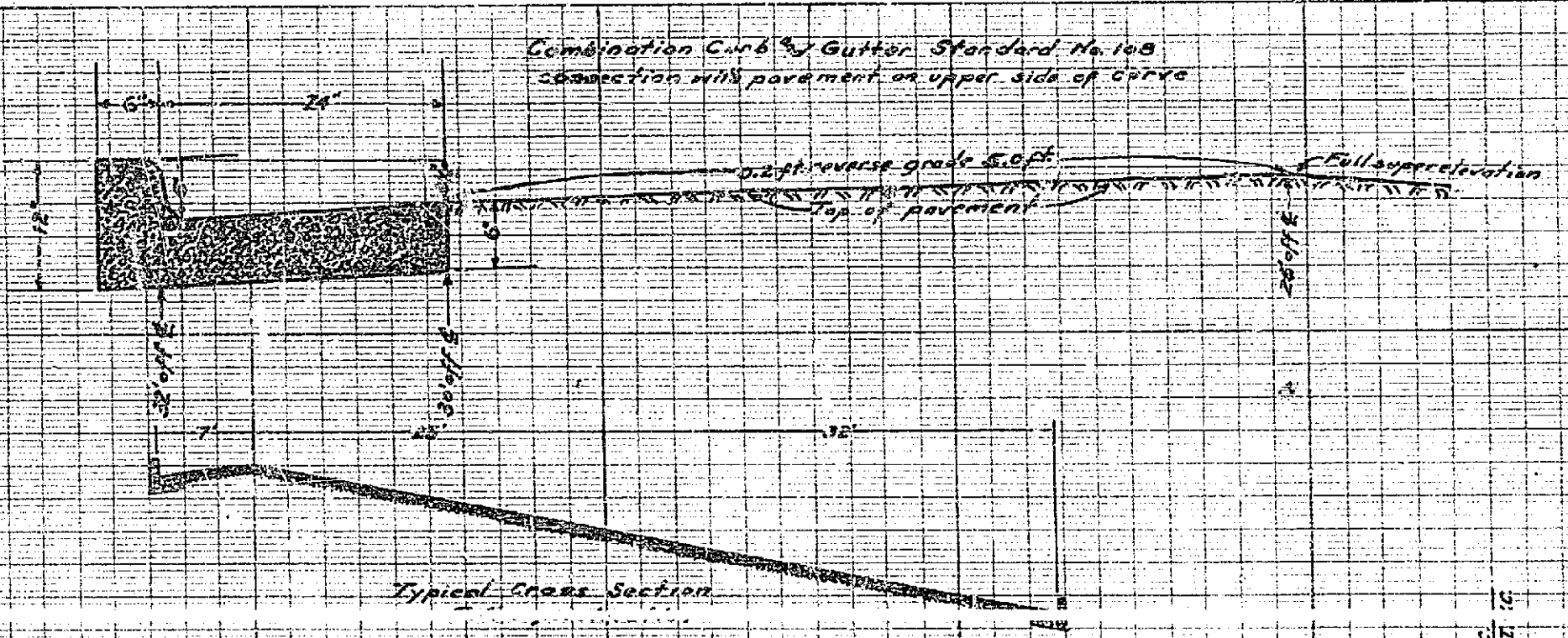

Typical Cross Section

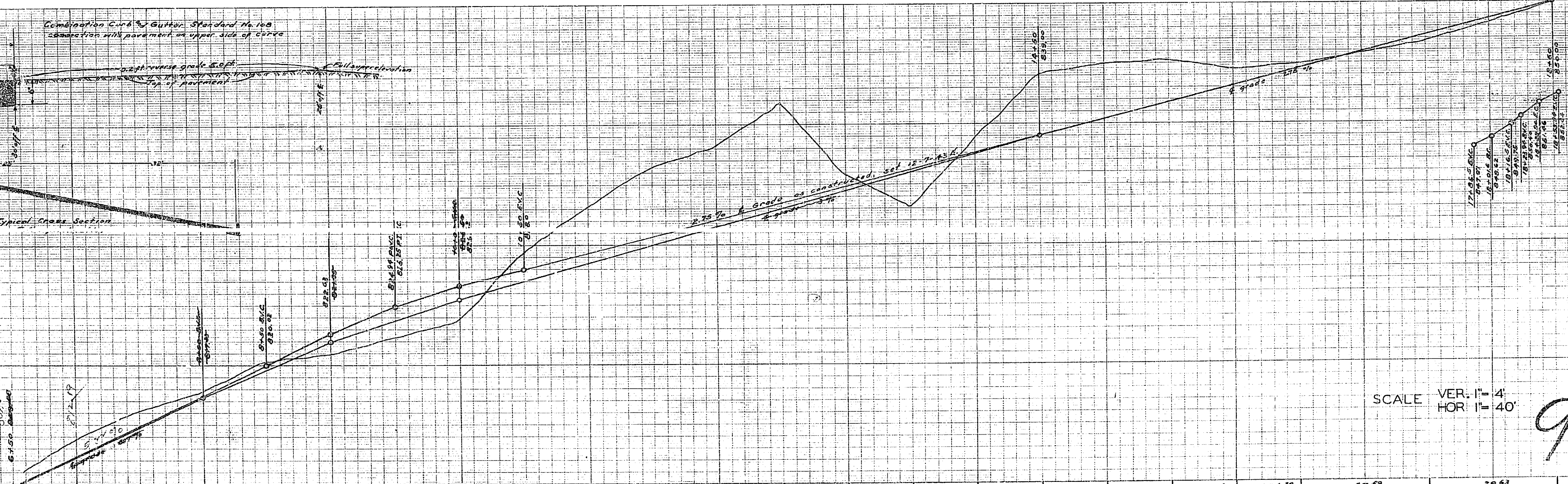

SCALE VER: 1" = 4'  
 HOR: 1" = 40'

996

| CU. YDS | EX.   | EMB.  | STR.  | 6     | 7      | 8      | 9      | 10     | 11     | 12     | 13     | 14     | 15     | 16     | 17     | 18     |        |        |        |        |       |       |
|---------|-------|-------|-------|-------|--------|--------|--------|--------|--------|--------|--------|--------|--------|--------|--------|--------|--------|--------|--------|--------|-------|-------|
|         | 30.23 | 99.57 | 80.56 | 39.01 | 41.67  | 108.33 | 163.91 | 229.17 | 381.48 | 564.16 | 850.00 | 298.15 | 758.35 | 453.37 | 490.28 | 389.81 | 516.20 | 325.90 | 293.14 | 124.39 | 67.59 | 29.63 |
|         | 27.00 | 3.24  | 8.80  | 38.43 | 208.33 | 387.86 | 478.70 | 468.52 | 228.24 | 25.74  | —0—    | 40.74  | 186.74 | 232.41 | 471.40 | 618.06 | 370.93 | 235.19 | 494.48 | 741.27 | 99.07 |       |