

DRAWING NUMBER	SHEET NUMBER	TOTAL SHEETS	FILE & BOOK
398			4-21
DRAWN BY	CHECKED BY	APPROVED BY	
R.E.O.	R.E.O.		

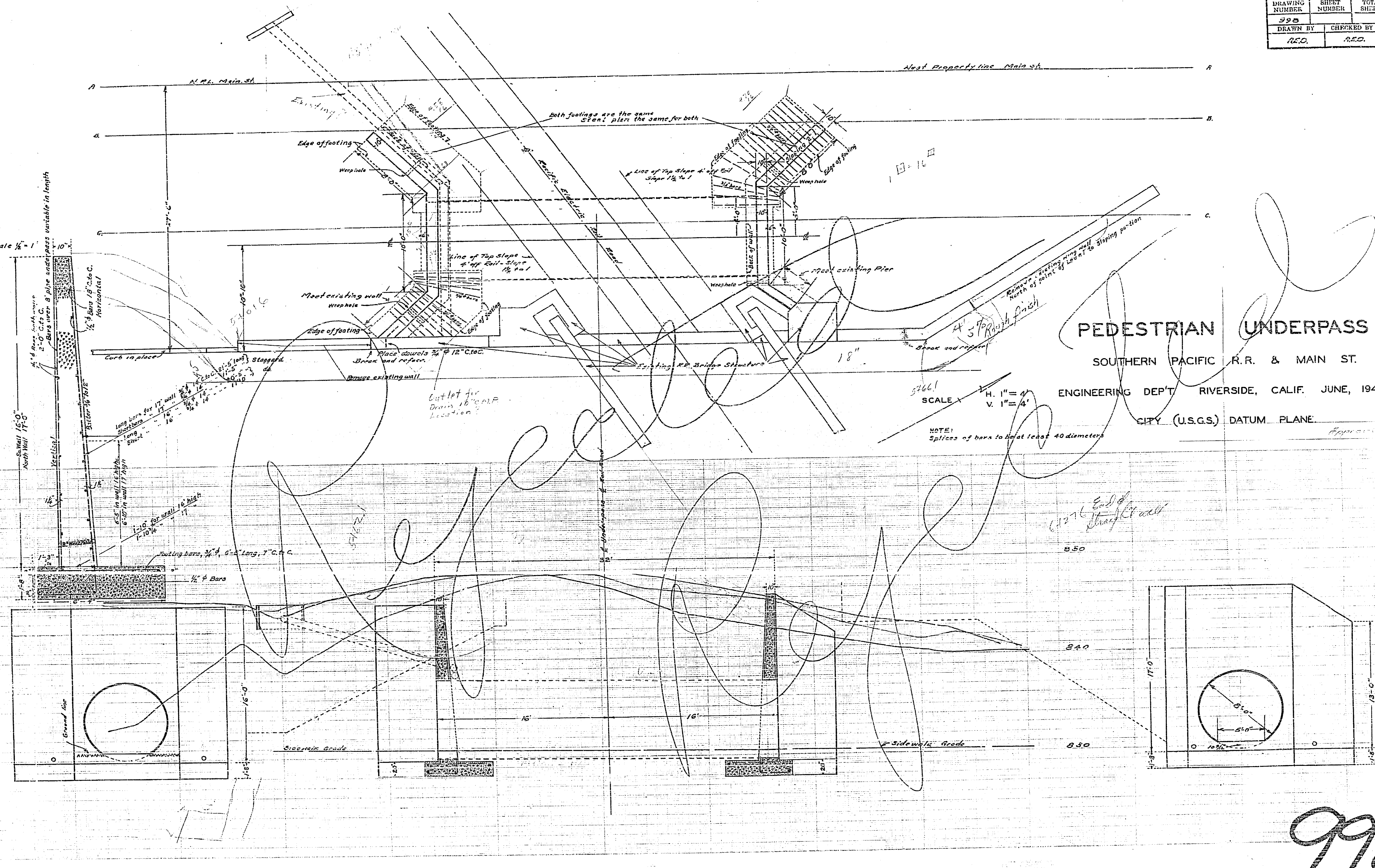

PEDESTRIAN UNDERPASS

SOUTHERN PACIFIC R.R. & MAIN ST.

ENGINEERING DEPT. RIVERSIDE, CALIF. JUNE, 1945.

CITY (U.S.G.S.) DATUM PLANE

SCALE
H. 1" = 4'
V. 1" = 4'

NOTE:
Splices of bars to be at least 40 diameters

Approved: _____
Checked: _____

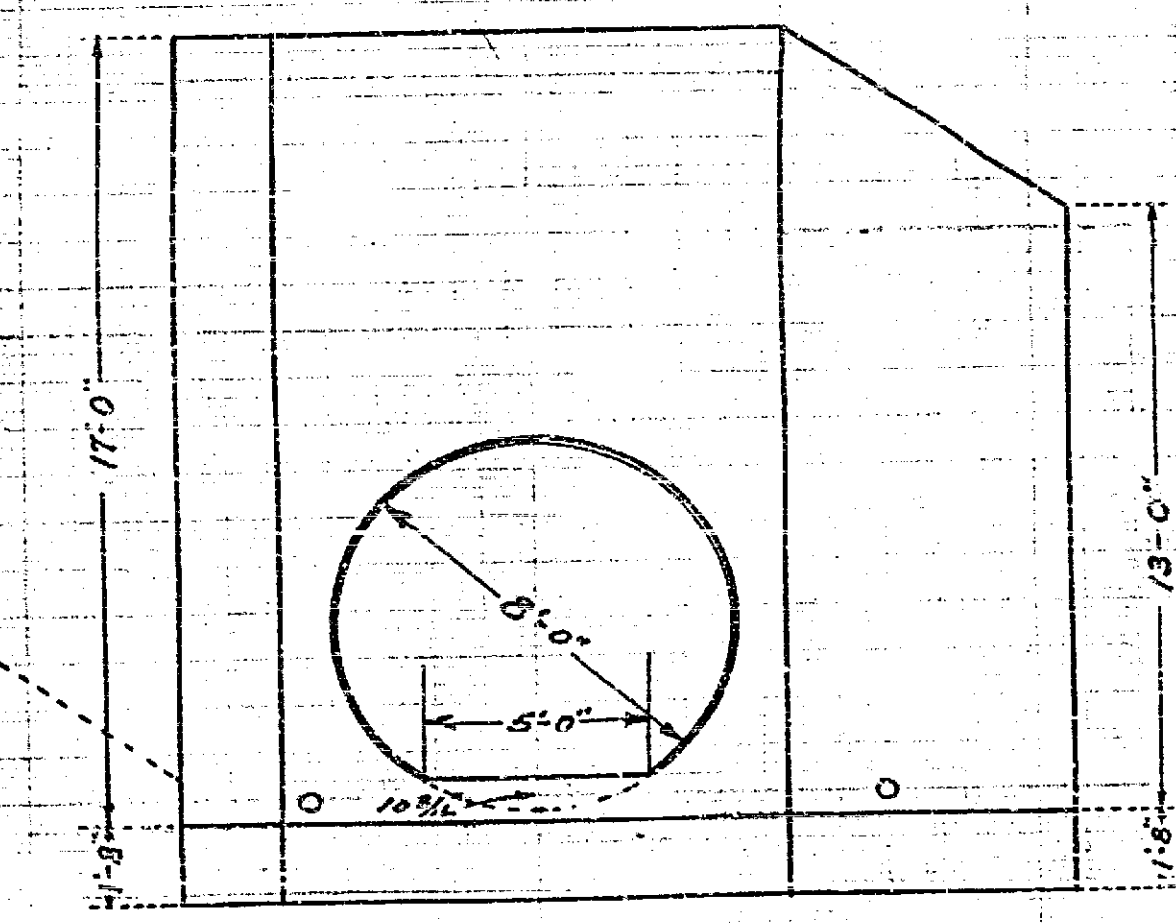

998