

OWNER'S CERTIFICATE

We hereby certify that we are the owners of or have some right, title, or interest in the land included within the land subdivided as shown on the annexed map; that we are the only persons whose consent is necessary to pass clear title to said land, and we consent to the preparation and recordation of this Parcel Map. We hereby dedicate to public use for street purposes Lot "A" and further we, the undersigned owners, our successors and assigns in interest, hereby release and relinquish to the City of Riverside, a Municipal corporation, all vehicular access rights to Parcel 2 as shown on the annexed map, on, over, and across Victoria Avenue, adjoining said parcel. We also hereby offer for dedication for construction and maintenance of electrical public utility facilities the area designated as 5' P.U.E.

Winston A. Tustison
Winston A. Tustison
Gwen L. Tustison
Gwen L. Tustison
Raymond G. Richardson
Raymond G. Richardson
Rosemarie Richardson
Rosemarie Richardson

FIRST AMERICAN TITLE INSURANCE COMPANY, a California corporation, as Trustee

James W. Penn
Asst. Sec.

NOTARY ACKNOWLEDGEMENT

STATE OF CALIFORNIA }
COUNTY OF RIVERSIDE } ss

On this 20th day of December, 1978, before me, Agnes H. Palmer a Notary Public in and for said County and State, personally appeared Winston A. Tustison and Gwen L. Tustison known to me to be the persons whose names are subscribed to the within instrument and acknowledged to me that they executed the same.

WITNESS my hand and official seal.

My commission expires on 12/4/79.

Agnes H. Palmer
Notary Public in and for said County and State

NOTARY ACKNOWLEDGEMENT

STATE OF CALIFORNIA }
COUNTY OF RIVERSIDE } ss

On this 20th day of December, 1978, before me, Agnes H. Palmer a Notary Public in and for said County and State, personally appeared Raymond G. Richardson and Rosemarie Richardson known to me to be the persons whose names are subscribed to the within instrument and acknowledged to me that they executed the same.

WITNESS my hand and official seal.

My commission expires on 12/4/79.

Agnes H. Palmer
Notary Public in and for said County and State

STATE OF CALIFORNIA }
COUNTY OF RIVERSIDE } ss

On December 20, 1978, before me, the undersigned, a Notary Public in and for said State, personally appeared Roderick W. Johnson, known to me to be the Asst. V.P. President, and James W. Penn, known to me to be the Asst. Secretary of the corporation that executed the within instrument, and known to me to be the persons who executed the within instrument on behalf of the corporation therein named, and acknowledged to me that such corporation executed the within instrument pursuant to its by-laws or a resolution of its board of directors.

WITNESS my hand and official seal.

My Commission Expires August 27, 1982

Signature Vibiana V. Morones
Vibiana V. Morones
(Name Typed or Printed)

PARCEL MAP 9386

IN THE CITY OF RIVERSIDE
RIVERSIDE COUNTY, CALIFORNIA

BEING A DIVISION OF A PORTION OF LOT 2 OF BLOCK 80 OF
"ARLINGTON HEIGHTS" AS SHOWN ON MAP ON FILE IN MAP BOOK-
11, PAGE 20 AND 21, RECORDS OF SAN BERNARDINO COUNTY,
CALIFORNIA. DECEMBER 1978

J. F. DAVIDSON ASSOCIATES
RIVERSIDE CALIFORNIA

PUBLIC UTILITY EASEMENTS

The City of Riverside, being the owner of the below described Easements, hereby consents to the making and filing of the annexed map.

An easement to the City of Riverside for water conduits by deed recorded March 22, 1917 in Book 458, page 289 of Deeds, Records of Riverside County, California.

EVERETT C. ROSS
Director of Public Utilities

Dated: Dec. 21, 1978

By: Emilio C. Ross

UTILITIES CERTIFICATE

I hereby certify as follows:

WATER FACILITIES

Frontage fees, acreage fees, water connection charges and Backup Facility Capacity Charges have been paid for Parcels No. 1 and No. 3. No water fees and charges have been paid for Parcel No. 2.

ELECTRIC FACILITIES

No electric fees have been paid for Parcels No. 1, No 2 and No. 3.

EASEMENTS

All Public Utility easement shown are sufficient for all requirements of Water and Electric Divisions of the Department of Public Utilities of the City of Riverside.

EVERETT C. ROSS
Director of Public Utilities

Dated: Dec. 21, 1978

By: Emilio C. Ross

CITY ENGINEER'S CERTIFICATE

This map has been examined this 3rd day of JANUARY, 1979, for conformance with the requirements of the Subdivision Map Act and Title 18 of the Riverside Municipal Code.

ROBERT C. WALES R.C.E. 18793
City Engineer

By: Robert C. Wales

TENTATIVE MAP APPROVED DECEMBER 22, 1977

CITY CLERK'S CERTIFICATE

RESOLVED: That this map, consisting of TWO (2) sheets be, and the same is hereby accepted as the final map of P.M. No. 9386 and the streets and easements are hereby accepted as public streets and easements,

and the City Clerk is hereby authorized and directed to attest said map by signing her name thereto as City Clerk of the City of Riverside, State of California, and affix the official seal of said City thereto.

I hereby certify that the foregoing resolution was accepted by the Mayor and Council of the City of Riverside this 8th day of May, 1979.

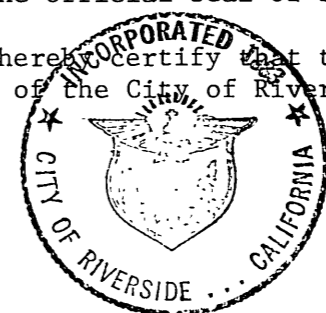

ALICE A. HARE
City Clerk of the City of Riverside, California

By: Alice A. Hare

SURVEYOR'S CERTIFICATE

This map was prepared by me or under my direction and is based upon a field survey in conformance with the requirements of the Subdivision Map Act at the request of Yeager, Ward & Tustison on March 23, 1978.

I hereby state that the parcel map procedures of the local agency have been complied with and that this parcel map conforms to the approved tentative map and the Conditions of Approval thereof which were required to be fulfilled prior to the filing of the parcel map.

12-13-1978
Date

James F. Davidson Jr.
James F. Davidson Jr., P.S. 3018

IN THE CITY OF RIVERSIDE
RIVERSIDE COUNTY, CALIFORNIA

PARCEL MAP 9386

BEING A DIVISION OF A PORTION OF LOT 2 OF BLOCK 80 OF
"ARLINGTON HEIGHTS" AS SHOWN ON MAP ON FILE IN MAP
BOOK 11, PAGES 20 AND 21, RECORDS OF SAN BERNARDINO
COUNTY, CALIFORNIA.

DECEMBER 1978

SCALE: 1"=100'

J.F. DAVIDSON ASSOCIATES

RIVERSIDE, CALIFORNIA

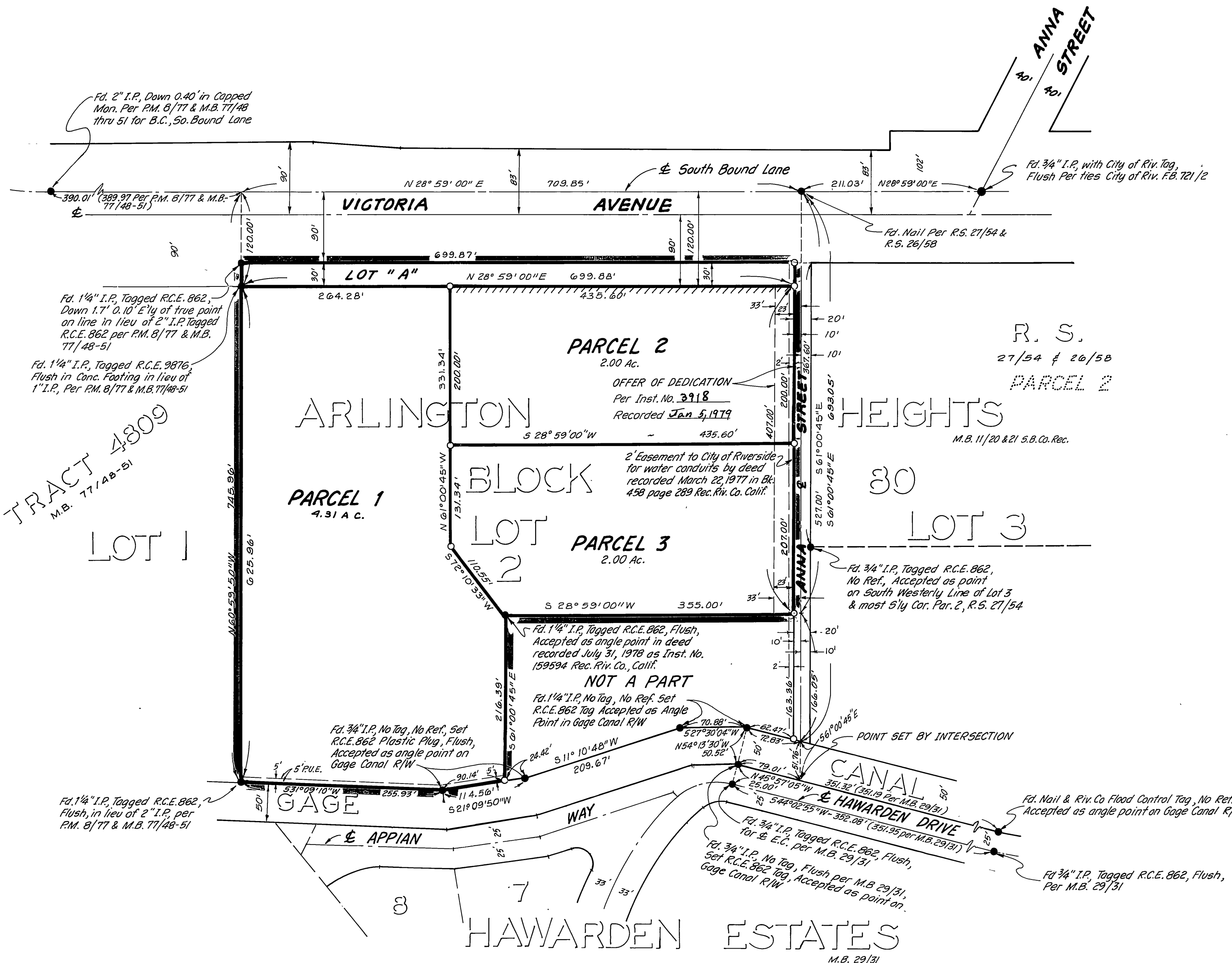
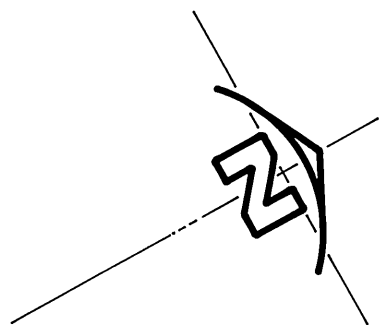

SURVEYOR'S NOTES

BASIS OF BEARINGS IS THE CENTER LINE OF
VICTORIA AVENUE TAKEN AS N 28° 59' 00" E
AS SHOWN ON RECORD OF SURVEY 27/54,
RECORDS OF RIVERSIDE COUNTY, CALIFORNIA

- INDICATES MONUMENTS FOUND AS NOTED
 - INDICATES SET 3/4" IRON PIPE WITH PLASTIC PLUG STAMPED R.C.E. 862
 - TTTT INDICATES VEHICULAR ACCESS RIGHTS WAIVED
- THIS TRACT CONTAINS 8.79 ACRES

TRACT 4809
M.B. 77/48-51
LOT 1

PARCEL 2
2.00 Ac.

PARCEL 1
4.31 A.C.

PARCEL 3
2.00 Ac.

R. S.
27/54 & 26/58
PARCEL 2

NOT A PART

P.M. 65/4

9-5-6

P.M. 65/4