

088710

Recording requested by:

And when recorded, mail to:

City of Riverside
Public Works Department
3900 Main Street
Riverside, California 92522

RECEIVED FOR RECORD
AT 8:00 O'CLOCK

MAR 16 1992

Recorded in Official Records
of Riverside County, California

Recorder
Fees \$ 14

FOR RECORDER'S OFFICE USE ONLY

PROJECT: PMW for R-28-901
Tenth St. between Commerce St. & Park Ave.
A.P.N 211-191-021

PLANNING COMMISSION
of the
CITY OF RIVERSIDE
CERTIFICATE OF COMPLIANCE

Property Owner(s): MAX L. CARDEY and HELEN N. CARDEY, as Trustees of
the Cardey Family 1988 Living Trust dated July 25,
1988

Pursuant to Section 18.38.030 of the Riverside Municipal Code, the
Planning Commission of the City of Riverside hereby declares that on
June 20, 1991, a waiver of parcel map for a lot line adjustment was
granted for the real property as described in Exhibit "A" attached
hereto and incorporated herein by this reference, located in the City of
Riverside, County of Riverside, State of California, which real property
as described in said Exhibit "A" thereby created complies with the
California Subdivision Map Act and Title 18 of the Riverside Municipal
Code.

THE ISSUANCE OF THIS CERTIFICATE OF COMPLIANCE DOES NOT SUPERSEDE,
MODIFY OR AFFECT ANY REQUIREMENTS OF THE BUILDING OR ZONING REGULATIONS
OF THE CITY OF RIVERSIDE.

PLANNING COMMISSION OF THE
CITY OF RIVERSIDE

MERLE G. GARDNER
PLANNING DIRECTOR

Dated: March 10, 1992

By *Kenneth R. Gutierrez*
KENNETH R. GUTIERREZ
PRINCIPAL PLANNER

STATE OF CALIFORNIA)
COUNTY OF RIVERSIDE) "

On this 10th day of March, in the year 1992,
before me, Margaret I. Archambault a Notary
Public in and for said County and State, personally appeared
Kenneth R. Gutierrez, personally known
to me to be the person who executed this instrument as
Principal Planner of the City of Riverside, on
behalf of the Planning Commission of the City of Riverside and
acknowledged to me that said Planning Commission executed the same.

Margaret I. Archambault
Notary Public in and for said
State

CARDEY.COC/a

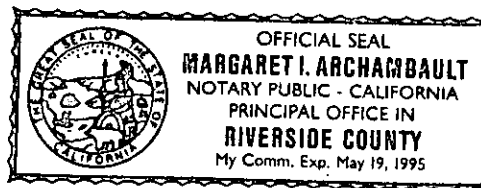

EXHIBIT "A"

Parcel 1

In the City of Riverside, County of Riverside, State of California, Section 23, Township 3 South, Range 5 West, San Bernardino Meridian, Lots 24, 25, and the southeasterly 30.00 feet of Lot 26 in Block 14 of Whites Addition as shown by map on file in Book 6 of Maps at Page 48 thereof, records of San Bernardino County, California.

Contains 0.5 acres, more or less.

DESCRIPTION APPROVAL:

3, 9, 92
George P. Hutchinson
SURVEYOR, CITY OF RIVERSIDE

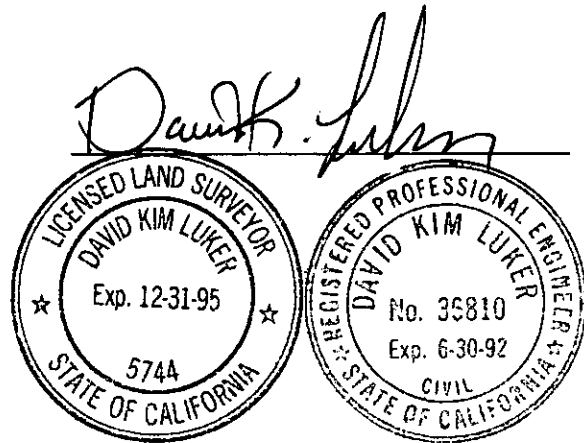

JKV/KAT
LEGAL/741P1-A
1/20/91

Commerce Street

Southerly Corner of Lot 27

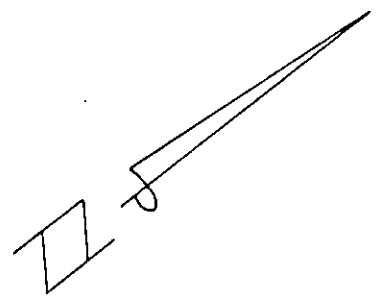

Tenth Street

Ninth Street

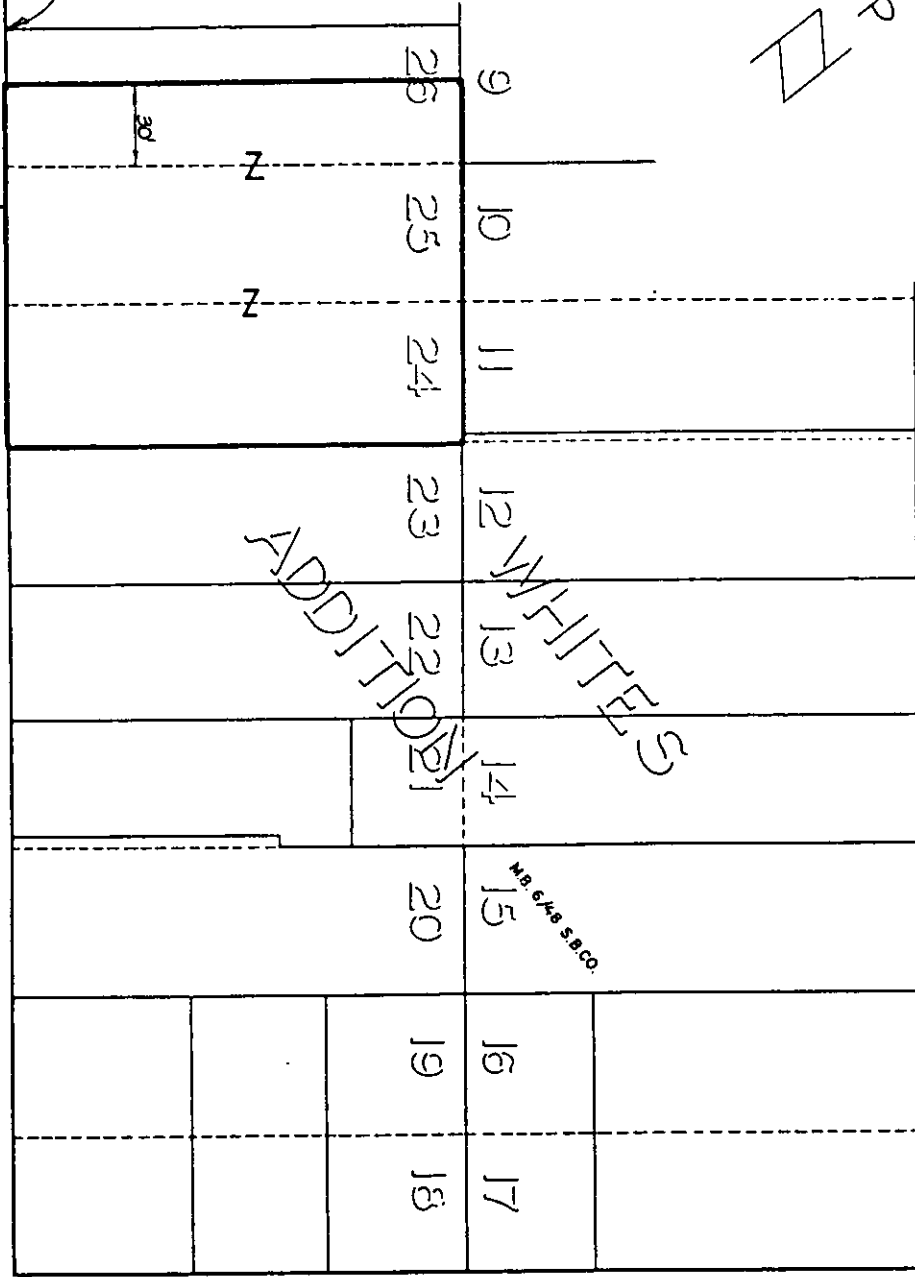

Park Avenue

• CITY OF RIVERSIDE, CALIFORNIA •

THIS PLAT IS SOLELY AN AID IN LOCATING THE PARCEL(S) DESCRIBED IN THE ATTACHED DOCUMENT. IT IS NOT A PART OF THE WRITTEN DESCRIPTION THEREIN.

SHEET 1 OF 1

3/12

SCALE: 1" = NTS

DRAWN BY KGS DATE 3/6/92

SUBJECT R-28-901

PMW-206