

GENERAL CONSTRUCTION NOTES

- 1 CONSTRUCTION SHALL BE IN ACCORDANCE WITH THE CITY OF RIVERSIDE STANDARD DRAWINGS AND STANDARD SPECIFICATIONS FOR PUBLIC WORKS CONSTRUCTION, 2009 EDITION.
- 2 EXISTING UTILITIES SHOWN ON THIS PLAN ARE PLOTTED FROM UTILITY RECORDS. THE CONTRACTOR IS REQUIRED TO TAKE DUE PRECAUTIONARY MEASURES TO LOCATE AND PROTECT ALL UTILITIES WHETHER OR NOT SHOWN ON THIS PLAN.
- 3 ALL STREET PULL BOXES, AFFECTED BY CONSTRUCTION, SHALL BE ADJUSTED TO THE PROPOSED GRADE, UNLESS OTHERWISE NOTED.
- 4 PRIME CONTRACTOR BIDDING THIS WORK SHALL HAVE A CLASS "A" OR A "C-08"
- 5 COLD MILLING SHALL BE AS DIRECTED BY THE ENGINEER AND AS DESCRIBED IN SPECIAL PROVISIONS.
- 6 IN PAVEMENT OVERLAY AREAS, ANY DISTRESSED EXISTING PAVEMENT SHALL BE REMOVED AND REPLACED AS DIRECTED BY THE INSPECTOR AFTER COLD-MILLING AND PRIOR TO OVERLAYING.
- 7 CONTRACTOR SHALL GRIND AND OVERLAY EXISTING PAVEMENT AS REQUIRED ADJACENT TO 5% WHEELCHAIR RAMP BOTTOM LANDING INDICATED ON STANDARD DRAWING NO 304. CONTRACTOR SHALL GRIND AND OVERLAY AS NECESSARY BEYOND LANDING TO JOIN EXISTING PAVEMENT TO PROVIDE A FINISHED JOIN GRADE OF 1% MAXIMUM.
- 8 FOR ALL PROPOSED DRIVEWAYS INDICATED, THE "B" DIMENSION PER CITY STANDARD 302 SHALL BE AT A+7' UNLESS OTHERWISE NOTED.
- 9 CONTRACTOR SHALL RECONSTRUCT EXISTING SIDEWALK OR ADD NEW SIDEWALK PER CITY STANDARD 325 AS NECESSARY TO ADEQUATELY JOIN NEW RAMP TO BE CONSTRUCTED PER CITY STD 304, WHETHER INDICATED OR NOT.

LEGEND NOTES:

- PIP - PROTECT IN PLACE.
- R&R - REMOVE AND REPLACE.
- (M) - MODIFIED
- X-WALK-CROSS WALK

RIVERSIDE

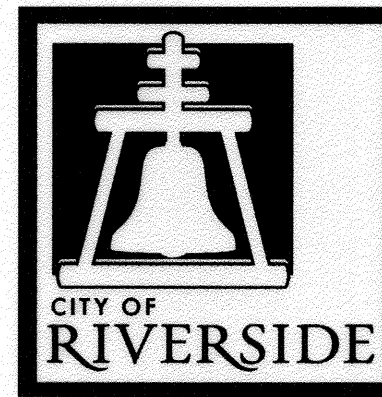

CALIFORNIA

SHEET INDEX: STREET IMPROVEMENT

SHEET NO.	DESCRIPTION
1	TITLE SHEET AND NOTES
2	WHEELCHAIR CONSTRUCTION AREA NO. 1
3	WHEELCHAIR CONSTRUCTION AREA NO. 2

SB - 821  
**WHEELCHAIR RAMP CONSTRUCTION  
 AT VARIOUS LOCATIONS - 2011/2012**

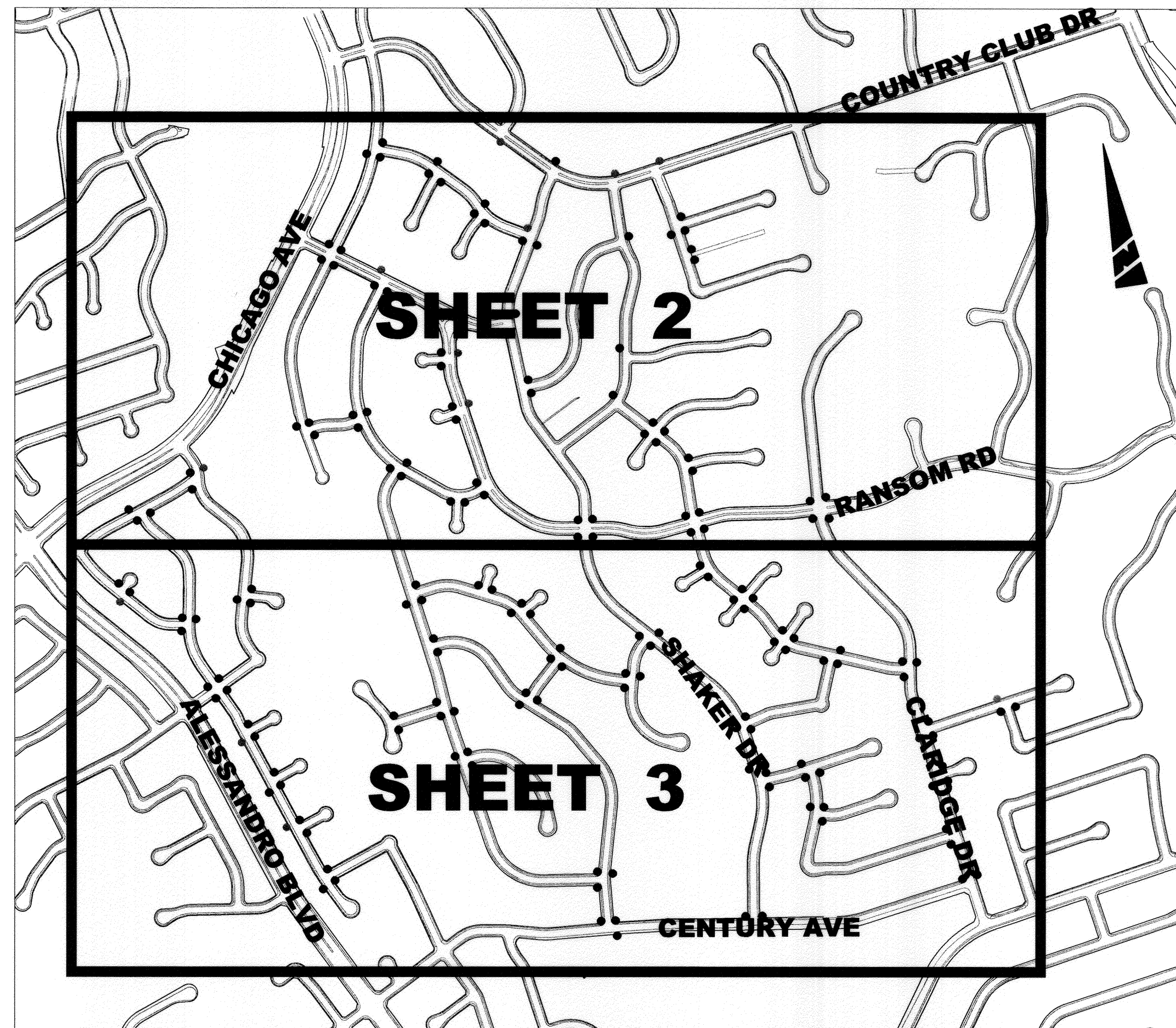

LOCATION MAP

PROPOSED WHEELCHAIR RAMP LOCATION

1"=500'

Under Ground Service Alert of Southern California  
 Call: TOLL FREE 1-800-227-2600  
 TWO WORKING DAYS BEFORE YOU DIG

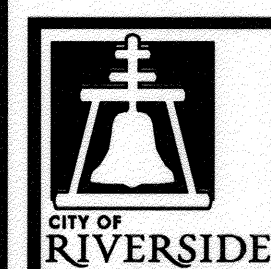

ENGINEER IN RESPONSIBLE CHARGE

Name: Edward Jara  
 R.C.E. No. 63753 EXPIRES: 9-30-12  
 DATE: July 25, 2011

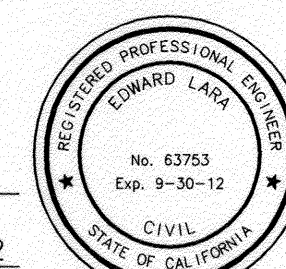

MARK	REVISIONS	APPR	DATE

DESIGNED BY: JC DRAWN BY: JC CHECKED BY: EL

CITY OF RIVERSIDE, CALIFORNIA  
 DEPARTMENT OF PUBLIC WORKS

APPROVED BY	BY	DATE	APPROVED BY	DATE
ENGINEERING MANAGER	Ed	7/26/11	Ed	7/26/11
CONSTRUCTION ADMIN.	Ed	7/26/11	Ed	7-26-11
TRAFFIC DIVISION				
PRINCIPAL ENGINEER				

SB-821 FACILITIES PROGRAM

WHEELCHAIR RAMP CONSTRUCTION AT VARIOUS LOCATIONS-2011/2012

TITLE SHEET AND NOTES

HORIZ. SCALE: N/A VERT. SCALE: N/A

AS-BUILT 6-13-14 DC

DESIGN WORK ORDER NO.: 1122226  
 CONSTR. WORK ORDER NO.: 1122229

M-467

SHEET 1 OF 3

FILE NAME: M467-01.DWG

Indexed 6-13-12 BM

WHEELCHAIR CONSTRUCTION DATA				
NO.	INTERSECTION	CORNER	RAMP TYPE	REMARK
1	VIA TIODA & INTERVALE DR	SW	I	PIP WALKWAY. ADD RETAINING CURB IF NECESSARY.
2		SE	I	
3		NE	I (M)	R&R SIDEWALK AS NECESSARY TO JOIN.
4	VIA TIODA & VIA CONEJO	SW	V	TRIM BUSH AS NECESSARY FOR CONSTRUCTION. RELOCATE ROCK.
5		NW	VII	RELOCATE WATER METER.
6		SE	V	RELOCATE STREET SIGN IF NECESSARY.
7	VIA TIODA & VIA CUESTA	NW	I(M)	ADDRESS 1515. PIP TREE AND DRIVEWAY. MODIFY TO CONSTRUCT RETAINING CURBS ON BOTH SIDES AND WINGS. ALIGN WITH WHEELCHAIR RAMP NO.9. CONSTRUCT BETWEEN DRIVEWAY & TREE.
8		SE	V	RELOCATE STREET SIGN IF NECESSARY.
9		SW	V	REMOVE BUSH LOCATED ADJACENT TO RAMP.
10		NW	OMIT	OMIT
11	VIA TIODA & SHAKER DR	SE	II-A	PIP PALM TREES.
12		SW	V(M)	TRIM BUSHES AS NECESSARY TO CONSTRUCT WHEELCHAIR RAMP. RELOCATE STREET SIGN. MODIFY TO ADD RETAINING CURB TO ONLY ALLOW ACCESS TO WHEELCHAIR RAMP NO. 11
13		COUNTY CLUB DR & VIA SAN JACINTO	SE	OMIT
14	COUNTY CLUB DR & SHAKER DR	NW	I	PIP DRIVEWAY, TREE, AND CABLE BOX. REMOVE PAVERS AND REPLACE WITH CONCRETE.
15	COUNTRY CLUB DR & TRENTON DR	NE	OMIT	OMIT
16	TRENTON DR & TIMBERLANE DR	NE	II-A	PIP BRICK CURB, AND WATER METER. RELOCATE STREET LIGHT PULL BOX.
17	VIA COIBA & COUNTRY CLUB DR.	NE	OMIT	OMIT
18	VIA COIBA & SAN CRISTOBAL DR	SW	II-A	PIP CABLE RISER, PIP WATER METER, AND BRICK LANDSCAPE BORDER.
19		NE	II	RELOCATE STREET SIGN IF NECESSARY. R&R SPANDREL.
20		SE	II	
21	VIA COIBA & SAN CRISTOBAL DR	NE	III	REMOVE OUTLET PIPE AS NECESSARY.
22		SE	III	
23	TRENTON DR & HALIFAX DR	NW	II-A	PIP STREET LIGHT.
24	TRENTON DR & WIMBLEDDON DR	NW	II-A	LOCATE AT ADDRESS 1483.
25		W	II	
26	WIMBLEDDON DR & CADWELL CT	N	II	PIP WOOD RETAINING CURB AND STREET SIGN.
27		E	II	PIP BLOCK CURB.
28		S	II	PIP CONCRETE CURB AND STREET SIGN.
29	IVERSON PL & WIMBLEDDON DR	NE	II	PIP BRICKS AND STREET SIGN.
30		SE	II	PIP BLOCK WALL.
31		NW	II	PIP LANDSCAPE.
31A	CLARIDGE DR & RANSOM RD	NE	I	GRIND CONCRETE LIP.
32		SW	II	PIP LANDSCAPE.
32A		SE	I	R&R EXISTING WHEELCHAIR RAMP.
33		SE	II	
34	WIMBLEDDON DR & RANSOM RD	NE	II	PIP SMALL TREES.
35		NW	II	TRIM BACK TREE AS NECESSARY.
36		SW	II	PIP TWO FIRE HYDRANTS.
37		SE	II	RELOCATE OUTLET PIPE. RELOCATE STREET SIGN AND STOP SIGN.
38	RANSOM RD & SHAKER DR	SW	II	PIP STOP SIGN.
39		NW	II	RELOCATE STREET LIGHTING PULL BOX. PIP STOP SIGN AND CABLE RISER.
40		NE	II	PIP BUSHES.
41	RANSOM RD & COURTLAND DR	SW	II	
42		NW	II	
43	ANDOVER CT & COURTLAND DR	SE	II	PIP STREET SIGN.
44		SW	II	
45	WINDEMERE WY & COURTLAND DR	SE	I	PIP FIRE HYDRANT. STOP SIGN, AND STREET SIGN.
46		NE	II-A	PIP ELECTRICAL VAULT. LOCATE AT ADDRESS 5978. CONSTRUCT TO ALIGN WITH WHEELCHAIR RAMP NO. 45. PIP DRIVEWAY.
47		SW	II	TRIM BUSH IF NECESSARY.
48	MEDINA WY & COURTLAND DR	SW	II	PIP FIRE HYDRANT, PALM TREE, AND STREET SIGN.
49		NE	II-A	LOCATE AT ADDRESS 5950. PIP STEPS AND COLUMNS.
50		NW	II	

NOTE: SEE GENERAL CONSTRUCTION NOTES AND LEGEND ON SHEET 1 OF 3.

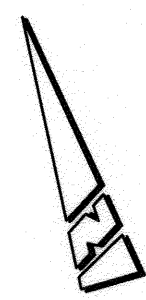

RELOCATE TO NORTH SIDE OF P.L.  
 MODIFY WITH FULL HEIGHT RETAINING CURB  
 RELOCATE ACROSS FROM

ALIGN WITH #47

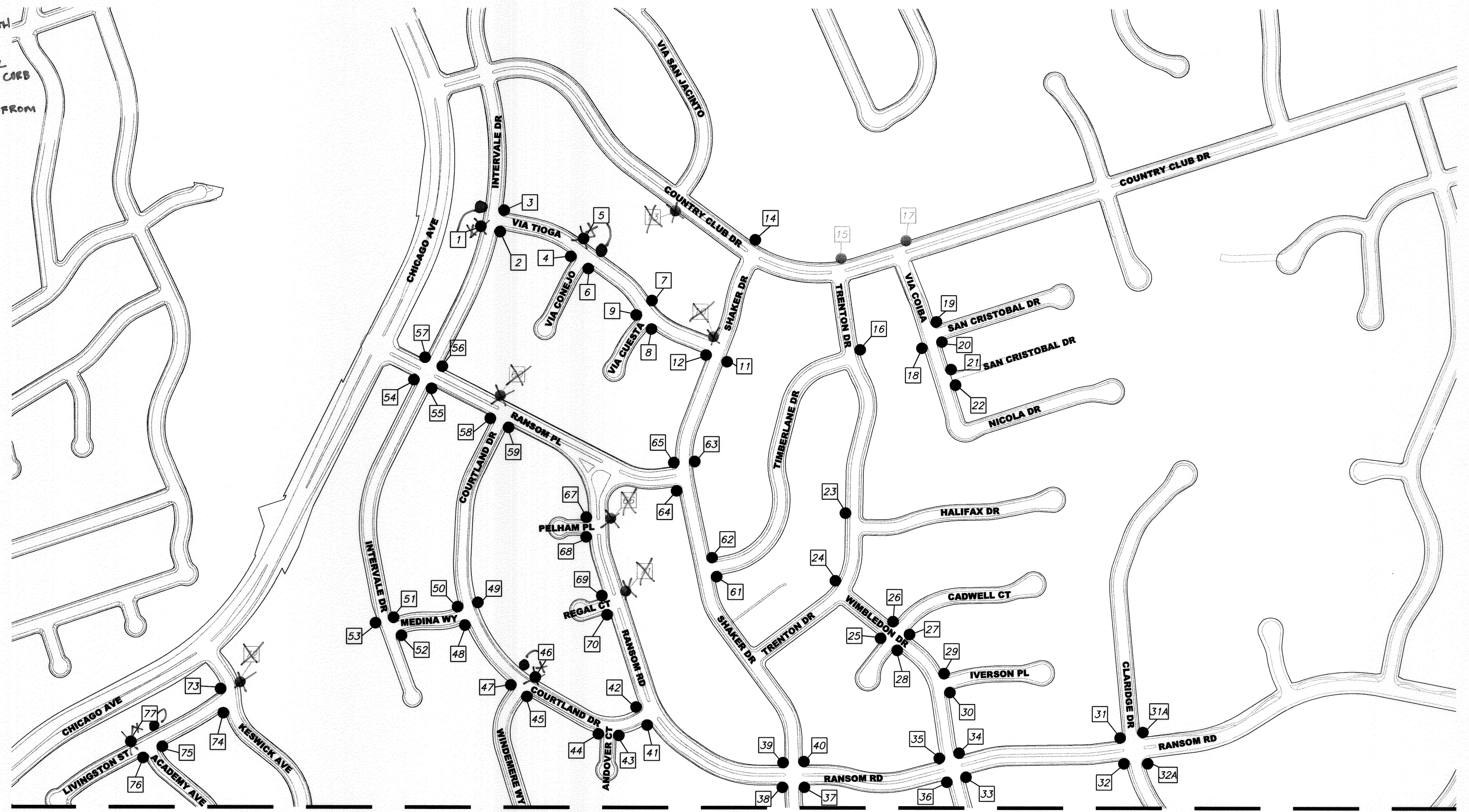

MATCHLINE (SEE SHEET 3 OF 3)

WHEELCHAIR CONSTRUCTION DATA				
NO.	INTERSECTION	CORNER	RAMP TYPE	REMARK
51	INTERVALE DR & MEDINA WY	NE	II	
52		SE	II	PIP FIRE HYDRANT, AND ROSES BUSHES. REMOVE AND REPLACE BRICKS.
53		NW	II-A	LOCATE AT ADDRESS 5949. ALIGN WITH WHEELCHAIR RAMP NO. 51. PIP STREET LIGHT PULL BOX.
54	INTERVALE DR & RANSOM RD	W	II	PIP CATCH BASIN, AND ELECTRICAL BOX. REMOVE 3 BUSHES BETWEEN ELECTRICAL VAULTS. SHIFT RAMP TO PROTECT CATCH BASINS. R&R SPANDREL.
55		S	II	TRIM BACK BUSH AS NECESSARY.
56		E	V	REMOVE PAVERS. TRIM BUSHES IF NECESSARY.
57		N	V	REMOVE PAVERS. TRIM BUSHES IF NECESSARY.
58	RANSOM RD & COURTLAND DR	NW	II	PIP TREE, AND FIRE HYDRANT. R&R SPANDREL. R&R CURB AND SIDEWALK AS NECESSARY AROUND THE RETURN.
59		S	II	PIP STOP SIGN.
60		NE	OMIT	OMIT
61	SHAKER DR & TIMBERLANE DR	SE	II	PIP ELECTRICAL BOX AND STREET LIGHT.
62		NE	II	RELOCATE ELECTRIC BOX. RELOCATE STOP SIGN IF NECESSARY.
63		NE	II-A	
64	SHAKER DR & RANSOM PL	SW	II	PIP STOP SIGN AND FIRE HYDRANT.
65		NW	II	PIP CABLE RISER, BRICK WALL, AND ROCK LANDSCAPE BORDER.

NOTE: SEE GENERAL CONSTRUCTION NOTES AND LEGEND ON SHEET 1 OF 3.

WHEELCHAIR CONSTRUCTION DATA				
NO.	INTERSECTION	CORNER	RAMP TYPE	REMARK
66		NE	OMIT	OMIT
67	RANSOM RD & PELHAM PL	NW	II	PIP TREE. R&R 12' OF DAMAGED SIDEWALK NEXT TO THE PROPOSED RAMP.
68		SW	II	PIP STREET SIGN, AND TRIM BUSHES AS NECESSARY.
69		NW	II	PIP FIRE HYDRANT. R&R PAVERS.
70	RANSOM RD & REGAL CT	SW	II	PIP TREE, CABLE POST, STREET SIGN, AND ELECTRICAL STRUCTURE. TRIM SMALL BUSH AS NECESSARY FOR CONSTRUCTION.
71		NE	OMIT	OMIT
72		NE	OMIT	OMIT
73	LIVINGSTON ST & KESWICK AVE	NW	I	PIP STREET LIGHT PULL BOX. RECONSTRUCT WESTERLY SIDEWALK AND PRIVATE WALKWAY AS NECESSARY TO JOIN NEW RAMP.
74		SW	I	RELOCATE STREET SIGN. PIP LANDSCAPE.
75		SE	IV-A	PIP BLOCK WALL. RELOCATE STREET SIGN IF NECESSARY.
76	LIVINGSTON ST & ACADEMY AVE	SW	IV-A	
77		NW	I (M)	LOCATE AT ADDRESS 2055. ADD RETAINING CURB AS NECESSARY TO PROTECT EXISTING TREE AND DRIVEWAY.

NOTE: SEE GENERAL CONSTRUCTION NOTES AND LEGEND ON SHEET 1 OF 3.

Under Ground Service Alert of Southern California  
 Call: TOLL FREE 1-800-227-2600  
 TWO WORKING DAYS BEFORE YOU DIG

ENGINEER IN RESPONSIBLE CHARGE  
 Name: Edward J. ...  
 R.C.E. No. 63753 EXPIRES: 9-30-12  
 DATE: 7/26/11

REVISIONS  
 APPR. DATE  
 DESIGNED BY: JC DRAWN BY: JC CHECKED BY: EL

CITY OF RIVERSIDE, CALIFORNIA  
 DEPARTMENT OF PUBLIC WORKS  
 APPROVED BY: [Signature]  
 ENGINEERING MANAGER  
 CONSTRUCTION ADMIN. [Signature]  
 TRAFFIC DIVISION [Signature]  
 PRINCIPAL ENGINEER  
 DATE: 7/29/11

SB-821 FACILITIES PROGRAM  
 WHEELCHAIR RAMP CONSTRUCTION AT VARIOUS LOCATIONS-2011/2012  
 WHEELCHAIR RAMP LOCATION AREA NO. 2  
 HORIZ. SCALE: 1" = 250' VERT. SCALE: N/A

DESIGN WORK ORDER NO.: 1122226  
 CONSTR. WORK ORDER NO.: 1122229  
 M-467  
 SHEET 2 OF 3  
 FILE NAME: M467-02.DWG

WHEELCHAIR CONSTRUCTION DATA				
NO.	INTERSECTION	CORNER	RAMP TYPE	REMARK
78	BOND ST & TUDDOR CT	NE	IV-A	PIP SIGN.
79		SE	IV-A	
80		SW	OMIT	OMIT
81	BOND ST & ACADEMY AVE	NW	IV-A	TRIM BUSH AS NECESSARY.
82		SW	IV-A	PIP FIRE HYDRANT, PIP STREET SIGN.
83		NE	VII	R&R DRIVEWAY WITH PROPERTY LINE SIDEWALK & MAINTAIN BACK OF WALK ELEVATION. A=15.5'. LOCATE AT ADDRESS 6050.
84	ACADEMY AVE & TRAFALGAR AVE	NW	I	PIP FIRE HYDRANT. RELOCATE STOP SIGN IF NECESSARY.
85		NE	I	RELOCATE STREET SIGN.
86		SW	I	REMOVE BUSHES.
87	ACADEMY AVE & MADRID CT	SE	I	PIP SMALL PALM TREES.
88		NE	IV-A	
89		SW	OMIT	OMIT
90	ACADEMY AVE & YUMA CT	SE	IV-A	PIP BLOCK WALL
91		NE	IV-A	PIP STREET SIGN.
92		SE	IV-A	REMOVE AND REPLACE DECORATIVE PAVERS IF NECESSARY.
92A	ACADEMY AVE & THISTLE CT	SW	I	RELOCATE SIGN. PLACE ACROSS FROM WHEELCHAIR RAMP NO. 92. PIP BLOCK WALL.
93		NW	OMIT	OMIT
94		NE	IV-A	PIP TIMBER BLOCKS AND PALM TREE.
95	ACADEMY AVE & DOLPHIN ST	SE	IV-A	PIP LANDSCAPE.
96		NE	IV-A	RELOCATE STREET SIGN IF NECESSARY.
97		SE	IV-A	PIP BRICK WALL. TRIM BUSHES AS NECESSARY.
97A	ACADEMY AVE & CHATHART PL	SW	VII(M)	LOCATE AT ADDRESS 6233. R&R WESTERLY SIDEWALK PANEL. ADD GROOVES AND GRIND LIP. PIP EXISTING DRIVEWAY.
98		SE	IV-A	
99		SW	VII(M)	GRIND LIP AND ADD GROOVES. ADDRESS 6049. PIP EXISTING DRIVEWAY.
100	WINDEMERE WY & BELLEFONTAINE DR	NE	IV-A	PIP PLANTS, TREES. RELOCATE STREET SIGN IF NECESSARY.
101		SW	II-A	ACROSS FROM WHEELCHAIR RAMP 103. PIP STREET LIGHT PULL BOX. PIP DRIVEWAY.
102		NE	II	PIP FIRE HYDRANT AND CABLE RISER. R&R SPANDREL.
103	WINDEMERE WY & PROMONTORY LN	SE	II	PIP SPANDREL. RELOCATE STREET SIGN IF NECESSARY.
104		NE	II	PIP TREES, FIRE HYDRANTS, & CATCH BASIN.
105		SE	II	PIP BOTH CATCH BASINS.
106	ST AUGUSTINE DR & WINDEMERE WY	SE	II-A	LOCATE ACROSS FROM WHEELCHAIR RAMP NO. 108. PIP FIRE HYDRANT. R&R BRICK LANDSCAPE BORDER.
107		NW	II	PIP DECORATIVE CONCRETE. SHIFT RAMP TOWARDS ST AUGUSTINE DRIVE TO PIP CABLE BOX.
108		SW	II	RELOCATE STREET SIGN. PIP METAL STEEL FENCE.
109	ST AUGUSTINE DR & CUL-DE-SAC	SE	I	R&R EXISTING WHEELCHAIR RAMP.
110		NE	I	R&R EXISTING WHEELCHAIR RAMP.
111		NW	II-A	PIP TREE, AT&T BOX, AND WATER METER. ACROSS FROM WHEELCHAIR RAMP NO. 112.
112	WINDEMERE WY & PORT AU PRINCE CR	NE	II	PIP BRICK WALL. RELOCATE STREET SIGN IF NECESSARY.
113		SE	II	PIP FIRE HYDRANT. REMOVE AND REPLACE WOOD RETAINING CURB AS NECESSARY FOR CONSTRUCTION.
114		SE	II-A	PIP STREET LIGHT. CONSTRUCT NEXT TO STREET LIGHT ACROSS FROM 115. SANDBLAST EXISTING X-WALK AND RE-STRIPE IN KIND.
115	PROMONTORY LN & CENTURY AVE	NE	II	PIP WOOD BORDER, STOP SIGN, STREET SIGN, AND TREES. R&R 10' ON CENTURY AVENUE OF DAMAGED CURB AND GUTTER.
116		NW	II	PIP FIRE HYDRANT & STOP SIGN. TRIM BUSHES AS NECESSARY FOR CONSTRUCTION.
117		SW	I	RELOCATE STREET SIGN AND ROSE BUSHES.
118	PROMONTORY LN & WINDEMERE WY	NE	II-A	PIP TELECOMMUNICATIONS POST. LOCATE ACROSS FROM 119.
119		NW	II	PIP FIRE HYDRANT.
120		NW	II-A	R&R BRICK BORDER.
121	POMPAND WY & PROMONTORY WY	SE	II	PIP FIRE HYDRANT.
122		NE	II	RELOCATE STREET SIGN. TRIM BUSHES AS NECESSARY FOR CONSTRUCTION. R&R 10FT W'LY SIDEWALK AND 20FT E'LY.
123		BELLEFONTAINE DR & SAGINAW PL	NW	II
124	BELLEFONTAINE DR & SEDALIA PL	NE	II	RELOCATE STREET SIGN. PIP BRICK CURB.
125		NE	II	TRIM SHRUBS AND TREES AS NECESSARY FOR CONSTRUCTION.
126		NW	II-A	PIP STREET LIGHT. RELOCATE STREET LIGHT PULL BOX.
127	BELLEFONTAINE DR & POMPAD WY	SE	II	RELOCATE STREET SIGN IF NECESSARY.
128		NW	II	PIP STREET LIGHT.
129		NE	II-A	PIP DRIVEWAY.
130	BELLEFONTAINE DR & TAREYTON DR	SW	II	RELOCATE STREET SIGN IF NECESSARY. TRIM BUSHES AS NECESSARY.

NOTE: SEE GENERAL CONSTRUCTION NOTES AND LEGEND ON SHEET 1 OF 3.

RELOCATE TO LINE UP WITH # 82

RELOCATE TO LINE UP WITH # 116. RELOCATE X-WALK

MOVE TO LINE UP WITH # 130

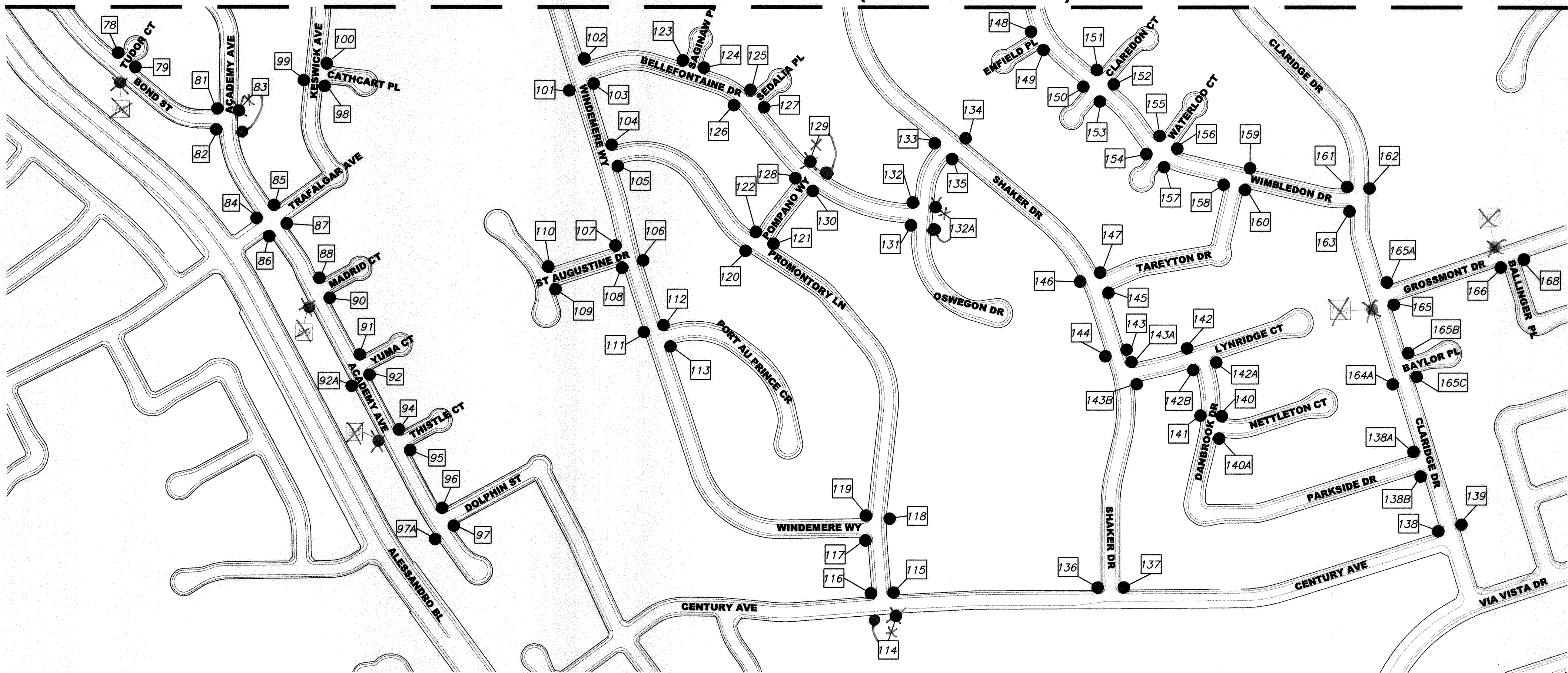

WHEELCHAIR CONSTRUCTION DATA				
NO.	INTERSECTION	CORNER	RAMP TYPE	REMARK
131	BELLEFONTAINE DR & OSWEGON DR	SW	II	PIP WATER METER. PIP STREET SIGN.
132		NW	II	
132A		NE	II-A	PIP WATER METER. LOCATE ACROSS FROM 131
133	SHAKER DR & OSWEGON DR	NW	II	
134		SE	II-A	
135		SW	II	RELOCATE STREET SIGN. PIP FIRE HYDRANT, STOP SIGN, AND ST LGT BOX. TRIM BUSHES AS NECESSARY.
136	CENTURY AVE & SHAKER DR	NW	II	PIP FIRE HYDRANT AND STOP SIGN. RELOCATE STREET SIGN IF NECESSARY. TRIM BUSHES AS NECESSARY.
137		NE	I	R&R EXISTING WHEELCHAIR RAMP.
138		NW	I	R&R EXISTING WHEELCHAIR RAMP. PIP WOOD BORDER.
139	CENTURY AVE & CLARIDGE DR	NE	VII(M)	PIP EXISTING DRIVEWAY. ADD GROOVES.
138A		NW	I	R&R EXISTING WHEELCHAIR RAMP. R&R SIDEWALK AS NECESSARY.
138B		SW	I	R&R EXISTING WHEELCHAIR RAMP. R&R SIDEWALK AS NECESSARY.
140	DANBROOK DR & NETTLETON CT	NE	I	R&R EXISTING WHEELCHAIR RAMP. PIP STREET SIGN, BRICK BORDER, AND PALM TREE. TRIM BUSHES AS NECESSARY.
140A		SE	I	R&R EXISTING WHEELCHAIR RAMP.
141		NW	II-A	PIP STREET LIGHT, PIP PAVERS, AND BRICK MAIL BOX.
142	DANBROOK DR & LYNRIDGE CT	NW	II-A	LOCATE RAMP ACROSS FROM 142B. IN ADDITION, R&R 11' OF E'LY SIDEWALK ADJACENT TO EXISTING DRIVEWAY LOCATED AT ADDRESS 1367.
142A		SE	I	R&R EXISTING WHEELCHAIR RAMP.
142B		SW	I	R&R WHEELCHAIR RAMPS.
143A	SHAKER DR & LYNRIDGE CT	NE	I	R&R EXISTING WHEELCHAIR RAMP. PIP BLOCK WALL.
143B		SE	I	R&R EXISTING WHEELCHAIR RAMP. TRIM BUSHES AS NECESSARY FOR CONSTRUCTION.
143		E	II-A	PIP BLOCK WALL. RELOCATE STREET SIGN. ALIGN WITH WHEELCHAIR RAMP NO. 144. SANDBLAST STRIPPING, AND RE-STRIPE IN KIND TO ALIGN WITH NEW RAMPS.
144	SHAKER DR. APPROXIMATELY 25' NORTH OF LYNRIDGE CT	W	II-A	SANDBLAST EXISTING X-WALK, AND RE-STRIPE IN KIND TO ALIGN WITH NEW RAMPS. BEGIN RAMP AT THE EDGE OF SCHOOL WALKWAY. RELOCATE STREET SIGN.
145		SE	II	PIP FIRE HYDRANT.
146		NW	II-A	PIP STREET LIGHT. PIP PRIVATE WALKWAY.
147	SHAKER DR & TAREYTON DR	NE	II	PIP STREET SIGN AND STOP SIGN.

NOTE: SEE GENERAL CONSTRUCTION NOTES AND LEGEND ON SHEET 1 OF 3.

MATCHLINE (SEE SHEET 2 OF 3)

WHEELCHAIR CONSTRUCTION DATA				
NO.	INTERSECTION	CORNER	RAMP TYPE	REMARK
148	WIMBLETON DR & ENFIELD PL	NW	II	PIP AT&T BOX.
149		SW	II	PIP BLOCK WALL.
150	WIMBLETON DR & CLARENDON CT	NW	II	PIP AT&T BOX, FIRE HYDRANT, AND STREET LIGHT.
151		NE	II	PIP TREE.
152		SE	II	PIP LANDSCAPE.
153	WATERLOO CT & WIMBLETON DR	SW	II	RELOCATE STREET SIGN IF NECESSARY. PIP LANDSCAPE.
154		NW	II	PIP AT&T CABLE RISER. PIP LANDSCAPE.
155		NE	II	PIP LANDSCAPE.
156	WIMBLETON DR & TAREYTON DR	SE	II	PIP LANDSCAPE.
157		SW	II	PIP LANDSCAPE.
158		SW	II	PIP ELECTRICAL BOX, FIRE HYDRANT, AND LANDSCAPE.
159	WIMBLETON DR & TAREYTON DR	NE	II-A	PIP STREET LIGHT PULL BOX. CONSTRUCT NEXT TO PULL BOX. PIP BLOCK WALL.
160		SE	II	PIP STREET SIGN, ELECTRICAL BOX, AND STREET LIGHT. R&R 24' OF DAMAGED SIDEWALK ON TAREYTON DR.
161		NW	II	PIP TREE. PIP LANDSCAPE.
162	WIMBLETON DR & CLARIDGE DR	NE	II-A	PIP TREE. LOCATE ACROSS FROM WHEELCHAIR RAMP NO. 161.
163		SW	II	PIP ELECTRICAL VAULT, PIP STOP SIGN, AND FIRE HYDRANT. PIP LANDSCAPE.
164		SW	OMIT	OMIT
165	CLARIDGE DR & GROSSMONT DR	SE	II	PIP BLOCK WALL.
165A		NE	I	R&R EXISTING WHEELCHAIR RAMP. PIP BLOCK WALL AND STREET SIGN. RECONSTRUCT ADJACENT SIDEWALK AS NECESSARY TO JOIN NEW RAMP.
164A		SW	II-A	PIP BRICK BORDER AND STEPS. PIP WATER METER.
165B	CLARIDGE DR & BAYLOR PL	NE	I	R&R EXISTING WHEELCHAIR RAMP. R&R SIDEWALK AS NECESSARY.
165C		SE	I	R&R EXISTING WHEELCHAIR RAMP. R&R SIDEWALK AS NECESSARY.
166		SW	II	PIP FIRE HYDRANT AND UTILITY BOX. R&R LOWERED SIDEWALK.
167	GROSSMONT DR & BALLINGER PL	NW	OMIT	OMIT
168		SE	II	PIP STREET SIGN AND BRICK LANDSCAPE BORDER.

NOTE: SEE GENERAL CONSTRUCTION NOTES AND LEGEND ON SHEET 1 OF 3.

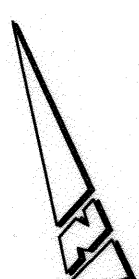

Under Ground Service Alert of Southern California  
Call: TOLL FREE 1-800-227-2600  
TWO WORKING DAYS BEFORE YOU DIG

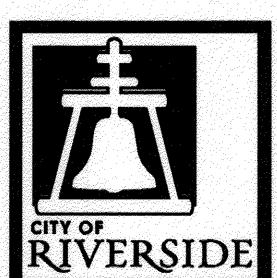

ENGINEER IN RESPONSIBLE CHARGE  
Name: Edward J. ...  
R.C.E. No. 63753 EXPIRES: 9-30-12  
DATE: 2/24/11

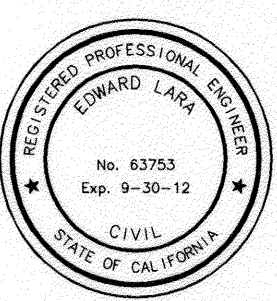

DESIGNED BY	JC	DRAWN BY	JC	CHECKED BY	EL
-------------	----	----------	----	------------	----

CITY OF RIVERSIDE, CALIFORNIA  
DEPARTMENT OF PUBLIC WORKS

APPROVED BY: [Signature]  
DATE: 2/24/11  
TRAFFIC DIVISION: [Signature]  
PRINCIPAL ENGINEER: [Signature]

SB-821 FACILITIES PROGRAM  
WHEELCHAIR RAMP CONSTRUCTION AT VARIOUS LOCATIONS-2011/2012  
WHEELCHAIR RAMP LOCATION AREA NO. 3  
HORIZ. SCALE: 1" = 250' VERT. SCALE: N/A

DESIGN WORK ORDER NO.: 1122226  
CONSTR. WORK ORDER NO.: 1122229  
M-467  
SHEET 3 OF 3  
FILE NAME: M467-03.DWG