

RIVERSIDE CALIFORNIA

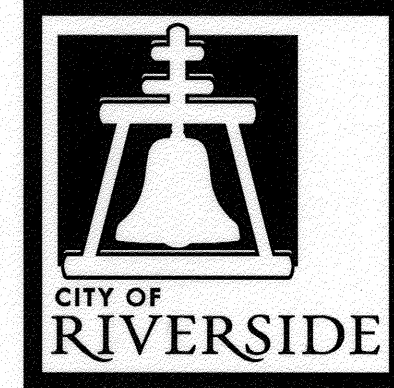

PUBLIC WORKS DEPARTMENT

2012-2013 CDBG ADA FOOTPATH IMPROVEMENTS AT VARIOUS LOCATIONS A HUD FUNDED PROJECT

GENERAL CONSTRUCTION NOTES:

- CONSTRUCTION SHALL BE IN ACCORDANCE WITH THE CITY OF RIVERSIDE STANDARD DRAWINGS AND STANDARD SPECIFICATIONS FOR PUBLIC WORKS CONSTRUCTION, 2012 EDITION.
- EXISTING UTILITIES SHOWN ON THIS PLAN ARE PLOTTED FROM UTILITY RECORDS. THE CONTRACTOR IS REQUIRED TO TAKE DUE PRECAUTIONARY MEASURES TO LOCATE AND PROTECT ALL UTILITIES WHETHER OR NOT SHOWN ON THIS PLAN.
- ALL STREET PULL BOXES, AFFECTED BY CONSTRUCTION, SHALL BE ADJUSTED TO THE PROPOSED GRADE, UNLESS OTHERWISE NOTED.
- PRIME CONTRACTOR BIDDING THIS WORK SHALL HAVE A CLASS "A" OR A "C-12".
- CONTRACTOR SHALL GRIND AND OVERLAY EXISTING PAVEMENT AS REQUIRED ADJACENT TO 5% WHEELCHAIR RAMP BOTTOM LANDING INDICATED ON STANDARD DRAWING NO. 304. CONTRACTOR SHALL GRIND AND OVERLAY AS NECESSARY BEYOND LANDING TO JOIN EXISTING PAVEMENT TO PROVIDE A FINISHED JOIN GRADE OF 16% MAXIMUM.
- CONTRACTOR SHALL RECONSTRUCT EXISTING SIDEWALK OR ADD NEW SIDEWALK PER CITY STANDARD 325 AS NECESSARY TO ADEQUATELY JOIN NEW RAMP TO BE CONSTRUCTED PER CITY STD 304, WHETHER INDICATED OR NOT.

SIGNING GENERAL NOTES:

- SIGNING INSTALLATIONS SHALL CONFORM TO THE CALIFORNIA MANUAL ON UNIFORM TRAFFIC CONTROL DEVICES (CA MUTCD), THE STATE OF CALIFORNIA DEPARTMENT OF TRANSPORTATION (CALTRANS) STANDARD PLANS AND SPECIFICATIONS DATED 2010, AND ALL ADDENDUMS THERETO, AND THE CITY OF RIVERSIDE PUBLIC WORKS DEPARTMENT STANDARD DRAWINGS, CURRENT EDITION.
- TRAFFIC SIGN FACE SHALL BE 3M DIAMOND GRADE DG3 REFLECTIVE SHEETING (ASTM XI) OR APPROVED EQUAL WITH PROTECTIVE GRAFFITI OVERLAY FILM OR AS OTHERWISE NOTED.
- SIGNS SHALL BE STANDARD SIZE UNLESS NOTED OTHERWISE. PRIOR TO INSTALLATION, NEW SIGNS SHALL BE APPROVED BY THE CITY OF RIVERSIDE. EXACT LOCATIONS OF SIGNS SHALL BE DETERMINED BY THE CITY ENGINEER.
- REMOVED SIGNS AND SIGN POSTS SHALL BE DELIVERED TO THE CITY OF RIVERSIDE SIGN DEPARTMENT.
- CONTRACTOR SHALL INSTALL NEW SIGN(S) AND/OR POST(S) PER CITY OF RIVERSIDE STANDARD DRAWING No. 664, SEE SPECIFICATIONS.
- CONTRACTOR SHALL INSTALL NEW STREET NAME SIGNS AND POST PER CITY OF RIVERSIDE STANDARD DRAWING No. 662, SEE SPECIFICATIONS.
- CONTRACTOR SHALL REMOVE & RE-STRIPE STOP BARS WHERE NEW "T" RAMP ARE CONSTRUCTED AS NEEDED.

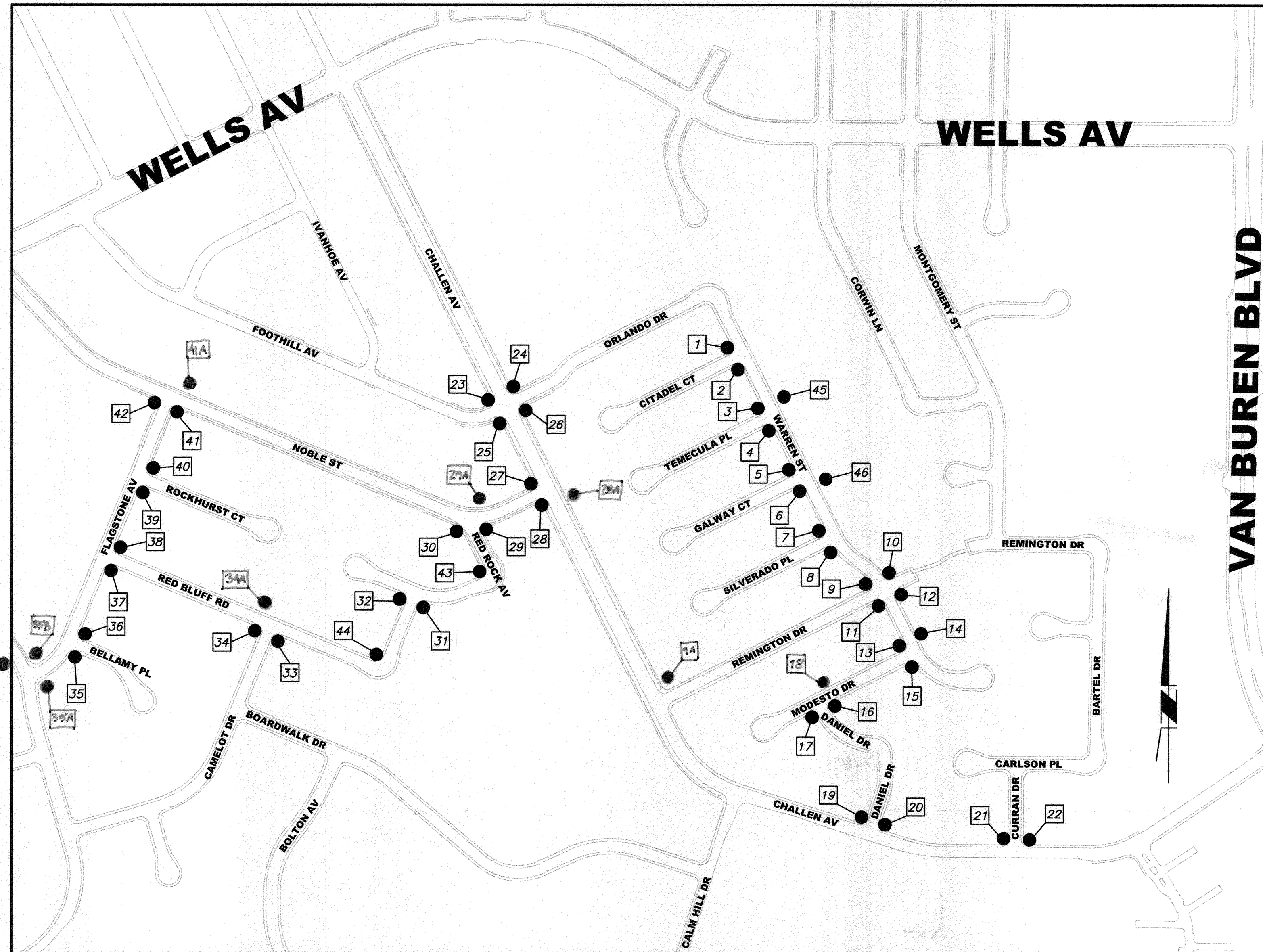

LOCATION MAP
SCALE: 1" = 250'

PROPOSED WHEELCHAIR RAMP/SIGNAGE LOCATION

WHEELCHAIR RAMP CONSTRUCTION DATA					SIGN QUANTITIES - THIS SHEET			
NO.	LOCATION	QUAD.	RAMP TYPE	REMARKS	SIGN CODE	INSTALL SNS	RELOCATE SIGN, 1 POST	REMOVE SIGN
1	CITADEL & WARREN	NW	II					
2	CITADEL & WARREN	SW	II		SNS	1		1
3	TEMECULA & WARREN	NW	I					
4	TEMECULA & WARREN	SW	II		SNS	1		1
5	GALWAY & WARREN	NW	I					
6	GALWAY & WARREN	SW	II		SNS	1		1
7	SILVERADO & WARREN	NW	II					
8	SILVERADO & WARREN	SW	II		SNS	1		1
9		NW	II		SNS	1		1
10		NE	I					
11	REMINGTON & WARREN	SW	I	PIP HYDRANT				
12		SE	PIP		SNS	1		
13		NW	II	R&R 9' S/W				
14	MODESTO & WARREN	NE	II-A					
15		SW	I	R&R 18.5' S/W	SNS	1		1
16	DANIEL & MODESTO	SE	I		SNS	1		1
17	DANIEL & MODESTO	SW	II					
18	MODESTO & DANIEL	At "T"	VII					
19	DANIEL & CHALLEN	NW	II		SNS	1		1
20	DANIEL & CHALLEN	NE	I					
21	CURRAN & CHALLEN	NW	R&R I		SNS	1		1
22	CURRAN & CHALLEN	NE	R&R I					
23		NW	I	PIP HYDRANT				
24		NE	R&R I	REMOVE 2 RAMPS, INSTALL 2	SNS	1		1
25	ORLANDO & CHALLEN	SW	V I	REMOVE 2 RAMPS, INSTALL 2	SNS	1		1
26		SE	R&R I	REMOVE 2 RAMPS, INSTALL 2				
27	NOBLE & CHALLEN	NW	IV					
28		SW	IV		SNS	1		1
29	RED ROCK & NOBLE	SE	I		SNS	1		1
30	RED ROCK & NOBLE	SW	I					
31	RED ROCK & RED BLUFF	SE	I		SNS	1		1
32	RED ROCK & RED BLUFF	SW	I					
33	RED BLUFF & CAMELOT	SE	R&R I		SNS	1		1
34	RED BLUFF & CAMELOT	SW	R&R I				1	1
35	RED BLUFF & CAMELOT	SE	R&R I					
36	BELLAMY & FLAGSTONE	NE	R&R I		SNS	1		1
37	BELLAMY & FLAGSTONE	NE	R&R I				1	1
38	RED BLUFF & FLAGSTONE	SE	R&R I		SNS	1		1
39	ROCKHURST & FLAGSTONE	SE	R&R I					
40	ROCKHURST & FLAGSTONE	NE	R&R V		SNS	1		1
41	NOBLE & FLAGSTONE	SE	IV		SNS	1		1
42	NOBLE & FLAGSTONE	SW	IV					
43	RED ROCK & RED ROCK	NW	R&R I	REMOVE RAMP, REPLACE W/ STOP BAR				
44	RED BLUFF & RED BLUFF	NW	I					
45	TEMECULA & WARREN	AT "T"	II-A					
46	GALWAY & WARREN	AT "T"	VII					
ROADSIDE SIGN GRAND TOTAL:						20	2	21

R&R = REMOVE AND REPLACE EXISTING IMPROVEMENT
PIP = PROTECT IN PLACE
S/W = SIDEWALK
SNS = STREET NAME SIGN
(*) = REUSE EXISTING SIGN, REPLACE POST ONLY
SEE CITY OF RIVERSIDE STD DWG NO. 664 FOR ROADSIDE SIGNS
SEE CITY OF RIVERSIDE STD DWG NO. 662 FOR STREET NAME SIGNS

WHEELCHAIR RAMP CONSTRUCTION DATA (CONT'D)				
NO.	LOCATION	QUAD.	RAMP TYPE	REMARKS
QA	REMINGTON & CHALLEN	NE	V	
29A	CHALLEN & NOBLE	At "T"	VII	WIDEN DRIVEWAY AS NEEDED
29A	NOBLE & RED ROCK	At "T"	VII	
24A	RED BLUFF & CAMELOT	At "T"	II-A	
25A	FLAGSTONE	SE	R&R II	
25B	CREST	NE	R&R I	
25C	CREST	At "T"	II-A	
41A	FLAGSTONE & NOBLE	At "T"	II-A	

Under Ground Service Alert of Southern California
Call: TOLL FREE 1-800-227-2600
TWO WORKING DAYS BEFORE YOU DIG

ENGINEER IN RESPONSIBLE CHARGE
EDWARD LARA
R.C.E. No. 63753 EXPIRES: 9-30-14
DATE: December 29, 2012

EDWARD LARA
No. 63753 Exp. 9-30-14
CIVIL
STATE OF CALIFORNIA

CITY OF RIVERSIDE, CALIFORNIA
DEPARTMENT OF PUBLIC WORKS

APPROVED BY: [Signature]
BY: [Signature] DATE: 12/27/12
CONSTRUCTION ADMIN. [Signature]
TRAFFIC DIVISION [Signature]
STREETS SERVICES

WHEELCHAIR RAMP IMPROVEMENTS
2012-2013 CDBG
ADA FOOTPATH IMPROVEMENTS
AT VARIOUS LOCATIONS
WHEELCHAIR RAMP IMPROVEMENT PLAN

HORIZ. SCALE: N/A VERT. SCALE: N/A

DESIGN WORK ORDER: #1309684
CONSTR. WORK ORDER: #1309693

M-470
SHEET 1 OF 1
FILE NAME: M470-1.DWG