

# RIVERSIDE CALIFORNIA

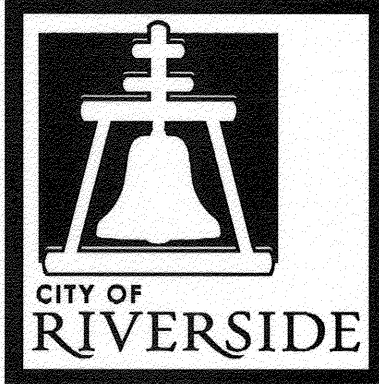

## PUBLIC WORKS DEPARTMENT

### 2013/2014 - SB821

### WHEELCHAIR RAMP CONSTRUCTION

#### GENERAL CONSTRUCTION NOTES:

- CONSTRUCTION SHALL BE IN ACCORDANCE WITH THE CITY OF RIVERSIDE STANDARD DRAWINGS AND STANDARD SPECIFICATIONS FOR PUBLIC WORKS CONSTRUCTION, 2012 EDITION.
- EXISTING UTILITIES SHOWN ON THIS PLAN ARE PLOTTED FROM UTILITY RECORDS. THE CONTRACTOR IS REQUIRED TO TAKE DUE PRECAUTIONARY MEASURES TO LOCATE AND PROTECT ALL UTILITIES WHETHER OR NOT SHOWN ON THIS PLAN.
- ALL STREET PULL BOXES, AFFECTED BY CONSTRUCTION, SHALL BE ADJUSTED TO THE PROPOSED GRADE, UNLESS OTHERWISE NOTED.
- PRIME CONTRACTOR BIDDING THIS WORK SHALL HAVE A CLASS "A" OR A "C-8".
- CONTRACTOR SHALL GRIND AND OVERLAY EXISTING PAVEMENT AS REQUIRED ADJACENT TO 5% MAX. WHEELCHAIR RAMP BOTTOM LANDING INDICATED ON STANDARD DRAWING NO 304. CONTRACTOR SHALL GRIND AND OVERLAY AS NECESSARY BEYOND LANDING TO JOIN EXISTING PAVEMENT TO PROVIDE A FINISHED JOIN GRADE OF 16% MAXIMUM.
- CONTRACTOR SHALL RECONSTRUCT EXISTING SIDEWALK OR ADD NEW SIDEWALK PER CITY STANDARD 325 AS NECESSARY TO ADEQUATELY JOIN NEW RAMP TO BE CONSTRUCTED PER CITY STD 304, WHETHER INDICATED OR NOT.

#### CONSTRUCTION DATA TABLE ABBREVIATIONS:

R&R	REMOVE AND REPLACE EXISTING IMPROVEMENT
PIP	PROTECT IN PLACE
WCR	WHEELCHAIR RAMP
S/W	SIDEWALK
D/W	DRIVEWAY
A/C	ASPHALT CONCRETE
PL	PROPERTY LINE
WM	WATER METER
MB	MAILBOX
SL	STREET LIGHT
FH	FIRE HYDRANT
PB	PULLBOX
SNS	STREET NAME SIGN
ECR	END OF CURB RETURN
BURD	BURIED UNDERGROUND ELECTRICAL DISTRIBUTION

#### SHEET INDEX:

SHEET NO.	DESCRIPTION
1	TITLE SHEET, GENERAL NOTES, AND DETAIL "A"
2	LOCATION "A" AREA MAP AND CONSTRUCTION DATA TABLE
3	LOCATION "B" AREA MAP AND CONSTRUCTION DATA TABLE
4	LOCATION "C" AREA MAP
5	LOCATIONS "C" AND "D" CONSTRUCTION DATA TABLES
6	LOCATION "D" AREA MAP

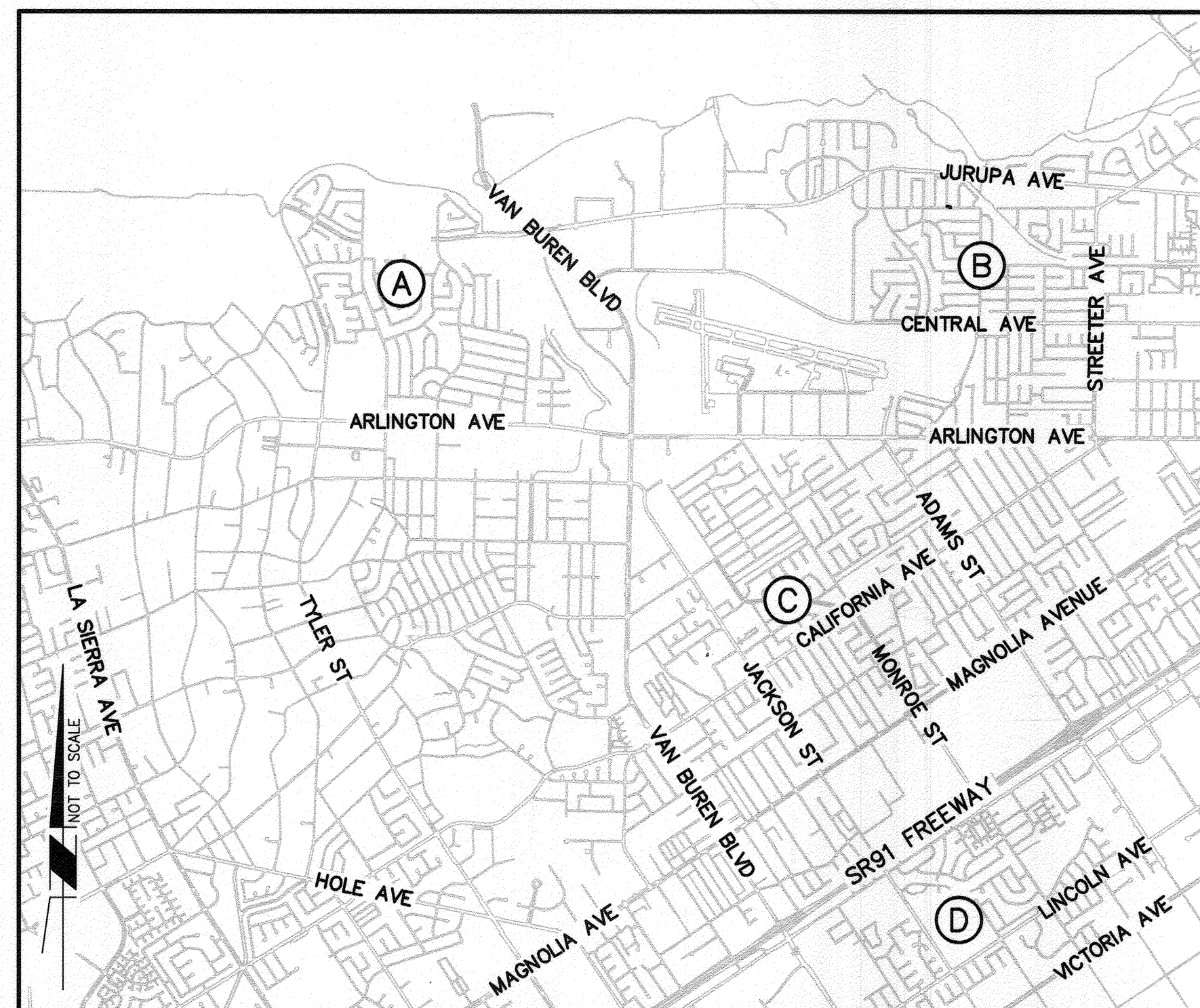

**LOCATION MAP**

# LOCATION IDENTIFICATION

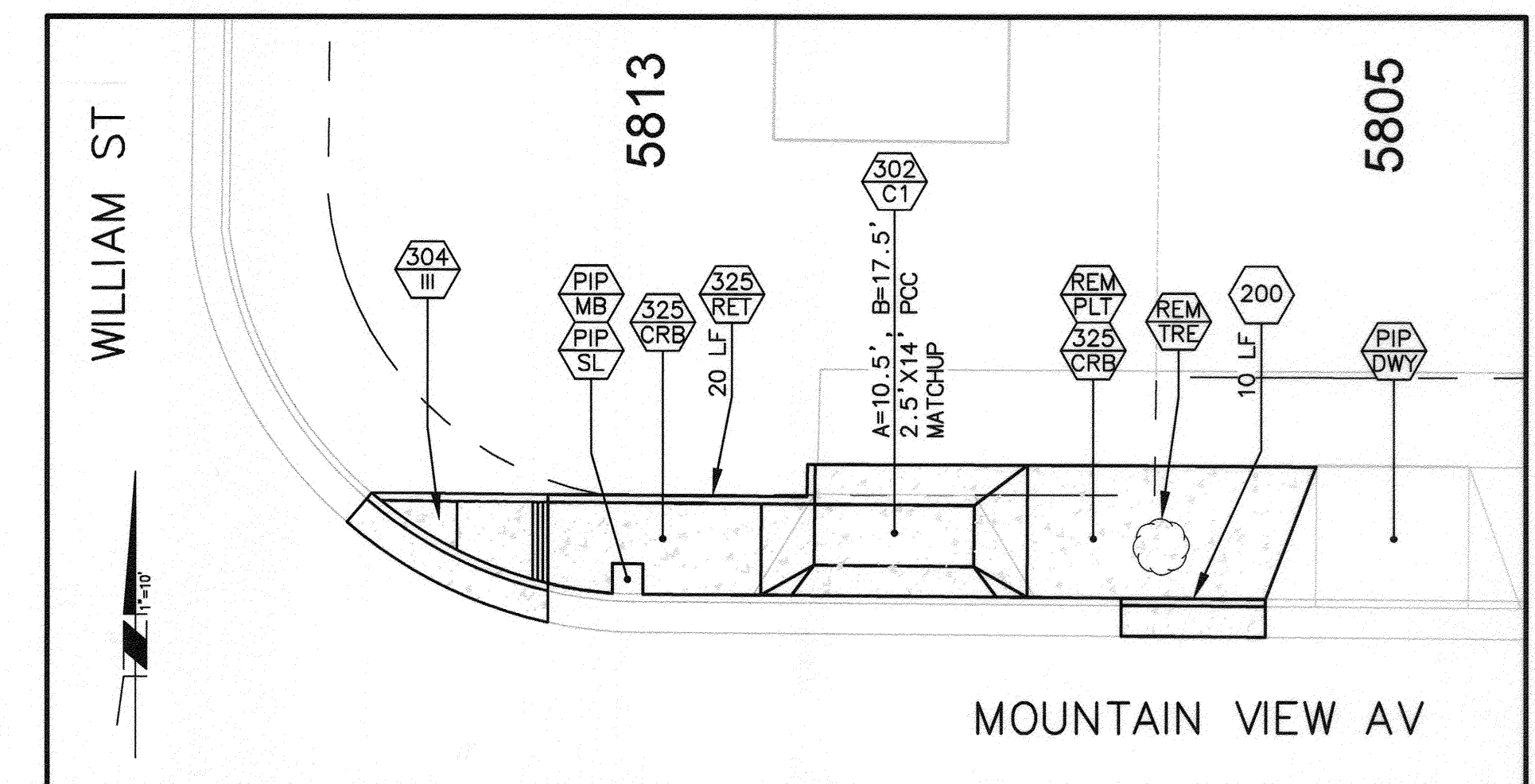

**DETAIL "A"**

#### DETAIL "A" CONSTRUCTION NOTES:

- PROTECT IN PLACE, DESCRIPTION PER PLAN (---): (MB) MAILBOX. (PP) POWER POLE.
- REMOVE EXISTING, DESCRIPTION PER PLAN (---): (TREE) REMOVE TREE AS PART OF CLEARING AND GRUBBING. (PLT) PLANTER.
- REMOVE AND REPLACE CURB AND GUTTER PER CITY STD 200.
- REMOVE AND REPLACE DRIVEWAY PER CITY STD 302 WITH THE FOLLOWING TYPE (---): (C1) = TYPE CURB-1.
- CONSTRUCT WHEELCHAIR RAMP PER CITY STD 304 WITH THE FOLLOWING TYPE (---): (III) = TYPE III.
- CONSTRUCT SIDEWALK PER CITY STD 325 WITH THE FOLLOWING TYPE OR MODIFICATION (---): (CRB) = CONSTRUCT CURBSIDE SIDEWALK PER STD. PLANS. (RET) = CONSTRUCT RETAINING CURB MONOLITHIC WITH SIDEWALK. INCLUDES CURB HEIGHTS UP TO 18".

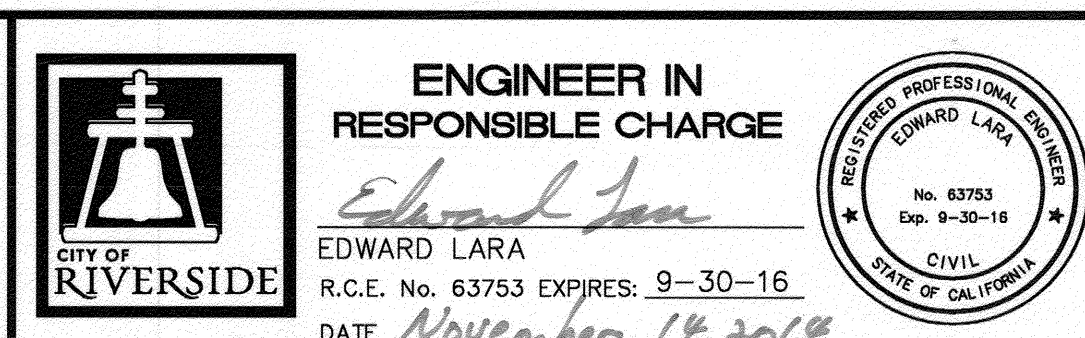

MARK	REVISIONS	APPR.	DATE

CITY OF RIVERSIDE, CALIFORNIA DEPARTMENT OF PUBLIC WORKS			
APPROVED BY	BY	DATE	APPROVED BY
ENGINEERING MANAGER	EN	11/17/14	[Signature]
CONSTRUCTION ADMIN.	DC	11/18/14	CITY ENGINEER
TRAFFIC DIVISION	KA	11.20.14	DATE 11/21/2014
STREETS SERVICES			

WHEELCHAIR RAMP IMPROVEMENTS	
2013/2014 - SB821 WHEELCHAIR RAMP CONSTRUCTION	
TITLE SHEET, GENERAL NOTES, AND DETAIL "A"	
HORIZ. SCALE: N/A	VERT. SCALE: N/A

DESIGN WORK ORDER: #1420238 CONSTR. WORK ORDER: #1420242	M-475
SHEET 1 OF 6	FILE NAME: M475-1.DWG

AS-BUILT 10-21-15 DC

INDEXED 10-21-15 DC



**LOCATION "A" AREA MAP**

LOCATION "A" CONSTRUCTION DATA TABLE				
NO.	LOCATION	QUAD.	RAMP TYPE	REMARKS
1	AULD & MACY	SW	II-A	PIP SL, PIP WALL
2	DUNN & COBB	NE	II-A	PIP WM
3	JULIAN & IDYLLWILD	NW	II-A	PIP WALL, PIP MB
4	IDYLLWILD & ONTARIO	SW	II-A	PIP WM
5	ALTA LOMA & ONTARIO	SE	II-A	PIP FH
6	IDYLLWILD & MEDALLION	NW	I MOD	TYPE I RAMP WITH RETAINING CURB ON BOTH SIDES
7	IDYLLWILD & MANDALAY	SW	VII	A=16.5', B=23.5', CONSTRUCT WCR AT 7.5% R&R 80 SF MODIFIED SIDEWALK (6" THICK) BEHIND D/W APPROACH AT 2% R&R 185 SF S/W EAST OF D/W PER STANDARD SPECIFICATION 325 (PROPERTY LINE), REMOVE EXISTING A/C PATCH, PIP RISER
8	BATAVIA & MANDALAY	SE	VII	A=12', B=19', PIP ELECTRIC BURD, PIP FENCE COLUMN, RECONSTRUCT HALF D/W ONLY
9	PASADENA & MANDALAY	SW	I MOD	TYPE I RAMP WITH RETAINING CURB ON BOTH SIDES, PIP RISER, PIP WM
10	AUSTIN & MANDALAY	SE	I MOD	TYPE I RAMP WITH RETAINING CURB ON BOTH SIDES, PIP TREE, PIP WM
11	CUCAMONGA & NOVATO	NE	II-A	PIP RISER
12	CUCAMONGA & SAN PEDRO	SE	II-A	
13	BUTTE & CUCAMONGA	SE	II-A	CONSTRUCT WCR BETWEEN DRIVEWAYS, PIP PLANTER
14	TYLER & VERONA	NW	II-A	TRIM BUSHES
15	EUREKA & CARDIFF	SW	VII	A=21', B=28', PIP MB, RECONSTRUCT HALF DRIVEWAY ONLY
16	VERONA & ASTORIA	SE	VII	A=16', B=23', PIP MB, PIP WM, CONSTRUCT WCR ON NORTH SIDE OF DRIVEWAY, RECONSTRUCT HALF DRIVEWAY ONLY
17	MENDOCINO & PRESIDIO	SE	VII	A=16.5', B=23.5', PIP MB, RECONSTRUCT HALF DRIVEWAY ONLY
18	OLYMPIA & LEUCADIA	NW	II-VII	PIP WM
19	MENDOCINO & LEUCADIA	SE	I MOD	TYPE I RAMP WITH RETAINING CURB ON BOTH SIDES, PIP PB, PIP SL, CONSTRUCT WCR BETWEEN SL AND ELECTRIC PB
20	OLYMPIA & JAMAICA	SE	I MOD	TYPE I RAMP WITH RETAINING CURB ON BOTH SIDES, PIP WM, PIP SL
21	SAN JOAQUIN & HILLSBOROUGH	NE	I MOD	TYPE I RAMP SLOPED AT 8.33% CONSTRUCT DEPRESSED LANDING AND CONSTRUCT WINGS TO MEET WITH EXISTING S/W. CONSTRUCT RETAINING CURB ON ALL SIDES OF WCR.
22	OLYMPIA & HILLSBOROUGH	SE	VII	A=16.5', B=23.5', PIP MB, PIP RISER
23	CREST & LEUCADIA	SE	VII	A=16.5', B=23.5', PIP MB
24	CREST & ENCANTO	SW	VII	A=12.5', B=19.5', PIP MB
25	CREST & HILLSBOROUGH	NE	I MOD	TYPE I RAMP WITH RETAINING CURB ON BOTH SIDES, R&R 280 SF S/W NORTH AND SOUTH OF WCR, R&R 11 LF CURB AND GUTTER SOUTH OF WCR, PIP MB, PIP FH. REMOVE CROSSWALK MARKINGS ON SOUTH SIDE OF INTERSECTION USING WET SANDBLASTING AND FOG SEAL PER SPECIAL PROVISIONS.
26	DORINDA & ALTADENA	SW	I MOD	TYPE I RAMP WITH RETAINING CURB ON BOTH SIDES, PIP PB, CONSTRUCT WCR NORTH OF ELECTRIC FACILITIES
27	COMSTOCK & ALTADENA	NW	I MOD	TYPE I RAMP WITH RETAINING CURB ON BOTH SIDES
28	MANITOBA & KEATING	NE	I MOD	R&R 250 SF S/W NORTH AND SOUTH OF WCR, PIP FENCE
29	ALTADENA & KEATING	SW	I MOD	TYPE I RAMP WITH RETAINING CURB BOTH SIDES, R&R 90 SF S/W WEST OF WCR, PIP TREE, PIP RISER
30	FARRIER & ALTADENA	SE	I MOD	TYPE I RAMP WITH RETAINING CURB ON BOTH SIDES, PIP RSR, PIP PB, PIP TREE
31	COMSTOCK & HOBART	NW	VII	A=16', B=24', PIP MB, RECONSTRUCT HALF DRIVEWAY ONLY
32	ECHO & HOBART	NW	VII	A=16', B=24', PIP MB
33	BISCAYNE & HOBART	NE	I MOD	TYPE I RAMP WITH RETAINING CURB ON BOTH SIDES, REMOVE CLASS I TREE, R&R 150 SF S/W SOUTH OF WCR, PIP SL
34	DORINDA & ENCANTO	NE	I MOD	TYPE I RAMP WITH RETAINING CURB ON BOTH SIDES, PIP MB
35	COMSTOCK & DAYTONA	SE	I MOD	TYPE I RAMP WITH RETAINING CURB ON BOTH SIDES, R&R 24 SF S/W, PIP TREE, PIP SIGN
36	BISCAYNE & DAYTONA	NE	I MOD	TYPE I RAMP WITH RETAINING CURB ON BOTH SIDES, PIP TREE, PIP PB
37	ADAIR & RANDOLPH	NW	I MOD	TYPE I RAMP WITH RETAINING CURB ON BOTH SIDES
38	MIA & RANDOLPH	NE	VII	A=16.5', B=23.5', PIP MB, PIP SIGN. REFRESH EX. CROSSWALKS ON EAST AND SOUTH SIDES OF INTERSECTION.
39	FARRIER & FIREBIRD	SW	VII	A=16', B=24'
40	RUTLAND & ALABAMA	SW	II-A	PIP RISER, PIP MB
41	RUTLAND & BRADFORD	E	II-A	PIP POST AND FENCING
42	ROSSINI & BRADFORD	E	II-A	
43	ALABAMA & BRADFORD	NE	II-A	
44	GLLENDALE & RANDOLPH	SE	II-VII	CONSTRUCT WCR WEST OF DRIVEWAY AT 8746 RANDOLPH STREET. RELOCATE MB OUT OF EASTERLY WCR WING. ADJUST WATER METER WITHIN WESTERLY WCR WING.
45	GREEN & RANDOLPH	SW	VII	A=16', B=23', 5' X 30' DRIVEWAY MATCHUP AT 14% SLOPE (SAWCUT CONCRETE DRIVEWAY AS NECESSARY). RELOCATE MB OUT OF PROPOSED DRIVEWAY WING.
46	PALOS & RANDOLPH	SE	VII	A=16', B=23', 8' X 30' DRIVEWAY MATCHUP (SAWCUT CONCRETE DRIVEWAY AS NECESSARY), PIP MB
47	MALLARD & RANDOLPH	SE	VII	A=23', B=30', 5' DRIVEWAY MATCHUP (SAWCUT CONCRETE DRIVEWAY AS NECESSARY), RELOCATE MB OUT OF PROPOSED DRIVEWAY WING

Under Ground Service Alert of Southern California  
Call: TOLL FREE 1-800 227-2600  
TWO WORKING DAYS BEFORE YOU DIG

**ENGINEER IN RESPONSIBLE CHARGE**  
Edward Lara  
R.C.E. No. 63753 EXPIRES: 9-30-16  
DATE: November 14, 2014

**CITY OF RIVERSIDE**  
EDWARD LARA  
No. 63753 Exp. 9-30-16  
CIVIL  
STATE OF CALIFORNIA

AS-BUILT  
DESIGNED BY BA DRAWN BY BA CHECKED BY EL

**CITY OF RIVERSIDE, CALIFORNIA DEPARTMENT OF PUBLIC WORKS**  
APPROVED BY: [Signature] DATE: 11/20/14  
CONSTRUCTION ADMIN. DATE: 11/20/14  
TRAFFIC DIVISION DATE: 11/20/14  
STREETS SERVICES

**WHEELCHAIR RAMP IMPROVEMENTS**  
2013/2014 - SB821  
WHEELCHAIR RAMP CONSTRUCTION  
LOCATION 'A' AREA MAP AND CONSTRUCTION DATA TABLE  
HORIZ. SCALE: 1"=300' VERT. SCALE: N/A

DESIGN WORK ORDER: #1420238  
CONSTR. WORK ORDER: #1420242  
M-475  
SHEET 2 OF 6  
FILE NAME: M475-2.DWG

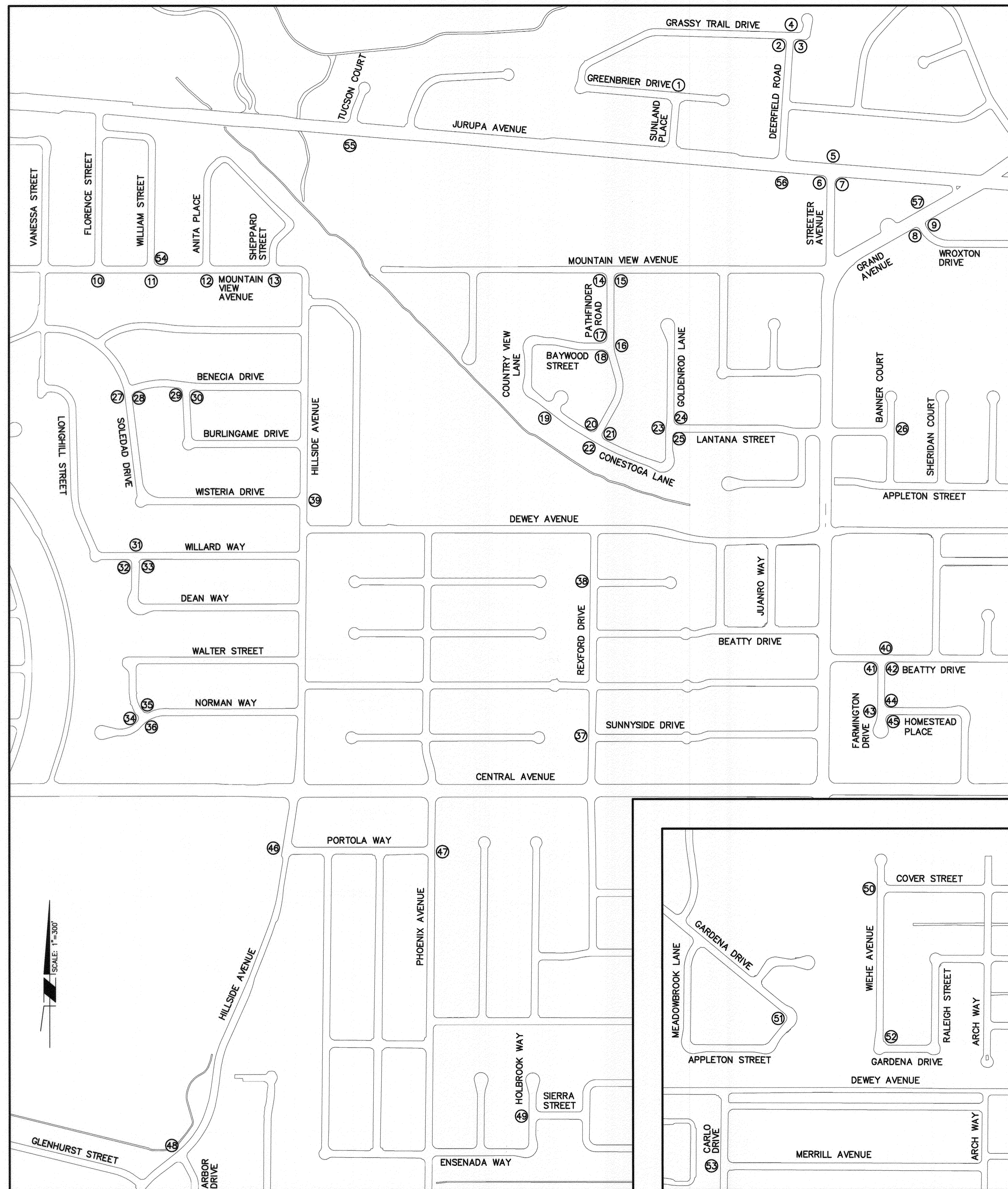

LOCATION "B" CONSTRUCTION DATA TABLE					
NO.	LOCATION	QUAD.	RAMP TYPE	REMARKS	
1	GREENBRIER & SUNLAND	NE	VII	A=17', B=24', R&R 30 SF S/W (6" THICK)	
2		NE	II-A MOD	TRIM HEDGE, CONSTRUCT LANDING IN S/W AND RAMP UP ON EITHER SIDE	
3	DEERFIELD & GRASSY TRAIL	SE	II MOD	CONSTRUCT LANDING IN S/W AND RAMP UP ON EITHER SIDE, PIP PLANTER	
4		SW	II MOD	CONSTRUCT LANDING IN S/W AND RAMP UP ON EITHER SIDE, PIP PLANTER, R&R 135 SF SIDEWALK (SOUTH SIDE), R&R 30 SF S/W (NORTH SIDE)	
5	STREETER & JURUPA	NW	VII	A=38', B=45', 5315 JURUPA AV: 15' X 20' D/W MATCHUP, RECONSTRUCT 15.5' RETAINING CURB ALONG EX. LANDSCAPE BORDER FOLLOWING D/W MATCHUP, 5305 JURUPA AV: 15' X 25' D/W MATCHUP, RECONSTRUCT 16.5' RETAINING CURB ALONG D/W MATCHUP, RECONSTRUCT 7' BLOCK WALL, CONSTRUCT WCR ON EASTERLY SIDE OF D/W, SAWCUT CONCRETE AS NECESSARY, PIP SIGNAL EQUIPMENT, PIP PB, PIP SL	
6		SW	I	R&R, PIP SIGNAL EQUIPMENT	
7		SE	I	R&R, PIP SIGNAL EQUIPMENT	
8	GRAND & WROXTON	SE	V	R&R, PIP FH, PIP SNS, PIP FENCE, ADJUST SL PULLBOX	
9		SW	V	R&R, PIP WALL, PIP SIGN	
10	MOUNTAIN VIEW & FLORENCE	SE	II MOD	A=16', B=23', PIP MB	
11	MOUNTAIN VIEW & WILLIAM	SW	I MOD	TYPE I RAMP WITH RETAINING CURB ON BOTH SIDES, PIP TREE, CONSTRUCT WCR ALONG WEST PROPERTY LINE AT 5820 MOUNTAIN VIEW AV.	
12	MOUNTAIN VIEW & ANITA	SW	VII	A=10.5', B=17.5', PIP WM, PIP TREE, PIP MB (5774 MOUNTAIN VIEW)	
13	MOUNTAIN VIEW & SHEPPARD	SE	I MOD	TYPE I RAMP WITH RETAINING CURB ON BOTH SIDES, PIP WM	
14	PATHFINDER & MOUNTAIN VIEW	SW	I	R&R	
15		SE	I	R&R	
16		SE	II-A		
17	PATHFINDER & BAYWOOD	NW	I	R&R	
18		SW	I	R&R, RELOCATE SNS PER CITY STANDARD 662, REPLACE STOP SIGN POST	
19	CONESTOGA & COUNTRY VIEW	SE	II-A	CONSTRUCT ENTIRE RAMP JUST EAST OF MAILBOX, PIP MB	
20		NW	I	R&R, REPLACE STOP SIGN POST, REPLACE SNS POST	
21	CONESTOGA & PATHFINDER	NE	I	R&R	
22		SW	II-A	PIP RISER, PIP PULLBOX, PIP CATCH BASIN	
23		SW	II-A	PIP FH	
24	GOLDENROD & LANTANA	NE	I	R&R, REPLACE STOP SIGN POST, REPLACE SNS POST	
25		SE	I	R&R	
26	LANTANA & BANNER	NE	I MOD	TYPE I RAMP WITH RETAINING CURB ON BOTH SIDES	
27	BENECIA & SOLEDAD	SW	I MOD	CONSTRUCT 5' WIDE RAMP WITH RETAINING CURB ON BOTH SIDES FROM FRONT OF EX. S/W, R&R 30 SF S/W WITH 0-18" RETAINING CURB AROUND BACK AND SIDE TO JOIN RAMP	
28		SE	IV-A MOD	TYPE I RAMP WITH ONE WING ONLY	
29	BENECIA & BURLINGAME	SW	II MOD	TYPE II RAMP WITH RETAINING CURB ON ONE SIDE, CONSTRUCT 50 SF S/W TO MATCH EX., PIP FH, PIP SL, R&R 10 LF C&G	
30		SE	II MOD	TYPE II RAMP WITH RETAINING CURB ON ONE SIDE, CONSTRUCT 50 SF S/W TO MATCH EX., RELOCATE SNS PER CITY STANDARD 662	
31		NW	II-A MOD	CONSTRUCT 2' RAMP AT 8.33%, CONSTRUCT 4' LANDING AT 2%, CONSTRUCT 50 SF S/W ON BOTH SIDES OF RAMP TO MATCHUP WITH EXISTING S/W.	
32	WILLARD & DEAN	SW	II MOD	CONSTRUCT 0.5' RAMP AT 8.33%, CONSTRUCT 4' LANDING AT 2% AND RAMP UP ON EITHER SIDE, INSTALL 2' X 4' TRUNCATED DOME PANEL IN LANDING ADJACENT TO 0.5' RAMP, PIP FENCE, PIP SL	
33		SE	II MOD	CONSTRUCT 0.5' RAMP AT 8.33%, CONSTRUCT 4' LANDING AT 2% AND RAMP UP ON EITHER SIDE, INSTALL 2' X 4' TRUNCATED DOME PANEL IN LANDING ADJACENT TO 0.5' RAMP, PIP FENCE	
34		NW	II MOD	CONSTRUCT 0.5' RAMP AT 8.33%, CONSTRUCT 4' LANDING AT 2% AND RAMP UP ON EITHER SIDE, INSTALL 2' X 4' TRUNCATED DOME PANEL IN LANDING ADJACENT TO 0.5' RAMP	
35	WALTER & NORMAN	NE	II MOD	CONSTRUCT 0.5' RAMP AT 8.33%, CONSTRUCT 4' LANDING AT 2% AND RAMP UP ON EITHER SIDE, INSTALL 2' X 4' TRUNCATED DOME PANEL IN LANDING ADJACENT TO 0.5' RAMP, PIP FENCE, PIP SL, R&R 75 SF S/W	
36		SW	II-A MOD	CONSTRUCT 0.5" RAMP AT 8.33%, CONSTRUCT 4' LANDING AT 2%, AND RAMP UP ON EITHER SIDE, INSTALL 2' X 4' TRUNCATED DOME PANEL IN LANDING ADJACENT TO 0.5' RAMP.	
37	REXFORD & SUNNYSIDE	NW	I MOD	TYPE I RAMP WITH RETAINING CURB ON BOTH SIDES, RECONSTRUCT 65 SF CONCRETE PAD ADJACENT TO WCR RETAINING CURB, PIP FH, PIP TREE	
38	REXFORD & AGNES	SW	I MOD	TYPE I RAMP WITH RETAINING CURB ON BOTH SIDES, PIP FH, PIP TREE	
39	HILLSIDE & WISTERIA	SE	I MOD	TYPE I RAMP WITH RETAINING CURB ON BOTH SIDES, PIP PP	
40		NE	I MOD	TYPE I RAMP WITH RETAINING CURB ON BOTH SIDES	
41	FARMINGTON & BEATTY	SW	I	PIP FH	
42		SE	I	REPLACE SNS POST	
43		NW	II-A	PIP SL, PIP PULLBOX	
44	FARMINGTON & HOMESTEAD	NE	I	R&R, REPLACE STOP SIGN POST, RELOCATE SNS PER CITY STANDARD 662	
45		SE	I	R&R	
46	PORTOLA & HILLSIDE	NW	II-A	PIP SIGN	
47	PORTOLA & PHOENIX	NE	I MOD	TYPE I RAMP WITH RETAINING CURB ON BOTH SIDES, REMOVE CONCRETE LANDSCAPE BORDER, PIP TREE	
48	HILLSIDE & ARBOR	SW	II-A		
49	HOLBROOK & SIERRA	NW	VII	A=18', B=25', CONSTRUCT 7' PCC DRIVEWAY MATCHUP, R&R 108 SF S/W	
50	COVER & WIEHE	NW	I MOD	TYPE I RAMP WITH RETAINING CURB ON BOTH SIDES	
51	APPLETON & GARDENA	WEST	IV	RELOCATE SNS PER CITY STANDARD 662	
52	GARDENA & WIEHE	NE	IV	RELOCATE SNS PER CITY STANDARD 662	
53	MERRILL & CARLO	NW	I MOD	TYPE I RAMP WITH RETAINING CURB ON BOTH SIDES, PIP TREE	
54	MOUNTAIN VIEW & WILLIAM	NE	III	SEE DETAIL "A" ON SHEET 1	
55	TUCSON & JURUPA	SE	II-A MOD	A=21', B=35', RECONSTRUCT HALF OF DRIVEWAY ONLY	
56	DEERFIELD & JURUPA	SE	I MOD	TYPE I RAMP WITH RETAINING CURB ON BOTH SIDES	
57	GRAND & WROXTON	NE	II-A	PIP FENCE	

**LOCATION "B" AREA MAP**

Under Ground Service Alert of Southern California  
 Call: TOLL FREE 1-800-227-2600  
 TWO WORKING DAYS BEFORE YOU DIG

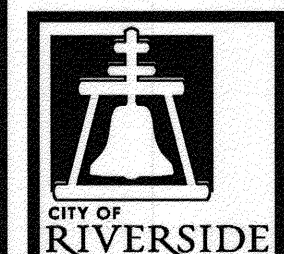

**ENGINEER IN RESPONSIBLE CHARGE**  
 Edward Lara  
 R.C.E. No. 63753 EXPIRES: 9-30-16  
 DATE: November 14, 2014

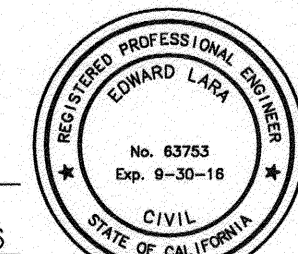

AS-BUILT	11/18/14	
MARK	REVISIONS	
DESIGNED BY: BA	DRAWN BY: BA	CHECKED BY: EL

**CITY OF RIVERSIDE, CALIFORNIA DEPARTMENT OF PUBLIC WORKS**

APPROVED BY: [Signature] DATE: 11/18/14  
 ENGINEERING MANAGER  
 CONSTRUCTION ADMIN. DATE: 11/20/14  
 TRAFFIC DIVISION DATE: 11/20/14  
 STREETS SERVICES

**WHEELCHAIR RAMP IMPROVEMENTS**

2013/2014 - SB821  
**WHEELCHAIR RAMP CONSTRUCTION**

LOCATION "B" AREA MAP AND CONSTRUCTION DATA TABLE  
 HORIZ. SCALE: 1"=300' VERT. SCALE: N/A

DESIGN WORK ORDER: #1420238  
 CONSTR. WORK ORDER: #1420242

**M-475**

SHEET 3 OF 6  
 FILE NAME: M475-3.DWG

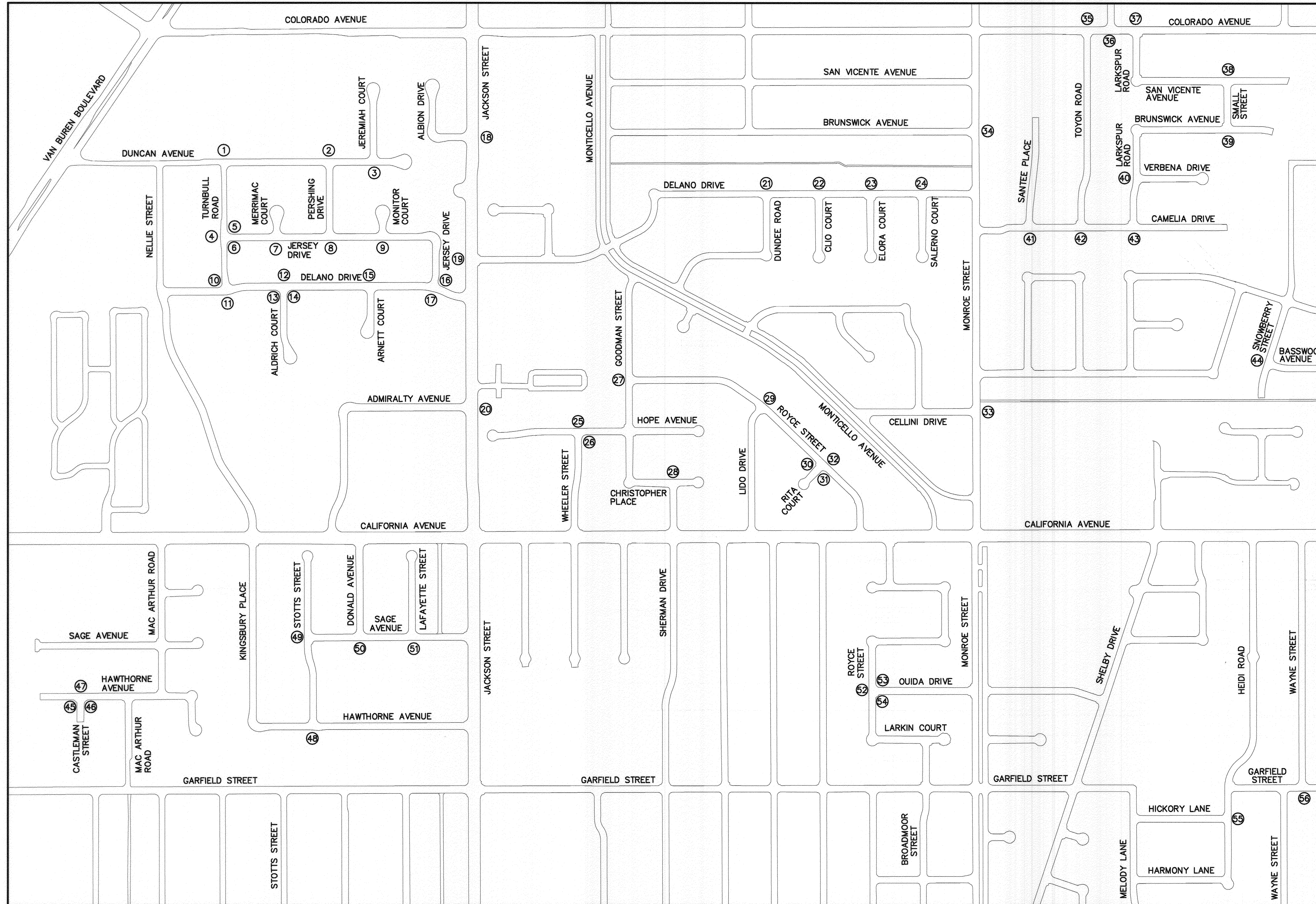

**LOCATION "C" AREA MAP**

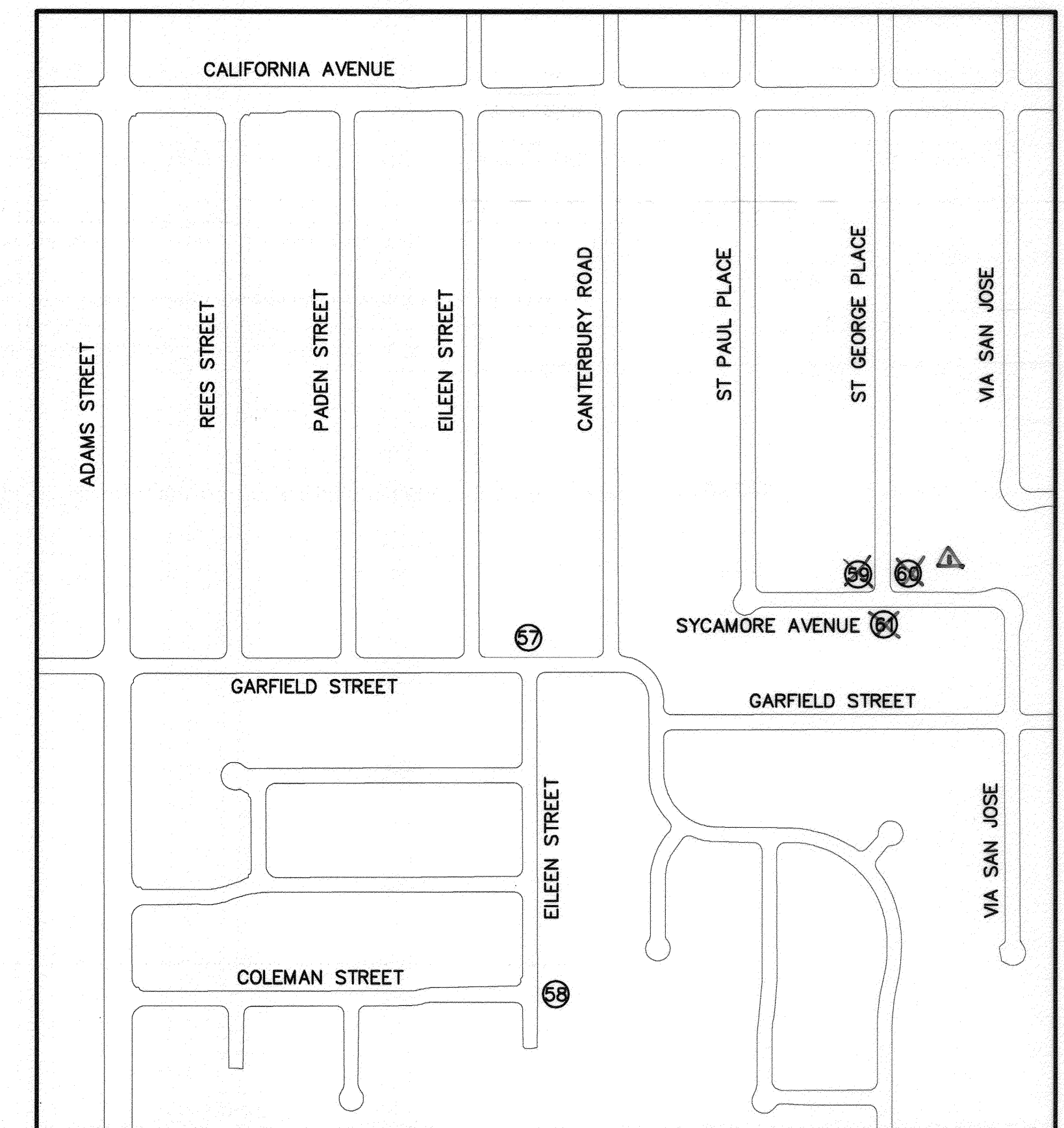

**LOCATION "C" AREA MAP**

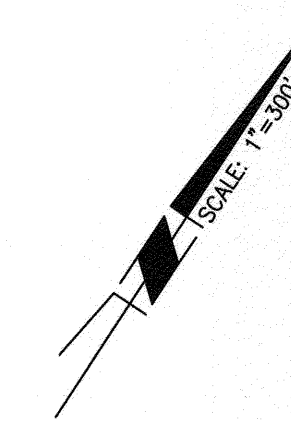

Under Ground Service Alert of Southern California  
Call: TOLL FREE 1-800-227-2600  
TWO WORKING DAYS BEFORE YOU DIG

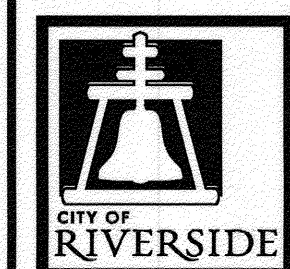

**ENGINEER IN RESPONSIBLE CHARGE**  
*Edward Lara*  
EDWARD LARA  
R.C.E. No. 63753 EXPIRES: 9-30-16  
DATE: November 14, 2014

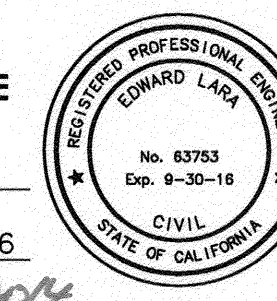

AS-BUILT	6/6	2/16
MARK	REVISIONS	APPR. DATE
DESIGNED BY BA	DRAWN BY BA	CHECKED BY EL

CITY OF RIVERSIDE, CALIFORNIA DEPARTMENT OF PUBLIC WORKS		
APPROVED BY	BY	DATE
ENGINEERING MANAGER	FM	11/27/14
CONSTRUCTION ADMIN.	DC	11/18/14
TRAFFIC DIVISION	S.M.	11/20/14
STREETS SERVICES		
APPROVED BY	DATE	
CITY ENGINEER	11/21/2014	

WHEELCHAIR RAMP IMPROVEMENTS
2013/2014 - SB821 WHEELCHAIR RAMP CONSTRUCTION
LOCATION "C" AREA MAP
HORIZ. SCALE: 1"=300' VERT. SCALE: N/A

DESIGN WORK ORDER: #1420238  
CONSTR. WORK ORDER: #1420242  
**M-475**  
SHEET 4 OF 6  
FILE NAME: M475-4.DWG

LOCATION "C" CONSTRUCTION DATA TABLE

NO.	LOCATION	QUAD	RAMP TYPE	REMARKS
1	TURNBILL & DUNCAN	NE	II-A	PIP FH, PIP WM, PIP FENCE
2	DUNCAN & PERSHING	NE	II-A	PIP SL
3	JEREMIAH & DUNCAN	SW	II-A	PIP RISER, PIP PB
4		NW	II-A	PIP WM, PIP ELEC. PB, PIP ELEC. VAULT
5	JERSEY & TURNBULL	NE	I	R&R
6		SE	I	R&R
7	MERRIMAC & JERSEY	SW	II-A	A=20.5', B=27.5', 5' D/W MATCHUP, PIP MB, SAWCUT AS NECESSARY
8	JERSEY & PERSHING	SE	II-A	PIP MB, PIP SD INLET, PIP CHAIN LINK FENCE, COORDINATE WITH RPU WATER TO EXTEND WATER METER TO BACK OF LANDING
9	JERSEY & MONITOR	NW	II-A	PIP FH
10	DELANO & TURNBULL	NW	I	R&R
11		SW	II-A	
12		NW	II-A	PIP WM, PIP SL, R&R 66 SF S/W
13	DELANO & ALDRICH	SW	I	R&R
14		SE	I	R&R
15	DELANO & ARNETT	SW	II-A	PIP WM, PIP LANDSCAPE WALL
16		NE	II	R&R, PIP FENCE
17	JERSEY & DELANO	SW	II-A	
18	JACKSON & ALBION	SE	II-A	PIP FENCE
19	JACKSON & DELANO	NW	II-A	PIP PB
20	JACKSON & ADMIRALTY	SE	II-A	PIP FENCE
21	DELANO & DUNDEE	NE	VII	A=14', B=19', EASTERLY WING=3.5', WESTERLY WING=1.5', PIP MB, PIP SIGN, PIP PALM TREE
22	CLIO & DELANO	NE	VII	A=10', B=17'
23	DELANO & ELORA	NE	I MOD	TYPE I RAMP WITH RETAINING CURB ON BOTH SIDES, RAMP TO BE LOCATED BETWEEN DRIVEWAYS
24	DELANO & SALERNO	NE	I MOD	TYPE I RAMP WITH RETAINING CURB ON BOTH SIDES, RAMP TO BE LOCATED BETWEEN DRIVEWAYS
25		NE	I MOD	TYPE I RAMP WITH RETAINING CURB ON BOTH SIDES
26	WHEELER & HOPE	SE	IV	PIP PLANTER, PIP SIGN
27	GOODMAN & ROYCE	NW	I MOD	TYPE I RAMP WITH RETAINING CURB ON BOTH SIDES, RELOCATE STOP SIGN SOUTH OF WCR, PIP WM
28	CHRISTOPHER & SHERMAN	NW	I MOD	TYPE I RAMP WITH RETAINING CURB ON BOTH SIDES
29	ROYCE & LIDO	NE	II-A	A=13', B=20
30		SW	IV	PIP FENCE, PIP PLANTER
31	RITA & ROYCE	SE	IV	PIP PLANTER
32		N	I MOD	TYPE I RAMP WITH RETAINING CURB ON BOTH SIDES
33	MONROE & CELLINI	NE	I MOD	TYPE I RAMP WITH RETAINING CURB ON BOTH SIDES
34	MONROE & BRUNSWICK	SE	I MOD	TYPE I RAMP WITH RETAINING CURB ON BOTH SIDES, RELOCATE MB
35	TOYON & COLORADO	NE	VII	A=16', B=23'
36	COLORADO & LARKSPUR (W)	SW	I MOD	TYPE I RAMP WITH RETAINING CURB ON BOTH SIDES, PIP TREE, PIP SL
37	COLORADO & LARKSPUR (E)	NE	VII	A=10', B=17', PIP MB
38	SAN VICENTE & SMALL	NW	I MOD	TYPE I RAMP WITH RETAINING CURB ON BOTH SIDES, PIP SL PB, CONSTRUCT IN PARKWAY PLANTER
39	BRUNSWICK & SMALL	SE	I MOD	TYPE I RAMP WITH RETAINING CURB ON BOTH SIDES, PIP WM, CONSTRUCT WEST OF WM
40	LARKSPUR & VERBENA	SW	I MOD	TYPE I RAMP WITH RETAINING CURB ON BOTH SIDES, PIP TREE, PIP WM
41	CAMELIA & SANTEE	SE	I MOD	TYPE I RAMP WITH RETAINING CURB ON BOTH SIDES
42	CAMELIA & TOYON	SE	I MOD	TYPE I RAMP WITH RETAINING CURB ON BOTH SIDES, PIP TREE, PIP FH
43	CAMELIA & LARKSPUR	SW	I MOD	TYPE I RAMP WITH RETAINING CURB ON BOTH SIDES, AVOID TREE ROOTS
44	SNOWBERRY & BASSWOOD	NW	I MOD	TYPE I RAMP WITH RETAINING CURB ON BOTH SIDES
45		SW	IV	PIP ROCK, PIP TREE
46	CASTLEMAN & HAWTHORNE	SE	IV	PIP TREE, PIP SIGN
47		NE	I MOD	TYPE I RAMP WITH RETAINING CURB ON BOTH SIDES, R&R 210 SF S/W EAST OF WCR, PIP WM
48	STOTTS & HAWTHORNE	SW	I MOD	TYPE I RAMP WITH RETAINING CURB ON BOTH SIDES, PIP MB
49	STOTTS & SAGE	SW	VII	A=16', B=23', R&R 150 SF S/W NORTH OF D/W, R&R 40 SF S/W SOUTH OF D/W
50	DONALD & SAGE	SW	I MOD	TYPE I RAMP WITH RETAINING CURB ON BOTH SIDES
51	SAGE & LAFAYETTE	SW	I MOD	TYPE I RAMP WITH RETAINING CURB ON BOTH SIDES
52		SW	I MOD	TYPE I RAMP WITH RETAINING CURB ON BOTH SIDES
53	ROYCE & OUIDA	NE	IV	R&R 210 SF S/W
54		SE	IV	
55	HICKORY & HEIDI	SE	I MOD	TYPE I RAMP WITH RETAINING CURB ON BOTH SIDES, PIP WM, PIP TREE
56	GARFIELD & WAYNE	SW	I MOD	TYPE I RAMP WITH RETAINING CURB ON BOTH SIDES, R&R 195 SF S/W, REMOVE PAVERS
57	GARFIELD & EILEEN (E)	NE	II-A MOD	CONSTRUCT WCR IN EXISTING D/W WING, CONSTRUCT EAST WCR SCORE LINES JUST WEST OF D/W "A" DIMENSION
58	EILEEN & COLEMAN	SE	I MOD	TYPE I RAMP WITH RETAINING CURB ON BOTH SIDES
59		NW	IV	
60	SYCAMORE & ST GEORGE*	NE	IV	
61		SW	I MOD	TYPE I RAMP WITH RETAINING CURB ON BOTH SIDES

\* OMITTED, INCLUDED WITH BID 1305

LOCATION "D" CONSTRUCTION DATA TABLE

NO.	LOCATION	QUAD	RAMP TYPE	REMARKS
1		NW	I	REMOVE EX. (2) RAMPS, R&R 40 LF CURB AND GUTTER AND 350 SF S/W ON BOTH SIDES OF NEW RAMP, CONSTRUCT NEW RAMP IN MIDDLE OF RETURN.
2	WESTCHESTER & LINCOLN	NE	I	REMOVE EX. (2) RAMPS, R&R 40 LF CURB AND GUTTER AND 350 SF S/W ON BOTH SIDES OF NEW RAMP, CONSTRUCT NEW RAMP IN MIDDLE OF RETURN.
3		SE	I MOD	TYPE I RAMP WITH RETAINING CURB ON BOTH SIDES, PIP FH, PIP UNDERGROUND FACILITIES, CONSTRUCT RAMP WEST OF UNDERGROUND FACILITIES
4	AEGEAN & ANTARES	NE	VII	A=16.5', B=23.5', PIP WM, PIP MB, RECONSTRUCT HALF DRIVEWAY ONLY
5	GIBSON & NARNIA	SE	I MOD	TYPE I RAMP SLOPED AT 8.33%. CONSTRUCT DEPRESSED LANDING AND CONSTRUCT WINGS TO MEET WITH EXISTING S/W. CONSTRUCT RETAINING CURB ON ALL SIDES OF WCR.
6	GIBSON & DOUGLAS	NE	I MOD	TYPE I RAMP SLOPED AT 8.33%. CONSTRUCT DEPRESSED LANDING AND CONSTRUCT WINGS TO MEET WITH EXISTING S/W. CONSTRUCT RETAINING CURB ON ALL SIDES OF WCR.
7	MESQUITE & ARALIA	NW	VII	A=19.5', B=26.5', 3' DRIVEWAY MATCHUP, PIP MB
8	SAGUARO & NOPAL	NE	VII	A=25', B=32', 3' DRIVEWAY MATCHUP, PIP MB, PIP SL, PIP WM
9	JOSHUA TREE & BAMBOO	SW	I MOD	CONSTRUCT WCR BETWEEN ELECTRIC FACILITIES AND MB, PIP RISER, PIP PB, PIP RISER, PIP BURD, PIP MB
10	JACKSON & SAGUARO	NW	I MOD	TYPE I RAMP WITH RETAINING CURB ON BOTH SIDES
11	HASKELL & ARROWHEAD	NE	I MOD	TYPE I RAMP WITH RETAINING CURB ON BOTH SIDES, RELOCATE STOP BAR AND "STOP" LEGEND IN KIND EASTERLY PER STRIPING GENERAL NOTES SHOWN ON SHEET 6, R&R 65 SF S/W
12	SHAWNEE & HASKELL	SW	VII	A=11', B=18'
13	SHAWNEE & ARAPAHOE	NE	I MOD	TYPE I RAMP WITH RETAINING CURB ON BOTH SIDES, R&R 190 SF S/W, R&R 43 LF CURB AND GUTTER
14	MONROE & HOFFMAN	NW	II-A	
15	MARLENE & HASKELL	SW	I MOD	TYPE I RAMP WITH RETAINING CURB ON BOTH SIDES, R&R 25 SF S/W
16	MARLENE & ARAPAHOE	SW	I MOD	TYPE I RAMP WITH RETAINING CURB ON BOTH SIDES
17	MARLENE & TORO	NW	II-A	TYPE I RAMP WITH RETAINING CURB ON BOTH SIDES, PIP SL
18		SW	II	TRANSITION S/W FROM BACK OF RAMP TO EX. 5' S/W, PIP FH
19	MARLENE & BERNARD	NE	VII	A=10', B=17', PIP WM, RECONSTRUCT HALF DRIVEWAY ONLY
20		NW	II	PIP POWER POLE
21	IRVING & CHERBOURG	SW	I MOD	TYPE I RAMP WITH RETAINING CURB ON BOTH SIDES
22	IRVING & CONTINENTAL	SW	I MOD	TYPE I RAMP WITH RETAINING CURB ON BOTH SIDES
23	QUEBEC & CONTINENTAL	SW	II-A	PIP PARKWAY DRAIN
24	COPENHAGEN & COPENHAGEN	NW	VII	A=16.5', B=23.5', 2' PCC DRIVEWAY MATCHUP
25		NW	I	REMOVE EX. (2) RAMPS, REPLACE 40 LF CURB AND GUTTER AND 240 SF S/W ON BOTH SIDES OF NEW RAMP, CONSTRUCT NEW RAMP IN MIDDLE OF RETURN
26	MONROE & COPENHAGEN	SW	I	REMOVE EX. (2) RAMPS, REPLACE 40 LF CURB AND GUTTER AND 240 SF S/W ON BOTH SIDES OF NEW RAMP, CONSTRUCT NEW RAMP IN MIDDLE OF RETURN, PIP FH, RELOCATE SNS TO SL (CONTRACTOR TO FURNISH BRACKET)
27	MONROE & AMSTERDAM	NW	I	REMOVE EX. (2) RAMPS & REPLACE 40 LF CURB AND GUTTER WITH 240 SF S/W, CONSTRUCT NEW RAMP IN MIDDLE OF RETURN
28	MONROE & LIMESTONE	SW	II-A	PIP PARKWAY DRAIN
29	LIMESTONE & LIMESTONE	NE	VII	A=23', B=30', 27' X 3' DRIVEWAY MATCHUP
30	HARRISBURG & LIMESTONE	NW	VII	A=20.5', B=27.5', 3' DRIVEWAY MATCHUP
31	CORALBERRY & LIMESTONE	NW	II-A	PIP WM
32	SHOREPINE & LIMESTONE	SE	II-A	MAINTAIN 4' CLEARANCE BETWEEN WCR AND DRIVEWAY
33	CORALBERRY & EASTBROOK	NW	II-A	
34	CORALBERRY & MIMOSA TREE	SE	II-A	PIP WM
35	GRATTON & MIMOSA TREE	SW	II-A	MAINTAIN 4' CLEARANCE BETWEEN WCR AND DRIVEWAY, PIP ELECTRIC PB
36	SONOMA & LINCOLN	NE	II-A	
37	SONOMA & THOREAU	NW	II-A	PIP WM
38	DARWIN & THOREAU	NW	II-A	PIP WM
39	DARWIN & BAXTER	NW	II-A	CONSTRUCT RAMP 4' SOUTH OF DRIVEWAY
40	GRATTON & WILLIAMSBURG	NW	II-A	PIP MB
41	JAMESTOWN & LINCOLN	SW	II-A	
42	TROPICANA & SPICEWOOD	NW	II-A	PIP PB
43	LEATHERWOOD & TROPICANA	NE	II-A	PIP WM
44	MONROE & TURLOCK	SW	I MOD	TYPE I RAMP WITH RETAINING CURB ON BOTH SIDES
45	CONTINENTAL & LINCOLN	SE	I MOD	TYPE I RAMP WITH RETAINING CURB ON BOTH SIDES
46	IRVING & MARION	SE	I MOD	TYPE I RAMP WITH RETAINING CURB ON BOTH SIDES
47	MARION & CARMA	NE	II-A	PIP MB, PIP SL, CONSTRUCT RAMP BETWEEN SL AND MB
48		NW	IV	
49	COPLEY & CASCABEL	NE	IV	
50		SW	IV	A=16', B=23'
51		NW	IV	PIP TREE
52	COPLEY & RONCADOR	NE	IV	PIP WALL, PIP BUSH
53		SE	IV	A=16', B=24', PIP WM
54	JACKSON & COPLEY	NE	IV MOD	DEPRESS THE LANDING AND CONSTRUCT BOTH RAMPS UP TO MEET EX. S/W WITH RETAINING CURB ON BOTH SIDES, R&R 125 SF NORTHERLY, R&R 15 LF CURB AND GUTTER, PIP WALL
55		SE	IV MOD	DEPRESS THE LANDING AND CONSTRUCT BOTH RAMPS UP TO MEET EX. S/W WITH RETAINING CURB ON BOTH SIDES, R&R 15 LF CURB AND GUTTER, TRIM HEDGE
56	GIBSON & JONQUIL	NW	I MOD	TYPE I RAMP WITH RETAINING CURB ON BOTH SIDES, PIP TREE

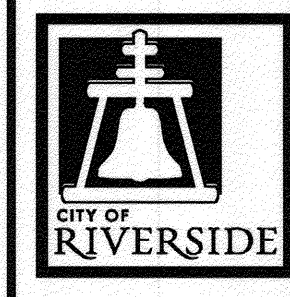

ENGINEER IN RESPONSIBLE CHARGE  
 Edward Lara  
 R.C.E. No. 63753 EXPIRES: 9-30-16  
 DATE: November 14, 2014

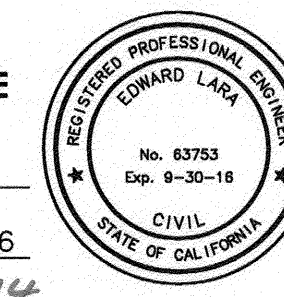

AS-BUILT	DATE	11/21/14
DESIGNED BY	BA	
DRAWN BY	BA	
CHECKED BY	EL	

CITY OF RIVERSIDE, CALIFORNIA DEPARTMENT OF PUBLIC WORKS			
APPROVED BY	BY	DATE	APPROVED BY
ENGINEERING MANAGER	EM	11/17/14	C. B. J.
CONSTRUCTION ADMIN.	DC	11/18/14	
TRAFFIC DIVISION	SL	11-20-14	
STREETS SERVICES			
DATE	11/21/2014		

WHEELCHAIR RAMP IMPROVEMENTS	
2013/2014 - SB821 WHEELCHAIR RAMP CONSTRUCTION	
LOCATIONS 'C' AND 'D' CONSTRUCTION DATA TABLES	
HORIZ. SCALE: N/A	VERT. SCALE: N/A

DESIGN WORK ORDER: #1420238  
 CONSTR. WORK ORDER: #1420242  
**M-475**  
 SHEET 5 OF 6  
 FILE NAME: M475-5.DWG

**STRIPING GENERAL NOTES:**

1. STRIPING INSTALLATIONS SHALL CONFORM TO THE CALIFORNIA MANUAL ON UNIFORM TRAFFIC CONTROL DEVICES (CA MUTCD) DATED 2012, THE STATE OF CALIFORNIA DEPARTMENT OF TRANSPORTATION (CALTRANS) STANDARD PLANS AND SPECIFICATIONS DATED 2010, AND ALL ADDENDUMS THERE TO, AND THE CITY OF RIVERSIDE PUBLIC WORKS DEPARTMENT STANDARD DRAWINGS, CURRENT EDITION.
2. ALL STRIPING, MARKINGS, AND LEGENDS SHALL BE REFLECTORIZED THERMOPLASTIC UNLESS OTHERWISE NOTED. THE CONTRACTOR SHALL PROVIDE AND INSTALL RAISED PAVEMENT MARKERS FOR ALL STRIPING. STRIPING, MARKINGS AND LEGENDS SHALL CONFORM TO THE 2010 CALTRANS STANDARD PLANS A20A THRU A20D AND A24A THRU A24E.
3. PRIOR TO FINAL ACCEPTANCE OF STREET IMPROVEMENTS, ALL PAVEMENT MARKINGS WITHIN THE PERIMETER OF THE CONSTRUCTION AREA SHALL BE RESTORED TO LIKE NEW CONDITION, IN A MANNER MEETING THE APPROVAL OF THE CITY OF RIVERSIDE.
4. ALL CONFLICTING STRIPING, PAVEMENT MARKINGS, LEGENDS, AND RAISED PAVEMENT MARKERS SHALL BE REMOVED EVEN IF NOT SHOWN ON PLANS. REMOVALS OF PAINTED STRIPING, PAVEMENT MARKINGS AND LEGENDS SHALL BE DONE BY WET SANDBLASTING. REMOVALS OF THERMOPLASTIC STRIPING, PAVEMENT MARKINGS AND LEGENDS SHALL BE REMOVED BY WET SANDBLASTING, GRINDING OR OTHER APPROVED METHOD AND SHALL NOT DAMAGE THE PAVEMENT. "BLACK OUT" OF EXISTING DELINEATION IS NOT PERMITTED. ALL DAMAGED PAVEMENT DUE TO REMOVALS SHALL BE REPAIRED AS NECESSARY TO MAINTAIN A SMOOTH AND UNIFORM SURFACE OR AS DIRECTED BY THE ENGINEER. ALL STRIPING REMOVALS AND LEGENDS SHALL BE "FOG SEALED".

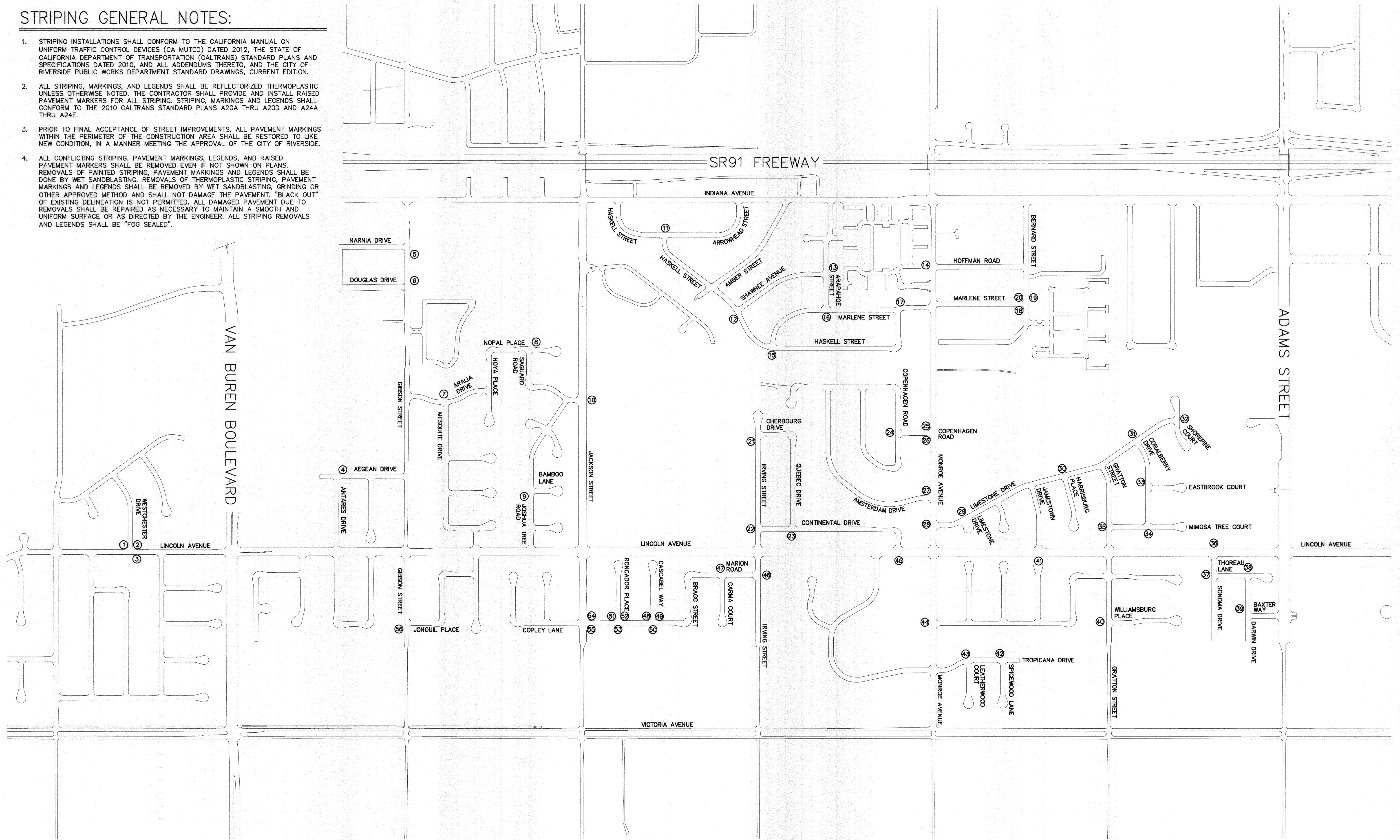

**LOCATION "D" AREA MAP**

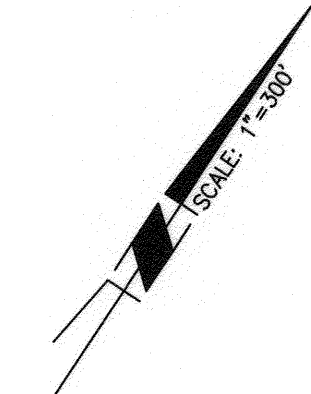

Under Ground Service Alert of Southern California  
 Call: TOLL FREE 1-800-227-2600  
 TWO WORKING DAYS BEFORE YOU DIG

**ENGINEER IN RESPONSIBLE CHARGE**  
 EDWARD LARA  
 R.C.E. No. 63753 EXPIRES: 9-30-16  
 DATE: November 14, 2014

MARK	REVISIONS	APPR.	DATE

DESIGNED BY: BA DRAWN BY: BA CHECKED BY: EL

**CITY OF RIVERSIDE, CALIFORNIA DEPARTMENT OF PUBLIC WORKS**

APPROVED BY	BY	DATE	APPROVED BY
ENGINEERING MANAGER	FM	11/17/14	CITY ENGINEER
CONSTRUCTION ADMIN.	DC	11/18/14	
TRAFFIC DIVISION		11-20-14	
STREETS SERVICES			

DATE: 11/21/2014

**WHEELCHAIR RAMP IMPROVEMENTS**  
 2013/2014 - SB821  
**WHEELCHAIR RAMP CONSTRUCTION**  
 LOCATION "D" AREA MAP  
 HORIZ. SCALE: 1"=300' VERT. SCALE: N/A

DESIGN WORK ORDER: #1420238  
 CONSTR. WORK ORDER: #1420242  
**M-475**  
 SHEET **6** OF **6**  
 FILE NAME: M475-6.DWG