

JOHN DULING'S SUBDIVISION

— OF —
BLOCK 3 RANGE 10
 — RIVERSIDE —

RIVERSIDE COUNTY CALIFORNIA

Scale
 50 FT = 1 IN.

KNOW all men by these presents that I hereby execute and adopt this MAP of JOHN DULING'S SUBDIVISION of BLOCK 3 RANGE 10 of RIVERSIDE CALIFORNIA and I do hereby dedicate the ALLEY as shown, to the PUBLIC and for the PUBLIC use forever

John Duling

STATE OF CALIFORNIA }
 COUNTY OF RIVERSIDE }

On this 19th day of OCTOBER A.D. 1904 before me J. J. Kuhns a NOTARY PUBLIC in and for said COUNTY OF RIVERSIDE residing therein duly commissioned and sworn personally appeared JOHN DULING known to me to be the person whose name is subscribed to and who executed the within instrument and acknowledged to me that he executed the same freely and voluntarily

IN WITNESS WHEREOF I hereunto set my hand and official seal the day and year first above written

J. J. Kuhns

NOTARY PUBLIC in and for RIVERSIDE COUNTY, CALIFORNIA

I hereby certify that this MAP of JOHN DULING'S SUBDIVISION is a true and correct representation of the Survey made by me during OCTOBER 1904

A. P. Campbell

Licensed Surveyor

RESOLVED that the within MAP be and is hereby adopted as the OFFICIAL MAP of JOHN DULING'S SUBDIVISION of BLOCK 3 RANGE 10 RIVERSIDE CALIFORNIA and that the ALLEY shown is accepted for PUBLIC use
 I hereby Certify that the foregoing RESOLUTION was adopted by the BOARD OF TRUSTEES of the CITY of RIVERSIDE

NOVEMBER 10th 1904

ATTEST *C. R. Stibbens* CITY CLERK

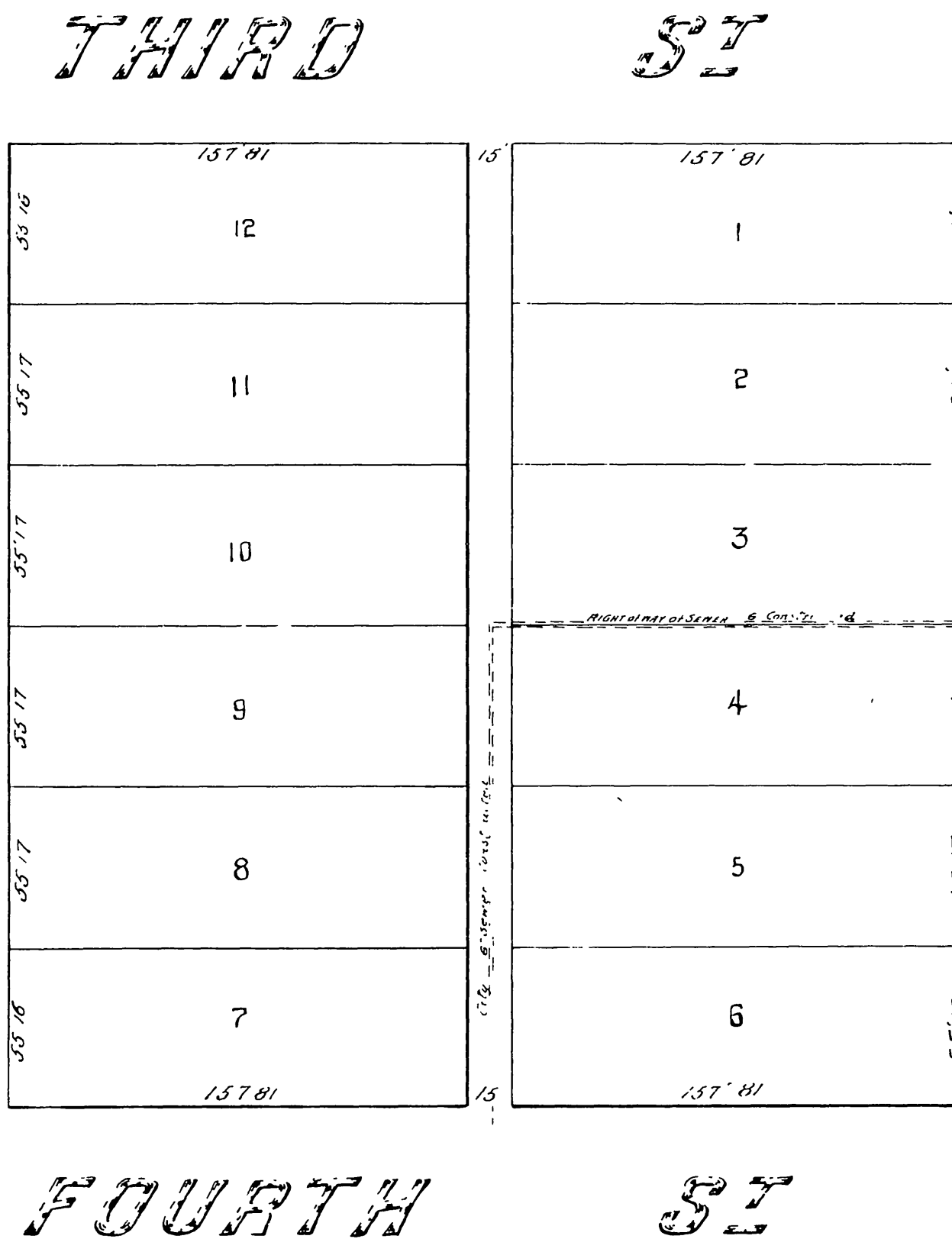

RS 2 / 83

RS 2/83

CBI

RS 2/83

Record