

84
FILED
 JAN 24 1908
 JAN 1908
 E. L. LOBAN, Recorder

MAP OF A PORTION OF RUBIDOUX HEIGHTS

in the City of Riverside, Riverside County, California, as surveyed by Kingsbury Sanborn, C. E., in November 1902, and filed in Map Book 4, at Page 80, records of Riverside County, California, showing the location of ROSE WAY through a portion of Lots 5, 6, 7, & 8 of Block 18, of said Rubidoux Heights, hereinafter dedicate to public use, also the divisions of a portion of 8TH Street, west of Pepper Street, into a double roadway, parking space, and sidewalk spaces, to be hereinafter dedicated for public use, also a portion of 8TH Street designated by a green band and marked "to be abandoned" and also the grade elevations, marked in red ink figures showing grades approved by the abutting property owners.

JANUARY, 1908. Compiled by A.P. Campbell, CITY ENGINEER.

Scale, 1 inch = 60 feet.

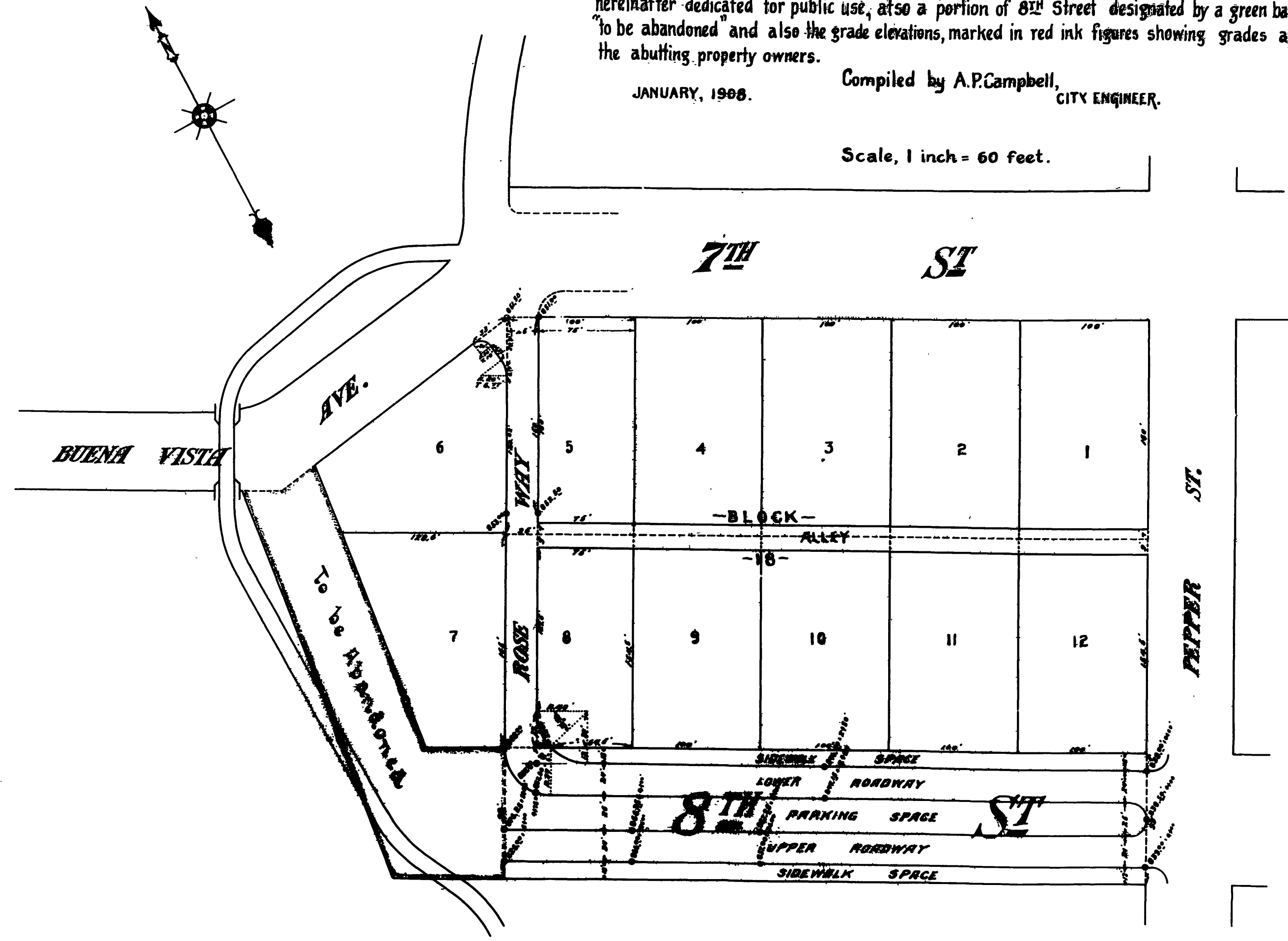

I hereby certify that this map is a correct representation of the work described.
 A.P. Campbell
 City Engineer.

RS 3 / 9

RS 3/9