

IN THE COUNTY OF RIVERSIDE

RECORD OF SURVEY

OF PORTIONS OF LOTS 1 AND 2 AND CRESCENT CITY RAILWAY RIGHT-OF-WAY PER MAP OF ALAMO TRACT, M.B. 9 PG. 5; AND PORTIONS OF LOTS 2, 3, A AND J, CRESTMORE AVE., MISSION BLVD. AND BUENA VISTA DR. PER MAP OF AMENDED MAP OF INDIAN HILL TRACT, M.B. 10 PG. 3, AND A PORTION OF LOT 6 OF LAKEHILL MANOR, M.B. 20 PGS. 1 & 2; AND A PORTION OF LOT 1, BLOCK 23 OF RUBIDOUX HEIGHTS, M.B. 4 PG. 80; AND A PORTION OF LOT 314 OF CORRECTED MAP OF R.L. & I. CO. LANDS, M.B. 4 PG. 75; AND PORTIONS OF LOTS 5 AND 6 OF EVANS RIO RANCHO, M.B. 10 PGS. 52-54, ALL RECORDS OF RIVERSIDE COUNTY, CALIFORNIA

BY
ALBERT A. WEBB ASSOCIATES
CIVIL ENGINEERS
APRIL 1957

Survey made at request of Riverside County Flood Control and Water Conservation District

I hereby certify that the above is a true and correct copy of the original Record of Survey as filed in the County of Riverside, California, on October 15, 1957, and that the positions of the corners are as shown on the map.

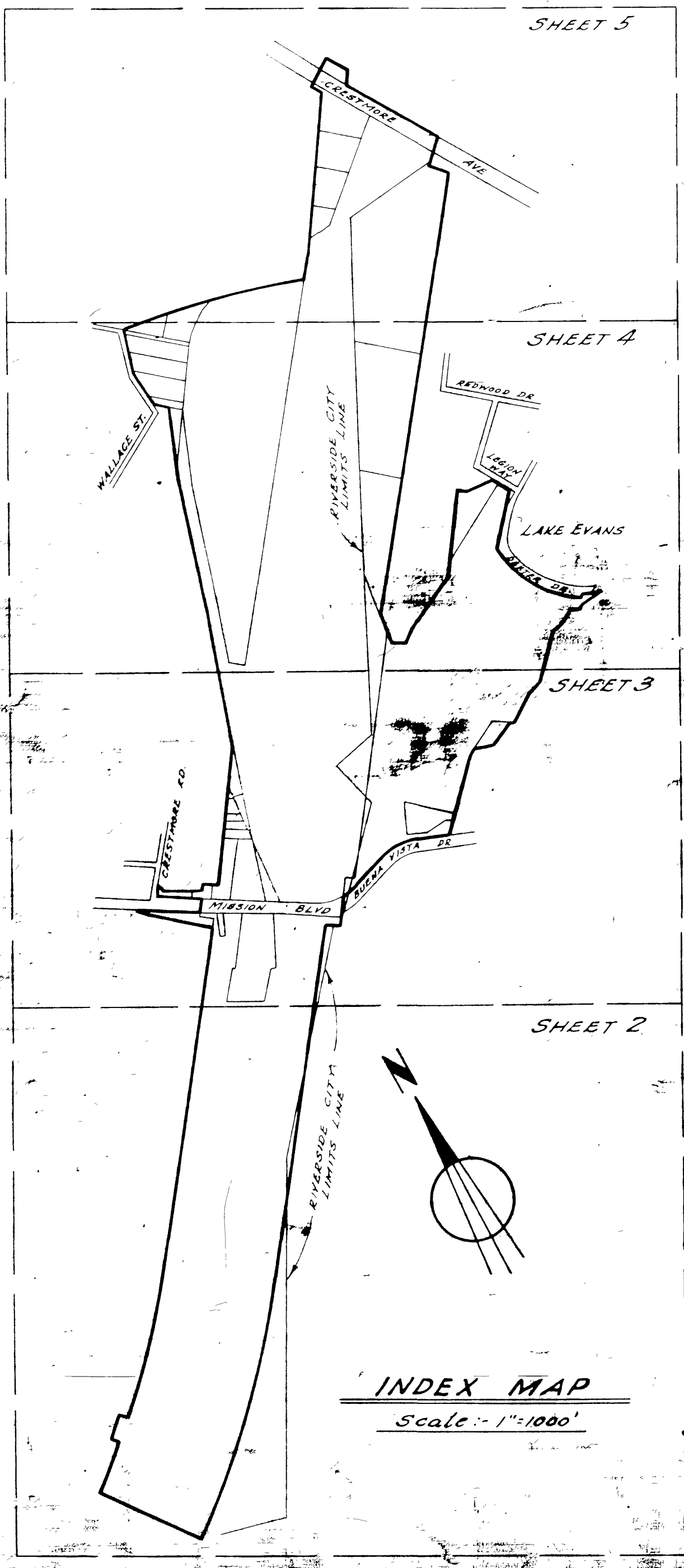

TABLE OF PARCELS SHOWING ACREAGE AND TYPE OF TITLE HELD IN RIVERSIDE COUNTY FLOOD CONTROL DISTRICT

PARCEL	TYPE	ACRES	PARCEL	TYPE	ACRES
29	FT.	0.658	54	FT	0.016
30	FT	4.420	55	FT	0.432
31	FT	3.081	55A	FT	0.028
32	FT	2.660	56	FT	0.333
33	FT	2.161	57	FT	0.260
34	FT	0.967	58	FT	0.340
35	PFE & WDE	1.776	59	FT	1.856
36	PFE & WDE	10.811	60	FT	2.370
37	FT	26.017	61	FT	3.034
38	FT	13.309	61A	FT	0.665
39	FT	7.045	62	FT	0.387
40	PFE	2.590	63	FT	3.777
41	PFE	0.298	64	FT	0.275
42	PFE	0.290	65	FT	6.286
43	PFE	0.853	66	FT	0.053
44	PFE	1.950	67	FT	2.50 FT.
44A	FT	0.078	68	FT	7.50 FT.
45	PFE	71.540	69	FT	0.128
46	FLOOD CONTROL DISTRICT EASEMENT	144.544	70	FT	0.668
47	PFE & WDE	54.074	71	FT	130.201
48	PFE & WDE	0.560	72	PFE & WDE	4.50 FT.
49	PFE & WDE	2.010	73	FT	0.400
50	PFE & WDE	2.009	74	TDE	1.000
51	PFE & WDE	2.034	75	FT	0.127
52	PFE & WDE	0.140	76	FT	0.501
53	FT	0.133			

FT - Fee Title
PFE - Permanent Flood Easement
WDE - Waste Disposal Easement
TDE - Temporary Detention Easement

- ENGINEERS NOTES:
1. Basis of bearings is the meridian N 33° 45' 33" W.
 2. Set 3/4" I.P. tagged W.D.E. size of all parcels.
 3. Found 3/4" I.P. at all points.
 4. Position computed from bearings and distances.