

(4th) COPY

89/67  
R/S 89/67

SHEET 1 OF 10 SHEETS  
 RECORDER'S STATEMENT:  
 FILED THIS 17 DAY OF NOVEMBER 1991,  
 AT 2:20 A.M. IN BOOK 22 OF RECORDS OF  
 SURVEY, AT PAGES 61-72 AT THE  
 REQUEST OF THE COUNTY SURVEYOR.  
 NO. 37395  
 FEE \$24.00  
 WILLIAM E. CONERLY  
 COUNTY RECORDER  
 BY: Santa Logan, DEPUTY

IN THE CITIES OF RIVERSIDE AND MORENO VALLEY (RIVERSIDE COUNTY), IN THE CITIES OF SAN BERNARDINO, GRAND TERRACE AND COLTON (SAN BERNARDINO COUNTY), IN THE UNINCORPORATED TERRITORY OF RIVERSIDE COUNTY AND IN THE UNINCORPORATED TERRITORY OF SAN BERNARDINO COUNTY, ALL IN THE STATE OF CALIFORNIA.

# RECORD OF SURVEY

THOSE PORTIONS OF SECTIONS 16, 20, 21, 22, 23, 26, 27, 28, 31, 32 AND 33 OF TOWNSHIP 1 SOUTH, RANGE 4 WEST, SECTIONS 5, 6, 7, 19, 29, 30, 32, 33 AND 34 OF TOWNSHIP 2 SOUTH, RANGE 4 WEST, SECTIONS 12, 13, 23, 24 AND 26 OF TOWNSHIP 2 SOUTH, RANGE 5 WEST AND SECTIONS 2, 3, 4, 10 AND 11 OF TOWNSHIP 3 SOUTH, RANGE 4 WEST, ALL OF SAN BERNARDINO BASE AND MERIDIAN, AND PORTIONS OF JURUPA RANCHO AND RANCHO SAN BERNARDINO.

STATE OF CALIFORNIA, DEPARTMENT OF TRANSPORTATION; MONUMENTATION MAP.  
 DATE OF SURVEY: MAY 1990 PSOMAS AND ASSOCIATES

**SURVEYOR'S STATEMENT:**

THIS MAP CORRECTLY REPRESENTS A SURVEY MADE BY ME OR UNDER MY DIRECTION IN CONFORMANCE WITH THE REQUIREMENTS OF THE LAND SURVEYORS ACT AT THE REQUEST OF RIVERSIDE COUNTY TRANSPORTATION COMMISSION IN MAY 1990.

Kari J. Launen  
 KARI J. LAUNEN LS 5679  
 LICENSE EXPIRES: 9-30-1991

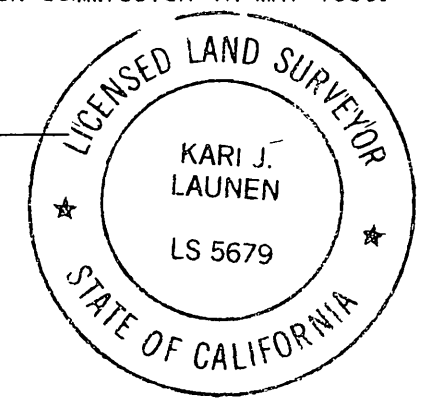

**RIVERSIDE COUNTY SURVEYOR'S STATEMENT:**

THIS MAP HAS BEEN EXAMINED IN ACCORDANCE WITH SECTION 8766 OF THE LAND SURVEYOR'S ACT THIS 31ST DAY OF OCT, 1991.

Gerald A. Stayer  
 GERALD A. STAYER, COUNTY SURVEYOR  
 L. S. 3739  
 LICENSE EXPIRES: 6-30-92



**SAN BERNARDINO COUNTY SURVEYOR'S STATEMENT:**

THIS MAP HAS BEEN EXAMINED IN ACCORDANCE WITH SECTION 8766 OF THE LAND SURVEYOR'S ACT THIS 29th DAY OF OCTOBER, 1991:

Larry E. Cotton DEPUTY  
 LARRY E. COTTON, COUNTY SURVEYOR  
 L. S. 4675  
 LICENSE EXPIRES: 9-30-95



NOTE: THIS MAP WAS PREPARED UNDER THE DIRECTION AND SUPERVISION OF CALIFORNIA DEPARTMENT OF TRANSPORTATION, DISTRICT 8, SURVEY SECTION. ALL MONUMENTS SET ARE CALIFORNIA DEPARTMENT OF TRANSPORTATION STANDARD MONUMENTS.

**STATEMENT OF PURPOSE:**

THE PURPOSE OF THIS SURVEY IS TO ESTABLISH A HORIZONTAL CONTROL NETWORK FOR TRANSPORTATION DEVELOPMENT IN THE COUNTY OF RIVERSIDE AND THE COUNTY OF SAN BERNARDINO WHICH IS CONSTRAINED TO FIRST ORDER NATIONAL GEODETIC CONTROL BASED ON THE 1983 NORTH AMERICAN DATUM AND ADJUSTMENT, CALIFORNIA STATE PLANE COORDINATE SYSTEM LAMBERT ZONE VI, USING GLOBAL POSITIONING SURVEY TECHNIQUES.

**BASIS OF BEARINGS:**

THE BASIS OF BEARINGS FOR THIS SURVEY IS DETERMINED BY THE HORIZONTAL CONTROL NETWORK OF THE COUNTY OF RIVERSIDE AND THE COUNTY OF SAN BERNARDINO AS DEFINED BY THE NATIONAL GEODETIC SURVEY'S 1983 NORTH AMERICAN DATUM AND ADJUSTMENT HOLDING THE STATIONS FIXED AS SHOWN ON SHEETS 9 OF 10 AND 10 OF 10.

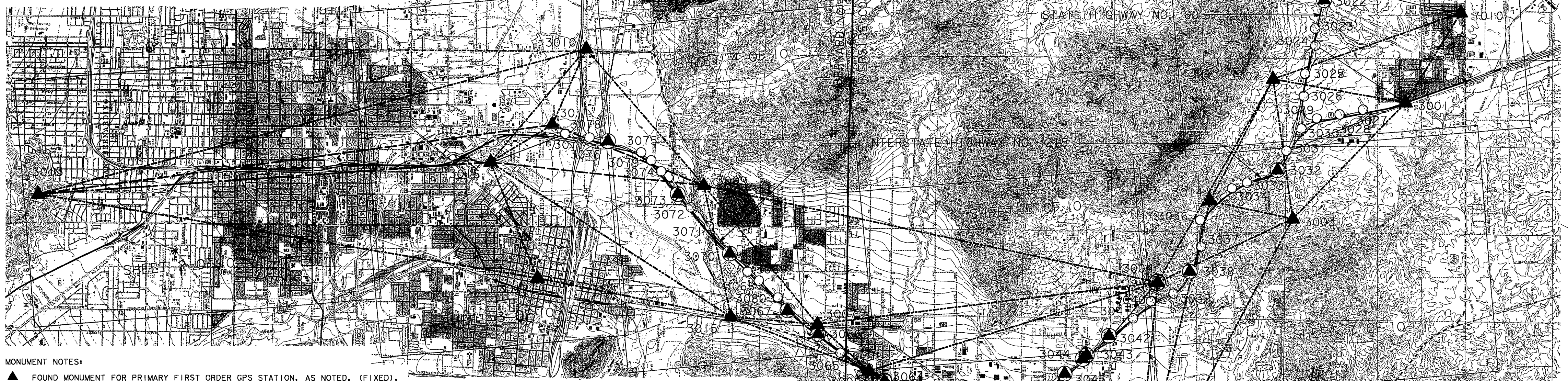

**MONUMENT NOTES:**

- ▲ FOUND MONUMENT FOR PRIMARY FIRST ORDER GPS STATION, AS NOTED, (FIXED).
- FOUND MONUMENT FOR SECONDARY CONTROL NETWORK PER CALTRANS SPECIFICATION, AS NOTED.
- SET 2" BRASS DISK IN 2" I.P. STAMPED AS NOTED FOR SECONDARY CONTROL NETWORK PER CALTRANS SPECIFICATION, UNLESS OTHERWISE NOTED.

**NOTE:**

GEOSURV'S GEOLAB SOFTWARE VERSION 1.91 WAS USED TO ADJUST THE NETWORK. A COPY OF THE REPORT IS AVAILABLE IN THE OFFICES OF THE RIVERSIDE COUNTY SURVEYOR AND THE SAN BERNARDINO COUNTY SURVEYOR.



**GRAPHIC SCALE**

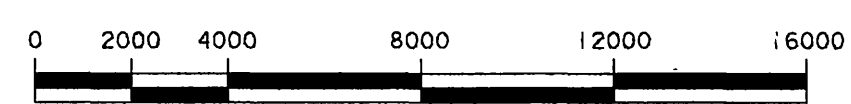

SCALE: 1" = 4000'

**NOTES:**

1. SEE SHEETS 9 AND 10 FOR COORDINATES.
2. ADDITIONAL INFORMATION REGARDING THOSE FOUND MONUMENTS STATED PER CALTRANS FILE NO. 261993 CAN BE OBTAINED FROM CALTRANS DISTRICT NO. 8, SAN BERNARDINO OFFICE.
3. THE "TO REACH DESCRIPTIONS" TO THE MONUMENT CAN BE OBTAINED FROM THE RIVERSIDE COUNTY SURVEYOR'S OFFICE AND SAN BERNARDINO COUNTY SURVEYOR'S OFFICE. ON FILE AS CORNER RECORDS IN SAN BERNARDINO COUNTY.
4. THE TOPOGRAPHIC DATA AS SHOWN IS COMPILED FROM THE REDUCTION AND ENLARGEMENT OF THE UNITED STATES DEPARTMENT OF INTERIOR GEOLOGICAL SURVEY, 7.5 MINUTE SERIES QUADRANGLE SHEETS.
5. THE TOPOGRAPHIC DATA AS SHOWN IS FOR REFERENCE ONLY, AND IS NOT FOR THE PURPOSE OF LOCATING ANY CADASTRAL BOUNDARY.
6. ALL POINTS SHOWN ON THIS MAP HAVE POSITIONS THAT WERE OCCUPIED AND HAVE COORDINATE VALUES ESTABLISHED BY G.P.S. EQUIPMENT AND METHODS. OTHER CONVENTIONAL METHODS WERE UTILIZED.
7. ALL BEARINGS AND DISTANCES SHOWN ARE CALCULATED INVERSES BASED UPON STATE PLANE COORDINATES ZONE 6 ONLY.
8. ALL MONUMENTS SHOWN ARE AT ARBITRARY LOCATIONS.
9. REPEAT BASELINES ARE LINES DETERMINED BY TWO OR MORE INDEPENDENT OBSERVATION SESSIONS.
10. POSITIONS WERE ESTABLISHED BY STATIC RELATIVE POSITIONING USING 3 TRIMBLE 4000SL RECEIVERS, SERIAL NUMBERS 2737A00103, 2737A00107, 2811A00170, TO STANDARDS SPECIFIED IN THE FEDERAL GEODETIC CONTROL COMMITTEE (FGCC) GEOMETRIC GEODETIC ACCURACY STANDARDS AND SPECIFICATIONS FOR USING GPS RELATIVE POSITIONING TECHNIQUES, DRAFT VERSION 5.0 PUBLISHED MAY 1988.

R/S 89/67

IN THE CITIES OF RIVERSIDE AND MORENO VALLEY (RIVERSIDE COUNTY), IN THE CITIES OF SAN BERNARDINO, GRAND TERRACE AND COLTON (SAN BERNARDINO COUNTY), IN THE UNINCORPORATED TERRITORY OF RIVERSIDE COUNTY AND IN THE UNINCORPORATED TERRITORY OF SAN BERNARDINO COUNTY, ALL IN THE STATE OF CALIFORNIA.

# RECORD OF SURVEY

THOSE PORTIONS OF SECTIONS 16, 20, 21, 22, 23, 26, 27, 28, 31, 32 AND 33 OF TOWNSHIP 1 SOUTH, RANGE 4 WEST, SECTIONS 5, 6, 7, 19, 29, 30, 32, 33 AND 34 OF TOWNSHIP 2 SOUTH, RANGE 4 WEST, SECTIONS 12, 13, 23, 24 AND 26 OF TOWNSHIP 2 SOUTH, RANGE 5 WEST AND SECTIONS 2, 3, 4, 10 AND 11 OF TOWNSHIP 3 SOUTH, RANGE 4 WEST, ALL OF SAN BERNARDINO BASE AND MERIDIAN, AND PORTIONS OF JURUPA RANCHO AND RANCHO SAN BERNARDINO.

STATE OF CALIFORNIA, DEPARTMENT OF TRANSPORTATION; MONUMENTATION MAP.  
DATE OF SURVEY: MAY 1990 PSOMAS AND ASSOCIATES

Copy



### GRAPHIC SCALE

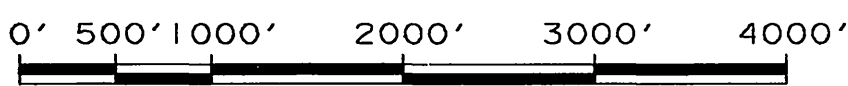

SCALE: 1" = 1000'

### NOTES:

- 1). COORDINATES, BEARINGS AND DISTANCES SHOWN HEREON ARE GRID VALUES.
- 2). SEE SHEET 1 OF 10 FOR BASIS OF BEARINGS, MONUMENT NOTES, SHEET INDEX MAP.
- 3). SEE SHEETS 9 AND 10 FOR COORDINATES.
- 4). GROUND DISTANCE = ( GRID DISTANCE ) / ( COMBINED FACTOR ).
- 5). GRID DISTANCE = ( GROUND DISTANCE ) x ( COMBINED FACTOR ).

### LEGEND:

- PRIMARY NETWORK, LINES BETWEEN STATIONS ARE NOT INTERVISIBLE.
- PRIMARY NETWORK, ALL LINES BETWEEN STATIONS ARE INTERVISIBLE.
- SECONDARY NETWORK, ALL LINES BETWEEN STATIONS ARE INTERVISIBLE.
- REPEAT BASELINES.

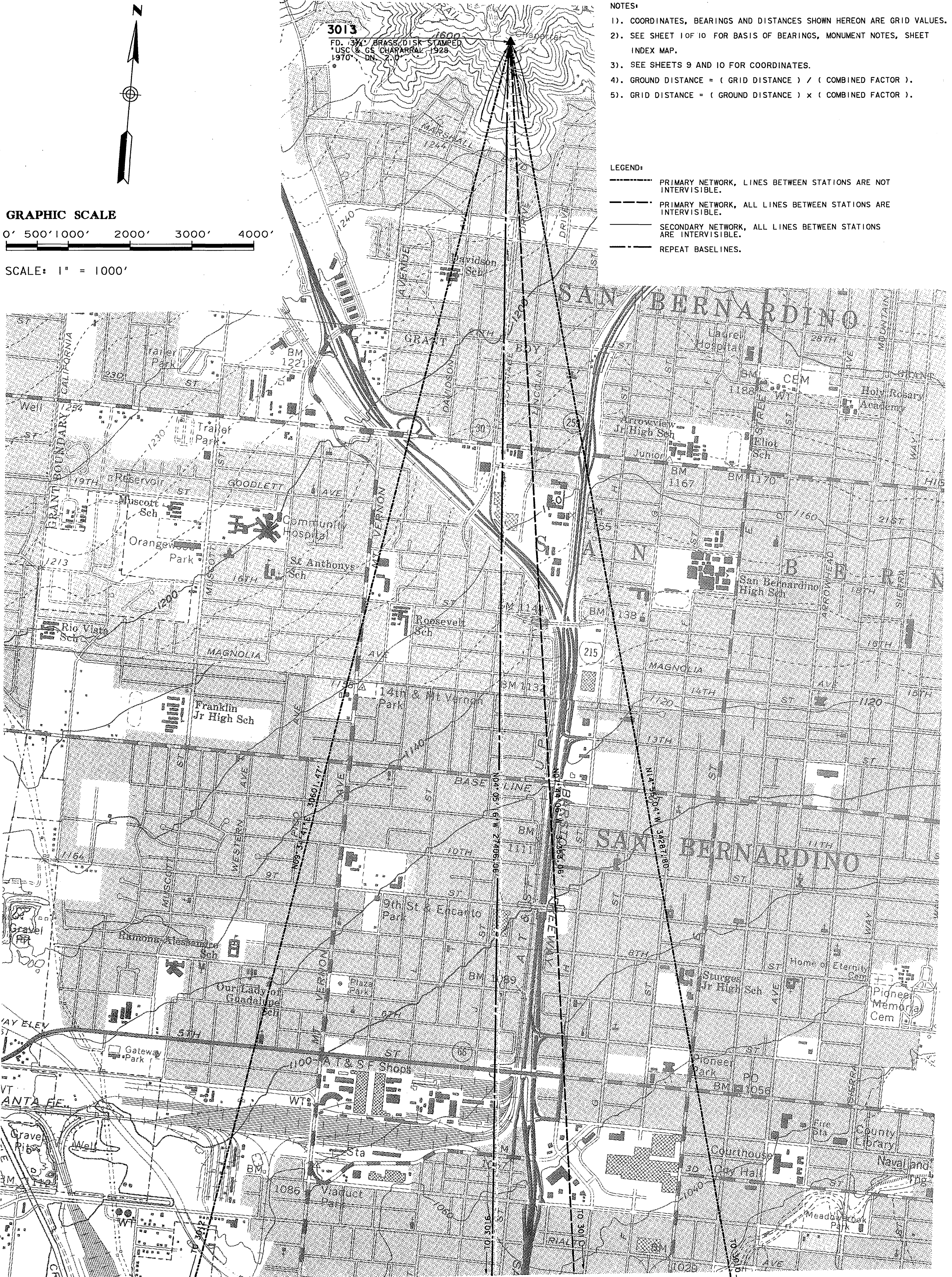

89/69

IN THE CITIES OF RIVERSIDE AND MORENO VALLEY (RIVERSIDE COUNTY), IN THE CITIES OF SAN BERNARDINO, GRAND TERRACE AND COLTON (SAN BERNARDINO COUNTY), IN THE UNINCORPORATED TERRITORY OF RIVERSIDE COUNTY AND IN THE UNINCORPORATED TERRITORY OF SAN BERNARDINO COUNTY, ALL IN THE STATE OF CALIFORNIA.

# RECORD OF SURVEY

THOSE PORTIONS OF SECTIONS 16, 20, 21, 22, 23, 26, 27, 28, 31, 32 AND 33 OF TOWNSHIP 1 SOUTH, RANGE 4 WEST, SECTIONS 5, 6, 7, 19, 29, 30, 32, 33 AND 34 OF TOWNSHIP 2 SOUTH, RANGE 4 WEST, SECTIONS 12, 13, 23, 24 AND 26 OF TOWNSHIP 2 SOUTH, RANGE 5 WEST AND SECTIONS 2, 3, 4, 10 AND 11 OF TOWNSHIP 3 SOUTH, RANGE 4 WEST, ALL OF SAN BERNARDINO BASE AND MERIDIAN, AND PORTIONS OF JURUPA RANCHO AND RANCHO SAN BERNARDINO.

STATE OF CALIFORNIA, DEPARTMENT OF TRANSPORTATION; MONUMENTATION MAP.

DATE OF SURVEY: MAY 1990 PSOMAS AND ASSOCIATES

### NOTES:

- 1). COORDINATES, BEARINGS AND DISTANCES SHOWN HEREON ARE GRID VALUES.
- 2). SEE SHEET 1 OF 10 FOR BASIS OF BEARINGS, MONUMENT NOTES, SHEET INDEX MAP.
- 3). SEE SHEETS 9 AND 10 FOR COORDINATES.
- 4). GROUND DISTANCE = ( GRID DISTANCE ) / ( COMBINED FACTOR ).
- 5). GRID DISTANCE = ( GROUND DISTANCE ) x ( COMBINED FACTOR ).

### LEGEND:

- PRIMARY NETWORK, LINES BETWEEN STATIONS ARE NOT INTERVISIBLE.
- PRIMARY NETWORK, ALL LINES BETWEEN STATIONS ARE INTERVISIBLE.
- SECONDARY NETWORK, ALL LINES BETWEEN STATIONS ARE INTERVISIBLE.
- REPEAT BASELINES.

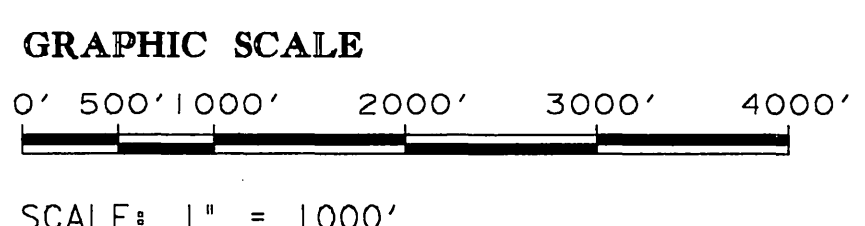
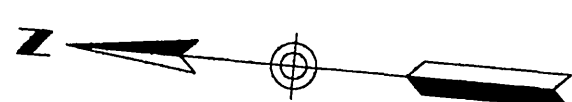
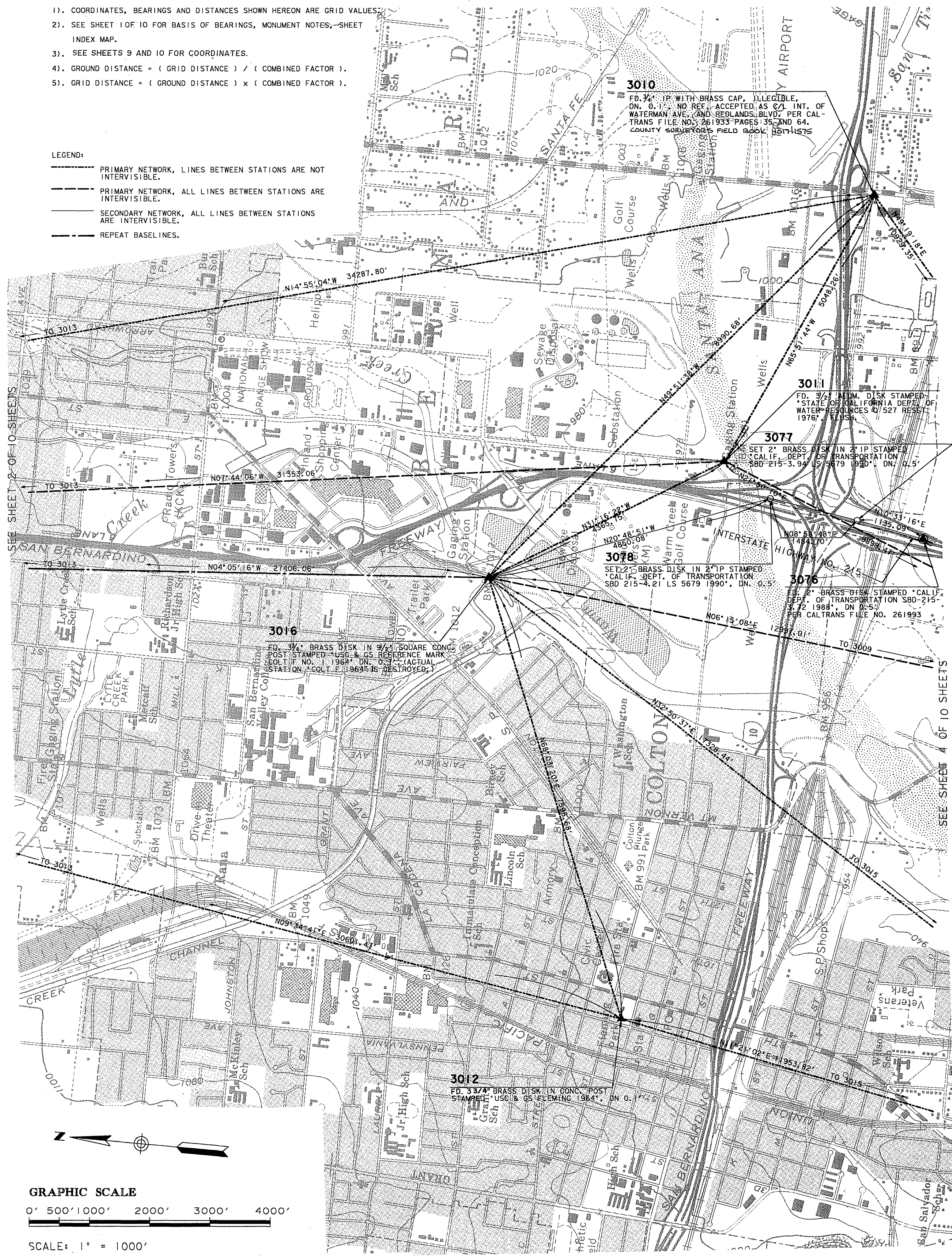

Copy

SEE SHEET 2 OF 10 SHEETS

SEE SHEET 4 OF 10 SHEETS

IN THE CITIES OF RIVERSIDE AND MORENO VALLEY (RIVERSIDE COUNTY), IN THE CITIES OF SAN BERNARDINO, GRAND TERRACE AND COLTON (SAN BERNARDINO COUNTY), IN THE UNINCORPORATED TERRITORY OF RIVERSIDE COUNTY AND IN THE UNINCORPORATED TERRITORY OF SAN BERNARDINO COUNTY, ALL IN THE STATE OF CALIFORNIA.

# RECORD OF SURVEY

THOSE PORTIONS OF SECTIONS 16, 20, 21, 22, 23, 26, 27, 28, 31, 32 AND 33 OF TOWNSHIP 1 SOUTH, RANGE 4 WEST, SECTIONS 5, 6, 7, 19, 29, 30, 32, 33 AND 34 OF TOWNSHIP 2 SOUTH, RANGE 4 WEST, SECTIONS 12, 13, 23, 24 AND 26 OF TOWNSHIP 2 SOUTH, RANGE 5 WEST AND SECTIONS 2, 3, 4, 10 AND 11 OF TOWNSHIP 3 SOUTH, RANGE 4 WEST, ALL OF SAN BERNARDINO BASE AND MERIDIAN, AND PORTIONS OF JURUPA RANCHO AND RANCHO SAN BERNARDINO.

STATE OF CALIFORNIA, DEPARTMENT OF TRANSPORTATION; MONUMENTATION MAP.

DATE OF SURVEY: MAY 1990 PSOMAS AND ASSOCIATES

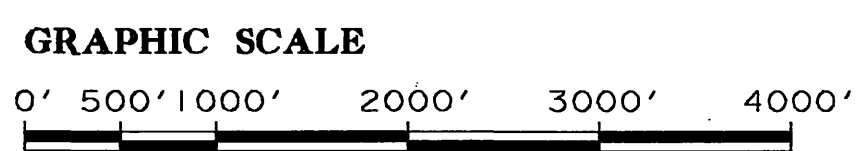
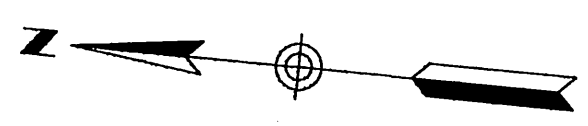

SCALE: 1" = 1000'

- LEGEND:
- PRIMARY NETWORK, LINES BETWEEN STATIONS ARE NOT INTERVISIBLE.
  - - - - - PRIMARY NETWORK, ALL LINES BETWEEN STATIONS ARE INTERVISIBLE.
  - SECONDARY NETWORK, ALL LINES BETWEEN STATIONS ARE INTERVISIBLE.
  - REPEAT BASELINES.

- NOTES:
- 1). COORDINATES, BEARINGS AND DISTANCES SHOWN HEREON ARE GRID VALUES.
  - 2). SEE SHEET 1 OF 10 FOR BASIS OF BEARINGS, MONUMENT NOTES, SHEET INDEX MAP.
  - 3). SEE SHEETS 9 AND 10 FOR COORDINATES.
  - 4). GROUND DISTANCE = ( GRID DISTANCE ) / ( COMBINED FACTOR ).
  - 5). GRID DISTANCE = ( GROUND DISTANCE ) x ( COMBINED FACTOR ).

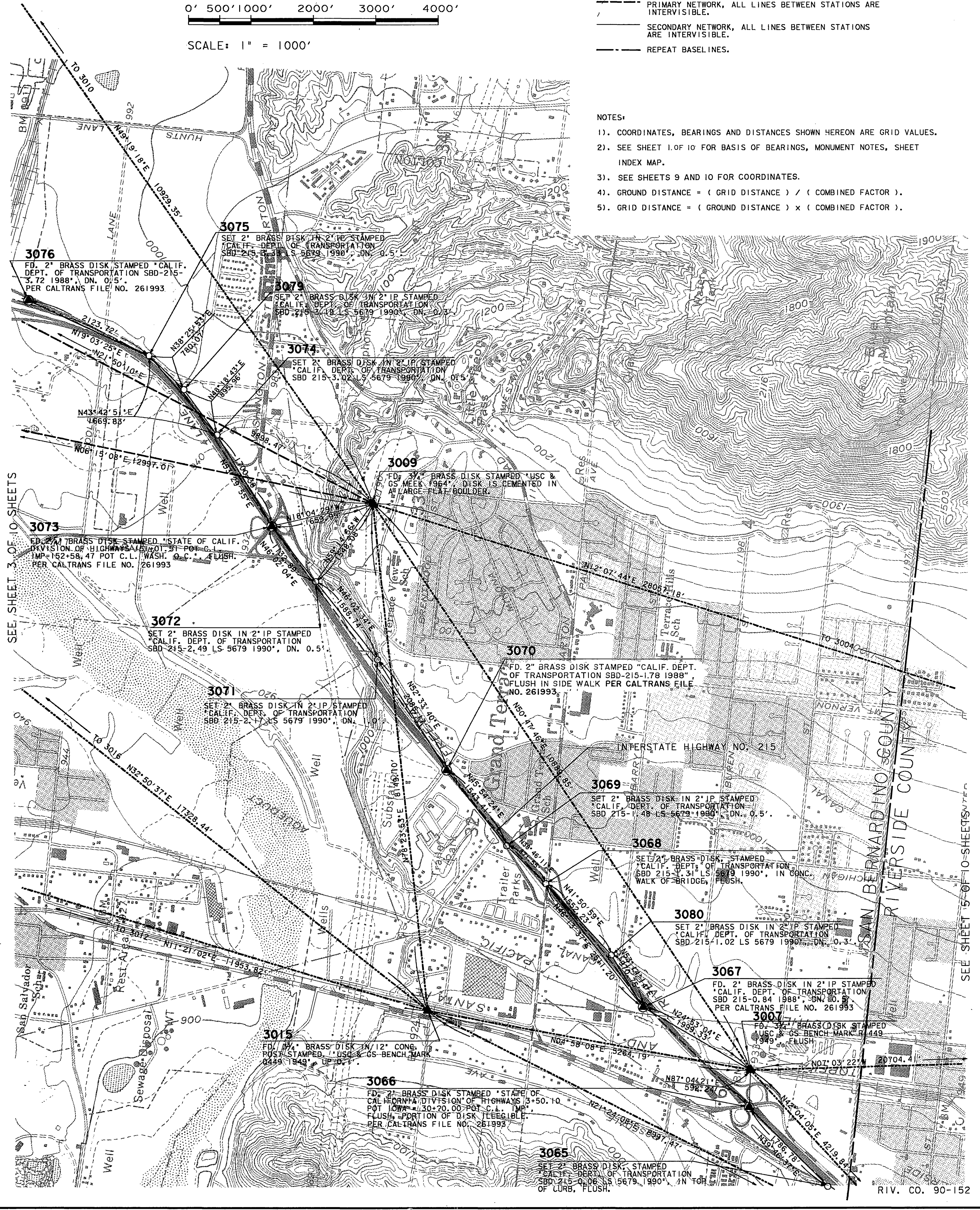

SEE SHEET 3 OF 10 SHEETS

SEE SHEET 5 OF 10 SHEETS

RIV. CO. 90-152

IN THE CITIES OF RIVERSIDE AND MORENO VALLEY (RIVERSIDE COUNTY), IN THE CITIES OF SAN BERNARDINO, GRAND TERRACE AND COLTON (SAN BERNARDINO COUNTY), IN THE UNINCORPORATED TERRITORY OF RIVERSIDE COUNTY AND IN THE UNINCORPORATED TERRITORY OF SAN BERNARDINO COUNTY, ALL IN THE STATE OF CALIFORNIA.

# RECORD OF SURVEY

THOSE PORTIONS OF SECTIONS 16, 20, 21, 22, 23, 26, 27, 28, 31, 32 AND 33 OF TOWNSHIP 1 SOUTH, RANGE 4 WEST, SECTIONS 5, 6, 7, 19, 29, 30, 32, 33 AND 34 OF TOWNSHIP 2 SOUTH, RANGE 4 WEST, SECTIONS 12, 13, 23, 24 AND 26 OF TOWNSHIP 2 SOUTH, RANGE 5 WEST AND SECTIONS 2, 3, 4, 10 AND 11 OF TOWNSHIP 3 SOUTH, RANGE 4 WEST, ALL OF SAN BERNARDINO BASE AND MERIDIAN, AND PORTIONS OF JURUPA RANCHO AND RANCHO SAN BERNARDINO. STATE OF CALIFORNIA, DEPARTMENT OF TRANSPORTATION; MONUMENTATION MAP. DATE OF SURVEY: MAY 1990 PSOMAS AND ASSOCIATES

Copy

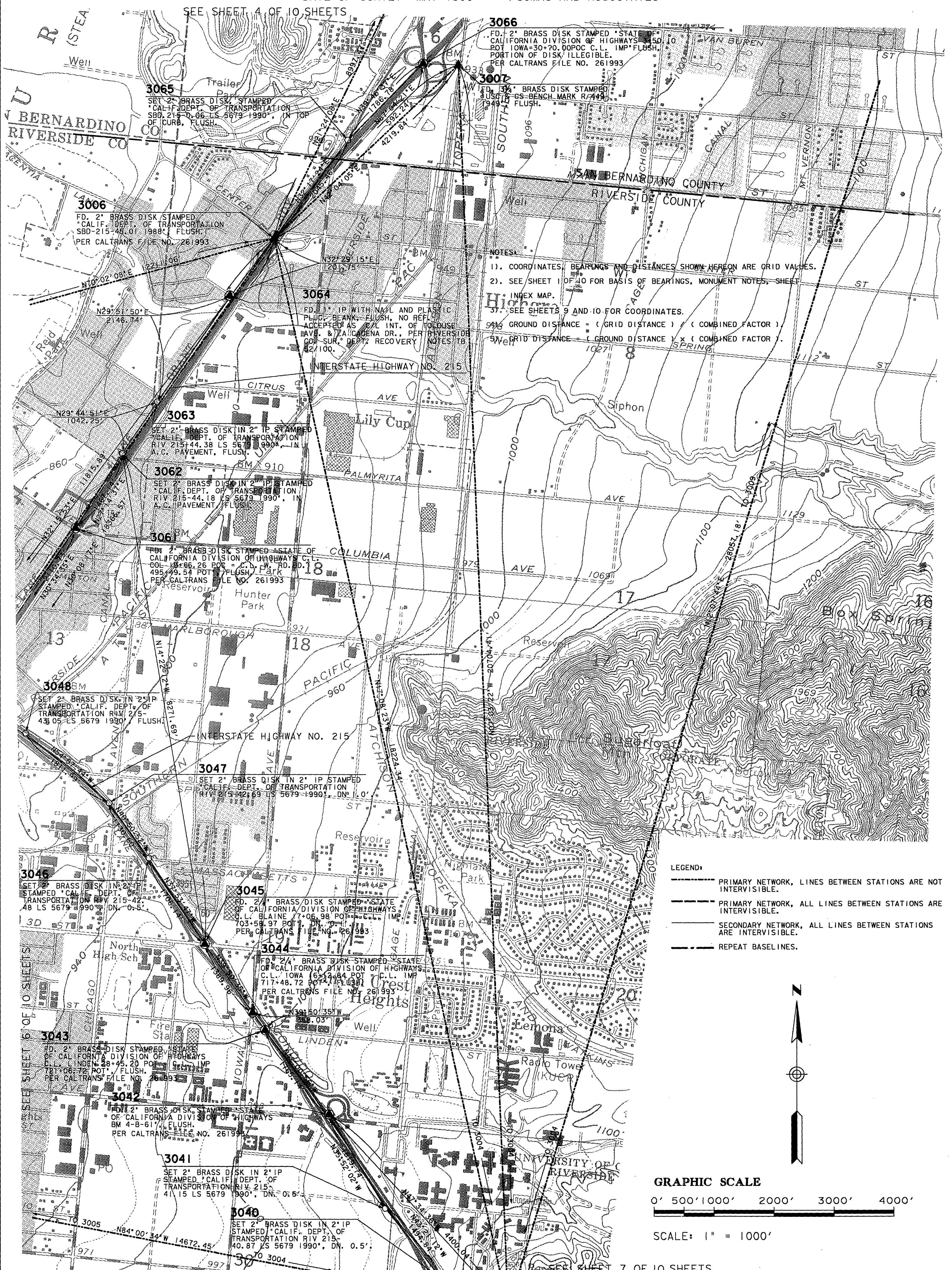

NOTES:

- COORDINATES, BEARINGS AND DISTANCES SHOWN HEREON ARE GRID VALUES.
- SEE SHEET 1 OF 10 FOR BASIS OF BEARINGS, MONUMENT NOTES, SHEET INDEX MAP.
- SEE SHEETS 9 AND 10 FOR COORDINATES.

$GRD DISTANCE = (GROUND DISTANCE) \times (COMBINED FACTOR)$   
 $GRD DISTANCE = (GROUND DISTANCE) \div (COMBINED FACTOR)$

LEGEND:

- PRIMARY NETWORK, LINES BETWEEN STATIONS ARE NOT INTERVARIABLE.
- PRIMARY NETWORK, ALL LINES BETWEEN STATIONS ARE INTERVARIABLE.
- SECONDARY NETWORK, ALL LINES BETWEEN STATIONS ARE INTERVARIABLE.
- REPEAT BASELINES.

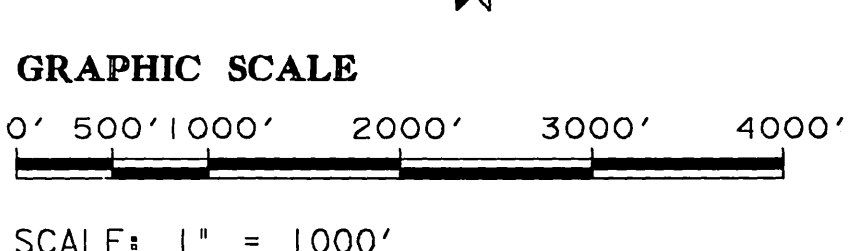
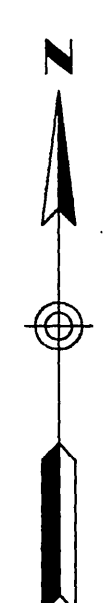

SEE SHEET 6 OF 10 SHEETS

SEE SHEET 7 OF 10 SHEETS



IN THE CITIES OF RIVERSIDE AND MOREMO VALLEY (RIVERSIDE COUNTY), IN THE CITIES OF SAN BERNARDINO, GRAND TERRACE AND COLTON (SAN BERNARDINO COUNTY), IN THE UNINCORPORATED TERRITORY OF RIVERSIDE COUNTY AND IN THE UNINCORPORATED TERRITORY OF SAN BERNARDINO COUNTY, ALL IN THE STATE OF CALIFORNIA.

# RECORD OF SURVEY

THOSE PORTIONS OF SECTIONS 16, 20, 21, 22, 23, 26, 27, 28, 31, 32 AND 33 OF TOWNSHIP 1 SOUTH, RANGE 4 WEST, SECTIONS 5, 6, 7, 19, 29, 30, 32, 33 AND 34 OF TOWNSHIP 2 SOUTH, RANGE 4 WEST, SECTIONS 12, 13, 23, 24 AND 26 OF TOWNSHIP 2 SOUTH, RANGE 5 WEST AND SECTIONS 2, 3, 4, 10 AND 11 OF TOWNSHIP 3 SOUTH, RANGE 4 WEST, ALL OF SAN BERNARDINO BASE AND MERIDIAN, AND PORTIONS OF JURUPA RANCHO AND RANCHO SAN BERNARDINO, STATE OF CALIFORNIA, DEPARTMENT OF TRANSPORTATION; MONUMENTATION MAP.

DATE OF SURVEY: MAY 1990 PSOMAS AND ASSOCIATES

SEE SHEET 5 OF 10 SHEETS

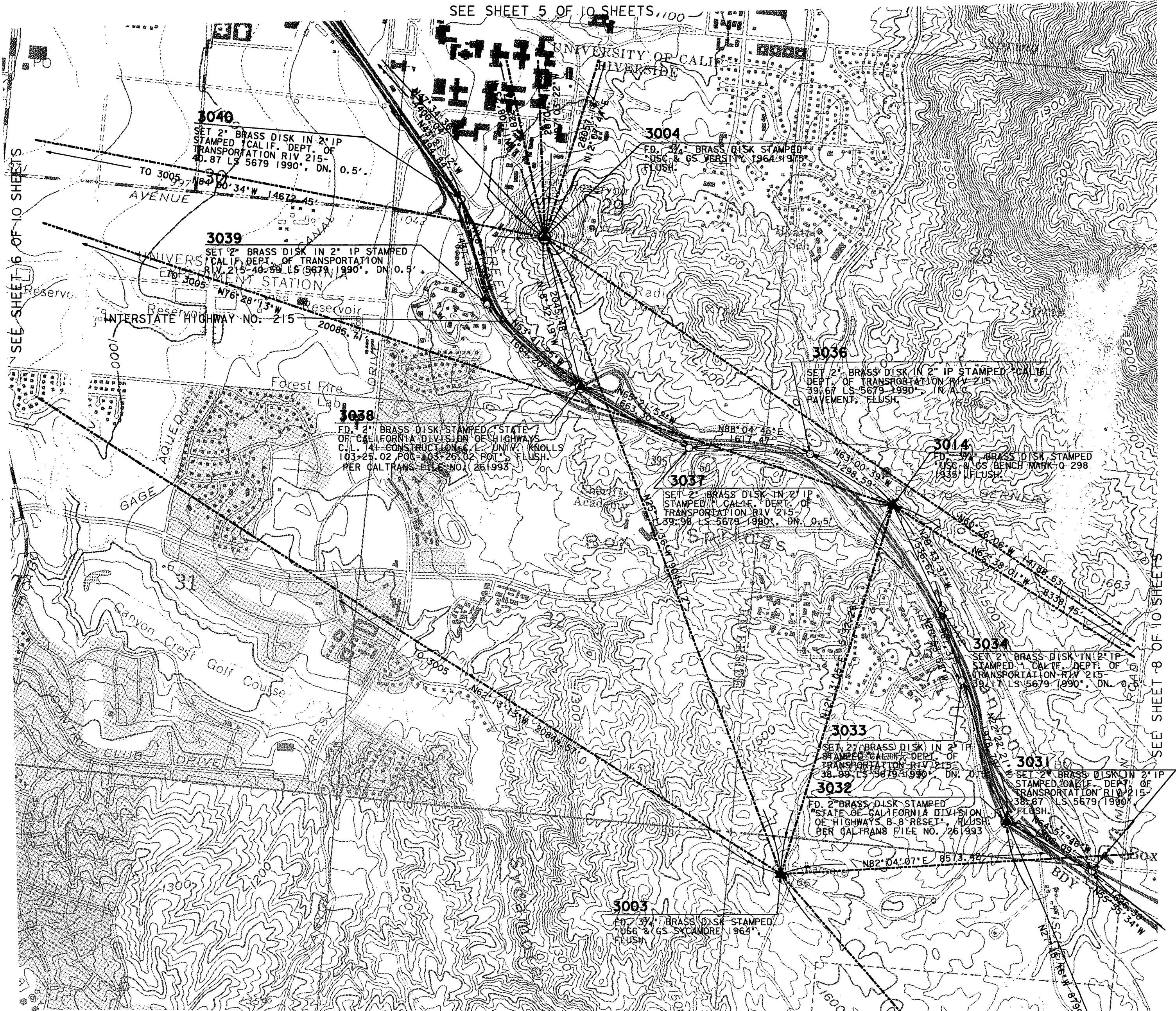

NOTES:

- 1). COORDINATES, BEARINGS AND DISTANCES SHOWN HEREON ARE GRID VALUES.
- 2). SEE SHEET 1 OF 10 FOR BASIS OF BEARINGS, MONUMENT NOTES, SHEET INDEX MAP.
- 3). SEE SHEETS 9 AND 10 FOR COORDINATES.
- 4). GROUND DISTANCE = ( GRID DISTANCE ) / ( COMBINED FACTOR ).
- 5). GRID DISTANCE = ( GROUND DISTANCE ) x ( COMBINED FACTOR ).

LEGEND:

- PRIMARY NETWORK, LINES BETWEEN STATIONS ARE NOT INTERVISIBLE.
- PRIMARY NETWORK, ALL LINES BETWEEN STATIONS ARE INTERVISIBLE.
- SECONDARY NETWORK, ALL LINES BETWEEN STATIONS ARE INTERVISIBLE.
- REPEAT BASELINES.

GRAPHIC SCALE

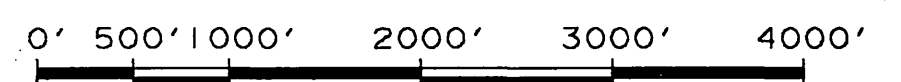

SCALE: 1" = 1000'

RIV. CO. 90-152

IN THE CITIES OF RIVERSIDE AND MORENO VALLEY (RIVERSIDE COUNTY), IN THE CITIES OF SAN BERNARDINO, GRAND TERRACE AND COLTON (SAN BERNARDINO COUNTY), IN THE UNINCORPORATED TERRITORY OF RIVERSIDE COUNTY AND IN THE UNINCORPORATED TERRITORY OF SAN BERNARDINO COUNTY, ALL IN THE STATE OF CALIFORNIA.

# RECORD OF SURVEY

THOSE PORTIONS OF SECTIONS 16, 20, 21, 22, 23, 26, 27, 28, 31, 32 AND 33 OF TOWNSHIP 1 SOUTH, RANGE 4 WEST, SECTIONS 5, 6, 7, 19, 29, 30, 32, 33 AND 34 OF TOWNSHIP 2 SOUTH, RANGE 4 WEST, SECTIONS 12, 13, 23, 24 AND 26 OF TOWNSHIP 2 SOUTH, RANGE 5 WEST AND SECTIONS 2, 3, 4, 10 AND 11 OF TOWNSHIP 3 SOUTH, RANGE 4 WEST, ALL OF SAN BERNARDINO BASE AND MERIDIAN, AND PORTIONS OF JURUPA RANCHO AND RANCHO SAN BERNARDINO.

STATE OF CALIFORNIA, DEPARTMENT OF TRANSPORTATION; MONUMENTATION MAP.

DATE OF SURVEY: MAY 1990 PSOMAS AND ASSOCIATES

SEE SHEET 7 OF 10 SHEETS

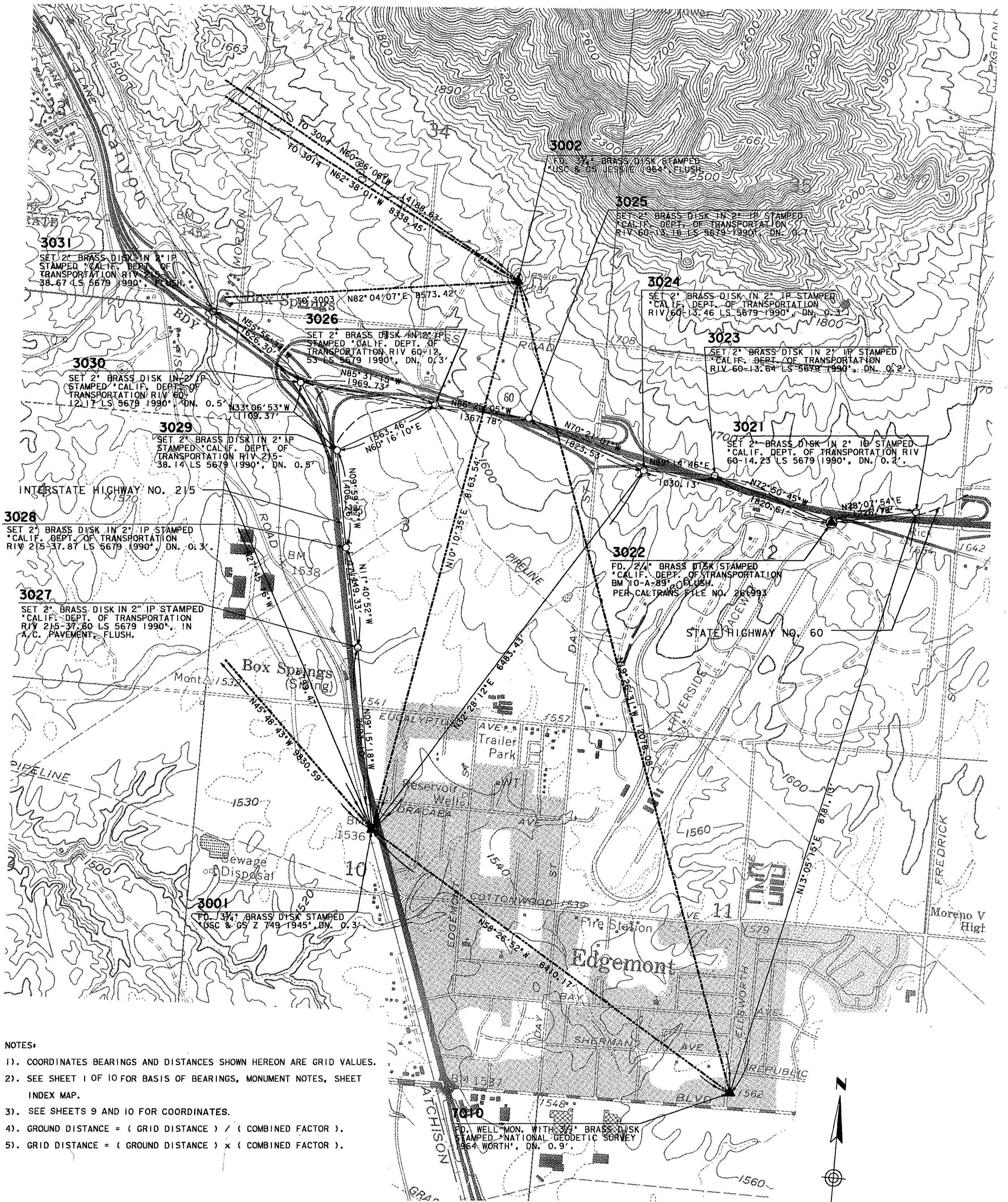

### NOTES:

- 1). COORDINATES BEARINGS AND DISTANCES SHOWN HEREON ARE GRID VALUES.
- 2). SEE SHEET 1 OF 10 FOR BASIS OF BEARINGS, MONUMENT NOTES, SHEET INDEX MAP.
- 3). SEE SHEETS 9 AND 10 FOR COORDINATES.
- 4). GROUND DISTANCE = ( GRID DISTANCE ) / ( COMBINED FACTOR ).
- 5). GRID DISTANCE = ( GROUND DISTANCE ) x ( COMBINED FACTOR ).

### LEGEND:

- PRIMARY NETWORK, LINES BETWEEN STATIONS ARE NOT INTERVISIBLE.
- PRIMARY NETWORK, ALL LINES BETWEEN STATIONS ARE INTERVISIBLE.
- SECONDARY NETWORK, ALL LINES BETWEEN STATIONS ARE INTERVISIBLE.
- REPEAT BASELINES.

### GRAPHIC SCALE

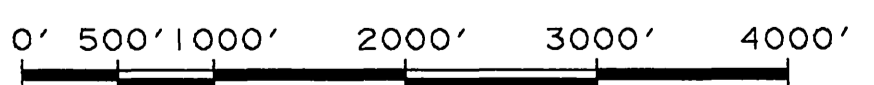

SCALE: 1" = 1000'





IN THE CITIES OF RIVERSIDE AND MORENO VALLEY (RIVERSIDE COUNTY), IN THE CITIES OF SAN BERNARDINO, GRAND TERRACE AND COLTON (SAN BERNARDINO COUNTY), IN THE UNINCORPORATED TERRITORY OF RIVERSIDE COUNTY AND IN THE UNINCORPORATED TERRITORY OF SAN BERNARDINO COUNTY, ALL IN THE STATE OF CALIFORNIA.

RECORD OF SURVEY

THOSE PORTIONS OF SECTIONS 16, 20, 21, 22, 23, 26, 27, 28, 31, 32 AND 33 OF TOWNSHIP 1 SOUTH, RANGE 4 WEST, SECTIONS 5, 6, 7, 19, 29, 30, 32, 33 AND 34 OF TOWNSHIP 2 SOUTH, RANGE 4 WEST, SECTIONS 12, 13, 23, 24 AND 26 OF TOWNSHIP 2 SOUTH, RANGE 5 WEST AND SECTIONS 2, 3, 4, 10 AND 11 OF TOWNSHIP 3 SOUTH, RANGE 4 WEST, ALL OF SAN BERNARDINO BASE AND MERIDIAN, AND PORTIONS OF JURUPA RANCHO AND RANCHO SAN BERNARDINO.

STATE OF CALIFORNIA, DEPARTMENT OF TRANSPORTATION; MONUMENTATION MAP.

DATE OF SURVEY: MAY 1990 PSOMAS AND ASSOCIATES

ZONE 6 VALUES

PRIMARY STATIONS

Table with columns: GPS NO., STATION NAME, NORTH AMERICAN DATUM 1983 (LATITUDE, LONGITUDE), CALIFORNIA COORDINATE SYSTEM 1983 (NORTH (Y), EAST (X)), ZONE 6 (CONVERGENCE, FACTOR). Rows include stations like CLSA 87, Z 749 1945, JESSIE 1964, SYCAMORE 1964, etc.

SECONDARY STATIONS

Table with columns: PT. NO., STATION NAME, NORTH AMERICAN DATUM 1983 (LATITUDE, LONGITUDE), CALIFORNIA COORDINATE SYSTEM 1983 (NORTH (Y), EAST (X)), ZONE 6 (CONVERGENCE, FACTOR). Rows include stations like RIV 60-14.23 1990, RIV 60-13.64 1990, etc.

SET BY CONVENTIONAL METHODS. PRIMARY NETWORK ADJUSTED VALUE NAD 83 PUBLISHED VALUE

NOTES:

- 1.) COORDINATES, BEARINGS AND DISTANCES SHOWN HEREON ARE GRID VALUES.
2.) SEE SHEET 1 OF 10 FOR BASIS OF BEARINGS, MONUMENT NOTES, AND SHEET INDEX MAP.
3.) GROUND DISTANCE = ( GRID DISTANCE ) / ( COMBINED FACTOR ).
4.) GRID DISTANCE = ( GROUND DISTANCE ) X ( COMBINED FACTOR ).
5.) POINT NUMBERS 3002, 3003, 3009 3012, 3013 AND 7010 WERE CONSTRAINED TO THE PUBLISHED NAD 83 COORDINATES FOR THOSE STATIONS AND ARE THE BASIS FOR THE NAD 83 VALUES FOR THE UNCONSTRAINED STATIONS IN THE NETWORK ADJUSTMENT.
6.) CONSTRAINING STATION VERSITY ( 3004 ) TO PUBLISHED NAD 83 COORDINATES INTRODUCED AN UNACCEPTABLE AMOUNT OF SYSTEMATIC ERROR INTO THE NETWORK ADJUSTMENT AND WAS THEREFORE UNCONSTRAINED IN THE ADJUSTMENT.

Copy

IN THE CITIES OF RIVERSIDE AND MORENO VALLEY (RIVERSIDE COUNTY), IN THE CITIES OF SAN BERNARDINO, GRAND TERRACE AND COLTON (SAN BERNARDINO COUNTY), IN THE UNINCORPORATED TERRITORY OF RIVERSIDE COUNTY AND IN THE UNINCORPORATED TERRITORY OF SAN BERNARDINO COUNTY, ALL IN THE STATE OF CALIFORNIA.

# RECORD OF SURVEY

THOSE PORTIONS OF SECTIONS 16, 20, 21, 22, 23, 26, 27, 28, 31, 32 AND 33 OF TOWNSHIP 1 SOUTH, RANGE 4 WEST, SECTIONS 5, 6, 7, 19, 29, 30, 32, 33 AND 34 OF TOWNSHIP 2 SOUTH, RANGE 4 WEST, SECTIONS 12, 13, 23, 24 AND 26 OF TOWNSHIP 2 SOUTH, RANGE 5 WEST AND SECTIONS 2, 3, 4, 10 AND 11 OF TOWNSHIP 3 SOUTH, RANGE 4 WEST, ALL OF SAN BERNARDINO BASE AND MERIDIAN, AND PORTIONS OF JURUPA RANCHO AND RANCHO SAN BERNARDINO.

STATE OF CALIFORNIA, DEPARTMENT OF TRANSPORTATION MONUMENTATION MAP  
DATE OF SURVEY: MAY 1990 PSOMAS AND ASSOCIATES

## ZONE 5 VALUES

### PRIMARY STATIONS:

PT. NO.	STATION NAME	NORTH AMERICAN DATUM 1983		CALIFORNIA COORDINATE SYSTEM 1983:			ZONE 5 COMBINED FACTOR
		LATITUDE	LONGITUDE	NORTH (Y) U.S. SURVEY FEET	EAST (X) U.S. SURVEY FEET	CONVERGENCE	
▲ 3000	CLSA 87	34°00'13.02486"N	117°22'49.35216"W	1824277.648	6749466.338	0°21'11.495"	0.99996767
▲ 3001	Z 749 1945	33°55'36.12530"N	117°17'16.46006"W	1796472.426	6777690.599	0°24'21.248"	0.99995134
▲ 3002	JESSIE 1964	33°56'55.74921"N	117°17'00.28980"W	1804531.047	6778995.826	0°24'30.465"	0.99993417
▲ 3003	SYCAMORE 1964	33°56'43.20305"N	117°18'40.93505"W	1803203.526	6770525.734	0°23'33.096"	0.99994051
▲ 3005	601-11-68 RESET 1974	33°58'17.39156"N	117°22'21.06438"W	1812603.381	6751920.844	0°21'27.620"	0.99997210
▲ 3006	SBD-215-45.01 1988	34°00'55.47599"N	117°20'33.55726"W	1828641.518	6760870.776	0°22'28.900"	0.99995978
▲ 3007	R 449 1949	34°01'26.75401"N	117°20'00.35931"W	1831821.714	6763644.328	0°22'47.823"	0.99995737
▲ 3009	MEEK 1964	34°02'35.69610"N	117°18'20.93938"W	1838847.466	6771964.239	0°23'44.494"	0.99994096
▲ 3010	(NOT NAMED)	34°03'46.98107"N	117°16'43.28601"W	1846111.249	6780129.984	0°24'40.157"	0.99994514
▲ 3011	Q 527 RESET 1976	34°04'06.94792"N	117°17'38.28466"W	1848096.769	6775488.810	0°24'08.807"	0.99994499
▲ 3012	FLEMING 1964	34°04'14.84385"N	117°19'29.07083"W	1848830.904	6766163.687	0°23'05.658"	0.99994466
▲ 3013	CHAPARRAL 1928 1970	34°09'13.82464"N	117°18'32.19241"W	1879086.234	6770740.612	0°23'38.079"	0.99989401
▲ 3014	Q 298 1935	33°57'32.92979"N	117°18'28.64769"W	1808237.362	6771526.308	0°23'40.100"	0.99995138
▲ 3015	Q 449 1949	34°02'18.67583"N	117°19'55.58916"W	1837072.980	6764010.950	0°22'50.542"	0.99995471
▲ 3016	COLT F NO 1 1964	34°04'43.63155"N	117°18'05.66911"W	1851788.884	6773159.360	0°23'53.198"	0.99994174
▲ 7010	WORTH 1964	33°55'03.47829"N	117°16'11.24998"W	1793211.663	6783209.590	0°24'58.418"	0.99995236

### SECONDARY STATIONS:

PT. NO.	STATION NAME	NORTH AMERICAN DATUM 1983		CALIFORNIA COORDINATE SYSTEM 1983:			ZONE 5 COMBINED FACTOR	
		LATITUDE	LONGITUDE	NORTH (Y) U.S. SURVEY FEET	EAST (X) U.S. SURVEY FEET	CONVERGENCE		
○ 3004	VERSITY 1964 1975	33°58'03.76549"N	117°19'27.62937"W	1811320.649	6766537.096	0°23'06.480"	0.99994862	PRIMARY NETWORK ADJUSTED VALUE
○ 3004	VERSITY 1964 1975	33°58'03.76460"N	117°19'27.62901"W	1811320.560	6766537.126	0°23'06.480"	0.99994862	NAD 83 PUBLISHED VALUE
○ 3021	RIV 60-14.23 1990	33°56'28.27598"N	117°15'48.64382"W	1801797.495	6785051.925	0°25'11.304"	0.99994205	
○ 3022	BM 10-A-89	33°56'25.66458"N	117°16'02.86331"W	1801524.763	6783855.833	0°25'03.199"	0.99994274	
○ 3023	RIV 60-13.64 1990	33°56'30.80786"N	117°16'23.57222"W	1802032.015	6782107.296	0°24'51.394"	0.99994138	
○ 3024	RIV 60-13.46 1990	33°56'30.57362"N	117°16'35.79573"W	1802000.907	6781077.623	0°24'44.427"	0.99994175	
○ 3025	RIV 60-13.16 1990	33°56'36.47155"N	117°16'56.25010"W	1802584.757	6779350.062	0°24'32.768"	0.99994240	
○ 3026	RIV 60-12.53 1990	33°56'37.18284"N	117°17'12.46228"W	1802646.937	6777983.683	0°24'23.527"	0.99994472	
○ 3027	RIV 215-37.60 1990	33°56'01.69336"N	117°17'21.77244"W	1799053.858	6777224.671	0°24'18.220"	0.99994935	
○ 3028	RIV 215-37.87 1990	33°56'15.70408"N	117°17'25.42288"W	1800467.986	6776907.089	0°24'16.139"	0.99994805	
○ 3029	RIV 215-38.14 1990	33°56'29.37931"N	117°17'28.48405"W	1801848.554	6776639.421	0°24'14.394"	0.99994736	
○ 3030	RIV 60-12.17 1990	33°56'38.51068"N	117°17'35.78745"W	1802767.284	6776017.608	0°24'10.231"	0.99994635	
○ 3031	RIV 215-38.67 1990	33°56'47.39006"N	117°17'51.88449"W	1803655.369	6774655.177	0°24'01.055"	0.99994783	
○ 3032	BB RESET	33°56'52.74806"N	117°18'06.01779"W	1804188.697	6773460.732	0°23'52.999"	0.99994741	
○ 3033	RIV 215-38.99 1990	33°57'10.77326"N	117°18'15.17713"W	1806005.459	6772676.490	0°23'47.778"	0.99994809	
○ 3034	RIV 215-39.17 1990	33°57'19.80660"N	117°18'19.44218"W	1806916.127	6772310.891	0°23'45.347"	0.99994862	
○ 3036	RIV 215-39.67 1990	33°57'38.64289"N	117°18'42.45544"W	1808806.896	6770359.273	0°23'32.229"	0.99995022	
○ 3037	RIV 215-39.98 1990	33°57'37.94338"N	117°19'01.63920"W	1808725.164	6768743.861	0°23'21.294"	0.99995486	
○ 3038	CL UNIV. KNOLLS 103+25.02 POC	33°57'44.64828"N	117°19'19.67167"W	1809392.661	6767220.368	0°23'11.016"	0.99995712	
○ 3039	RIV 215-40.59 1990	33°57'54.25950"N	117°19'35.71256"W	1810355.148	6765862.724	0°23'01.872"	0.99996101	
○ 3040	RIV 215-40.87 1990	33°58'07.67004"N	117°19'41.39894"W	1811707.575	6765374.710	0°22'58.631"	0.99996310	
○ 3041	RIV 215-41.15 1990	33°58'18.31668"N	117°19'53.71594"W	1812776.896	6764330.162	0°22'51.610"	0.99996402	
○ 3042	BM 4-B-61	33°58'32.79412"N	117°20'06.55667"W	1814233.204	6763239.018	0°22'44.291"	0.99996300	
○ 3043	CL IMP 721+06.72 POT	33°58'45.64455"N	117°20'20.74694"W	1815524.335	6762035.410	0°22'36.202"	0.99996440	
○ 3044	CL IMP 717+48.72 POT	33°58'48.34002"N	117°20'23.50467"W	1815795.286	6761801.382	0°22'34.630"	0.99996449	
○ 3045	CL IMP 703+58.97 POT	33°58'58.80436"N	117°20'34.21136"W	1816847.186	6760892.823	0°22'28.527"	0.99996521	
○ 3046	RIV 215-42.48 1990	33°59'12.01322"N	117°20'46.82315"W	1818175.505	6759822.100	0°22'21.338"	0.99996525	
○ 3047	RIV 215-42.69 1990	33°59'20.39596"N	117°20'55.71104"W	1819018.033	6759068.192	0°22'16.272"	0.99996461	
○ 3048	RIV 215-43.05 1990	33°59'30.53111"N	117°21'13.45953"W	1820032.920	6757567.109	0°22'06.155"	0.99996537	
○ 3049	RIV-60-12.21 1988	33°59'36.47866"N	117°21'25.90292"W	1820627.422	6756515.515	0°21'59.062"	0.99996647	
○ 3050	CL IMP 624+31.98 POT	33°59'45.29537"N	117°21'48.31172"W	1821506.669	6754623.056	0°21'46.289"	0.99996787	
○ 3051	CL IMP 619+77.89 POT	33°59'47.24956"N	117°21'53.16470"W	1821701.627	6754213.200	0°21'43.523"	0.99996858	
○ 3052	RIV 60-11.44 1990	33°59'54.09478"N	117°22'09.84111"W	1822384.749	6752804.760	0°21'34.017"	0.99996857	
○ 3053	RIV 60-11.07 1990	34°00'02.91801"N	117°22'30.69420"W	1823265.701	6751043.493	0°21'22.130"	0.99996784	
○ 3054	RIV 91-20.13 1990	33°58'30.92181"N	117°22'20.99656"W	1813971.152	6751918.017	0°21'27.658"	0.99997241	
○ 3055	RIV 91-20.45 1990	33°58'47.00575"N	117°22'13.92521"W	1815600.756	6752503.371	0°21'31.689"	0.99996951	
○ 3056	RIV 91-20.70 1990	33°58'55.92613"N	117°22'02.02786"W	1816508.783	6753499.612	0°21'38.471"	0.99996882	
○ 3057	RIV 91-20.87 1990	33°59'04.49952"N	117°21'57.20685"W	1817378.001	6753900.127	0°21'41.219"	0.99996835	
○ 3058	RIV 91-21.14 1990	33°59'15.98526"N	117°21'47.21606"W	1818544.380	6754734.081	0°21'46.914"	0.99996837	
○ 3059	CL IMP 452+29.26 POC	33°59'27.39950"N	117°21'32.02786"W	1819706.318	6756001.861	0°21'55.545"	0.99996686	
○ 3060	RIV 215-43.50 1990	33°59'46.79090"N	117°21'19.92738"W	1821673.077	6757011.969	0°22'02.468"	0.99996695	
○ 3061	CL COL. 19+66.26 POC	34°00'04.87868"N	117°21'07.40436"W	1823508.294	6758054.581	0°22'09.607"	0.99996441	
○ 3062	RIV 215-44.18 1990	34°00'17.85126"N	117°20'59.59123"W	1824823.899	6758703.900	0°22'14.060"	0.99996425	
○ 3063	RIV 215-44.38 1990	34°00'26.85605"N	117°20'53.56231"W	1825737.453	6759205.560	0°22'17.497"	0.99996344	
○ 3064	RIV 215-44.78 1990	34°00'45.38214"N	117°20'41.09813"W	1827617.019	6760242.655	0°22'24.602"	0.99996199	
○ 3065	SBD 215-0.06 1990	34°01'12.69287"N	117°20'20.79224"W	1830388.963	6761933.860	0°22'36.176"	0.99995881	
○ 3066	3-50, 10 POT IOWA	34°01'26.39398"N	117°20'07.38204"W	1831781.405	6763053.475	0°22'43.820"	0.99995742	
○ 3067	SBD-215-0.84 1988	34°01'44.78069"N	117°19'50.58829"W	1833649.434	6764454.610	0°22'53.393"	0.99995557	
○ 3068	SBD 215-1.31 1990	34°02'02.15015"N	117°19'29.25823"W	1835417.261	6766238.029	0°23'05.551"	0.99995278	
○ 3069	SBD 215-1.48 1990	34°02'08.92719"N	117°19'22.85718"W	1836105.952	6766772.121	0°23'09.200"	0.99995202	
○ 3070	SBD-215-1.78 1988	34°02'19.66281"N	117°19'09.81771"W	1837198.589	6767862.133	0°23'16.633"	0.99994972	
○ 3071	SBD 215-2.17 1990	34°02'32.36881"N	117°18'50.29959"W	1838494.159	6769495.892	0°23'27.758"	0.99994707	
○ 3072	SBD 215-2.49 1990	34°02'43.39213"N	117°18'36.84351"W	1839616.216	6770620.579	0°23'35.428"	0.99995277	
○ 3073	CL IMP 151+01.51 POT	34°02'51.25349"N	117°18'27.24913"W	1840416.444	6771422.444	0°23'40.897"	0.99995135	
○ 3074	SBD 215-3.02 1990	34°03'01.39510"N	117°18'11.12850"W	1841450.996	6772771.806	0°23'50.086"	0.99995065	
○ 3075	SBD 215-3.33 1990	34°03'13.44859"N	117°17'57.56003"W	1842677.376	6773904.992	0°23'57.820"	0.99994884	
○ 3076	SBD-215-3.72 1988	34°03'33.37289"N	117°17'49.55926"W	1844696.149	6774564.082	0°24'02.381"	0.99994686	
○ 3077	SBD 215-3.94 1990	34°03'44.43122"N	117°17'47.22142"W	1845815.370	6774752.948	0°24'03.713"	0.99994609	
○ 3078	SBD 215-4.21 1990	34°03'58.95999"N	117°17'44.64189"W	1847285.548	6774959.674	0°24'05.184"	0.99994522	
○ 3079	SBD 215-3.19 1990	34°03'07.35596"N	117°18'03.24896"W	1842058.162	6773430.616	0°23'54.578"	0.99994937	
○ 3080	SBD 215-1.02 1990	34°01'50.60729"N	117°19'41.42039"W	1834243.574	6765222.276	0°22'58.619"	0.99995476	SET BY CONVENTIONAL METHODS.

### NOTES:

- COORDINATES, BEARINGS AND DISTANCES SHOWN HEREON ARE GRID VALUES.
- SEE SHEET 1 OF 10 FOR BASIS OF BEARINGS, MONUMENT NOTES, AND SHEET INDEX MAP.
- GROUND DISTANCE = ( GRID DISTANCE ) / ( COMBINED FACTOR ).
- GRID DISTANCE = ( GROUND DISTANCE ) X ( COMBINED FACTOR ).
- POINT NUMBERS 3002, 3003, 3009 3012, 3013 AND 7010 WERE CONSTRAINED TO THE PUBLISHED NAD 83 COORDINATES FOR THOSE STATIONS AND ARE THE BASIS FOR THE NAD 83 VALUES FOR THE UNCONSTRAINED STATIONS IN THE NETWORK ADJUSTMENT.
- CONSTRAINING STATION VERSITY ( 3004 ) TO PUBLISHED NAD 83 CO