

IN THE CITIES OF RIVERSIDE AND MORENO VALLEY (RIVERSIDE COUNTY), IN THE CITIES OF SAN BERNARDINO, GRAND TERRACE AND COLTON (SAN BERNARDINO COUNTY), IN THE UNINCORPORATED TERRITORY OF RIVERSIDE COUNTY AND IN THE UNINCORPORATED TERRITORY OF SAN BERNARDINO COUNTY, ALL IN THE STATE OF CALIFORNIA.

RECORD OF SURVEY

THOSE PORTIONS OF SECTIONS 16, 20, 21, 22, 23, 26, 27, 28, 31, 32 AND 33 OF TOWNSHIP 1 SOUTH, RANGE 4 WEST, SECTIONS 5, 6, 7, 19, 29, 30, 32, 33 AND 34 OF TOWNSHIP 2 SOUTH, RANGE 4 WEST, SECTIONS 12, 13, 23, 24 AND 26 OF TOWNSHIP 2 SOUTH, RANGE 5 WEST AND SECTIONS 2, 3, 4, 10 AND 11 OF TOWNSHIP 3 SOUTH, RANGE 4 WEST, ALL OF SAN BERNARDINO BASE AND MERIDIAN, AND PORTIONS OF JURUPA RANCHO AND RANCHO SAN BERNARDINO.

STATE OF CALIFORNIA, DEPARTMENT OF TRANSPORTATION; MONUMENTATION MAP.

DATE OF SURVEY: MAY 1990 PSOMAS AND ASSOCIATES



GRAPHIC SCALE

0' 500' 1000' 2000' 3000' 4000'

SCALE: 1" = 1000'

LEGEND:

- PRIMARY NETWORK, LINES BETWEEN STATIONS ARE NOT INTERVISIBLE.
- - - - - PRIMARY NETWORK, ALL LINES BETWEEN STATIONS ARE INTERVISIBLE.
- SECONDARY NETWORK, ALL LINES BETWEEN STATIONS ARE INTERVISIBLE.
- REPEAT BASELINES.

NOTES:

- 1). COORDINATES, BEARINGS AND DISTANCES SHOWN HEREON ARE GRID VALUES.
- 2). SEE SHEET 1 OF 10 FOR BASIS OF BEARINGS, MONUMENT NOTES, SHEET INDEX MAP.
- 3). SEE SHEETS 9 AND 10 FOR COORDINATES.
- 4). GROUND DISTANCE = (GRID DISTANCE) / (COMBINED FACTOR).
- 5). GRID DISTANCE = (GROUND DISTANCE) x (COMBINED FACTOR).

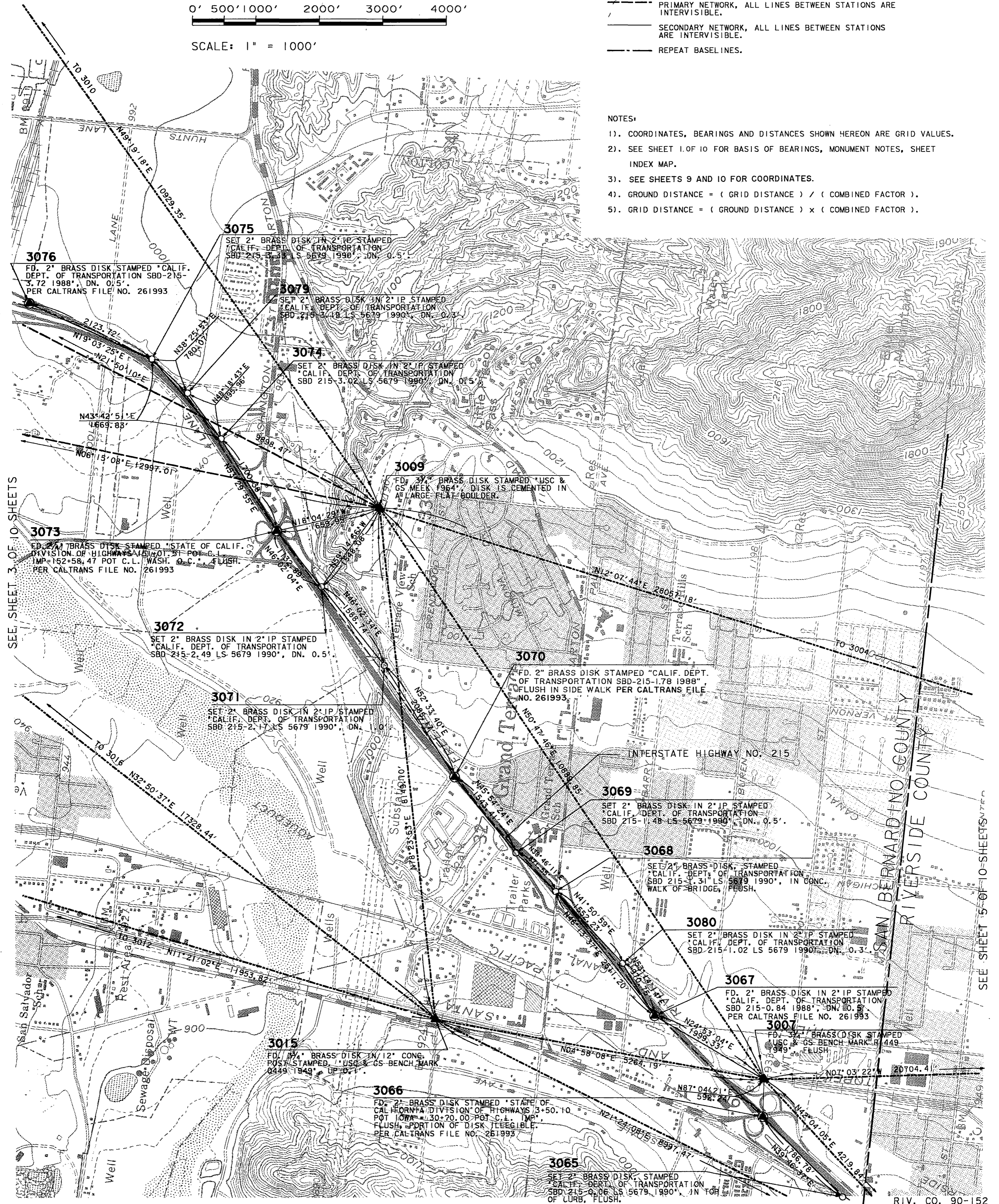

SEE SHEET 3 OF 10 SHEETS

SEE SHEET 5 OF 10 SHEETS

RIV. CO. 90-152