

GENERAL NOTES

1. Construction shall be in accordance with the Standard Specifications for Public Works Construction, 1973 Edition, and the City of Riverside Standard Drawings.
2. It shall be the responsibility of the contractor to clear the Right of Way in accordance with the provisions of the law as it affects each utility, including irrigation lines and appurtenances at no cost to the City.
3. Pipe shall be bedded per Case 1, Standard No 452, unless otherwise specified on plans.
4. All stubs and laterals to be constructed in accordance with Standard Drawing No 562. See Note 10.
5. Manhole frames and covers to be set as noted in the profile by the sewer contractor after final paving of streets.
6. Laterals are to be 4" and extend to property line.
7. Prior to construction of sewer, contractor is to expose the existing sewer and contact the Engineer for verification of existing location and elevation.
8. A plug shall be installed and will remain in place where the new sewer connects with existing sewer until such time as new sewer is accepted by the City.
9. Enclose Sewer 4.5' each side of proposed water main crossing per Public Utilities Drawing CWD-023, Type B.
10. All laterals shall have a 1/8" per foot slope and wyes are to lay flat.

NOTICE TO CONTRACTOR

The existence and location of underground utilities, pipes or structures shown on these plans are obtained by a search of the available records. To the best of our knowledge, there are no existing utilities except as shown on these plans. The contractor is required to make due precautionary measures to protect the utility lines shown and any other lines not of record or not shown on these plans.

BENCH MARK

Top of Brass Disc stamped GA-B in capped man. at Monroe 10 feet North-westerly of E California Ave. City of Riverside P.B. 735/44. Elen * 754,925

*AS BUILT 8-76 KPT

Approved by: *[Signature]* 8-7-75
 Chief Water Utility Engineer

ALBERT A. WEBB ASSOCIATES CIVIL ENGINEERS RIVERSIDE, CALIFORNIA APPROVED BY: <i>[Signature]</i> DATE 5/13/75 R.E. No. 2876 W.O. 74-4 FOR: <i>[Signature]</i> DEVELOPERS F.B. 1020	DESIGNED BY: <i>[Signature]</i> DRAWN BY: <i>[Signature]</i> CHECKED BY: <i>[Signature]</i>	CITY OF RIVERSIDE, CALIFORNIA PUBLIC WORKS DEPARTMENT		SEWER PLAN & PROFILE	ACCOUNT No. DRAWING NUMBER
		APPROVED BY: <i>[Signature]</i> DATE 10/23/75 CHIEF PUB. WKS. ENGR.	BY: <i>[Signature]</i> DATE 10/23/75 PRINCIPAL ENGINEER PARK DEPARTMENT TRAFFIC DIVISION	APPROVED BY: <i>[Signature]</i> DATE 8-7-75 DIRECTOR OF PUBLIC WORKS	KINGSBURY PLACE TRACT NO. 5130-3

SCALE: Horiz. 1"=40' Vert. 1"=4'

750

740

730

750

740

730

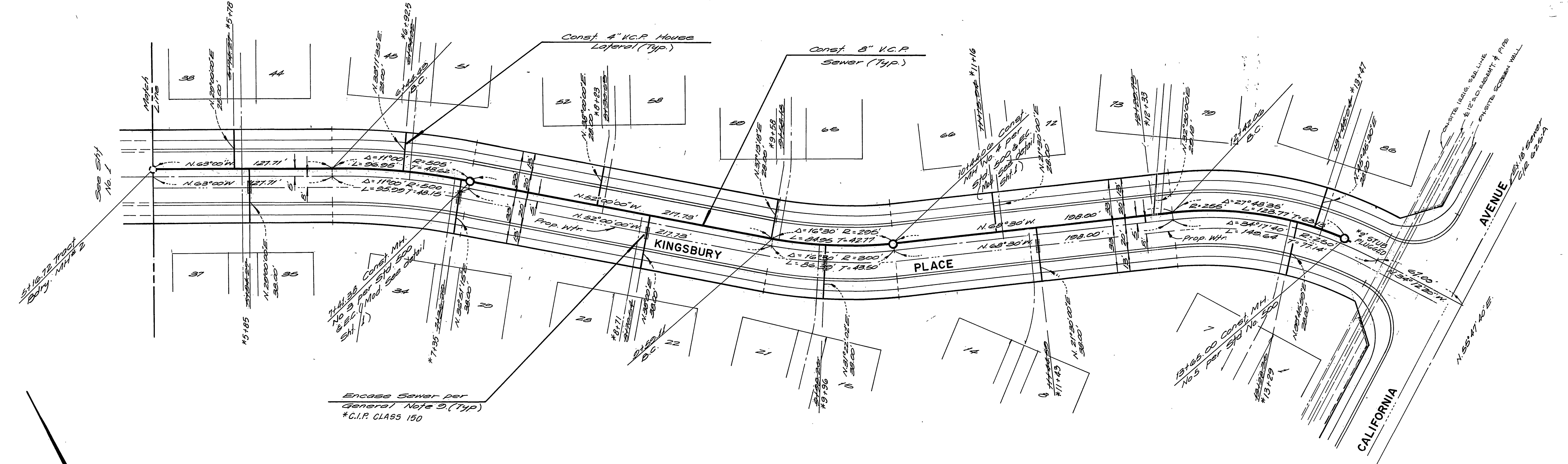
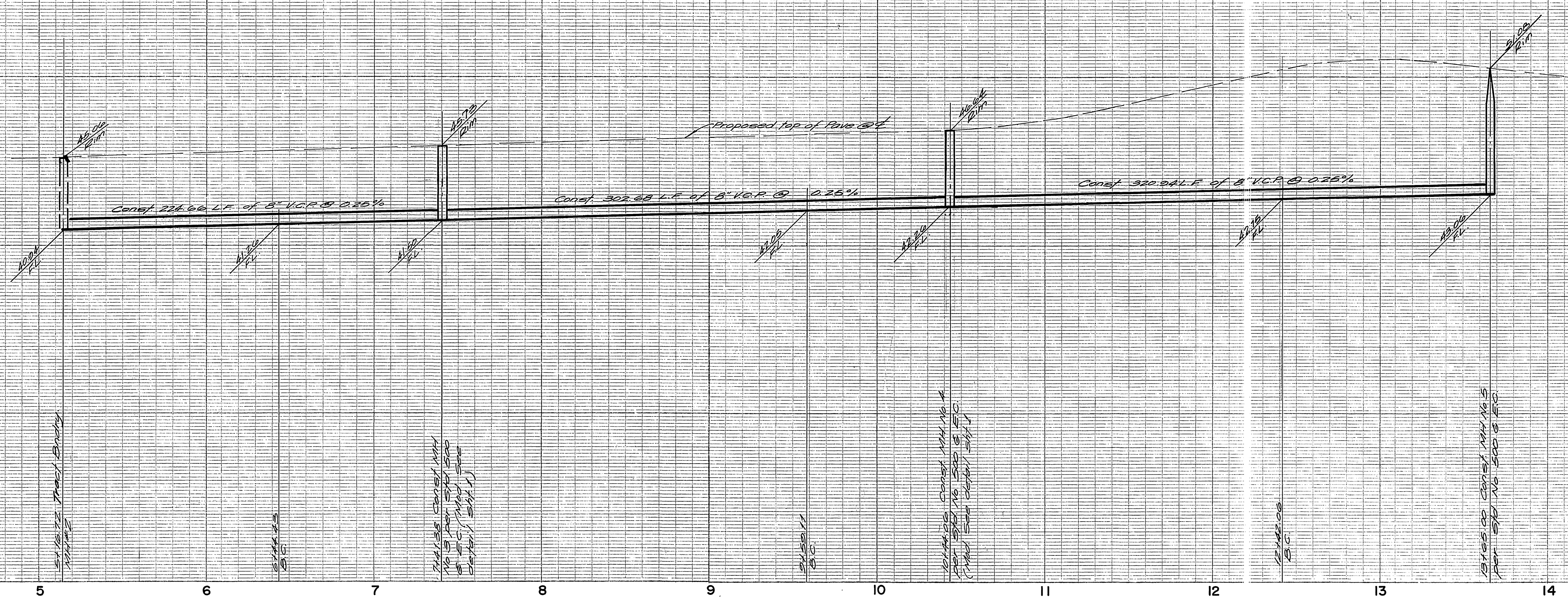

BENCH MARK
 Top of Brass Disc clamped 64.0 in capped man. of Monroes 10' North-westerly of E California Ave. City of Riverside R.B. 735/44.
 Elev. = 744.925.

Note: For General Notes See Sheet No. 1

Approved By: <i>Walter S. Webb</i> 8-7-75 Chief Water Utility Engineer Date		*AS BUILT 8-76 KET	
ALBERT A. WEBB ASSOCIATES CIVIL ENGINEERS RIVERSIDE, CALIFORNIA APPROVED BY: <i>Walter S. Webb</i> DATE: 5/13/75 R.E. No. 2876		CITY OF RIVERSIDE, CALIFORNIA PUBLIC WORKS DEPARTMENT APPROVED BY: <i>Samuel J. Smith</i> DIRECTOR OF PUBLIC WORKS DATE: 10-23-75	
SEWER PLAN AND PROFILE KINGSBURY PLACE TRACT NO. 5130-3		ACCOUNT No. DRAWING NUMBER S-1013 SHEET 2 OF 2 74-4-B	
W.O. 74-4 FOR: Woodhaven Developers F.B. 1029 DESIGNED BY: <i>W.S.W.</i> DRAWN BY: <i>E.L.T.</i> CHECKED BY: <i>W.S.W.</i>		SCALE: Horiz. 1"=40' Vert. 1"=4' REVISIONS:	