

TRACT NO. 6070-1

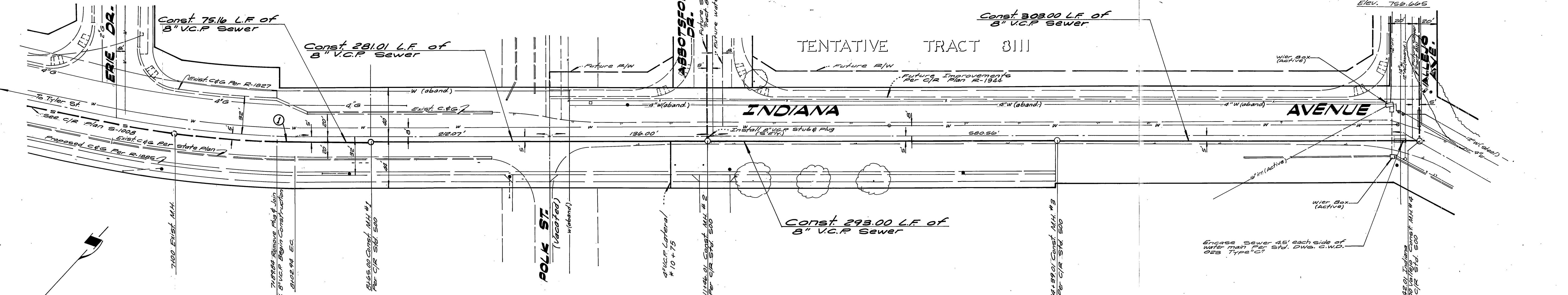

**Bench Mark:**  
 Brass Disc Set in Concrete Stamped  
 60'-25'-00" on West side of Tyler Street  
 250' North of Indiana Avenue and 11'  
 Northeast of bridge No. 26-419  
 Elev. 758.645

CURVE DATA			
No.	R	Δ	L
1	755.00'	1°08'48"	795' 15.10'

**General Notes:**

- Construction shall be in accordance with the standard specifications for Public Works Construction, 1976 Edition, and the City of Riverside Standard Drawings.
- It shall be the responsibility of the Contractor to clear the Right of Way in accordance with the provisions of law as it affects each utility, including irrigation lines and appurtenances and at no cost to the City.
- Pipe shall be bedded per Case I, Standard Drawing No. 452, unless otherwise specified on the plans.
- Location of wyes and laterals to be determined in the field at the direction of the owner.
- All stubs and laterals to be constructed in accordance with standard Drawing No. 562. Stubs shall be plugged and capped.

- Manhole frames and covers to be set as noted in profiles by Sewer Contractor after final paving of streets.
- Laterals are to be 4" V.C.P. and extended to property line.
- Prior to construction of Sewer, Contractor is to expose the exist. Sewer and contact the Engineer for verification of existing location and elevation.
- Plugs shall be installed, and will remain in place, where the new Sewer connects with the existing sewer until such time as the new sewer is accepted by the City.
- Encase Sewer 45' each side of proposed water main crossings per Public Utilities Drawing CWD 023, Type C.
- The private Engineer signing these plans is responsible for the accuracy and acceptability of the work hereon. In the event of discrepancies arising during construction, the private engineer shall be responsible for determining an acceptable solution and revising the plans for approval by the City.

**Notice to Contractor:**

The existence and location of underground utility pipes or structures shown on these plans are obtained by a search of the available records to the best of our knowledge. These are not existing utilities except as shown on these plans. The Contractor is required to take due precautionary measures to protect the utility lines shown and any other lines not of record or not shown on these plans.

APPROVED BY: *Walter Hyler* 2-9-77  
 Chief Utilities Engineer, Water  
 Date

ALBERT A. WEBB ASSOCIATES  
 CIVIL ENGINEERS  
 RIVERSIDE, CALIFORNIA  
 APPROVED BY: *Emmett Hill* DATE 4/2/76  
 R.E. No. 9876

MARK	REVISIONS	APPR. DATE

CITY OF RIVERSIDE, CALIFORNIA  
 PUBLIC WORKS DEPARTMENT  
 APPROVED BY: *Walter Hyler*  
 DIRECTOR OF PUBLIC WORKS  
 DATE 4-13-77

SEWER PLAN & PROFILE  
**INDIANA AVENUE**  
 320' ELY. OF ERIE DRIVE  
 TO 420' WLY. OF POLK ST.  
 FOR R-39-750

ACCOUNT No. 70-144  
 DRAWING NUMBER  
**S-1045**  
 SHEET 1 OF 1  
 W.C. 70-144