

- GENERAL NOTES**
1. It shall be the responsibility of the contractor to clear the right-of-way in accordance with the provisions of law as it affects each utility including irrigation lines and appurtenances and at no cost to the City.
 2. Construction shall be in accordance with the City of Riverside, Department of Public Works, Standard Drawings and the Standard Specifications for Public Works Construction, 1973 Edition.
 3. Location of laterals to be determined in the field at the direction of the owner.
 4. Contractor is to verify existing sewer elevation prior to construction.
 5. The sewer contractor shall adjust manholes to final grade after paving is completed.
 6. A plug shall be installed and will remain in place where the new sewer connects with the existing sewer until the new sewer is accepted by the City.

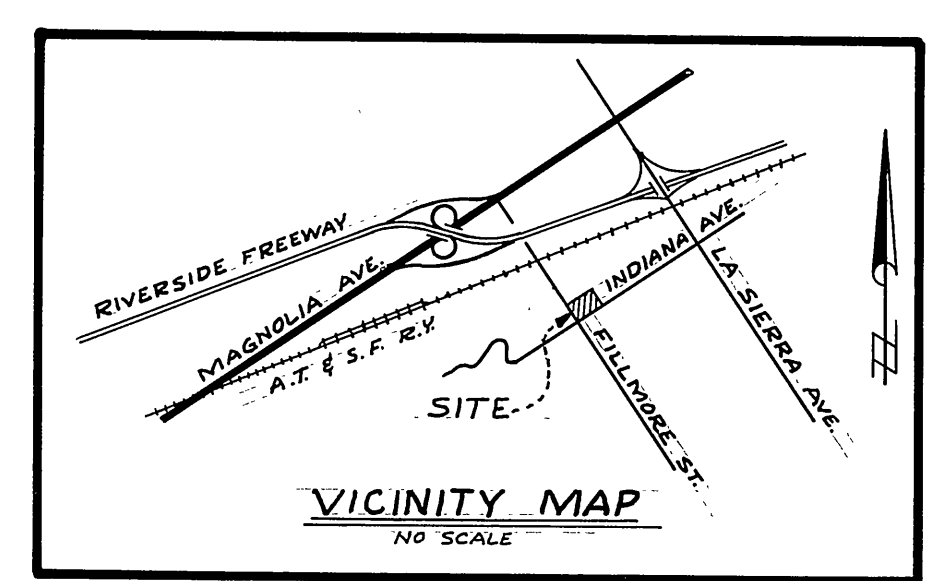

- CONSTRUCTION NOTES**
1. CONSTRUCT 8" V.C.P. SEWER MAIN
 2. CONSTRUCT 4" V.C.P. HOUSE LATERAL
- BENCH MARK**
CITY BM# E2-D. PK NAIL IN CENTER
S.E. CURB RETURN, INDIANA AND
FILLMORE STREET C.R.F.B. 739/54
ELEV. 738.968

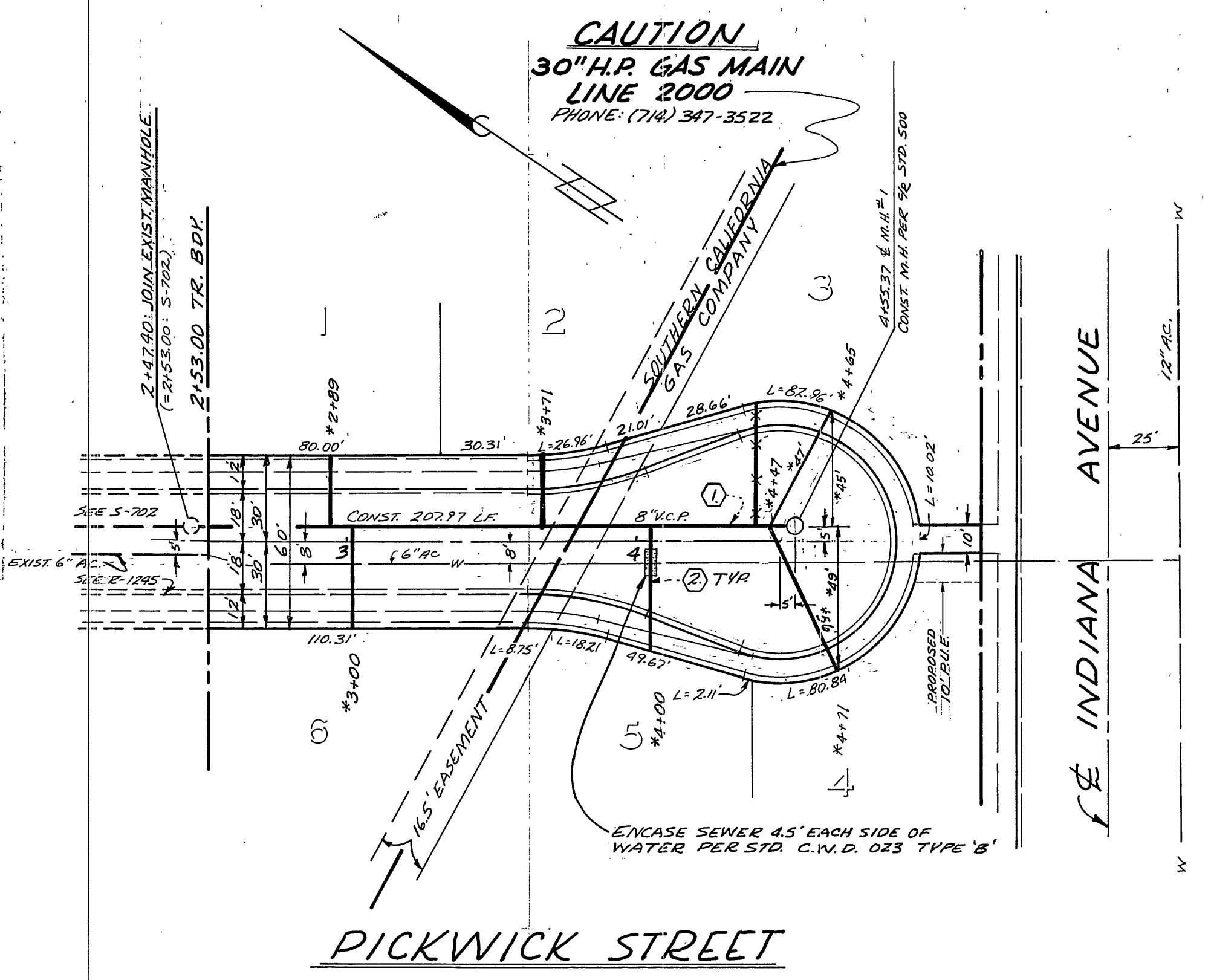

SOUTHERN CALIFORNIA GAS COMPANY
APPROVED BY: *Robert* 8/20/76
DATE

APPROVED BY: *Nancy Hyman* 7-29-76
DATE
CHIEF UTILITIES ENGINEER, WATER

J. F. DAVIDSON ASSOCIATES
CIVIL ENGINEERS - SURVEYORS - PLANNERS
RIVERSIDE, CALIFORNIA

APPROVED BY: *J. F. Davidson* DATE 3/30/76
R.E. No. 17550

W.D. 4808 FOR MURRAY DEV. CORP. F.B. 1099-743

MARK	REVISIONS	APPR. DATE

DESIGNED BY *WS* DRAWN BY *WS* CHECKED BY *EDM*

CITY OF RIVERSIDE, CALIFORNIA
DEPARTMENT OF PUBLIC WORKS

APPROVED BY: *[Signature]* DATE 8-27-76
PRINCIPAL ENGINEER
PARK DEPARTMENT
TRAFFIC DIVISION
CHIEF P. W. ENGR.

*AS BUILT 3-77 KPT
SEWER PLAN AND PROFILE

TRACT NO. 7568
PICKWICK STREET

PROJECT NO. S-1048
SHEET 1 OF 1
FILE NO. 4497

HORIZ. SCALE: 1" = 40' VERT. SCALE: 1" = 4'