

NOTICE TO CONTRACTOR

The existence and location of underground utility pipes or structures shown on these plans are obtained by a search of the available records. To the best of our knowledge there are no existing utilities except as shown on these plans.

The Contractor is required to take due precautionary measures to protect the utility lines shown and any other lines not of record or not shown on these plans.

ENGINEERS' NOTE

The private engineer signing these plans is responsible for the accuracy and acceptability of the work hereon. In the event of discrepancies arising during construction, the private engineer signing these plans shall be responsible for determining an acceptable solution and revising the plans for approval by the City.

GENERAL NOTES

1. Construction shall be in accordance with the Standard Specifications for Public Works Construction 1976 Edition and the City of Riverside Standard Drawings.
2. It shall be the responsibility of the contractor to clear the Right of way in accordance with the provisions of law as it affects each utility including irrigation lines and appurtenances and at no cost to the city.
3. Pipe shall be bedded per Case I, Standard Drawing No. 452, unless otherwise specified on the plans.
4. Location of wyes, laterals and saddles to be determined in the field at the direction of the owner.
5. All stubs and laterals to be constructed in accordance with Standard drawing No. 562. Stubs shall be plugged and capped.
6. Manhole frames and covers to be set as noted in profile by sewer contractor after final paving of streets.
7. Laterals are to be 4" V.C.P. and extended to property line.
8. Prior to construction of the sewer, the contractor is to expose the existing sewer and contact the Engineer for verification of existing location and elevation.
9. Plugs shall be installed and will remain in place where the new sewer connects with the existing sewer until such time as the new sewer is accepted by the city.

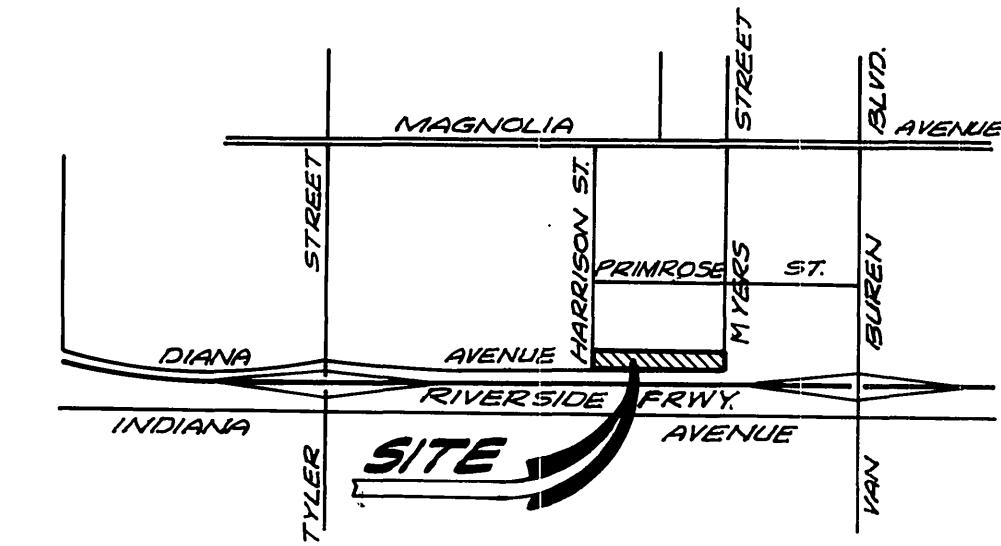

LOCATION MAP
NO SCALE

CONSTRUCTION NOTES

- 1 Construct 8"x4" saddle.
- 2 Join existing chimney.
- 3 Construct 4" V.C.P. lateral to property line.
- 4 Construct 8" V.C.P. sewer line.
- 5 Construct Manhole per City Standard No. 500.

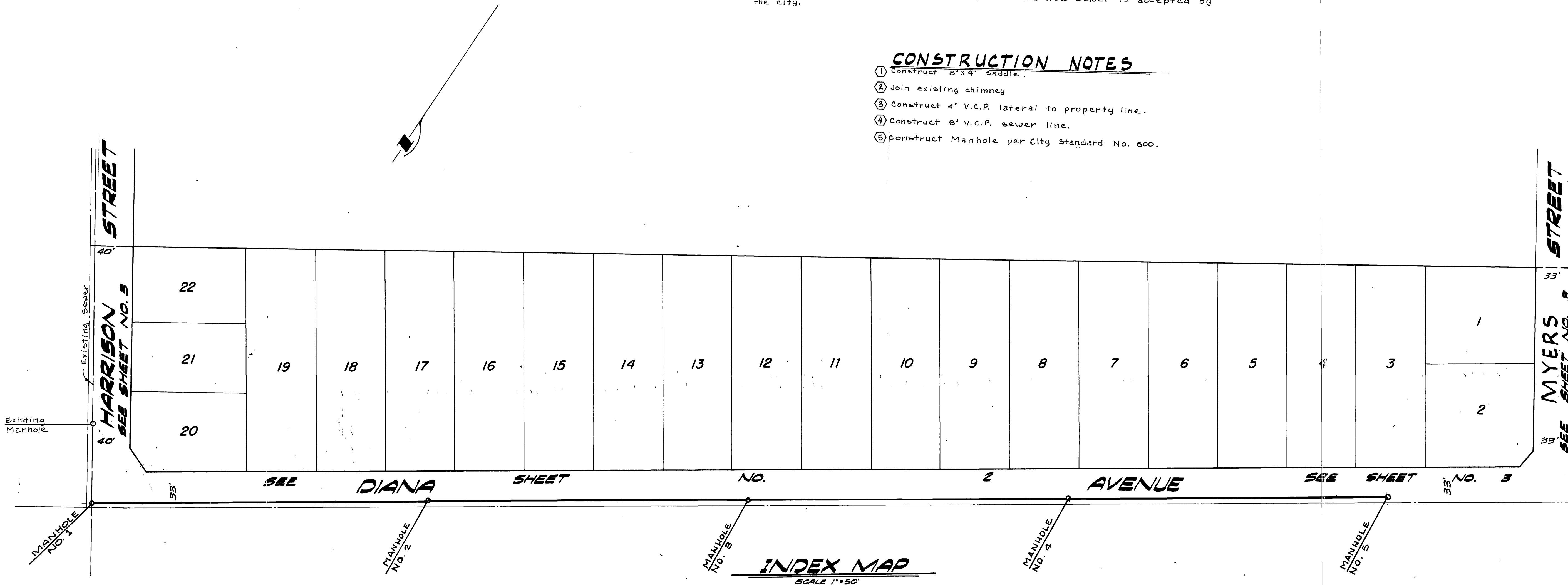

BENCH MARK:

0+35, at the intersection of Magnolia Avenue & Roosevelt Street, at the Arlington Branch of the Riverside Public Library, on the East side of the Main Entrance, about 1' above ground. A Std. disc stamped "0 35 1924". Elevation 782.349

*As built 11-26-76

Approved by: *Walter R. Hays*
Chief Utilities Engineer, Water Date: 3-24-77

KICAK WAINSCOTT & ASSOCIATES
CIVIL ENGINEERS
GRAND TERRACE, CALIFORNIA
APPROVED BY: *L. A. Waincott* DATE 2-3-77
R. C. E. 16056
W. Q. 015-01 FOR OWENS-KENNEDY, INC. F.B.

CITY OF RIVERSIDE, CALIFORNIA
DEPARTMENT OF PUBLIC WORKS
APPROVED BY: *[Signature]* BY DATE: 10-5-77
OFFICE ENGINEER
PARK DEPARTMENT
TRAFFIC DIVISION
ASSISTANT CITY ENGINEER
DESIGNED BY: *[Signature]* DRAWN BY: *[Signature]* CHECKED BY: *[Signature]*

INDEXED R.R. PROJECT NO. 5-1089
SEWER PLAN & PROFILE
TRACT NO. 8121
INDEX SHEET
SHEET 1 OF 3
FILE NO. 015-01-13
SCALE: AS SHOWN
DATE 10-5-77

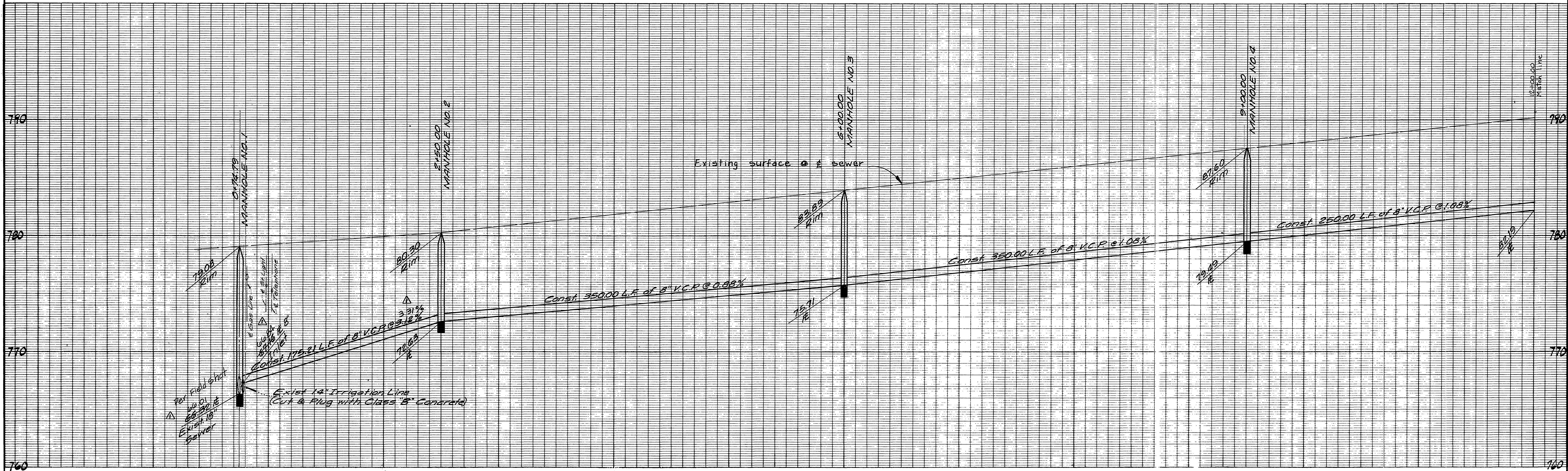

NOTE:
See Sheet No. 1 for General and Construction Notes.

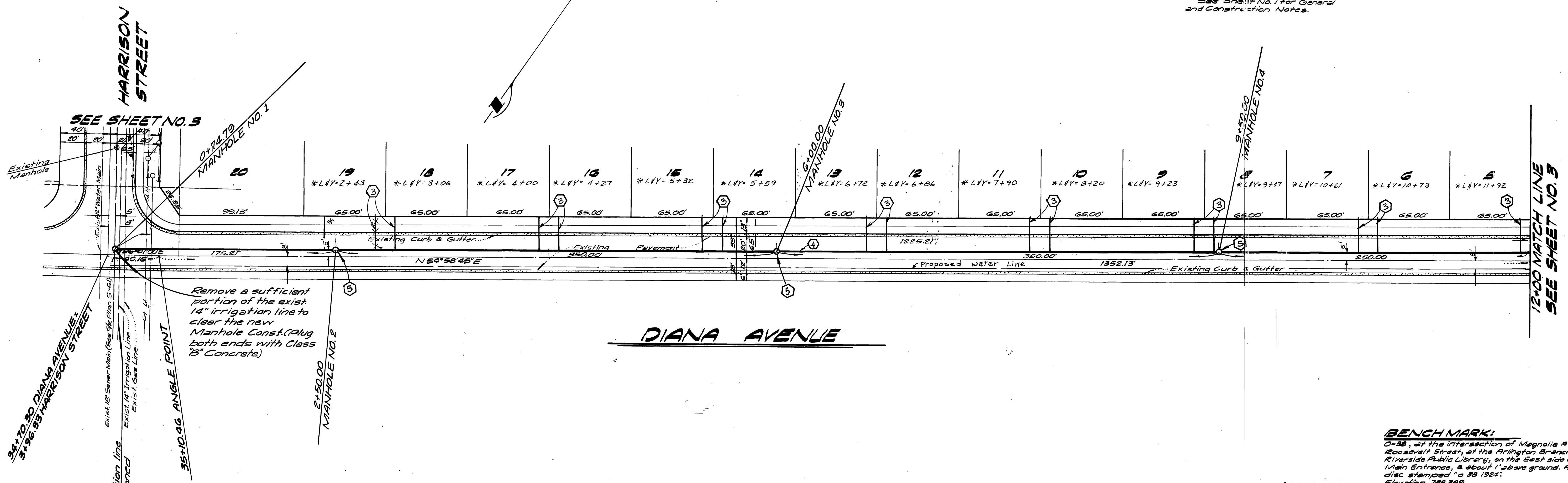

BENCH MARK:
0+35, at the intersection of Magnolia Avenue & Roosevelt Street, at the Arlington Branch of the Riverside Public Library, on the East side of the Main Entrance, & about 11 above ground. A Sta. disc stamped "C 38 1924". Elevation 788.349.

KICAK WAINSCOTT & ASSOCIATES
CIVIL ENGINEERS
GRAND TERRACE, CALIFORNIA

CITY OF RIVERSIDE, CALIFORNIA
DEPARTMENT OF PUBLIC WORKS

SEWER PLAN & PROFILE
TRACT NO. 8/21
DIANA AVENUE

PROJECT NO. _____
S-1089
SHEET 2 OF 3
FILE NO. 015-01-B

Approved by: *Wesley Lyden* 3-24-77
Chief Utilities Engineer, Water Date

APPROVED BY: *L.A. Waincott* DATE 2-3-77
R.C.E. 16052
W.O. 015-01 FOR OWENS-KENNEDY, INC. F.R.

DESIGNED BY: *R.H.* DRAWN BY: *R.H.* CHECKED BY: _____
DATE 10-5-77

APPROVED BY: *[Signature]*
DIRECTOR OF PUBLIC WORKS
DATE 10-5-77

SCALE: HORIZ. 1"=40' VERT. 1"=4'



NOTE:
See Sheet No. 1 for General and Construction Notes.

* Chimney stations were calculated from information obtained from City of Riverside Plan S-51.

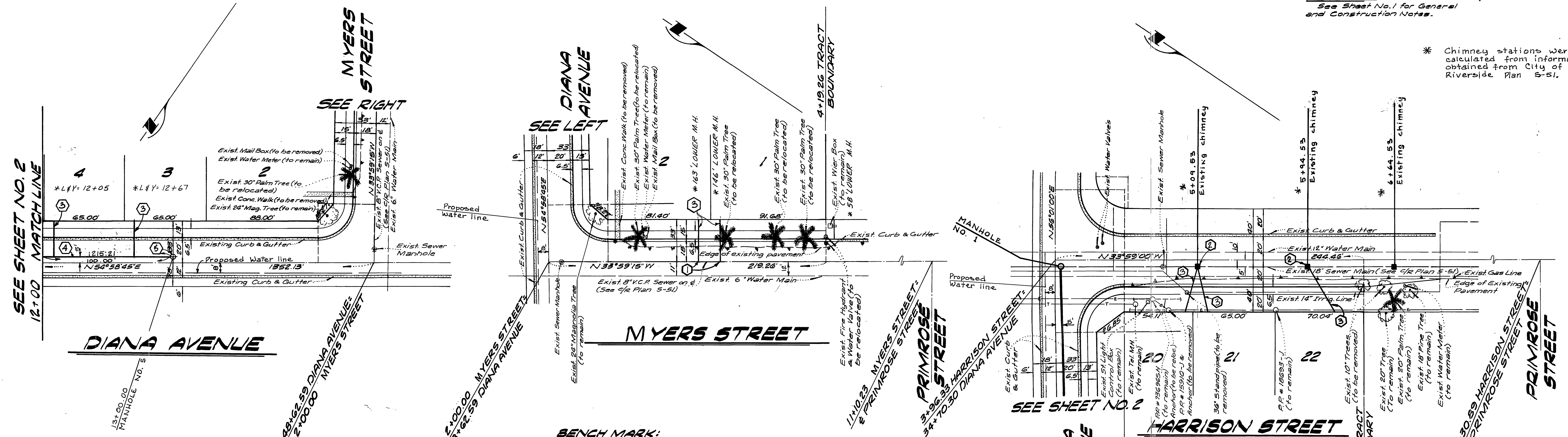

BENCH MARK:
D-38, at the intersection of Magnolia Avenue & Rosebush Street, at the Arlington Branch of the Riverside Public Library, on the East side of the Main Entrance, & about 1' above ground. A 5 1/2" disc stamped "o 38 1984". Elevation 788.349

KICAK WAINSCOTT & ASSOCIATES
CIVIL ENGINEERS
GRAND TERRACE, CALIFORNIA

APPROVED BY: *S.O. Waincott* DATE 2-3-77
R.C.E. 16056

Approved by: *Wesley J. Allen* 3-24-77
Chief Utilities Engineer, Water date.

CITY OF RIVERSIDE, CALIFORNIA
DEPARTMENT OF PUBLIC WORKS

APPROVED BY: *[Signature]* DATE 10-5-77
OFFICE ENGINEER
PARK DEPARTMENT
TRAFFIC DIVISION
ASSISTANT CITY ENGINEER

SEWER PLAN & PROFILE
TRACT NO. 8121
DIANA AVENUE - MYERS STREET - HARRISON STREET

SCALE: HORIZ. 1"=40' VERT. 1"=4'
DATE 10-5-77

INDEXED R/R
PROJECT NO. 5-1089
SHEET 3 OF 3
FILE NO. 015-01-B

DESIGNED BY: *R.H.* DRAWN BY: *R.H.* CHECKED BY: *[Signature]*