

BENCH MARK:
 PAINTED 1/4" I.F.T. EAST AND 1/4" NORTH OF PROPERTY
 CORNER AT SOUTHWEST CORNER OF TENTH AND MAIN
 STREETS. ELEV. 844.92. F.B. 1002/59

- CONSTRUCTION NOTES**
- CONSTRUCTION SHALL BE IN ACCORDANCE WITH STANDARD SPECIFICATIONS FOR PUBLIC WORKS CONSTRUCTION, 1976 EDITION.
 - FOR CURVED SEWER USE VCP, 2' LONG SECTIONS.

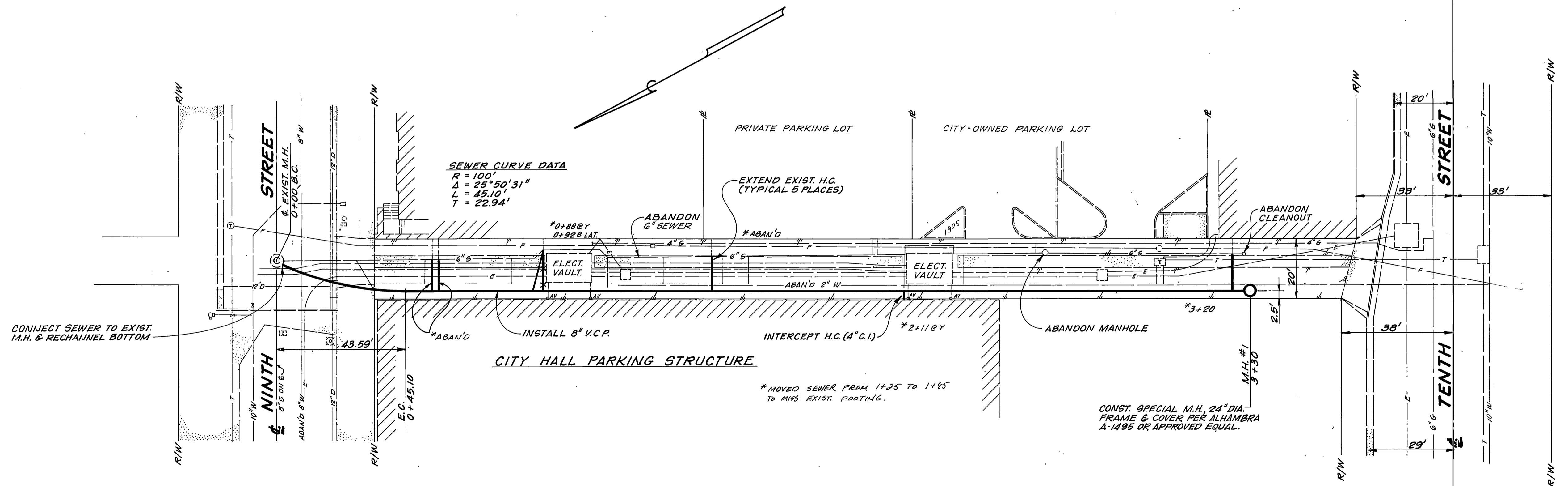

APPROVED BY: *Walter K. Hagan* 9-28-77
 CHIEF UTILITIES ENGINEER, WATER DATE

CITY OF RIVERSIDE
 PUBLIC WORKS DEPARTMENT

APPROVED BY: *[Signature]* DATE: 11-17-77
 PRINCIPAL ENGINEER
 PARK DEPARTMENT
 TRAFFIC DIVISION
 CHIEF P.W. ENGINEER

DESIGNED BY: *[Signature]* DRAWN BY: *[Signature]* CHECKED BY: *[Signature]*

*AS BUILT 8-78 KPT

ALLEY SEWER REPLACEMENT

FROM NINTH ST. TO TENTH ST.
 BETWEEN MAIN ST. & ORANGE ST.

HORIZ. SCALE: 1" = 20' VERT. SCALE: 1" = 2'

ACCOUNT NO. 32-571-590
S-1110
 SHEET 1 OF 1
 FILE NO.