

870

860

880

870

860

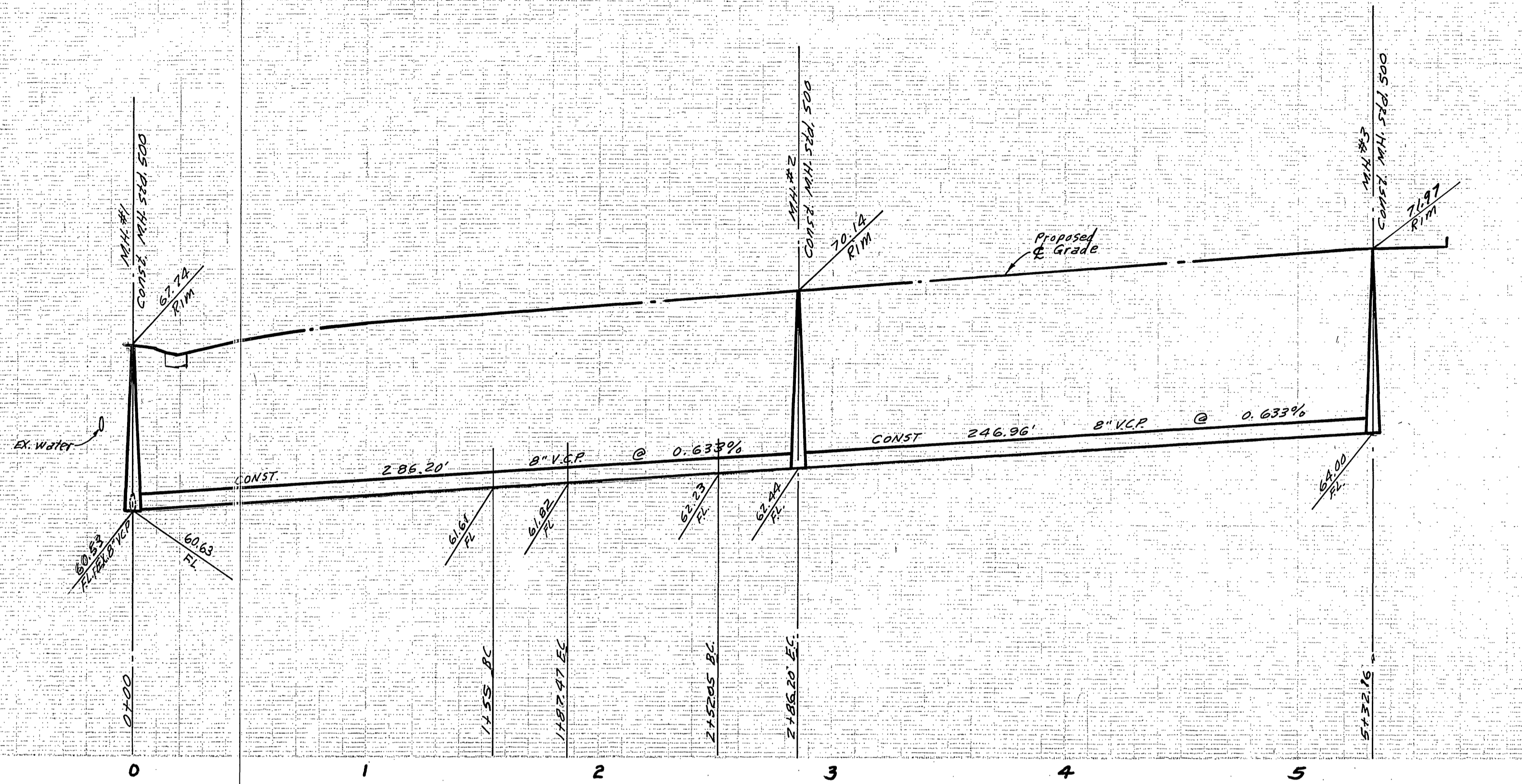

BENCH MARK: Elev. 845.599
 City B.M. F-5-H P.K. nail and top in Riv. Water Co. Canal Headwall, Wly side of Monroe St.

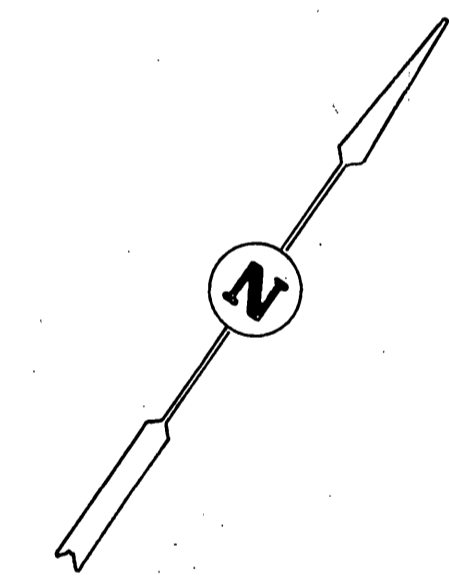
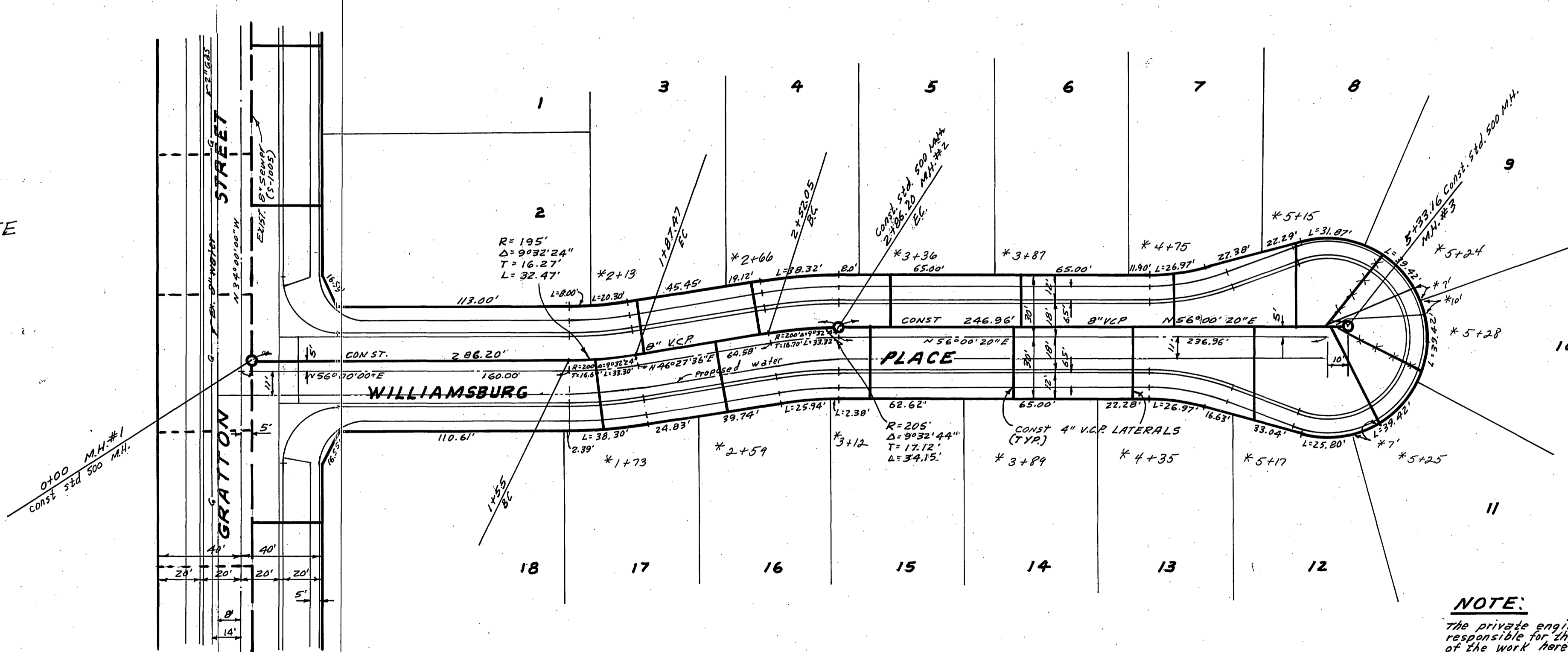
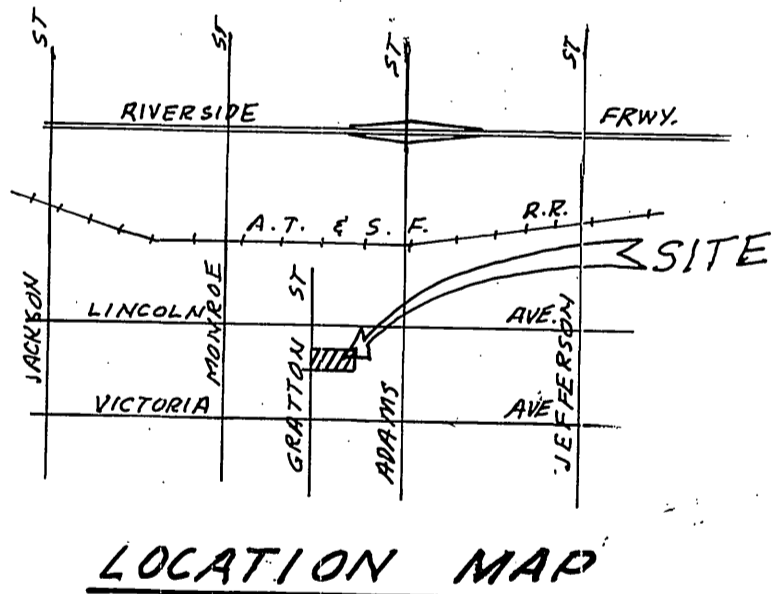

GENERAL NOTES:

1. Construction shall be in accordance with the standard specifications for Public Works Construction 1976 Edition, and the City of Riverside Standard Drawings.
2. It shall be the responsibility of the Contractor to clear the Right of Way in accordance with the provisions of law as it affects each utility including irrigation lines and appurtenances and at no cost to the City.
3. Pipe shall be bedded per Case 1, Standard Drawing No. 452, unless otherwise specified on the plans.
4. Location of wyes and laterals to be determined in the field at the direction of the owner.
5. All stubs and laterals to be constructed in accordance with standard Drawing No. 562 stubs shall be plugged and capped.
6. Manhole frames and covers to be set as noted in profiles by sewer contractor after final paving of streets.
7. Laterals are to be 4" VCP and extended to property line.
8. Prior to construction the sewer contractor is to expose the existing sewer and contact the Engineer for verification of existing location and elevation.
9. Plans shall be installed and will remain in place where the new sewer connects with the existing sewer until such time as the new sewer is accepted by the City.

NOTE:

The private engineer signing these plans is responsible for the accuracy and acceptability of the work shown. In the event of discrepancies arising during construction, the private engineer shall be responsible for determining an acceptable solution and revising the plans for approval by the City.

NOTICE TO CONTRACTOR

The existence and location of underground utility pipes or structures shown on these plans are obtained by a search of the available records. To the best of our knowledge there are no existing utilities except as shown on these plans. The contractor is required to take due precautionary measures to protect the utility lines shown and any other lines not of record or not shown on these plans.

ONE CONST.

*AS BUILT 8-78 MET

CITY OF RIVERSIDE DOMESTIC SYSTEM APPROVED BY: <i>[Signature]</i> 5/4/77 CHIEF UTILITIES ENGINEER, WATER DATE	ALBERT A. WEBB ASSOCIATES CIVIL ENGINEERS RIVERSIDE, CALIFORNIA APPROVED BY: <i>[Signature]</i> DATE 4/22/77 R.E. No. 9876		CITY OF RIVERSIDE, CALIFORNIA PUBLIC WORKS DEPARTMENT APPROVED BY: <i>[Signature]</i> DATE 5/16/77 CHIEF PUB. WKS. ENGR.		SEWER PLAN AND PROFILE WILLIAMSBURG PLACE TRACT NO. 8726 SCALE: 1" = 40' Horiz. - 1" = 4' Vert.	INDEXED R.R. ACCOUNT No. DRAWING NUMBER S-1122 SHEET 1 OF 1 76-339-B
	W.O.76-339 FOR Andrews Dev. Co. F.B. 1034 DESIGNED BY BEL DRAWN BY BEL CHECKED BY			DATE 5/16/77		