

PICKER STREET

CONSTRUCTION NOTES

1. CONSTRUCTION SHALL BE IN ACCORDANCE WITH STANDARD SPECIFICATIONS FOR PUBLIC WORKS CONSTRUCTION, 1976 EDITION AND CITY OF RIVERSIDE STD. DWGS.
2. EXTEND EXIST. H.C. AND CONNECT TO EXIST. 12" SEWER.
3. ABANDON M.H. PER STANDARD SPECIFICATIONS.
4. HC INDICATES LOCATION OF EXISTING HC HAS BEEN REPORTED BY THE PROPERTY OWNER. LOCATION OF OTHER HC'S ARE UNKNOWN. ALL HC'S MUST BE LOCATED BY THE CONTRACTOR.
5. REPLACE JUNCTION BY INSTALLING NEW SECTION OF 12" PIPE.
- 500 CONST. MANHOLE PER STD. DWG. NO. 500.

CITY OF RIVERSIDE PUBLIC WORKS DEPARTMENT		PICKER - PHILBIN SEWER REPLACEMENT		ACCOUNT NO. 32-577-509
APPROVED BY PRINCIPAL ENGINEER PARK DEPARTMENT TRAFFIC DIVISION CHIEF P. W. ENGINEER		APPROVED BY PUBLIC WORKS DIRECTOR		SHEET 1 OF 2
DESIGNED BY: <i>low</i> DRAWN BY: <i>KBT</i> CHECKED BY:		DATE: 5/9/79		FILE NO.
		* OS BUILT 4/4/80 first		INDEXED R/K
		HORIZ. SCALE: 1" = 40' VERT. SCALE: 1" = 2'		



735

730

725

735

730

725

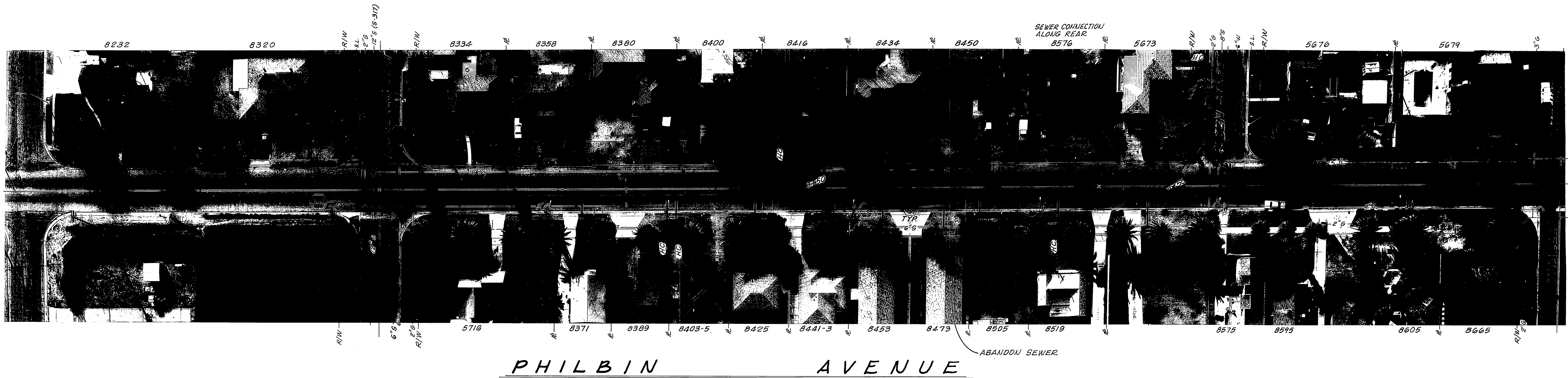
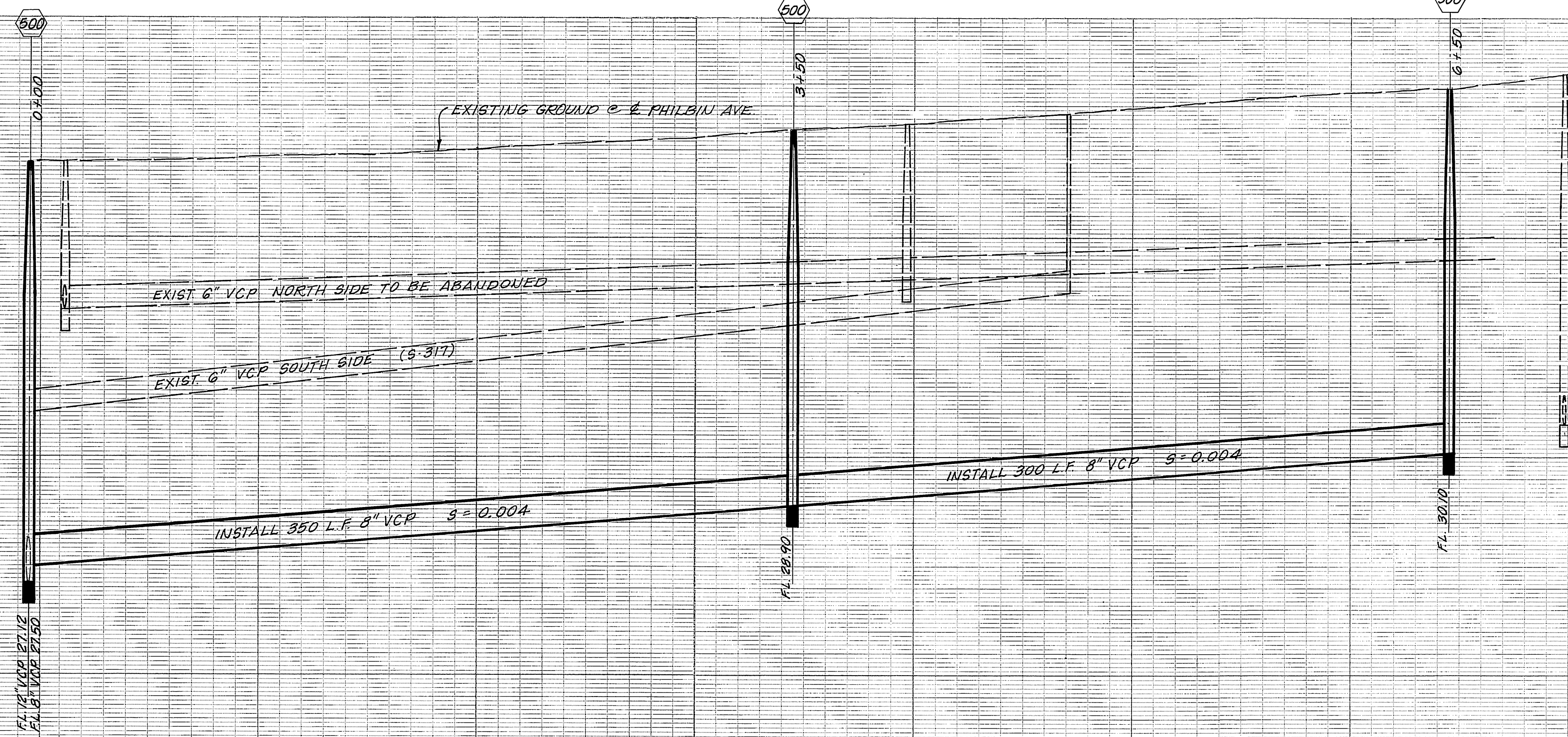

CITY OF RIVERSIDE PUBLIC WORKS DEPARTMENT		PICKER - PHILBIN SEWER REPLACEMENT		ACCOUNT NO. 32-577-509 <b>S-1198</b>
APPROVED BY PRINCIPAL ENGINEER PARK DEPARTMENT TRAFFIC DIVISION CHIEF P. W. ENGINEER		APPROVED BY  PUBLIC WORKS DIRECTOR		SHEET 2 OF 2
MARK DESIGNED BY DRAWN BY <i>KBT</i> CHECKED BY	REVISIONS APPR. DATE DATE <i>5/9/79</i>	HORIZ. SCALE: 1" = 40' VERT. SCALE: 1" = 2'	FILE NO.	