

800

790

780

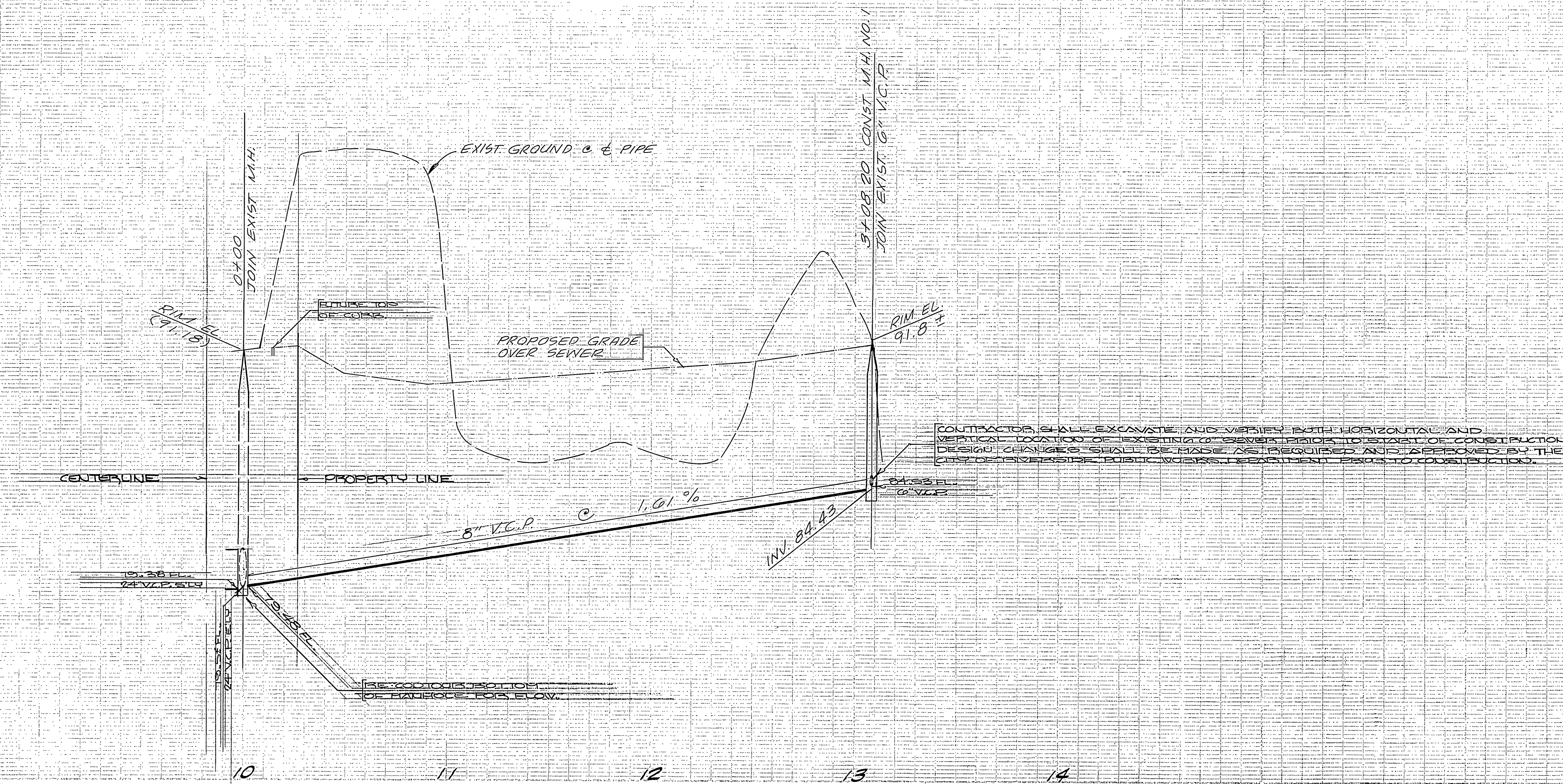

NOTE
 CONTRACTOR TO VERIFY LOCATION AND ELEVATION OF EXISTING MANHOLE PRIOR TO CONSTRUCTION

353/80

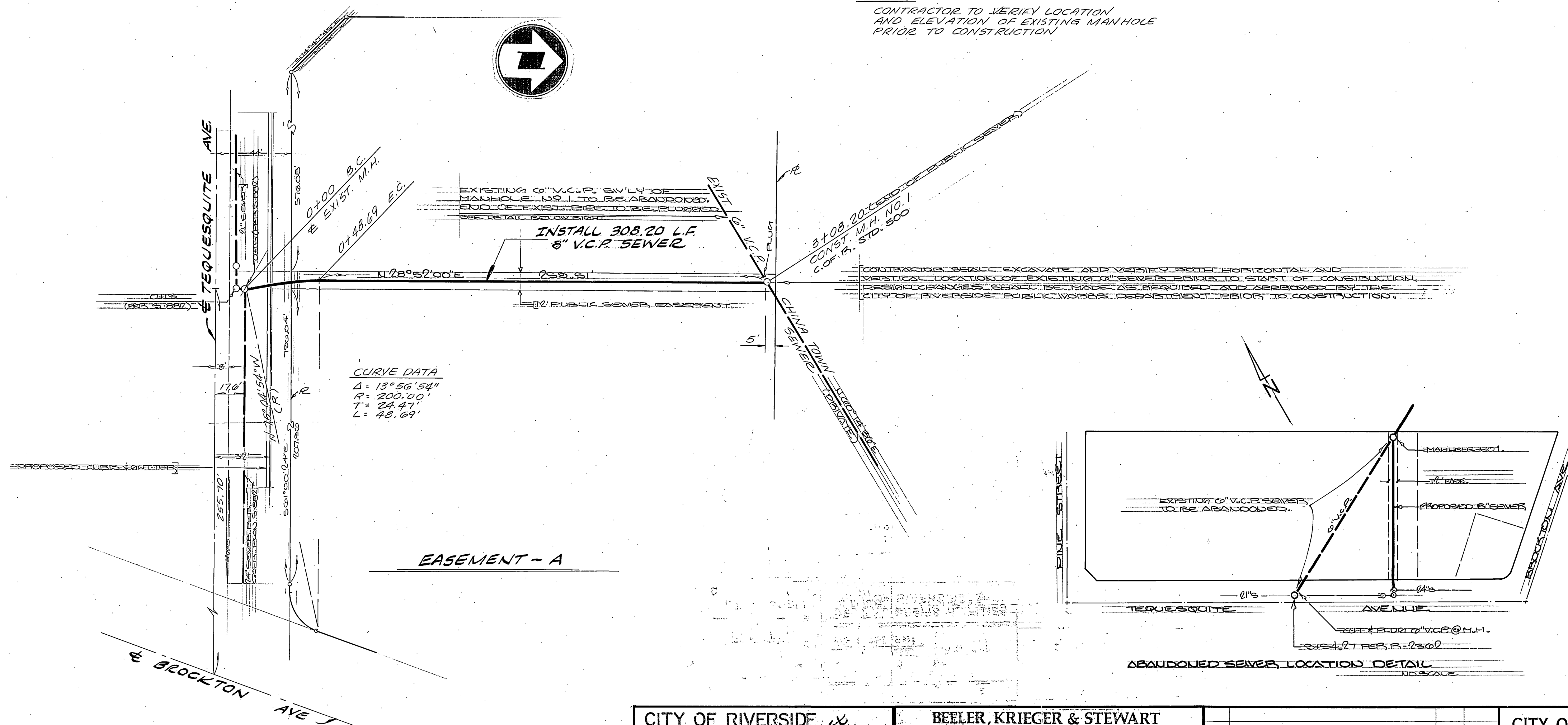

GENERAL NOTES

- CONSTRUCTION SHALL BE IN ACCORDANCE WITH THE CITY OF RIVERSIDE, DEPARTMENT OF PUBLIC WORKS, STANDARD DRAWINGS AND THE STANDARD SPECIFICATIONS FOR PUBLIC WORKS CONSTRUCTION, 1979 EDITION.
- THE PRIVATE ENGINEER SIGNING THESE PLANS IS RESPONSIBLE FOR ASSURING THE ACCURACY AND ACCEPTABILITY OF THE WORK HEREON. IN THE EVENT OF DISCREPANCIES ARISING DURING CONSTRUCTION AS A RESULT OF ERRORS OR OMISSIONS, THE PRIVATE ENGINEER SHALL BE RESPONSIBLE FOR DETERMINING AN ACCEPTABLE SOLUTION AND REVISING THE PLANS FOR APPROVAL BY THE CITY.
- LOCATION OF LATERALS TO BE DETERMINED IN THE FIELD AT THE DIRECTION OF THE OWNER. AVOID CONFLICT WITH PROPOSED AND/OR EXISTING FACILITIES.
- CONTRACTOR IS TO VERIFY EXISTING SEWER ELEVATION PRIOR TO CONSTRUCTION.
- A PLUG SHALL BE INSTALLED AND WILL REMAIN IN PLACE WHERE THE NEW SEWER CONNECTS WITH THE EXISTING SEWER UNTIL THE NEW SEWER IS ACCEPTED BY THE CITY.
- THE SEWER CONTRACTOR SHALL ADJUST MANHOLES TO FINAL GRADE AFTER PAVING IS COMPLETED.
- IT SHALL BE THE RESPONSIBILITY OF THE CONTRACTOR TO CLEAR THE RIGHT OF WAY IN ACCORDANCE WITH THE PROVISIONS OF LAW AS IT AFFECTS EACH UTILITY INCLUDING IRRIGATION LINES AND APPURTENANCES AND AT NO COST TO THE CITY.
- QUANTITIES SHOWN ARE FOR INFORMATION ONLY AND THE CITY OF RIVERSIDE IS NOT RESPONSIBLE FOR THEIR ACCURACY.
- A PLUG SHALL BE INSTALLED AND WILL REMAIN IN PLACE WHERE THE NEW SEWER CONNECTS WITH THE EXISTING SEWER UNTIL THE NEW SEWER IS ACCEPTED BY THE CITY.

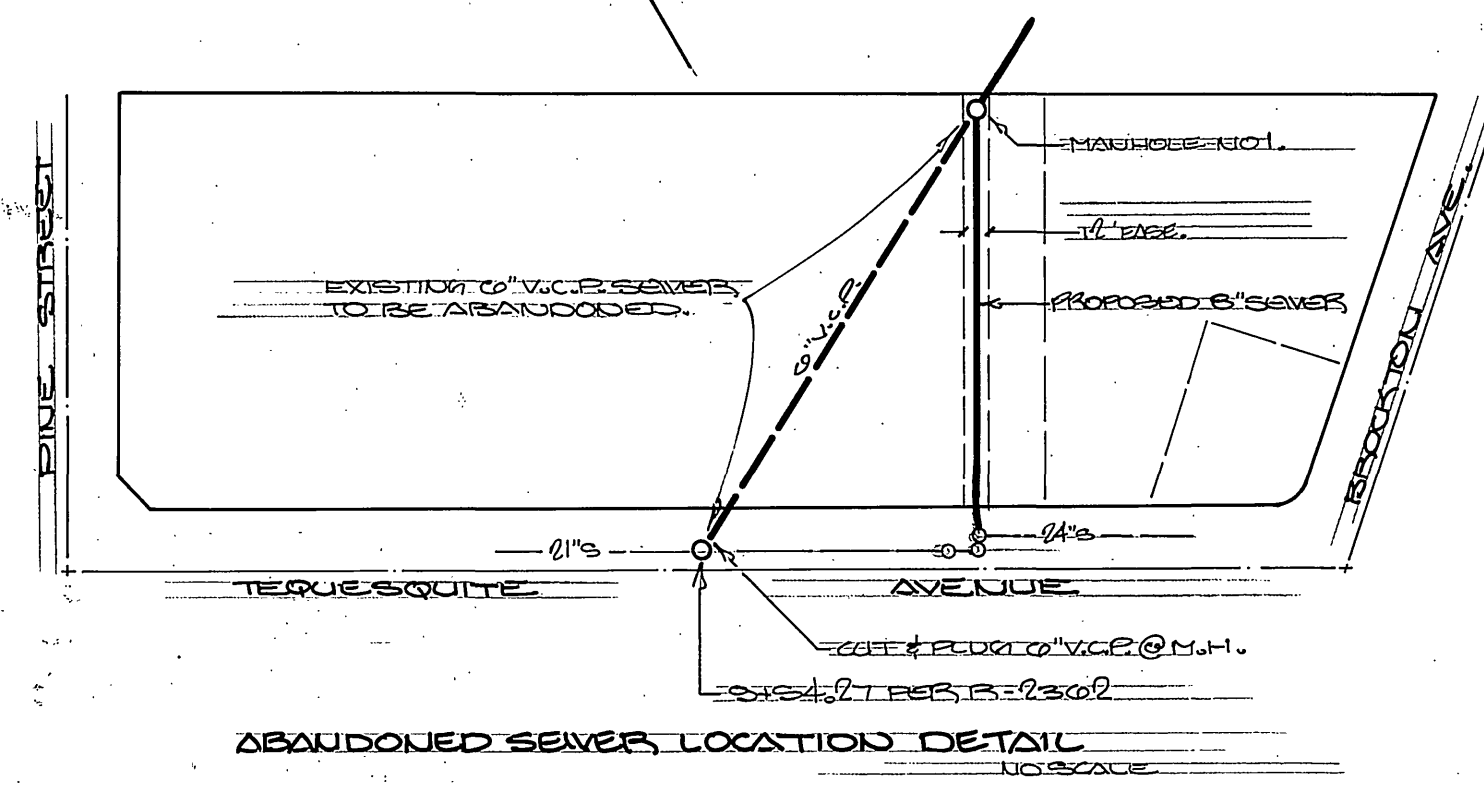

BENCH MARK 10-C
 BRASS DISC DN. 9" AT INTERSECTION OF
 PINE AVE & BROCKTON AVE
 ELEV. 773.83 INDEXED 810

SO. CALIFORNIA GAS CO.
 BY: *OR McHanna* 3/3/81
 DATE

CITY OF RIVERSIDE
 DOMESTIC WATER SYSTEM
 APPROVED BY: *And Law* 3/17/81
 WATER SYSTEMS MANAGER DATE

BEELE, KRIEGER & STEWART
 LAND SURVEYORS - CIVIL ENGINEERS
 3602 UNIVERSITY AVE., SUITE 201
 RIVERSIDE, CALIFORNIA 92501
 (714) 684-6900
 APPROVED BY: *Mark E. Messinger* 3-2-81
 REGISTERED ENGINEER NO. C22020 DATE

MARK	REVISIONS	APPR.	DATE

CITY OF RIVERSIDE, CALIFORNIA
 DEPARTMENT OF PUBLIC WORKS
 APPROVED BY: *William D. Gordon*
 DIRECTOR OF PUBLIC WORKS
 DATE: 4/24/81

SEWER PLAN & PROFILE
 OLD CHINA TOWN SEWER RELOCATION
 (A PORTION ONLY) "A"
 EASEMENT "A"
 TEQUESQUITE ST. BETWEEN
 PINE AVE & BROCKTON AVE.
 HORIZ. SCALE: 1" = 40' VERT. SCALE: 1" = 4'

PROJECT NO.
S-1271
 SHEET 1 OF 1
 FILE NO. 148-11