

PROFILE SCALES
 HORIZ: 1" = 20'
 VERT: 1" = 2'

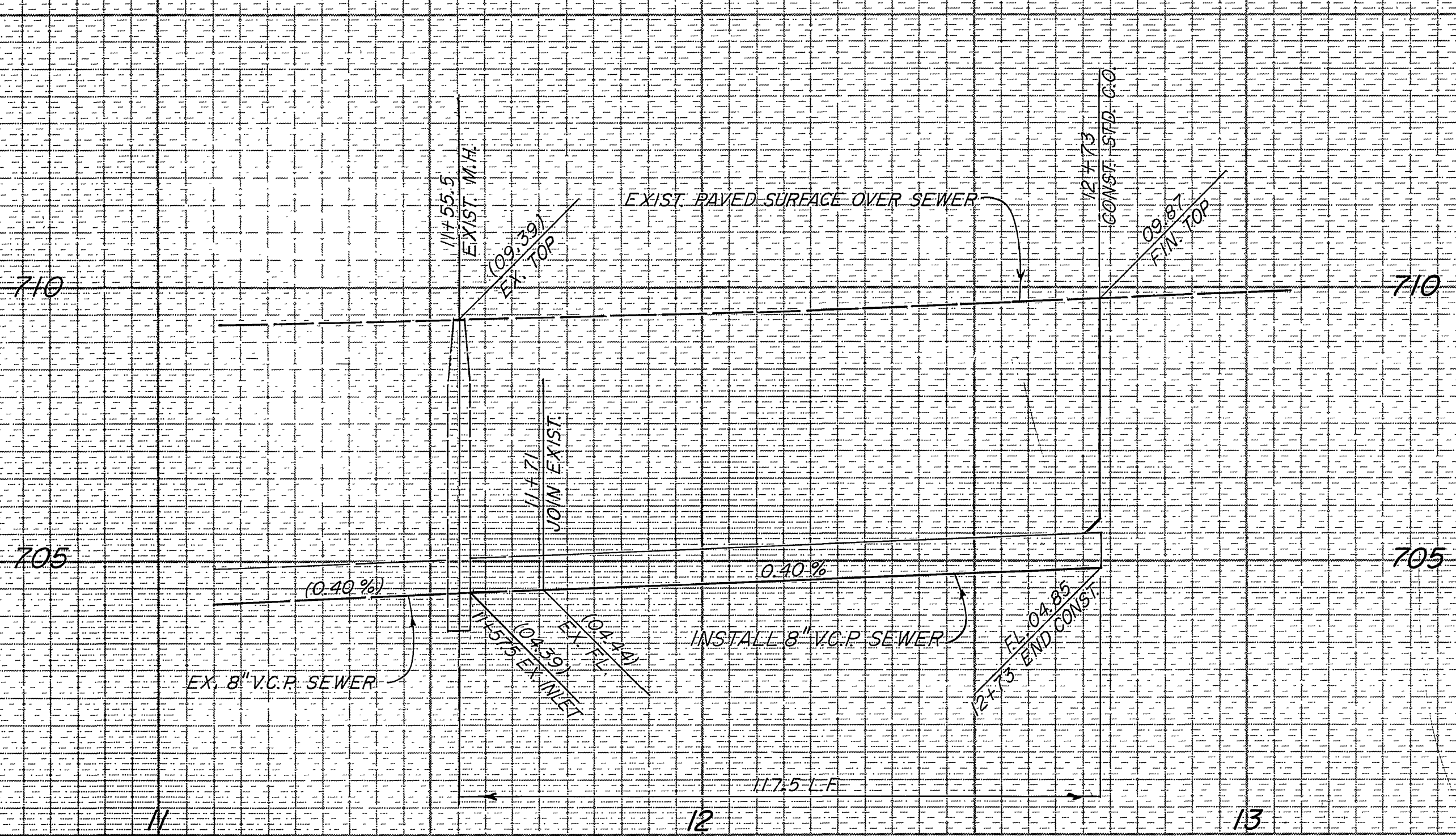

QUANTITY ESTIMATE

1. 116 L.F. 8" V.C.P. SEWER
2. 1 EA. 8" CLEANOUT
3. 1 EA. 8" X 4" WYE
4. 38 L.F. 6" V.C.P. LATERAL
5. LUMP SUM - EXCAVATION AND BACKFILLING
6. 630 S.F. PAVEMENT REMOVAL

BENCH MARK

R.K. NAIL AND WASHER TAGGED RIVERSIDE CITY ENGINEER
 IN TOP OF CURB OF THE WESTERLY CURB RETURN AT
 LA SIERRA AVENUE AND MAGNOLIA AVENUE.
 ELEV. 711.197

GENERAL NOTES

1. IT SHALL BE THE RESPONSIBILITY OF THE CONTRACTOR TO CLEAR THE RIGHT OF WAY IN ACCORDANCE WITH THE PROVISIONS OF LAW AS IT AFFECTS EACH UTILITY INCLUDING IRRIGATION LINES AND APPURTENANCES AND AT NO COST TO THE CITY.
2. CONSTRUCTION SHALL BE IN ACCORDANCE WITH THE CITY OF RIVERSIDE DEPARTMENT OF PUBLIC WORKS, STANDARD DRAWINGS, AND THE STANDARD SPECIFICATIONS FOR PUBLIC WORKS CONSTRUCTION, 1979 EDITION.
3. ALL FLAGGED ELEVATIONS SHALL BE STAKED IN THE FIELD BY THE PRIVATE ENGINEER.
4. LOCATION OF LATERALS OR WYES TO BE DETERMINED IN THE FIELD AT THE DIRECTION OF THE OWNER. AVOID CONFLICT WITH PROPOSED AND/OR EXISTING FACILITIES.
5. CONTRACTOR SHALL VERIFY EXISTING SEWER ELEVATION PRIOR TO CONSTRUCTION.
6. QUANTITIES SHOWN ARE FOR INFORMATION ONLY AND THE CITY OF RIVERSIDE IS NOT RESPONSIBLE FOR THEIR ACCURACY.
7. ANY TRAFFIC CONTROL STRIPING OBLITERATED DURING CONSTRUCTION SHALL BE RESTORED BY THE CONTRACTOR WITHIN FIVE DAYS AFTER NOTIFICATION FROM THE CITY INSPECTORS.
8. THE SEWER CONTRACTOR SHALL ADJUST MANHOLES AND/OR CLEANOUTS TO FINAL GRADE AFTER PAVING IS COMPLETED.
9. A PLUG SHALL BE INSTALLED AND REMAIN IN PLACE WHERE THE NEW SEWER CONNECTS WITH THE EXISTING SEWER UNTIL THE NEW SEWER IS ACCEPTED BY THE CITY.
10. THE PRIVATE ENGINEER SIGNING THIS PLAN IS RESPONSIBLE FOR ASSURING THE ACCURACY AND ACCEPTABILITY OF THE WORK HEREON. IN THE EVENT OF DISCREPANCIES ARISING DURING CONSTRUCTION AS A RESULT OF ERRORS OR OMISSIONS, THE PRIVATE ENGINEER SHALL BE RESPONSIBLE FOR DETERMINING AN ACCEPTABLE SOLUTION AND REVISING THE PLANS FOR APPROVAL BY THE CITY.
11. WHERE GROUND WATER IS ENCOUNTERED IN THE TRENCH THE CONTRACTOR SHALL, AT THE DIRECTION OF THE ENGINEER, EXCAVATE TO A DEPTH OF 6" BELOW THE PROPOSED PIPE AND PLACE A BEDDING OF 3/4" CRUSHED ROCK OR CRUSHED SLAG.
12. SEWER/WATER LINE ENCASUREMENT SHALL CONFORM TO CITY WATER DIVISION STANDARDS CWD-022 AND CWD-023.

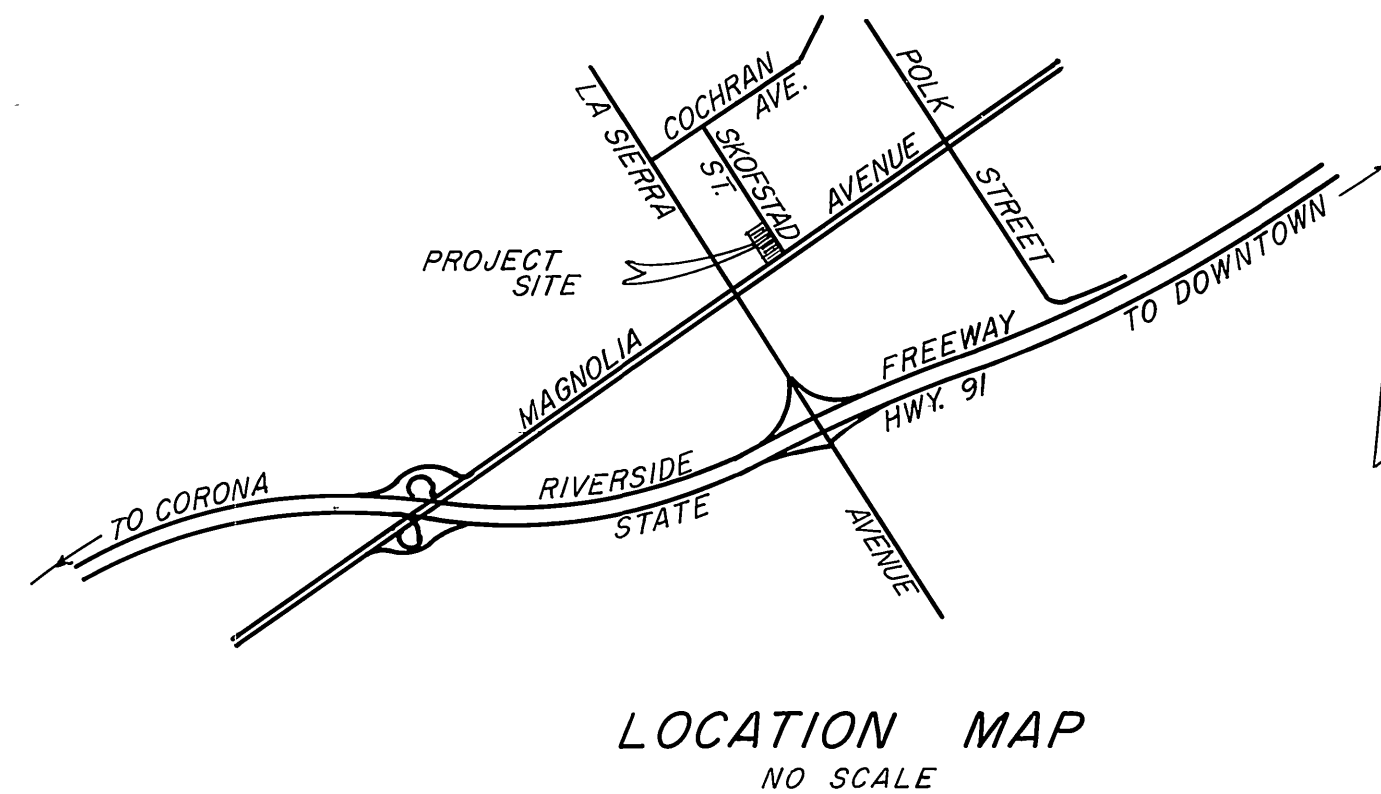
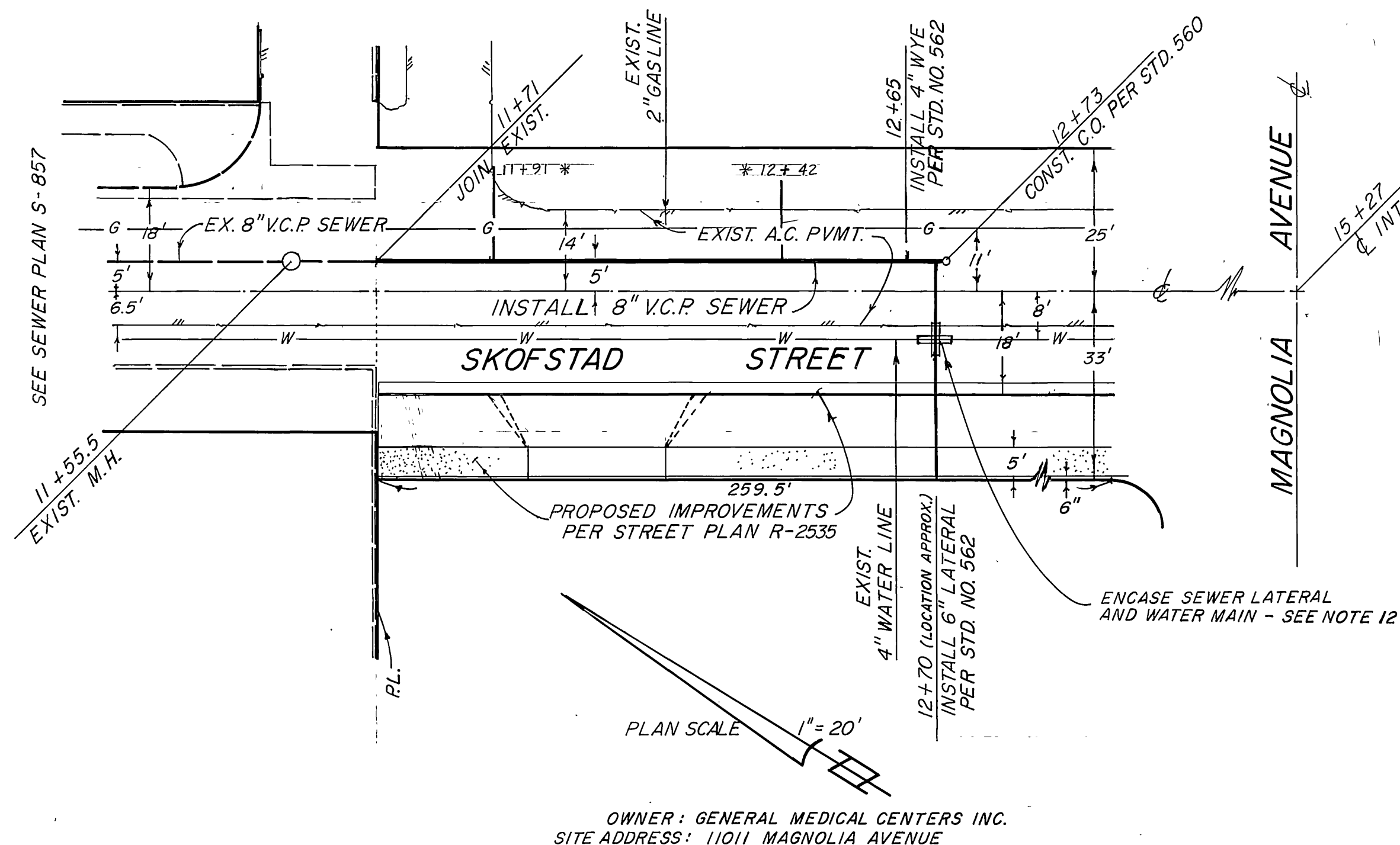

OWNER: GENERAL MEDICAL CENTERS INC.
 SITE ADDRESS: 11011 MAGNOLIA AVENUE

CITY OF RIVERSIDE DOMESTIC SYSTEMS	BYRON B. JOHNSON JR. AND PHIL K. MOSLEY CIVIL ENGINEERING AND SURVEYING 1033 E. ROSEWOOD CT., ONTARIO, CA. 91764 TEL. (714) 984-4702 OR 986-3916	CITY OF RIVERSIDE, CALIFORNIA PUBLIC WORKS DEPARTMENT		SEWER PLAN AND PROFILE		ACCOUNT No.
		APPROVED BY: [Signature] DATE: 1/9/84		IN: SKOFSTAD STREET N'WLY OF MAGNOLIA AVENUE FROM STA. 11+71 TO 12+73 (BUILDING PERMIT FOR 11011 MAGNOLIA AVE.)		DRAWING NUMBER S-1327
CHIEF UTIL. ENGR., WATER	DATE: 9-21-83	DESIGNED BY: P.K.M.	DRAWN BY: T.C.M.	CHECKED BY: B.B.J.	SCALE: HORIZ: 1" = 20' VERT: 1" = 2'	SHEET: 1 OF 1