

PROJECT LOCATION MAP

GENERAL NOTES

- CONSTRUCTION SHALL BE IN ACCORDANCE WITH THE CITY OF RIVERSIDE STD DRAWINGS & STD SPECIFICATIONS FOR PUBLIC WORKS CONSTRUCTION, 1985 EDITION.
- TRENCH RESURFACING STRUCTURAL SECTION SHALL BE 0.38' A.C. OVER 1.15' BASE MATERIAL.
- EXIST UTILITIES & OTHER UNDERGROUND FACILITIES ARE NOT SHOWN ON THE NORTHERLY HALF OF MAGNOLIA AVE WITHIN THE PROJECT LIMITS.
- TRAFFIC SIGNAL DETECTOR LOOPS SHALL BE INSTALLED IN THE PRESENCE OF THE TRAFFIC ENGINEER OR HIS REPRESENTATIVE.
- STEPS SHALL BE INSTALLED ON THE SE'LY OR THE NW'LY SIDE OF SEWER M.H. EXCEPT AS OTHERWISE SHOWN ON THE PLAN.

CONSTRUCTION NOTES

- NUMBERS IN HEXAGON ON THE PLAN REFER TO THE RESPECTIVE STANDARD DRAWING AND SHALL BE CONSTRUCTED ACCORDINGLY, UNLESS MODIFICATIONS ARE NOTED ON THE PLAN. ANY NUMBER BELOW THE STANDARD DRAWING INDICATES THE SPECIFIC ALTERNATE TO BE CONSTRUCTED.
 - REMOVE & REPLACE CURB PER STD. DWG. NO. 200, TYPE II.
 - REMOVE & REPLACE CURB & GUTTER PER STD. DWG. NO. 200, TYPE I.
 - CONSTRUCT SEWER M.H. PER STD. 500 EXCEPT BOTTOM PORTION OF M.H. SHALL BE 5' DIA.
 - PAVEMENT MARKINGS SHALL INCLUDE CROSSWALKS, BIKE LANE STENCILS AND BIKE SYMBOL. REPLACEMENT OF PAVING MARKINGS, DETERMINED IN THE FIELD BY THE ENGINEER.
- NOTE:
- INDICATES LOCATION OF TEST HOLES AT THE VICINITY OF STA. 91+64, 70' RT., SHT. 2 & STA. 107+00, 65' RT., SHT. 3.

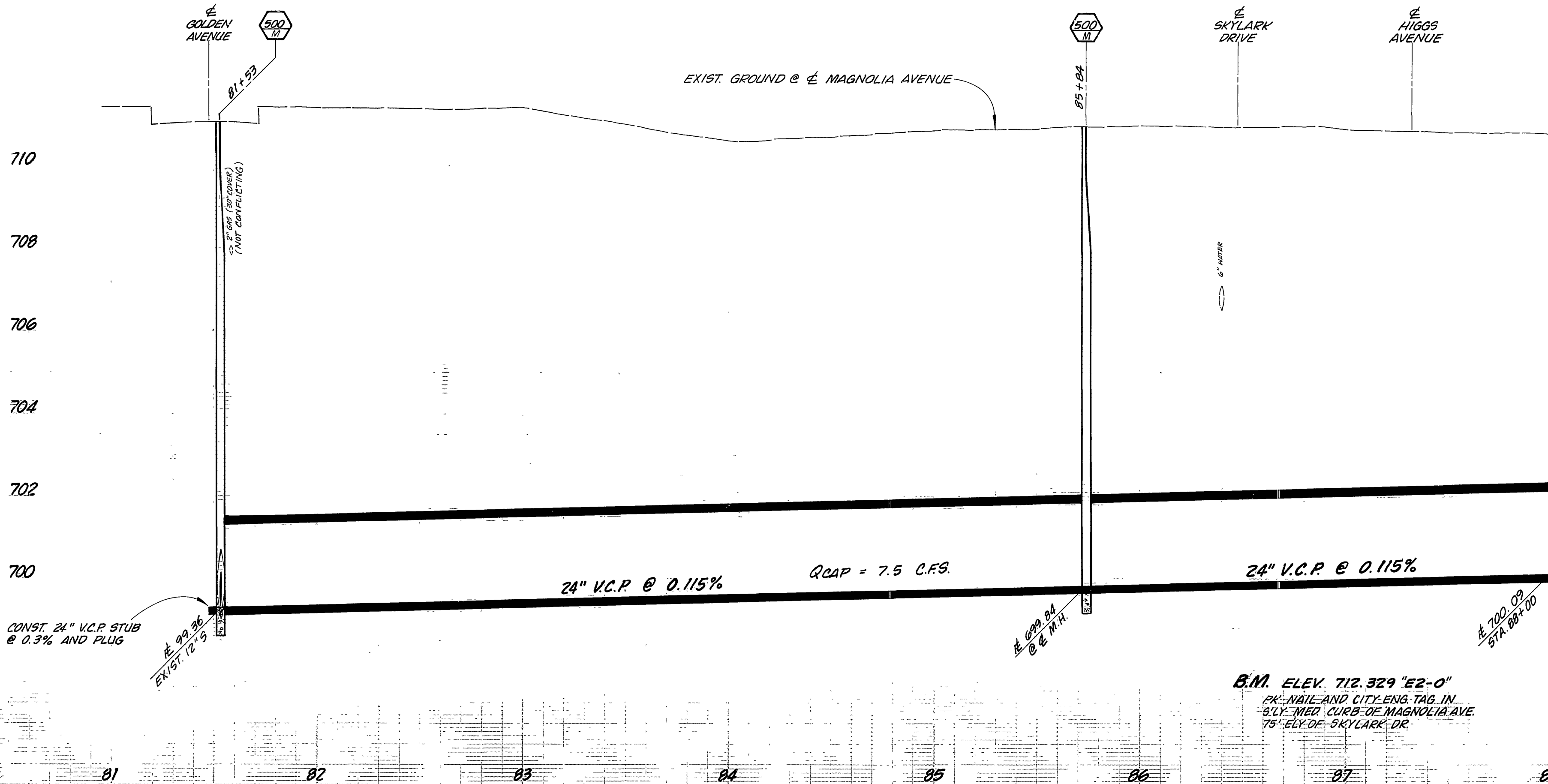

NOTE:
CONTRACTOR SHALL PROTECT EXIST. 24" FORCE MAIN AT MEDIAN ISLAND WITHIN THE CONSTRUCTION AREA. DEPTH VARIES 2' TO 4' ON THIS SHEET.

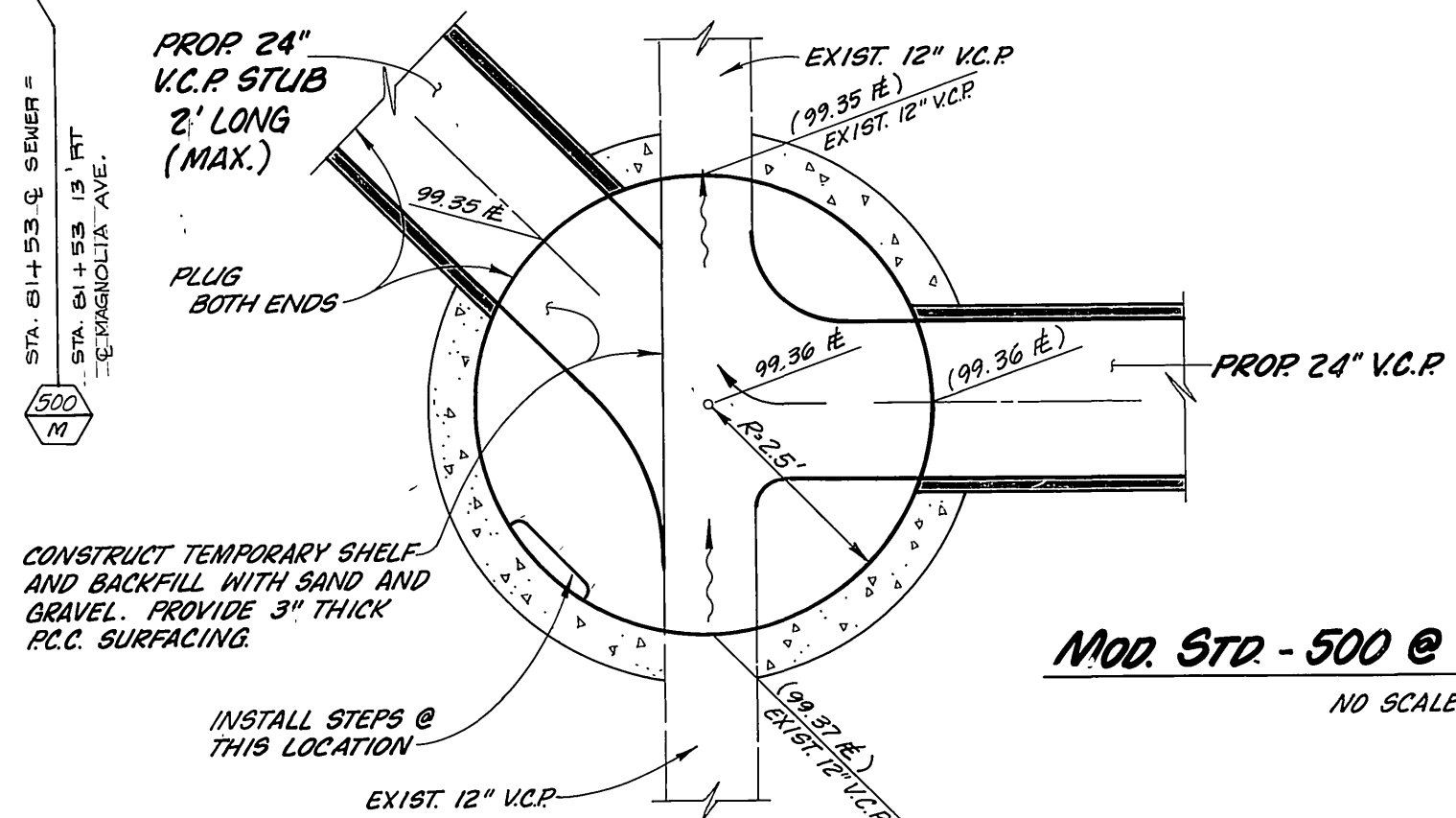
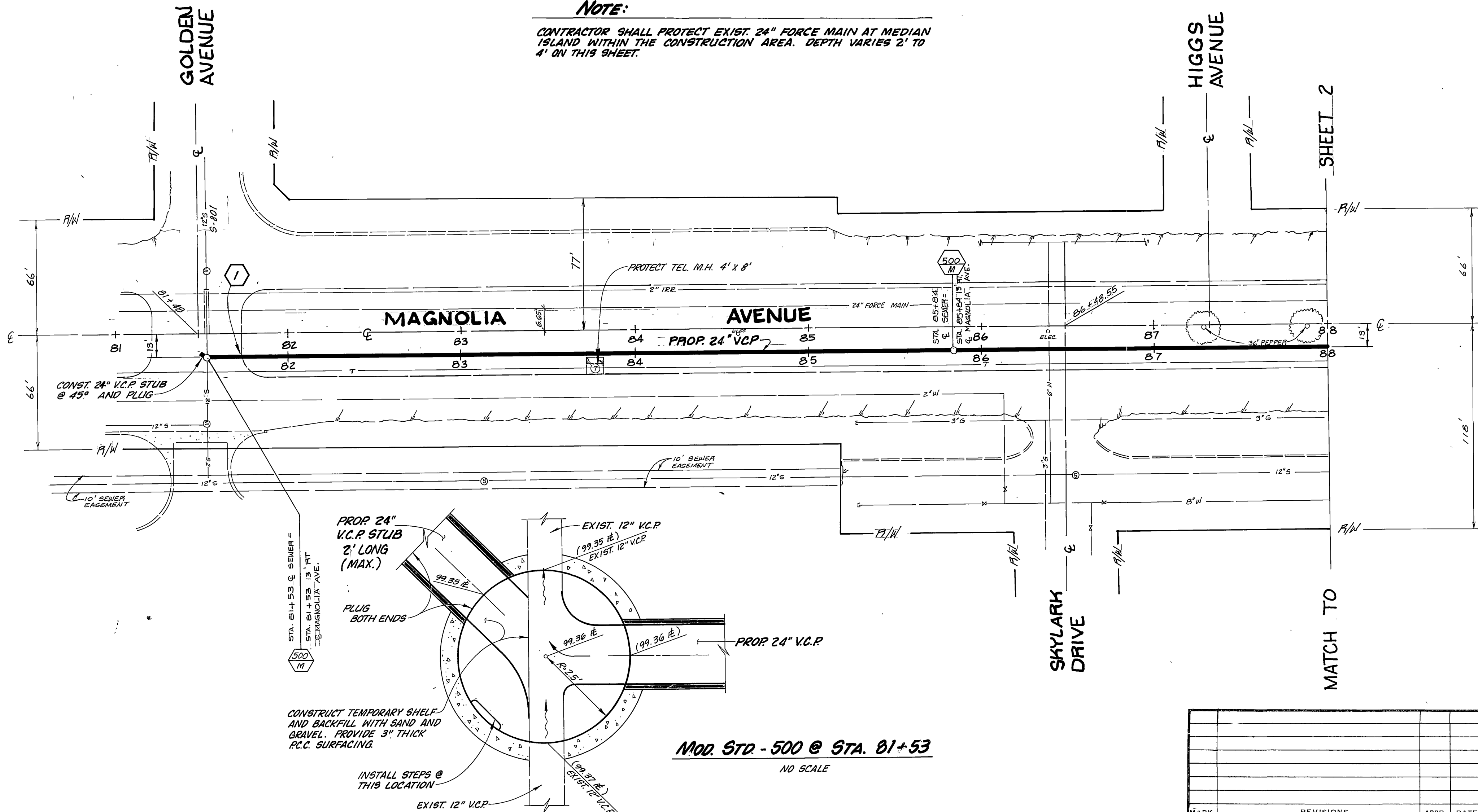

MOD. STD - 500 @ STA. 81+53
NO SCALE

CITY OF RIVERSIDE PUBLIC WORKS DEPARTMENT		MAGNOLIA AVENUE RELIEF SEWER FROM GOLDEN TO JONES		ACCOUNT NO. 32-577-565
APPROVED BY PRINCIPAL ENGINEER TANK DEPARTMENT TRAFFIC DIVISION CHIEF P.W. ENGINEER PUBLIC WORKS DIVISION	DATE 8-24-85	APPROVED BY PUBLIC WORKS DIRECTOR William D. Gardner	DATE 8-30-85	INDEXED 9-18-87
DESIGNED BY DRAWN BY CHECKED BY	REVISIONS APPR. DATE	DATE 8-30-85	HORIZ. SCALE: 1" = 40' VERT. SCALE: 1" = 2'	SHEET 1 OF 4

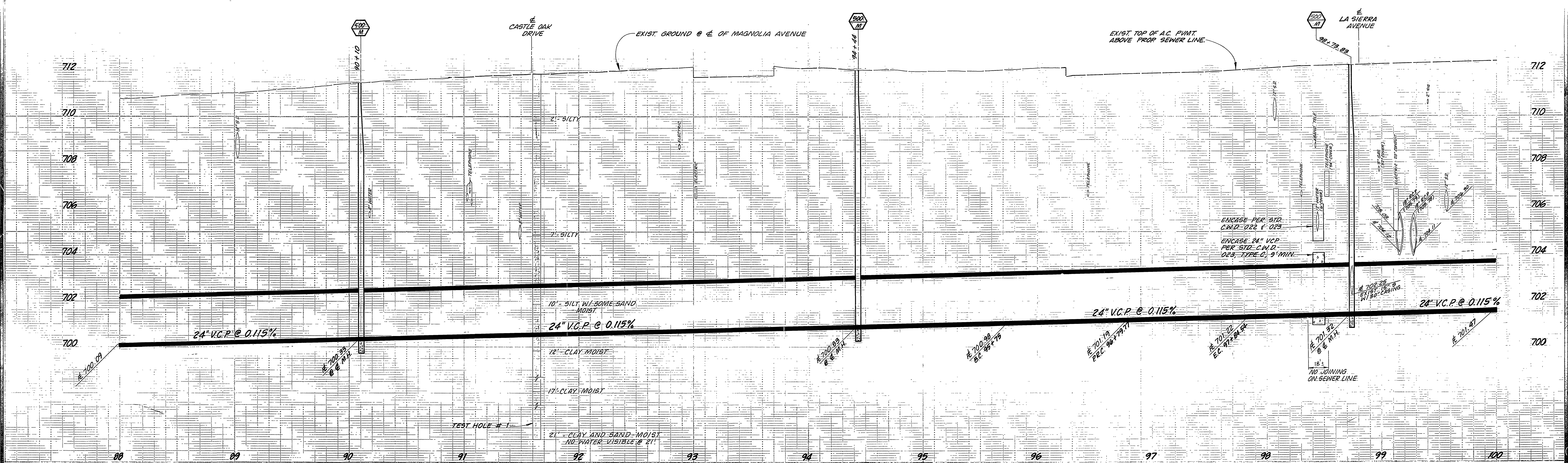

NOTE:
 CONTRACTOR SHALL PROTECT EXISTING 24" FORCE MAIN AT MEDIAN ISLAND WITHIN THE CONSTRUCTION AREA. DEPTH VARIES 1.5' TO 2.0' ON THIS SHEET.

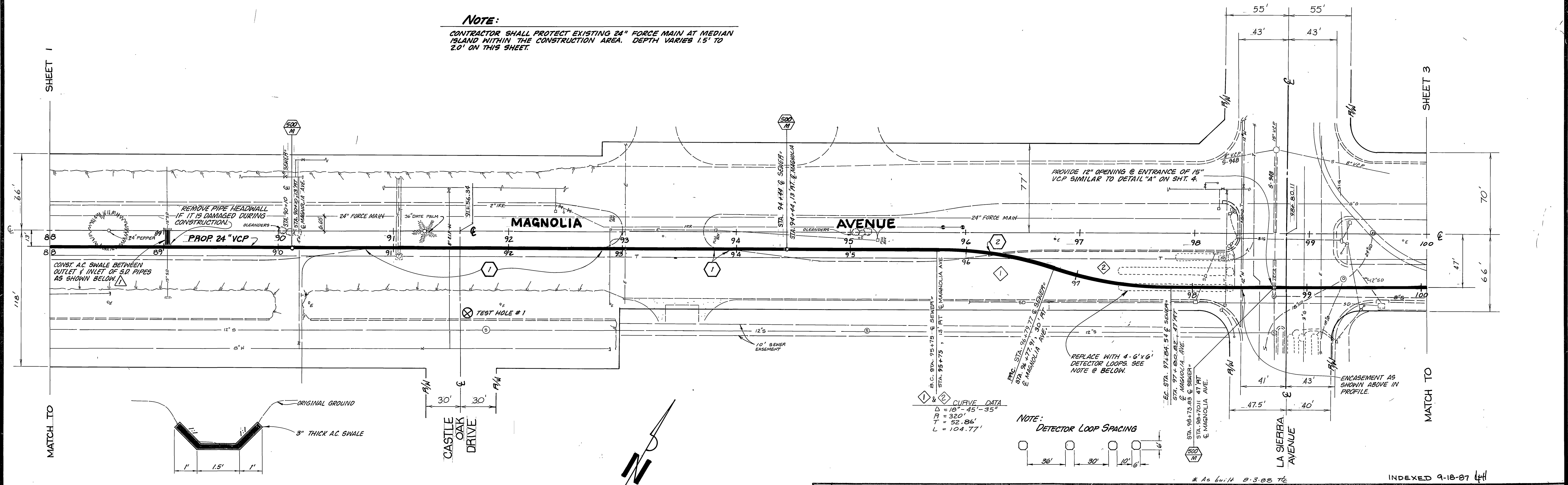

A.C. SWALE
 NO SCALE

CITY OF RIVERSIDE PUBLIC WORKS DEPARTMENT		MAGNOLIA AVENUE RELIEF SEWER FROM GOLDEN TO JONES		ACCOUNT NO. 32-577-565 S-1370 SHEET 2 OF 4
DESIGNED BY: [Signature] DRAWN BY: [Signature] CHECKED BY: [Signature]	APPROVED BY: [Signature] DATE: 8-30-85 PRINCIPAL ENGINEER PARK DEPARTMENT TRAFFIC DIVISION CHIEF P. W. ENGINEER	APPROVED BY: [Signature] DATE: 8-30-85 PUBLIC WORKS DIRECTOR	INDEXED 9-18-87 [Signature]	HORIZ. SCALE: 1" = 40' VERT. SCALE: 1" = 2'

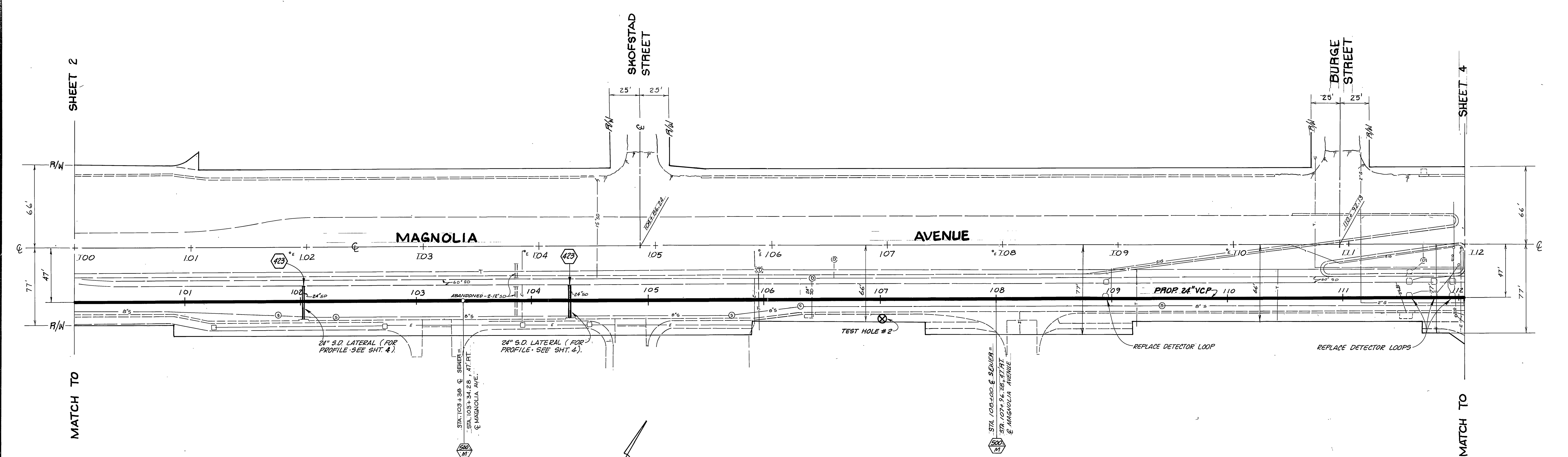
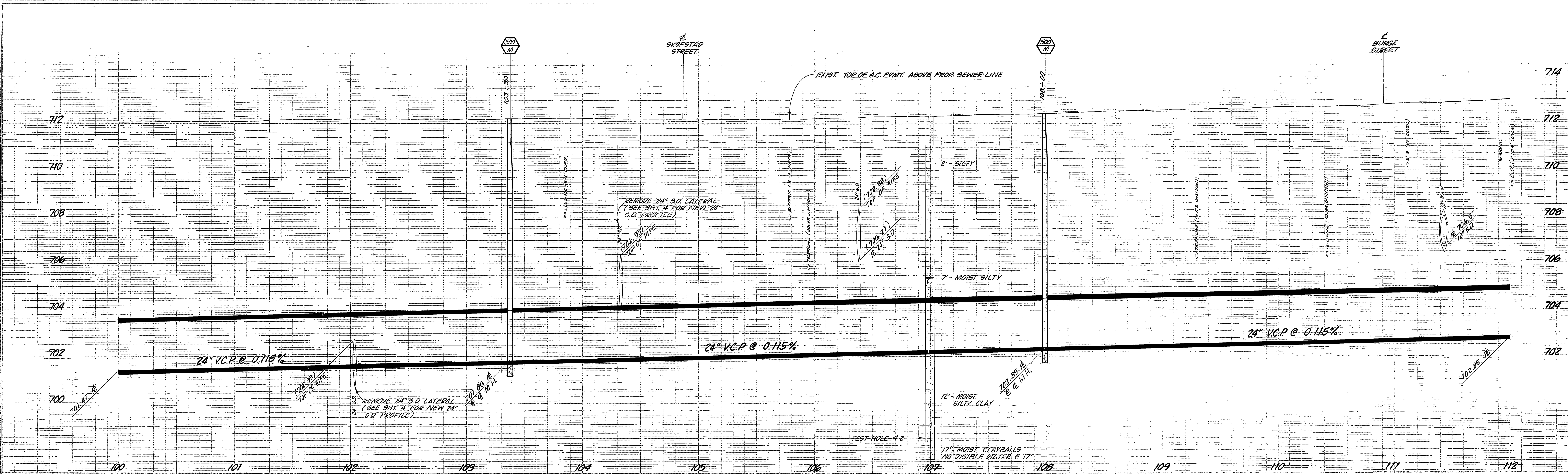

CITY OF RIVERSIDE PUBLIC WORKS DEPARTMENT		MAGNOLIA AVENUE RELIEF SEWER FROM GOLDEN TO JONES		ACCOUNT NO. 32-577-565 S-1370 SHEET 3 OF 4
APPROVED BY PRINCIPAL ENGINEER PARK DEPARTMENT TRAFFIC DIVISION CHIEF P.W. ENGINEER P.W. WATER DIVISION	DATE 8-13-85 9-13-85	APPROVED BY PUBLIC WORKS DIRECTOR WILLIAM D. SANDER	DATE 8-30-85	INDEXED 9-18-87 FH * As built 8-3-88 TE
DESIGNED BY [Signature] DRAWN BY [Signature] CHECKED BY [Signature]		HORIZ. SCALE: 1" = 40' VERT. SCALE: 1" = 2'		

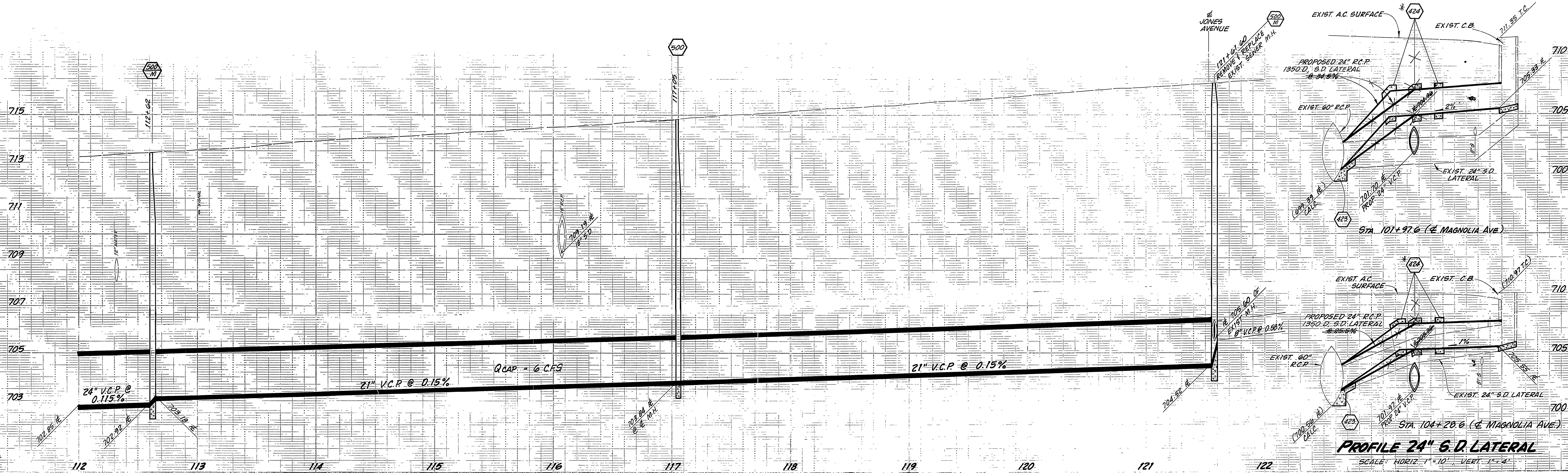

PROFILE 24" 6" D. LATERAL
SCALE: HORIZ. 1" = 10' VERT. 1" = 4'

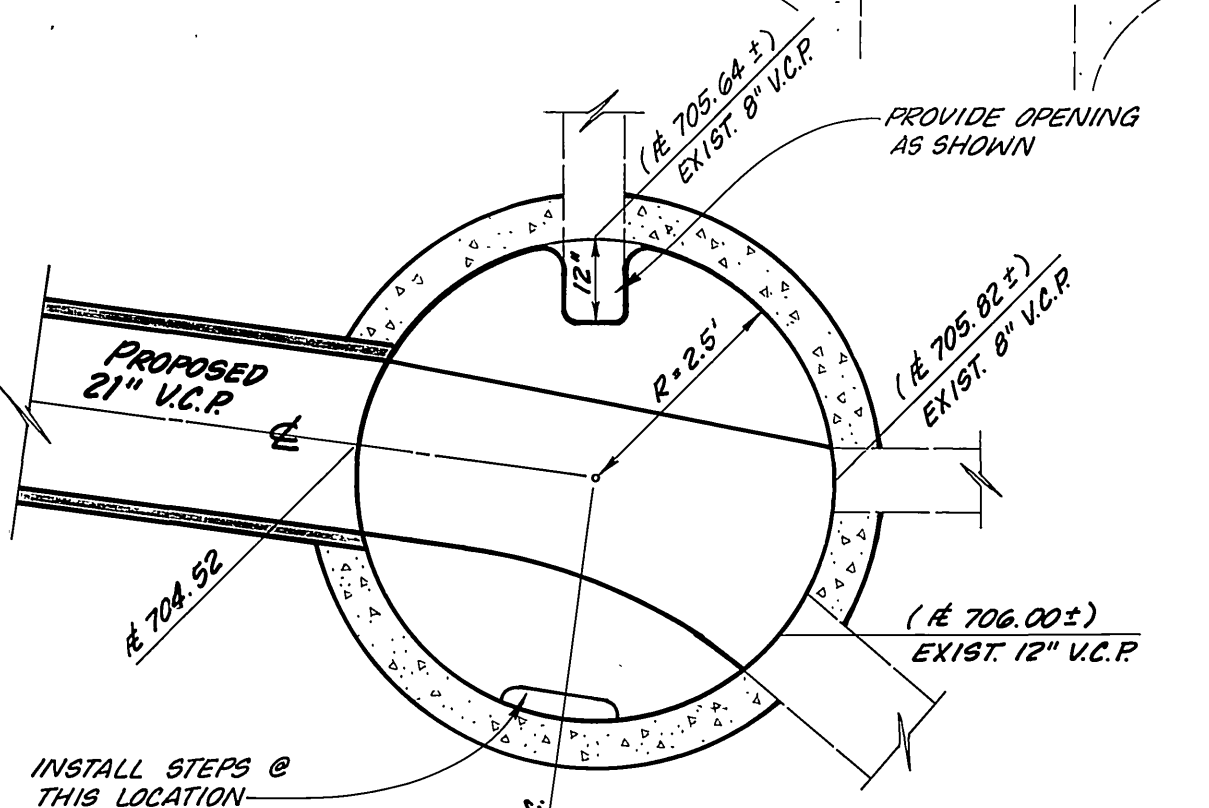
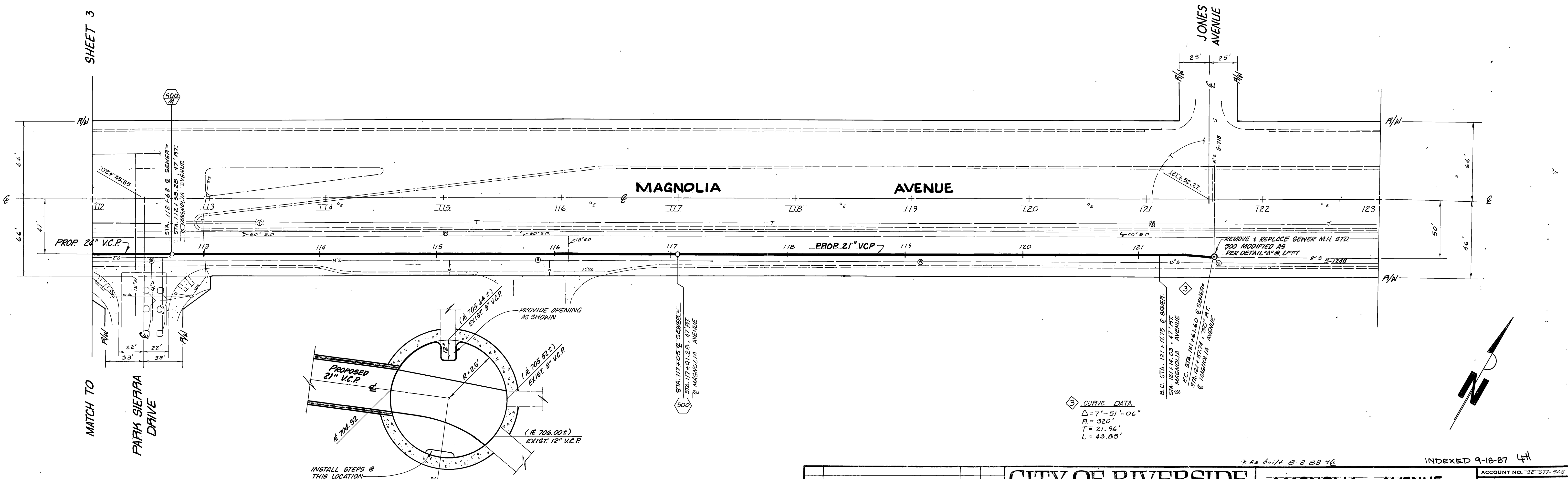

DETAIL "A"
(MODIFIED STD 500)
NO SCALE

CURVE DATA
Δ = 7° - 51' - 06"
R = 320'
T = 21.96'
L = 43.85'

B.C. STA. 121+177.5 @ SEWER
S.T.A. 121+14.03 @ 47' INT.
& MAGNOLIA AVENUE
E.C. STA. 121+141.60 @ SEWER
S.T.A. 121+57.14 @ 10' INT.
& MAGNOLIA AVENUE

CITY OF RIVERSIDE PUBLIC WORKS DEPARTMENT				MAGNOLIA AVENUE RELIEF SEWER FROM GOLDEN TO JONES		ACCOUNT NO. 32-572-565
				APPROVED BY: <i>William D. Gardner</i> PUBLIC WORKS DIRECTOR		SHEET 4 OF 4
DESIGNED BY: <i>JCL</i>	DRAWN BY: <i>JCL</i>	CHECKED BY: <i>JCL</i>	DATE: 8-30-85	HORIZ. SCALE: 1" = 40' VERT. SCALE: 1" = 2'	INDEXED 9-18-87 LH	