

GENERAL NOTES

- CONSTRUCTION SHALL BE IN ACCORDANCE WITH THE CITY OF RIVERSIDE DEPARTMENT OF PUBLIC WORKS STANDARD DRAWINGS AND THE STANDARD SPECIFICATIONS FOR PUBLIC WORKS CONSTRUCTION, 1985 EDITION.
- CONTRACTOR IS TO VERIFY EXISTING SEWER LOCATION AND ELEVATION PRIOR TO CONSTRUCTION.
- QUANTITIES SHOWN ARE FOR INFORMATION ONLY AND THE CITY OF RIVERSIDE IS NOT RESPONSIBLE FOR THEIR ACCURACY.
- A PLUG SHALL BE INSTALLED AND SHALL REMAIN IN PLACE WHERE THE NEW SEWER CONNECTS TO THE EXISTING SEWER UNTIL THE NEW SEWER IS ACCEPTED BY THE CITY.
- THE PRIVATE ENGINEER SIGNING THESE PLANS IS RESPONSIBLE FOR ASSURING THE ACCURACY AND ACCEPTABILITY OF THE WORK HEREON. IN THE EVENT OF DISCREPANCIES ARISING DURING CONSTRUCTION AS A RESULT OF ERRORS OR OMISSIONS, THE PRIVATE ENGINEER SHALL BE RESPONSIBLE FOR DETERMINING AN ACCEPTABLE SOLUTION AND REVISING THE PLANS FOR APPROVAL BY THE CITY.
- ANY TRAFFIC CONTROL STRIPING OBLITERATED AND/OR BADLY WORN DURING CONSTRUCTION SHALL BE RESTORED BY THE CONTRACTOR WITHIN FIVE DAYS AFTER NOTIFICATION FROM THE CITY INSPECTORS.

CONSTRUCTION NOTES

- CONSTRUCTION PERMITS SHALL BE OBTAINED BY THE CONTRACTOR FROM THE CITY OF RIVERSIDE PRIOR TO THE START OF ANY WORK.
- SEWER MANHOLE SHALL BE CONSTRUCTED PER CITY OF RIVERSIDE STANDARD DRAWING NO. 500.
- PIPE BEDDING SHALL BE PER CITY OF RIVERSIDE STANDARD DRAWING NO. 452, CASE I BACKFILL AND RESURFACING SHALL BE PER CITY OF RIVERSIDE STANDARD DRAWING NO. 453.

QUANTITIES

- 292± L.F. 8" VCP SEWER
- 2 EA. SEWER MANHOLE, PER CITY OF RIVERSIDE STANDARD DRAWING NO. 500
- 1 EA. SEWER LATERAL
- 1 L.S. CONNECTION TO EXISTING MANHOLE
- 60 L.F. 16" DIAMETER STEEL CASING, 3/8" THICK WALLS

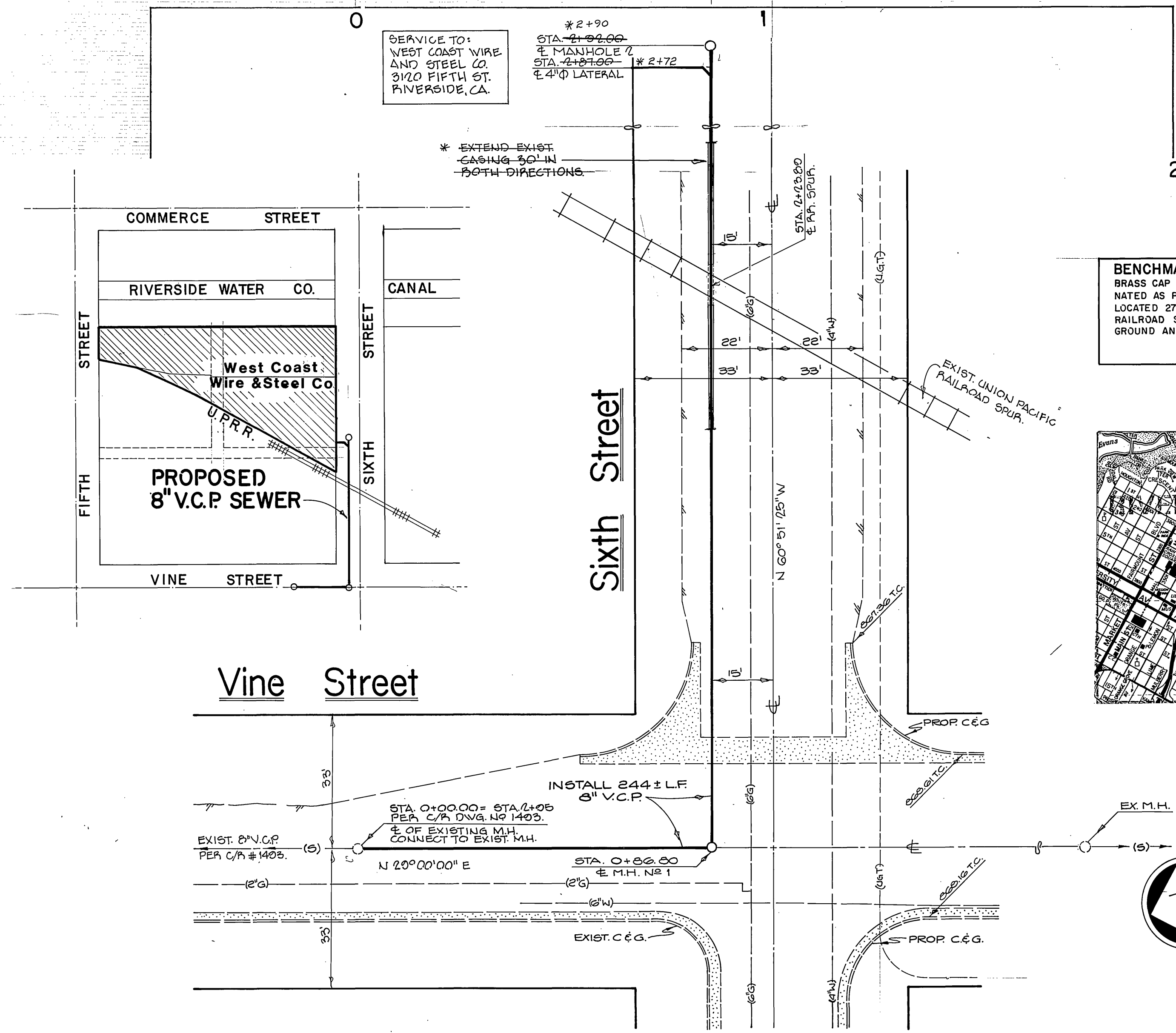

BENCHMARK:
BRASS CAP MONUMENT STAMPED "V-38", ALSO DESIGNATED AS PRECISE B.M. NO. 601-10-68, RESET 1956. LOCATED 27' EAST OF SOUTH CORNER OF THE A.T.&S.F. RAILROAD STATION, IN A CONCRETE POST FLUSH WITH GROUND AND LEVEL WITH TRACKS.
EL. 877.295

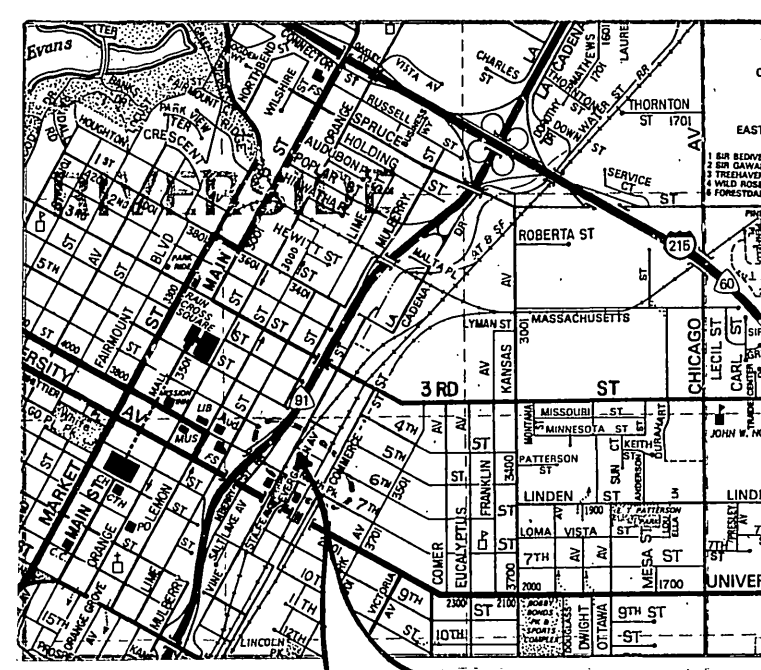

Project Location

APPROVED BY:
[Signature]
Union Pacific Railroad
DATE 2/3/86

SYM	REVISIONS	DATE	BY

KRIEGER & STEWART
INCORPORATED
ENGINEERING CONSULTANTS
RIVERSIDE, CALIFORNIA (714) 684-6900
APPROVED BY *[Signature]*
REGISTERED ENGINEER NO. 222020 DATE 1-15-86

SCALE
HORIZ. 1"=20' VERT. 1"=2'
FIELD BOOK
DESIGNED MEM
DRAWN DM
CHECKED MEM

DESIGNED BY
DRAWN BY
CHECKED BY
DATE 2/4/86

PUBLIC WORKS DEPARTMENT
APPROVED BY *[Signature]*
DATE 2-4-86
PUBLIC WORKS DIRECTOR

*As built 10-86

SEWER PLAN
VINE STREET & SIXTH STREET

INDEXED *[initials]*
ACCOUNT NO. 576-1
S-1417
SHEET 1 OF 1

HORIZ. SCALE: 1"=20' VERT. SCALE: 1"=2'