

**GENERAL NOTES:**

- IT SHALL BE THE RESPONSIBILITY OF THE CONTRACTOR TO CLEAR THE RIGHT OF WAY IN ACCORDANCE W/ THE PROVISIONS OF LAW AS IT AFFECTS EACH UTILITY INCLUDING IRRIGATION LINES AND APPURTENANCES AND AT NO COST TO THE CITY.
- CONSTRUCTION SHALL BE IN ACCORDANCE W/ THE CITY OF RIVERSIDE, DEPT. OF PUBLIC WORKS, STANDARD DRAWINGS, STANDARD DRAWING NO. 10, AND THE STANDARD SPECIFICATIONS FOR PUBLIC WORKS CONSTRUCTION, CURRENT EDITION.
- CONTRACTOR IS TO VERIFY EXISTING SEWER ELEVATION PRIOR TO CONSTRUCTION.
- THE SEWER CONTRACTOR SHALL ADJUST MANHOLES TO FINAL GRADE AFTER PAVING IS COMPLETED.
- A PLUG SHALL BE INSTALLED AND WILL REMAIN IN PLACE WHERE THE NEW SEWER CONNECTS TO THE EXISTING SEWER UNTIL THE NEW SEWER IS ACCEPTED BY THE CITY.
- THE PRIVATE ENGINEER SIGNING THESE PLANS IS RESPONSIBLE FOR ASSURING THE ACCURACY AND ACCEPTABILITY OF THE WORK HEREON. IN THE EVENT OF DISCREPANCIES ARISING DURING CONSTRUCTION THE PRIVATE ENGINEER SHALL BE RESPONSIBLE FOR DETERMINING AN ACCEPTABLE SOLUTION AND REVISING THE PLANS FOR APPROVAL BY THE CITY.
- ALL FLAGGED ELEVATIONS SHALL BE STAKED IN THE FIELD BY THE PRIVATE ENGINEER.
- QUANTITIES SHOWN ARE FOR INFORMATION ONLY AND THE CITY OF RIVERSIDE IS NOT RESPONSIBLE FOR THEIR ACCURACY.
- THE DEVELOPER SHALL BE RESPONSIBLE FOR PRESERVING OR RE-ESTABLISHING AND REFERENCING SURVEY MONUMENTS DESTROYED, DISTURBED, OR BURIED AS A RESULT OF CONSTRUCTION SHOWN HEREON.
- LOCATION OF LATERALS TO BE DETERMINED IN THE FIELD AT THE DIRECTION OF THE OWNER. AVOID CONFLICT WITH PROPOSED AND/OR EXISTING FACILITIES.
- NO FINISHED FLOOR ELEVATION SHALL BE LESS THAN 4' ABOVE THE SEWER FLOW LINE AT POINT OF CONNECTION WITHOUT HAVING A PROPER BACKWATER VALVE INSTALLED IN THE LATERAL.
- THE CONTRACTOR SHALL CALL IN A LOCATION REQUEST TO UNDERGROUND SERVICE ALERT (USA), PHONE NO. 1-800-422-4133, TWO WORKING DAYS BEFORE DIGGING. NO CONSTRUCTION PERMIT WILL BE ISSUED BY THE PUBLIC WORKS DEPARTMENT INVOLVING EXCAVATION FOR UNDERGROUND FACILITIES UNLESS THE APPLICANT HAS BEEN PROVIDED AN INQUIRY IDENTIFICATION NUMBER BY U.S.A.

**ESTIMATE OF QUANTITIES:**

- INSTALL 8" V.C.P. 120 L.F.
- INSTALL 6" V.C.P. LATERAL 28 L.F.
- INSTALL MANHOLE PER STD 500 1 EA.
- INSTALL WYE AS SHOWN 1 EA.

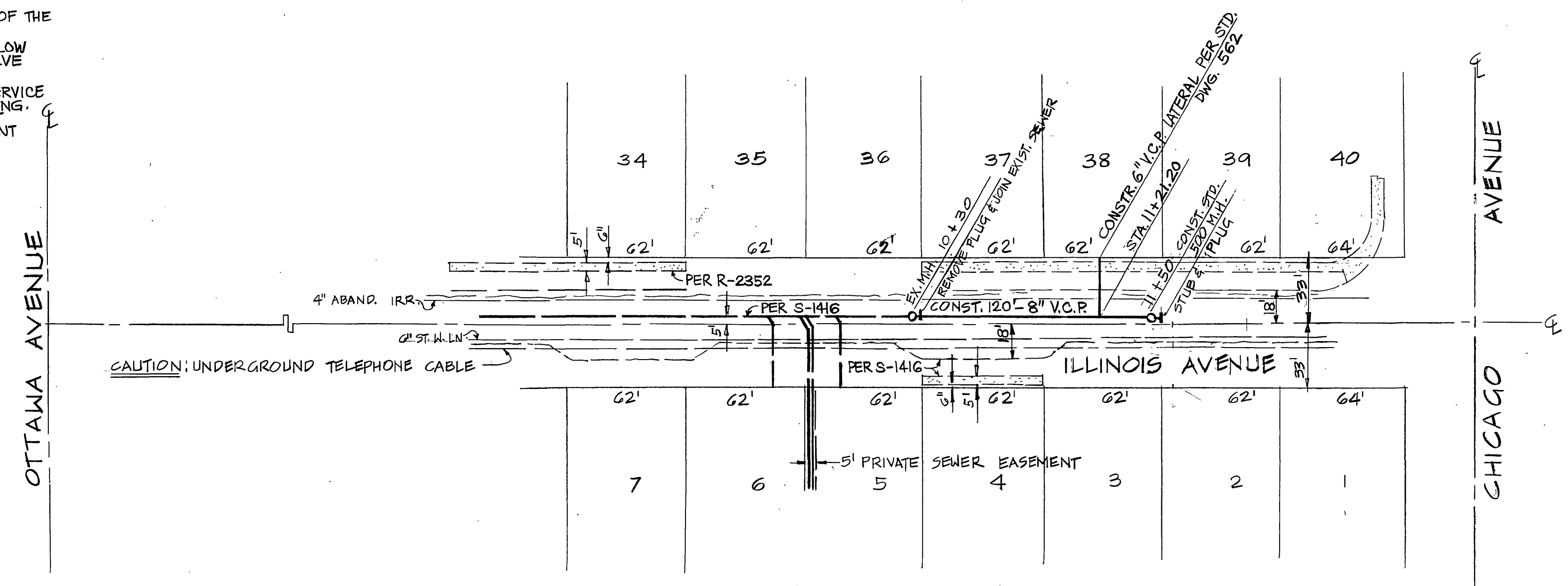
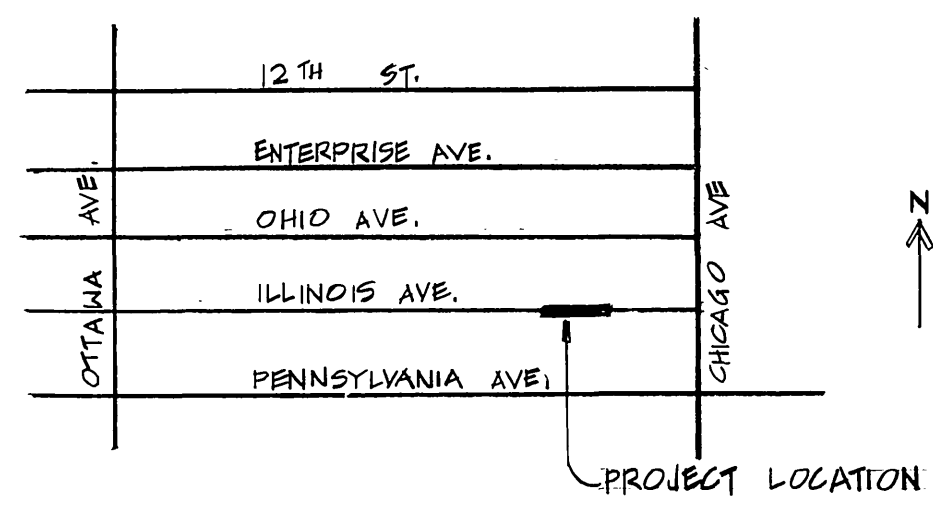

BUS. LIC. # 034687 EXP. 4/10/88

PACIFIC TEL. CO. <i>John Wick</i> DATE 8/6/87	SO. CALIF. GAS CO. <i>E. P. ...</i> DATE 8-5-87	CITY OF RIVERSIDE ELECTRICAL APPROVED BY: <i>Michael J. ...</i> DATE 8/6/87	CITY OF RIVERSIDE WATER SYSTEM APPROVED BY: <i>Carl ...</i> DATE 9/30/87	ENRIQUE MARQUEZ & ASSOC. 3210 MAIN STREET RIVERSIDE, CA 92501 784-3911 <i>Enrique Marquez</i> DATE 4/12/87 E.S. MARQUEZ R.C.E. 37724
---	---	---	--	--

\* AS BUILT 2-22-91 LHM  
INDEXED 11-5-87 LHM

<b>CITY OF RIVERSIDE</b> PUBLIC WORKS DEPARTMENT APPROVED BY: <i>Benny Beck</i> DATE: 10/28/87 CHIEF P.W. ENGINEER		ACCOUNT NO. DRAWING NUMBER <b>S-1476</b>	
		SEWER PLAN AND PROFILE ILLINOIS AVENUE BETWEEN OTTAWA AVE. & CHICAGO AVE. C-17-867 HORIZ. SCALE 1"=50' - VERT. SCALE 1"=4'	
DESIGNED BY: P.M. DRAWN BY: M.S. CHECKED BY: E.M.	REVISIONS APPR. DATE	APPROVED BY: <i>Benny Beck</i> PUBLIC WORKS DIRECTOR DATE: 10/28/87	SHEET 1 OF 1