

NO.	DATE	BY

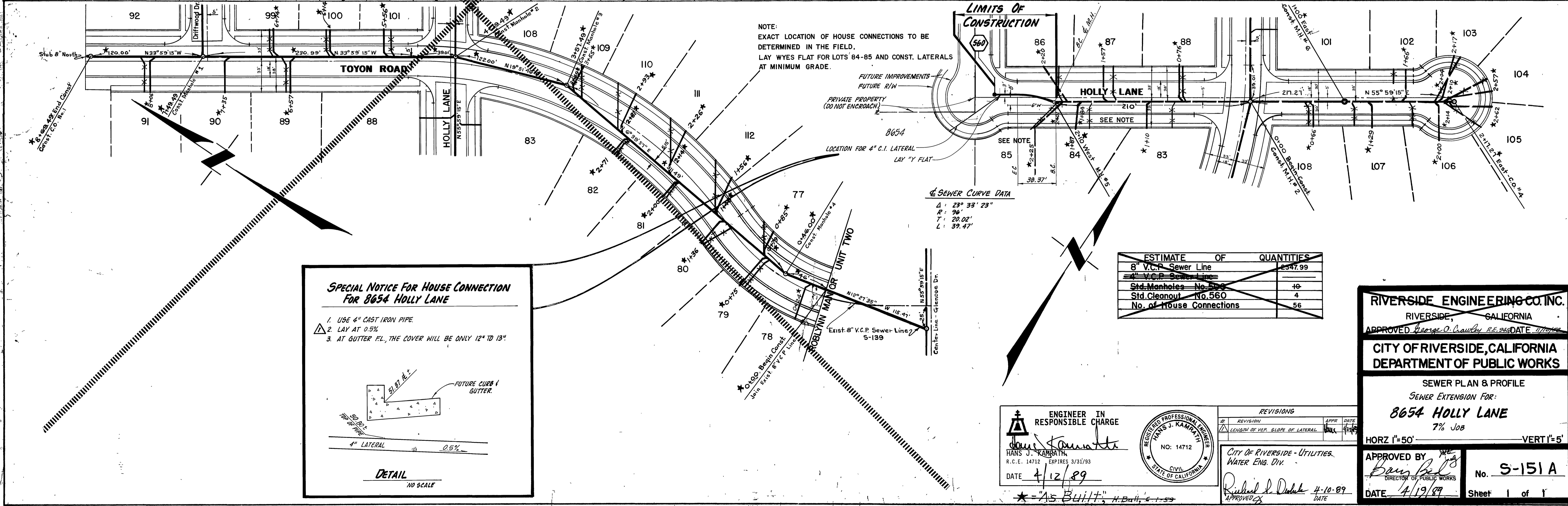

NO.	DATE	BY

SPECIAL NOTICE FOR HOUSE CONNECTION FOR 8654 HOLLY LANE

- USE 4" CAST IRON PIPE.
- LAY AT 0.5%.
- AT GUTTER FL., THE COVER WILL BE ONLY 12" TO 13".

DETAIL
NO SCALE

ESTIMATE OF QUANTITIES	
8" V.C.P. Sewer Line	2947.99
4" V.C.P. Sewer Line	10
Std. Manholes - No. 560	4
Std. Cleanout - No. 560	4
No. of House Connections	56

RIVERSIDE ENGINEERING CO. INC.
 RIVERSIDE, CALIFORNIA
 APPROVED: *George O. Cantley* R.E. 345 DATE 4/19/89

CITY OF RIVERSIDE, CALIFORNIA
 DEPARTMENT OF PUBLIC WORKS

SEWER PLAN & PROFILE
 SEWER EXTENSION FOR:
8654 HOLLY LANE
 7% JOB

HORZ 1"=50' VERT 1"=5'

APPROVED BY: *Ray Bell*
 DIRECTOR OF PUBLIC WORKS

DATE: 4/19/89 No. **S-151 A** Sheet 1 of 1

ENGINEER IN RESPONSIBLE CHARGE
George J. Kambath
 HANS J. KAMBATH
 R.C.E. 14712 EXPIRES 3/31/93
 DATE: 4/12/89

PROFESSIONAL ENGINEER
 HANS J. KAMBATH
 NO: 14712
 CIVIL
 STATE OF CALIFORNIA

REVISIONS

NO.	REVISION	APPR.	DATE
1	LENGTH OF V.C.P. SLOPE OF LATERAL	<i>[Signature]</i>	4/19/89

CITY OF RIVERSIDE - UTILITIES
 WATER ENG. DIV.
Rudolph J. Duda 4-10-89
 APPROVED DATE

INDEXED 8-9-89 4H