

- GENERAL NOTES**
- IT SHALL BE THE RESPONSIBILITY OF THE CONTRACTOR TO CLEAR THE RIGHT-OF-WAY IN ACCORDANCE WITH THE PROVISIONS OF LAW AS IT AFFECTS EACH UTILITY INCLUDING IRRIGATION LINES AND APPURTENANCES AND AT NO COST TO THE CITY.
 - CONSTRUCTION SHALL BE IN ACCORDANCE WITH THE CITY OF RIVERSIDE DEPARTMENT OF PUBLIC WORKS, STANDARD DRAWINGS, STANDARD DRAWING NO. 10 AND THE STANDARD SPECIFICATIONS FOR PUBLIC WORKS CONSTRUCTION, CURRENT EDITION.
 - THE PRIVATE ENGINEER SIGNING THESE PLANS IS RESPONSIBLE FOR ASSURING THE ACCURACY AND ACCEPTABILITY OF THE WORK HEREON. IN THE EVENT OF DISCREPANCIES ARISING DURING CONSTRUCTION, THE PRIVATE ENGINEER SHALL BE RESPONSIBLE FOR DETERMINING AN ACCEPTABLE SOLUTION AND REVISING THE PLANS FOR APPROVAL BY THE CITY.
 - QUANTITIES SHOWN ARE FOR INFORMATION ONLY AND THE CITY OF RIVERSIDE IS NOT RESPONSIBLE FOR THEIR ACCURACY.
 - THE DEVELOPER SHALL BE RESPONSIBLE FOR PRESERVING OR RE-ESTABLISHING AND REFERENCING SURVEY MONUMENTS DESTROYED, DISTURBED, OR BURIED AS A RESULT OF CONSTRUCTION SHOWN HEREON.
 - ALL FLAGGED ELEVATIONS SHALL BE STAKED IN THE FIELD BY THE PRIVATE ENGINEER.
 - THE CONTRACTOR SHALL CALL IN A LOCATION REQUEST TO UNDERGROUND SERVICE ALERT (USA), PHONE NO. 1-800-422-4133, TWO WORKING DAYS BEFORE DIGGING. NO CONSTRUCTION PERMIT WILL BE ISSUED BY THE PUBLIC WORKS DEPARTMENT INVOLVING EXCAVATION FOR UNDERGROUND FACILITIES UNLESS THE APPLICANT HAS BEEN PROVIDED AN UNDERGROUND IDENTIFICATION NUMBER BY U.S.A..
 - CONTRACTOR IS TO VERIFY EXISTING SEWER ELEVATION PRIOR TO CONSTRUCTION.
 - LOCATION OF LATERALS TO BE DETERMINED IN THE FIELD AT THE DIRECTION OF THE OWNER. AVOID CONFLICT WITH PROPOSED AND/OR EXISTING FACILITIES.
 - NO FINISHED FLOOR ELEVATION SHALL BE LESS THAN 4' ABOVE THE SEWER FLOW LINE AT POINT OF CONNECTION WITHOUT HAVING A PROPER BACKWATER VALVE INSTALLED IN THE LATERAL.
 - THE SEWER CONTRACTOR SHALL ADJUST MANHOLES TO FINAL GRADE AFTER PAVING IS COMPLETED.
 - A PLUG SHALL BE INSTALLED AND WILL REMAIN IN PLACE WHERE THE NEW SEWER CONNECTS WITH THE EXISTING SEWER UNTIL THE NEW SEWER IS ACCEPTED BY THE CITY.

CONSTRUCTION NOTE AND ESTIMATED QUANTITIES

1	CONST. SEWER MANHOLE PER STD. DWG. NO. 500	2 EA.
2	CONST. 8" V.C.P.	374 L.F.
3	CONST. 8" D.I.P. WITH COMPRESSION JOINTS	164 L.F.
4	CONST. 6" V.C.P.	524 L.F.
5	CONST. SEWER CLEANOUT PER STD. DWG. NO. 560	4 EA.
6	REMOVE AND REPLACE EX. PAVEMENT IN KIND	3330 S.F.

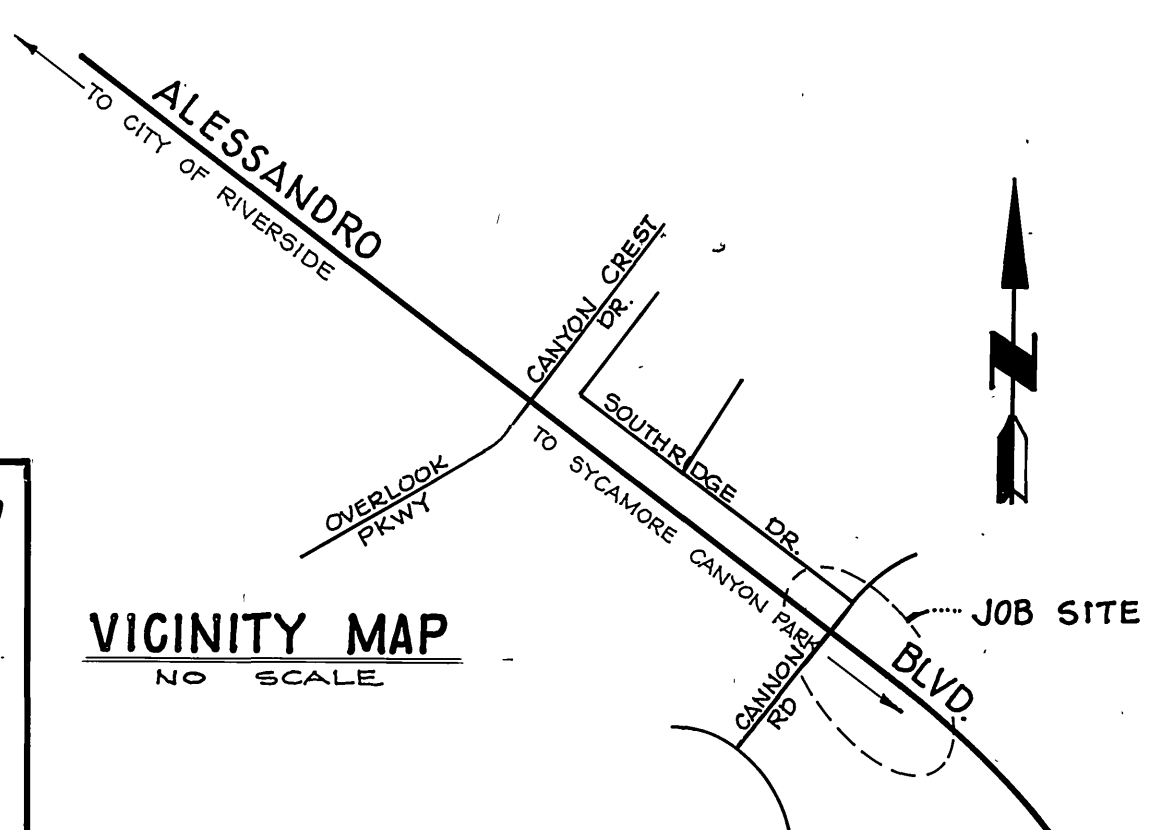
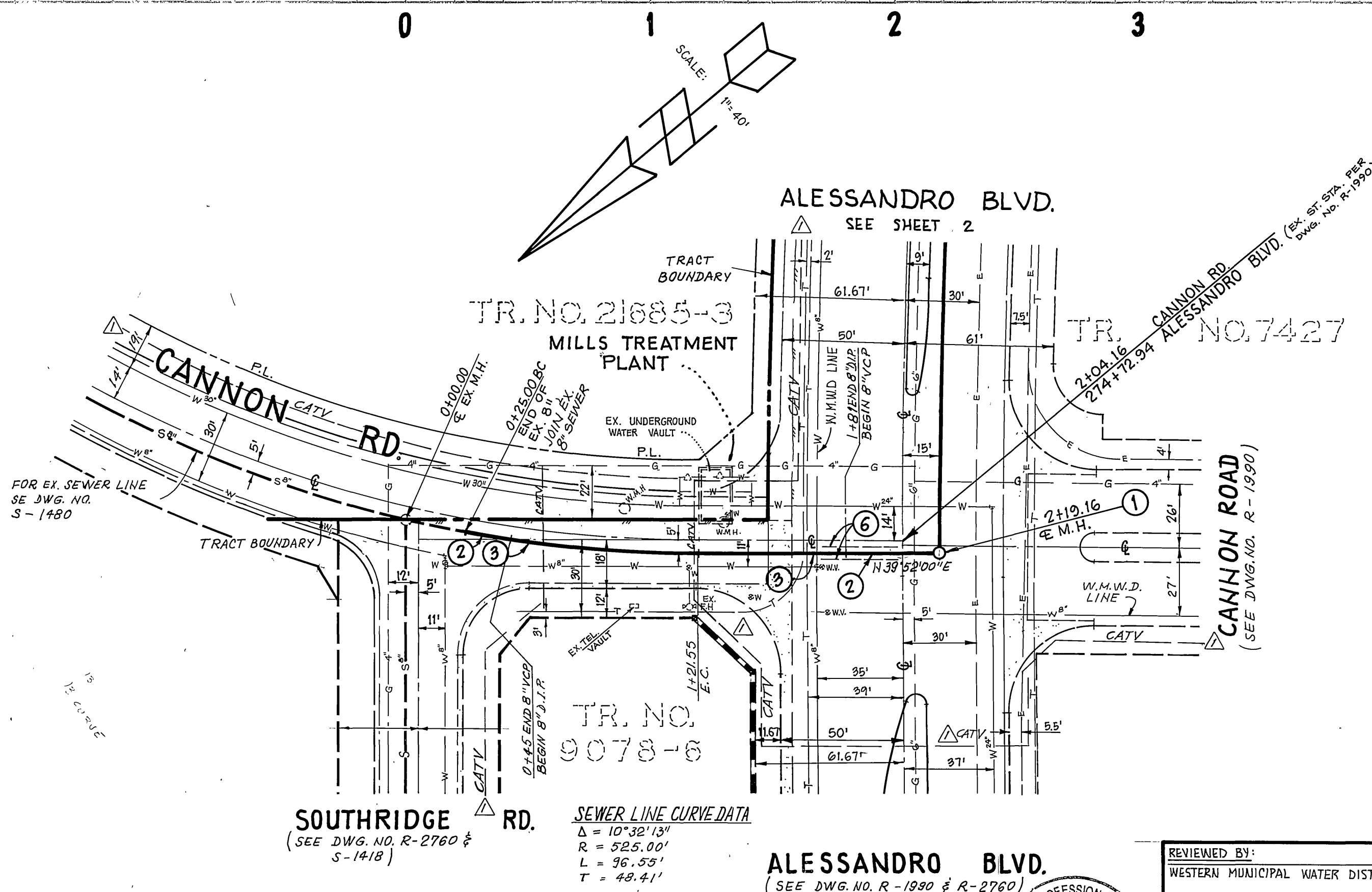

CALL CHOICE TELEVISION
714-688-9012
MARK A. DEFFENDAL
CONST. FOREMAN
THEY WILL MARK UP THEIR LINES THEMSELVES

BENCH MARK: CITY OF RIVERSIDE B.M. F-7A,
ELEVATION 1937.423 (CITY), TAKEN AS ELEVATION 1337.90 PER ST. PLAN NO. R-2760 FOR TR. NO. 9078-7.

UNDERGROUND SERVICE ALERT
CALL TWO WORKING DAYS BEFORE YOU DIG
1-800-422-4133
TOLL FREE

PRIVATE ENGINEER'S NOTICE TO CONTRACTORS
SAFETY RESPONSIBILITY: CONTRACTOR AGREES THAT HE SHALL ASSUME SOLE AND COMPLETE RESPONSIBILITY FOR JOB SITE CONDITIONS DURING THE COURSE OF CONSTRUCTION OF THIS PROJECT, INCLUDING SAFETY OF ALL PERSONS AND PROPERTY, THAT THE REQUIREMENTS SHALL APPLY CONTINUOUSLY AND NOT BE LIMITED TO NORMAL WORKING HOURS; AND THAT THE CONTRACTOR SHALL DEFEND, INDEMNIFY AND HOLD THE OWNER AND THE ENGINEER HARMLESS FROM ANY AND ALL LIABILITY, REAL OR ALLEGED, IN CONNECTION WITH THE PERFORMANCE OF WORK ON THIS PROJECT, INCLUDING LIABILITY ARISING FROM THE SOLE NEGLIGENCE OF THE OWNER OR THE ENGINEER.

EXISTING UNDERGROUND STRUCTURES: THE EXISTENCE AND LOCATION OF ANY UNDERGROUND PIPES OR STRUCTURES SHOWN ON THESE PLANS HAVE BEEN OBTAINED BY A SEARCH OF AVAILABLE RECORDS TO THE BEST OF OUR KNOWLEDGE. THERE ARE NO EXISTING UTILITIES EXCEPT AS SHOWN ON THESE PLANS. THE CONTRACTOR IS RESPONSIBLE TO TAKE THE NECESSARY PRECAUTIONARY MEASURES TO PROTECT THE EXISTING UTILITY LINES AND ANY LINES NOT OF RECORD, OR NOT SHOWN ON THESE PLANS.

PLANS PREPARED BY:
HAWKINS, ROBERTSON & ASSOC., INC.
3764 ELIZABETH ST.
RIVERSIDE CALIF. 92506
PH: (714) 684-9522
PREPARED UNDER SUPERVISION OF:
Massoud Tazir 11/19/89
R.C.E. 43613 EXPIRES: 12/31/92 DATE

REVIEWED BY:
WESTERN MUNICIPAL WATER DISTRICT
SHEETS 1 AND 2
Thomas H. Stahl
SUPV. DESIG. ENGR. R.C.E. 21643
DATE: 3/20/89

CITY OF RIVERSIDE
WATER SYSTEM
Richard L. Dinkel 2-21-89
APPROVED DATE

PACIFIC TELEPHONE
Clayton 1-30-89
APPROVED DATE

SOUTHERN CALIFORNIA GAS CO
Robert H. Johns 1-30-89
APPROVED DATE

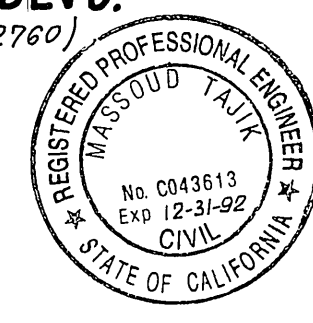

DESIGNED BY: *D.H.*
DRAWN BY: *W.B.E.* CHECKED BY: *M.F.*

CITY OF RIVERSIDE
PUBLIC WORKS DEPARTMENT
APPROVED BY: *Barry Bed*
DATE: 4/19/89

SEWER LINE EXTENSION FOR
COUNTY COMMUNICATION CENTER
COUNTY OF RIVERSIDE
7195 ALESSANDRO BLVD., RIVERSIDE, CA. 92506

ACCOUNT NO. 5-1539
SHEET 1 OF 2
HORIZ. SCALE: 1" = 40' VERT. SCALE: 1" = 4'

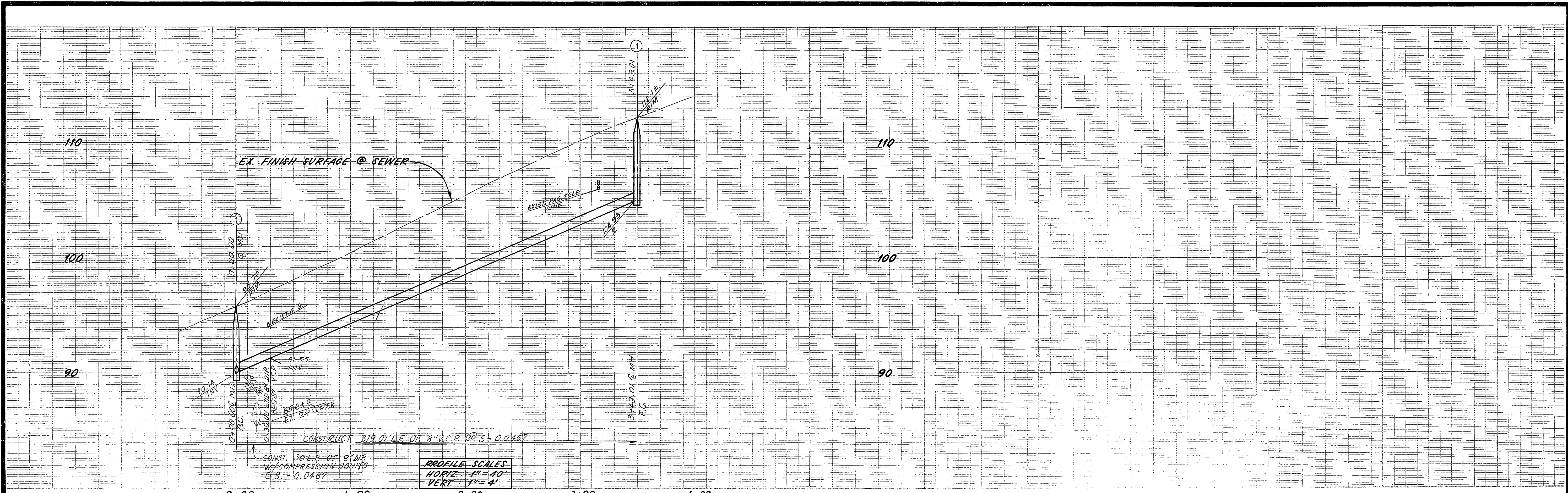

PROFILE SCALES
 HORIZ. 1" = 40'
 VERT. 1" = 4'

- CONSTRUCTION NOTES**
- ① CONST. SEWER MANHOLE PER STD. DWG. NO. 500
 - ② CONST. 8" V.C.P.
 - ③ CONST. 8" D.I.P. w/ COMPRESSION JOINTS
 - ④ CONST. 6" V.C.P.
 - ⑤ CONST. SEWER CLEAN-OUT PER STD. DWG. NO. 560
 - ⑥ REMOVE AND REPLACE EX. PAVEMENT IN KIND

TR. NO. 21885-3

SEWER LINE CURVE DATA
 Δ = 5°24'29"
 R = 3710.70'
 L = 349.01'
 T = 174.64'

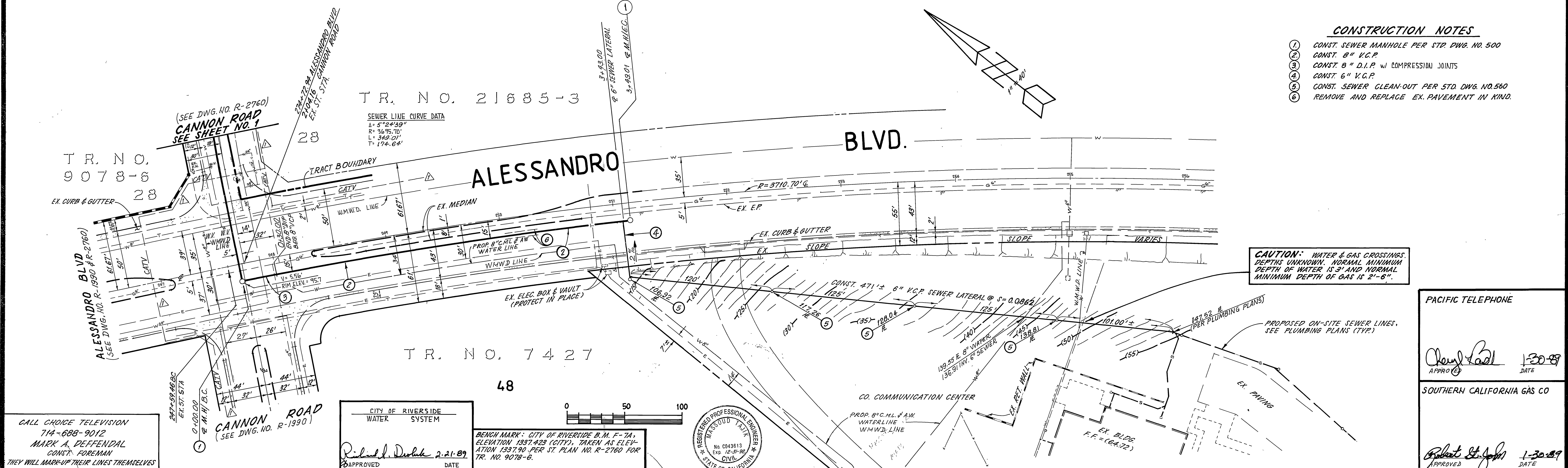

CAUTION: WATER & GAS CROSSINGS. DEPTHS UNKNOWN. NORMAL MINIMUM DEPTH OF WATER IS 3' AND NORMAL MINIMUM DEPTH OF GAS IS 2'-0".

PACIFIC TELEPHONE
 APPROVED: *Clayton Ladd* 1-30-89
 SOUTHERN CALIFORNIA GAS CO
 APPROVED: *Robert St. John* 1-30-89

CALL CHOICE TELEVISION
 714-688-9012
 MARK A. DEFFENDAL
 CONST. FOREMAN
 THEY WILL MARK-UP THEIR LINES THEMSELVES

CITY OF RIVERSIDE
 WATER SYSTEM
 APPROVED: *Richard J. Durbak* 2-21-89
 DATE

BENCH MARK: CITY OF RIVERSIDE B.M. F-7A,
 ELEVATION 137.423 (CITY), TAKEN AS ELEVATION 137.90 PER ST. PLAN NO. R-2760 FOR TR. NO. 9078-6.

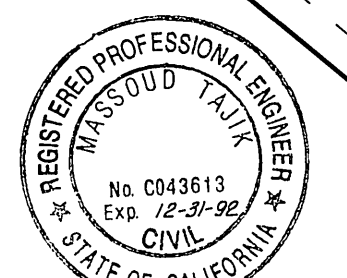

PLANS PREPARED BY:
HAWKINS, ROBERTSON & ASSOC. INC.
 3764 ELIZABETH ST.
 RIVERSIDE, CALIF. 92506
 PH: (714) 684-9522
 PREPARED UNDER SUPERVISION OF:
Massiud Tajik 4/18/89
 DATE
 MASSIUD TAJIK
 R.C.E. 43418
 EXPIRES: 12/31/92

CITY OF RIVERSIDE
PUBLIC WORKS DEPARTMENT
 APPROVED BY: *Barry Best* 4-11-89
 DATE
 PUBLIC WORKS DIRECTOR
 CHIEF P.W. ENGINEER
 DATE: 4/19/89

SEWER LINE EXTENSION
 FOR
 COUNTY COMMUNICATION CENTER
 COUNTY OF RIVERSIDE
 7195 ALESSANDRO BLVD., RIVERSIDE, CA 92506
 HORIZ. SCALE: 1" = 40' VERT. SCALE: 1" = 4'

ACCOUNT NO.
S-1539
 SHEET **2** OF **2**

UNDERGROUND SERVICE ALERT
 CALL TWO WORKING DAYS
 BEFORE YOU DIG
 1-800-422-4133
 TOLL FREE

PRIVATE ENGINEER'S NOTICE TO CONTRACTORS
 SAFETY RESPONSIBILITY: CONTRACTOR AGREES THAT HE SHALL ASSUME SOLE AND COMPLETE RESPONSIBILITY FOR THE SITE CONDITIONS DURING THE COURSE OF CONSTRUCTION OF THE PROJECT, INCLUDING SAFETY OF ALL PERSONS AND PROPERTY. THAT THE REQUIREMENTS SHALL APPLY CONTINUOUSLY AND NOT BE LIMITED TO NORMAL WORKING HOURS, AND THAT THE CONTRACTOR SHALL DEFEND, INDEMNIFY AND HOLD THE OWNER AND THE ENGINEER HARMLESS FROM ANY AND ALL LIABILITY, BEHALF OF ALLIED, IN CONNECTION WITH THE PERFORMANCE OF WORK ON THIS PROJECT, EXCEPTING FOR LIABILITY ARISING FROM THE SOLE NEGLIGENCE OF THE OWNER OR THE ENGINEER.

EXISTING UNDERGROUND STRUCTURES: THE EXISTENCE AND LOCATION OF ANY UNDERGROUND PIPES OR STRUCTURES SHOWN ON THESE PLANS WAS OBTAINED BY A SEARCH OF AVAILABLE RECORDS. TO THE BEST OF OUR KNOWLEDGE, THERE ARE NO EXISTING UTILITIES EXCEPT AS SHOWN ON THESE PLANS. THE CONTRACTOR IS REQUIRED TO TAKE THE APPROPRIATE PRECAUTIONARY MEASURES TO PROTECT THE EXISTING UTILITY LINES AND ANY LINES NOT OF RECORD OR NOT SHOWN ON THESE PLANS.

MARK	REVISIONS	APPR. DATE
1	ADDED APPROX. LOCATIONS OF CITY WATER	4/18/89