

1895

1885

1875

1895

1885

1875

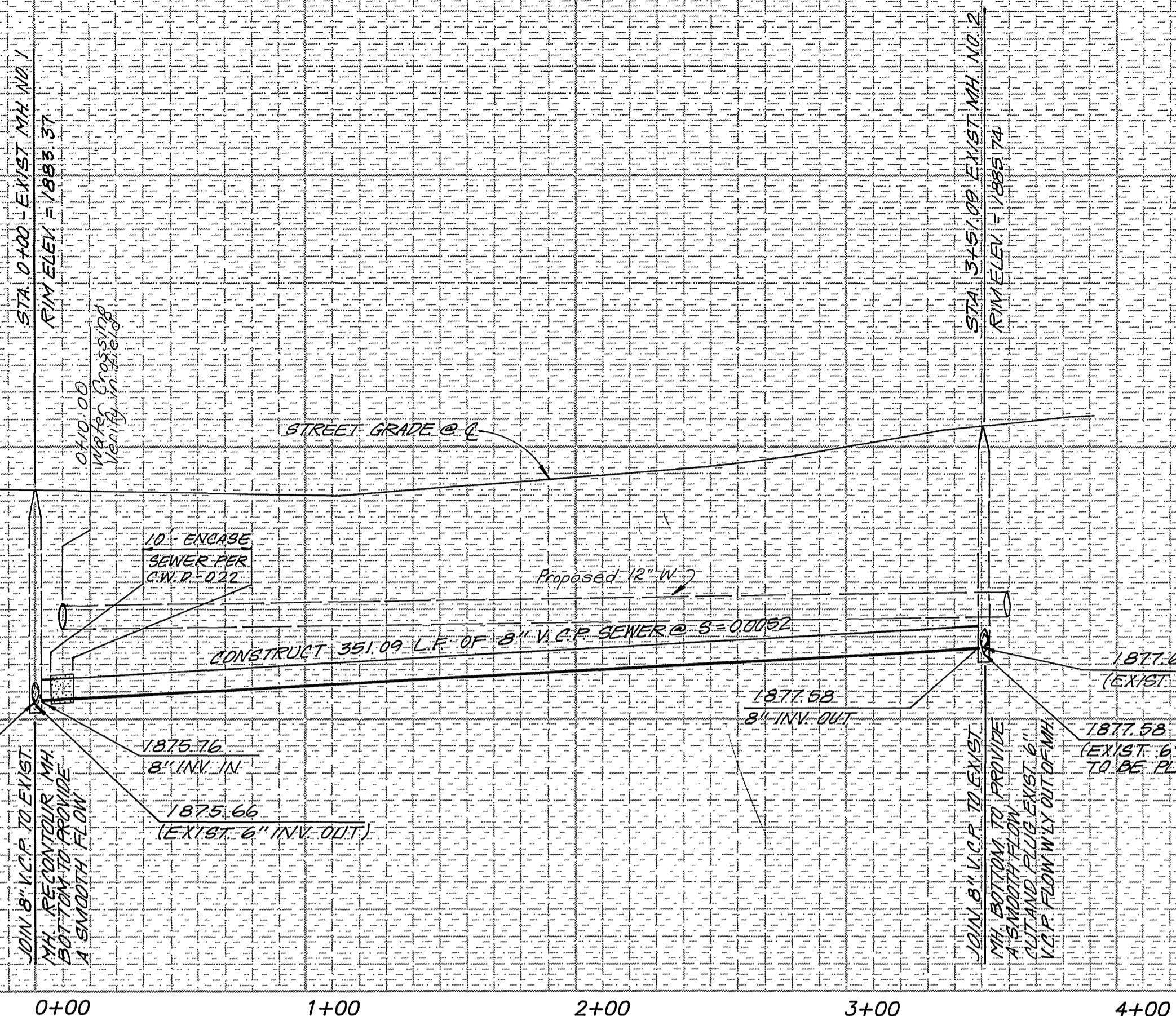

PROFILE SCALES:  
 HORIZ. 1"=40'  
 VERT. 1"=4'

- CONSTRUCTION NOTES**
1. INSTALL 8" V.C.P. SEWER.
  2. EXISTING MANHOLE.
  3. RECONTOUR BOTTOM OF MANHOLE FOR SMOOTH FLOW.
  4. RECONSTRUCT PAVEMENT PER STD. DWG. 453.

- GENERAL NOTES**
1. IT SHALL BE THE RESPONSIBILITY OF THE CONTRACTOR TO CLEAN THE RIGHT-OF-WAY IN ACCORDANCE WITH THE PROVISIONS OF LAW AS IT AFFECTS EACH UTILITY INCLUDING IRRIGATION LINES AND APPURTENANCES AND AT NO COST TO THE CITY.
  2. CONSTRUCTION SHALL BE IN ACCORDANCE WITH THE CITY OF RIVERSIDE DEPARTMENT OF PUBLIC WORKS' STANDARD DRAWINGS, STANDARD DRAWING NO. 10 AND THE STANDARD SPECIFICATIONS FOR PUBLIC WORKS CONSTRUCTION, CURRENT EDITION.
  3. CONTRACTOR IS TO VERIFY EXISTING SEWER ELEVATION PRIOR TO CONSTRUCTION.
  4. ALL MANHOLES TO BE MODIFIED FOR NEW SEWER LINE IN CONFORMANCE WITH CITY OF RIVERSIDE STANDARD NO. 500.
  5. THE CUTTING OFF AND PLUGGING OF THE EXISTING SEWER WILL NOT BE DONE UNTILL NEW SEWER IS ACCEPTED BY CITY OF RIVERSIDE.
  6. THE PRIVATE ENGINEER SIGNING THESE PLANS IS RESPONSIBLE FOR ASSURING THE ACCURACY AND ACCEPTABILITY OF THE WORK HEREON. IN THE EVENT OF DISCREPANCIES ARISING DURING CONSTRUCTION, THE PRIVATE ENGINEER SHALL BE RESPONSIBLE FOR DETERMINING AN ACCEPTABLE SOLUTION AND REVISING THE PLANS FOR APPROVAL BY THE CITY.
  7. THE CONTRACTOR SHALL CALL IN A LOCATIONS REQUEST TO UNDERGROUND SERVICE ALERT (USA), PH.# 1-800-422-4133 TWO WORKING DAYS BEFORE DIGGING. NO CONSTRUCTION PERMIT WILL BE ISSUED BY THE PUBLIC WORKS DEPARTMENT INVOLVING EXCAVATION FOR UNDERGROUND FACILITIES UNLESS THE APPLICANT HAS BEEN PROVIDED AN INQUIRY IDENT. NUMBER BY USA.

**CENTRE BRANDS**

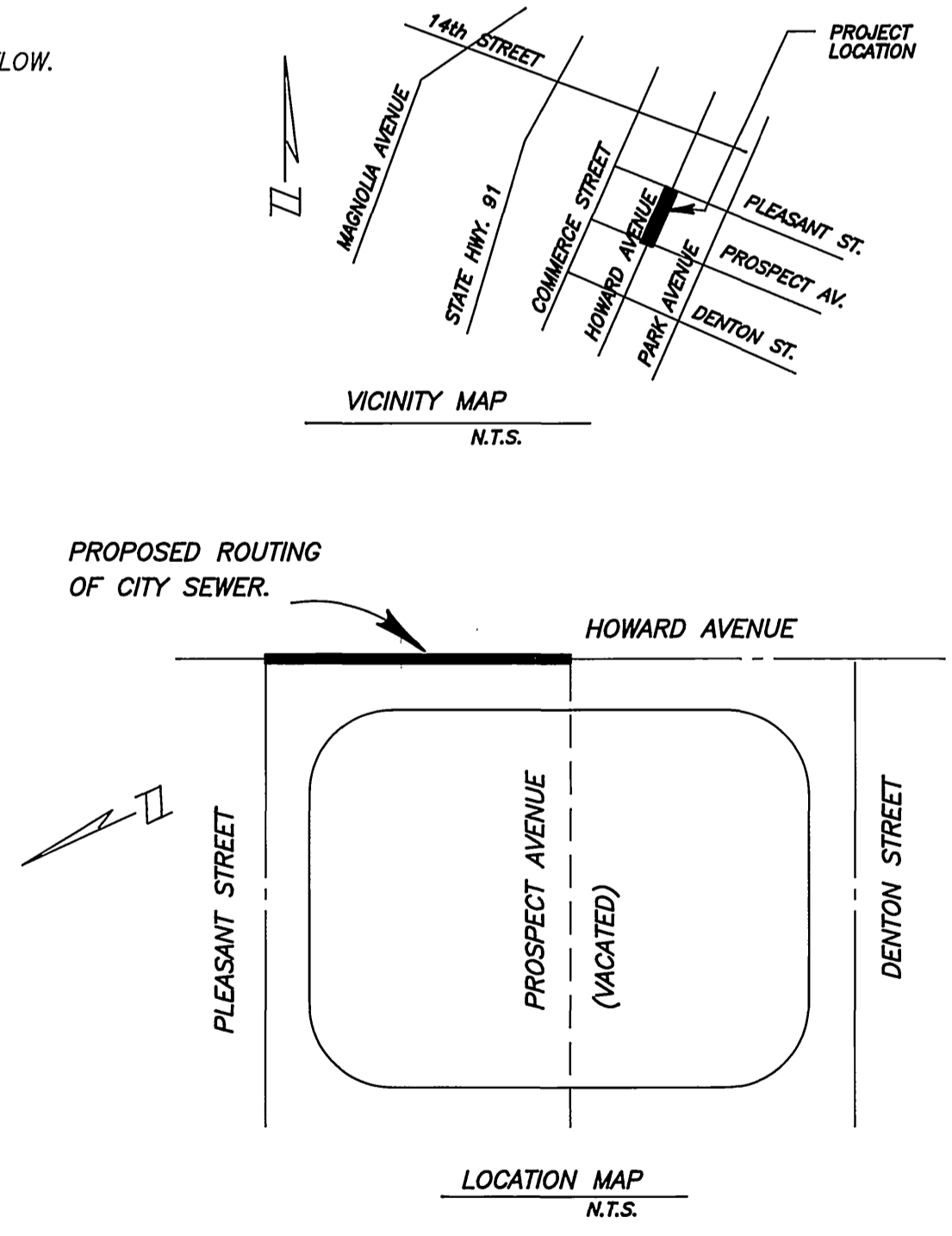
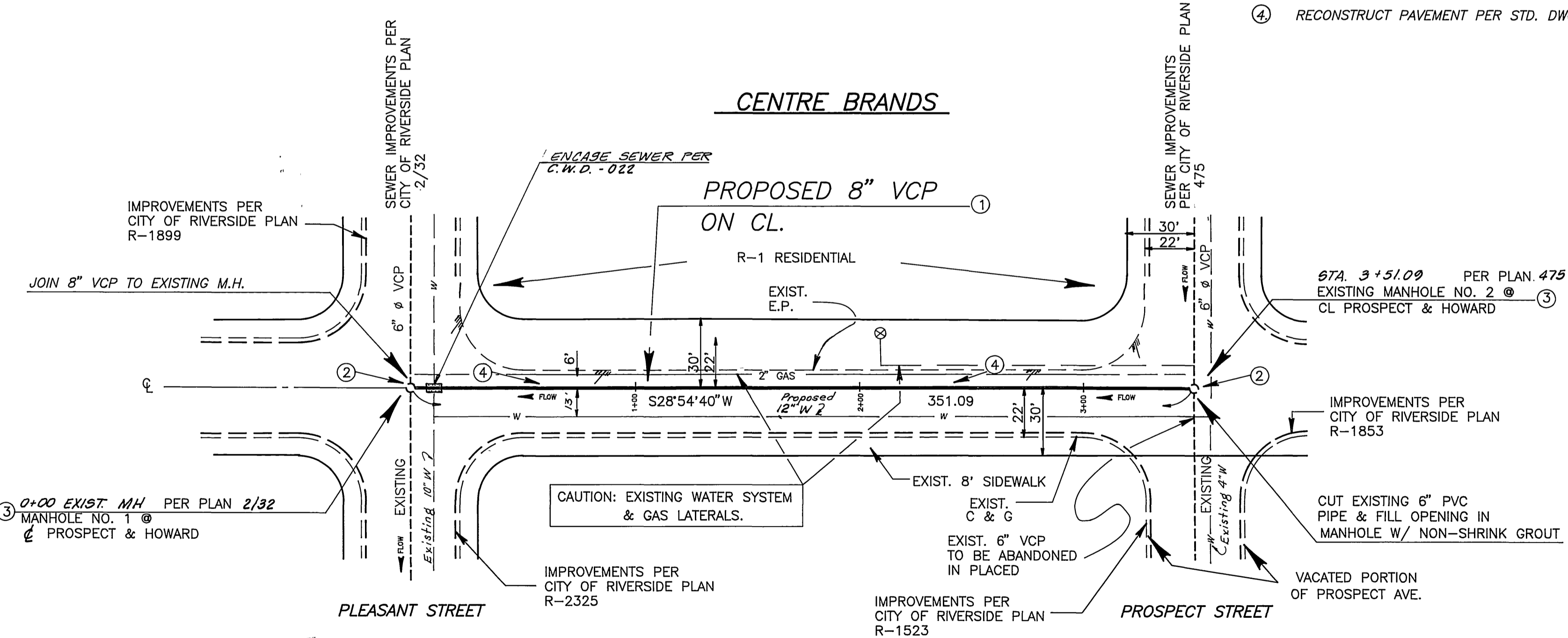

**HOWARD AVENUE**

CITY OF RIVERSIDE WATER SYSTEM  
 APPROVED BY: *Richard L. Dinkel* DATE: 4-28-89  
 BENCH MARK: ELEV. 889.435  
 SPIKE AND LEAD IN CURB, 1.5' NE OF THE NE CURB RET. OF PROSPECT AVE. AT PARK AVE.

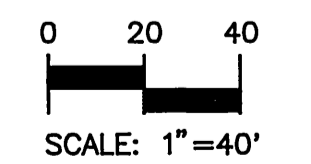

**UNDERGROUND SERVICE ALERT**  
 CALL: TOLL FREE 1-800-422-4133  
 TWO WORKING DAYS BEFORE YOU DIG

**PRIVATE ENGINEERING NOTE**  
 CONSTRUCTION CONTRACTOR AGREES THAT IN ACCORDANCE WITH GENERALLY ACCEPTED CONSTRUCTION PRACTICES CONSTRUCTION CONTRACTOR WILL BE REQUIRED TO ASSUME SOLE AND COMPLETE RESPONSIBILITY FOR JOB SITE CONDITIONS DURING THE COURSE OF CONSTRUCTION OF THE PROJECT, INCLUDING SAFETY OF ALL PERSONS AND PROPERTY THAT THIS REQUIREMENT SHALL BE MADE TO APPLY CONTINUOUSLY AND NOT BE LIMITED TO NORMAL WORKING HOURS, AND CONSTRUCTION CONTRACTOR FURTHER AGREES TO DEFEND, INDEMNIFY AND HOLD DESIGN PROFESSIONAL HARMLESS FROM ANY AND ALL LIABILITY, REAL OR ALLEGED, IN CONNECTION WITH THE PERFORMANCE OF WORK ON THIS PROJECT, EXCEPTING LIABILITY ARISING FROM THE SOLE NEGLIGENCE OF DESIGN PROFESSIONAL.

APPROVED: *Patrick M. Wallace* DATE: April 16, 1989  
 REGISTERED CIVIL ENGINEER NO. 27366 EXP. MARCH 31, 1993

DEPARTMENT OF PUBLIC WORKS  
 CITY OF RIVERSIDE, CALIFORNIA  
 APPROVED BY: *Richard L. Dinkel* DATE: 4/28/89  
 CIVIL

PREPARED BY:  
 Community Engineering Services, Inc.  
 5225 CANYON CREST DRIVE  
 BLDG. 200, SUITE 252  
 RIVERSIDE, CA. 92507  
 (714) 781-0850

**SEWER IMPROVEMENT PLAN**  
 HOWARD AVENUE SEWER  
 BETWEEN  
 PLEASANT ST. AND PROSPECT AVE.  
 FOR BUILDING PERMIT AT 3038 PLEASANT

ACCOUNT NO. S-1545  
 SHEET 1 of 1

INDEXED 5-18-89