

PROFILE SCALES
 HORIZ. : 1" = 20'
 VERT. : 1" = 8'

GENERAL NOTES

- CONSTRUCTION SHALL BE IN ACCORDANCE WITH THE CITY OF RIVERSIDE DEPARTMENT OF PUBLIC WORKS, STANDARD DRAWINGS, STANDARD DRAWING NO. 10 AND THE STANDARD SPECIFICATIONS FOR PUBLIC WORKS CONSTRUCTION, CURRENT EDITION.
- THE PRIVATE ENGINEER SIGNING THESE PLANS IS RESPONSIBLE FOR ASSURING THE ACCURACY AND ACCEPTABILITY OF THE WORK HEREON. IN THE EVENT OF DISCREPANCIES ARISING DURING CONSTRUCTION, THE PRIVATE ENGINEER SHALL BE RESPONSIBLE FOR DETERMINING AN ACCEPTABLE SOLUTION AND REVISING THE PLANS FOR APPROVAL BY THE CITY.
- QUANTITIES SHOWN ARE FOR INFORMATION ONLY AND THE CITY OF RIVERSIDE IS NOT RESPONSIBLE FOR THEIR ACCURACY.
- NO NOTE.
- ALL FLAGGED ELEVATIONS SHALL BE STAKED IN THE FIELD BY THE PRIVATE ENGINEER.
- THE CONTRACTOR SHALL CALL IN A LOCATION REQUEST TO UNDERGROUND SERVICE ALERT (USA), PHONE NO. 1-800-422-9133, TWO WORKING DAYS BEFORE DIGGING. NO CONSTRUCTION PERMIT WILL BE ISSUED BY THE PUBLIC WORKS DEPARTMENT INVOLVING EXCAVATION FOR UNDERGROUND FACILITIES UNLESS THE APPLICANT HAS BEEN PROVIDED AN INQUIRY IDENTIFICATION NUMBER BY USA.
- CONTRACTOR IS TO VERIFY EXISTING SEWER ELEVATION PRIOR TO CONSTRUCTION.
- LOCATION OF LATERALS TO BE DETERMINED IN THE FIELD AT THE DIRECTION OF THE OWNER AVOID CONFLICT WITH PROPOSED AND/OR EXISTING FACILITIES.
- NO FINISH FLOOR ELEVATION SHALL BE LESS THAN 4' ABOVE THE SEWER FLOW LINE AT POINT OF CONNECTION WITHOUT HAVING A PROPER BACKWATER VALVE INSTALLED IN THE LATERAL.
- A PLUG SHALL BE INSTALLED AND WILL REMAIN IN PLACE WHERE THE NEW SEWER CONNECTS WITH THE EXISTING SEWER UNTIL THE NEW SEWER IS ACCEPTED BY THE CITY.
- THE SEWER CONTRACTOR SHALL ADJUST MANHOLES TO FINAL GRADE AFTER PAVING IS COMPLETED.
- IT SHALL BE THE RESPONSIBILITY OF THE CONTRACTOR TO CLEAR THE RIGHT OF WAY IN ACCORDANCE WITH THE PROVISIONS OF LAW AS IT AFFECTS EACH UTILITY INCLUDING IRRIGATION LINES AND APPURTENANCES AT NO COST TO THE CITY.

CONSTRUCTION NOTES AND QUANTITY ESTIMATE

- ① CONSTRUCT 8" V.C.P. SEWER MAIN. 208 L.F.
- ② CONSTRUCT PRECAST CONCRETE SEWER MANHOLE PER STD. DRWG. 502. 3 EA.
- ③ CONSTRUCT 4" SEWER LATERAL PER STD. DRWG. 562. 340 L.F.

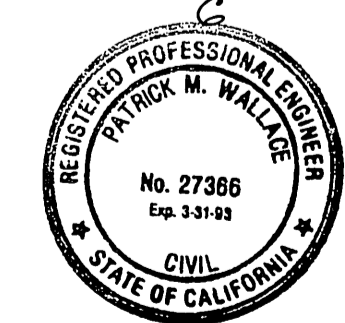
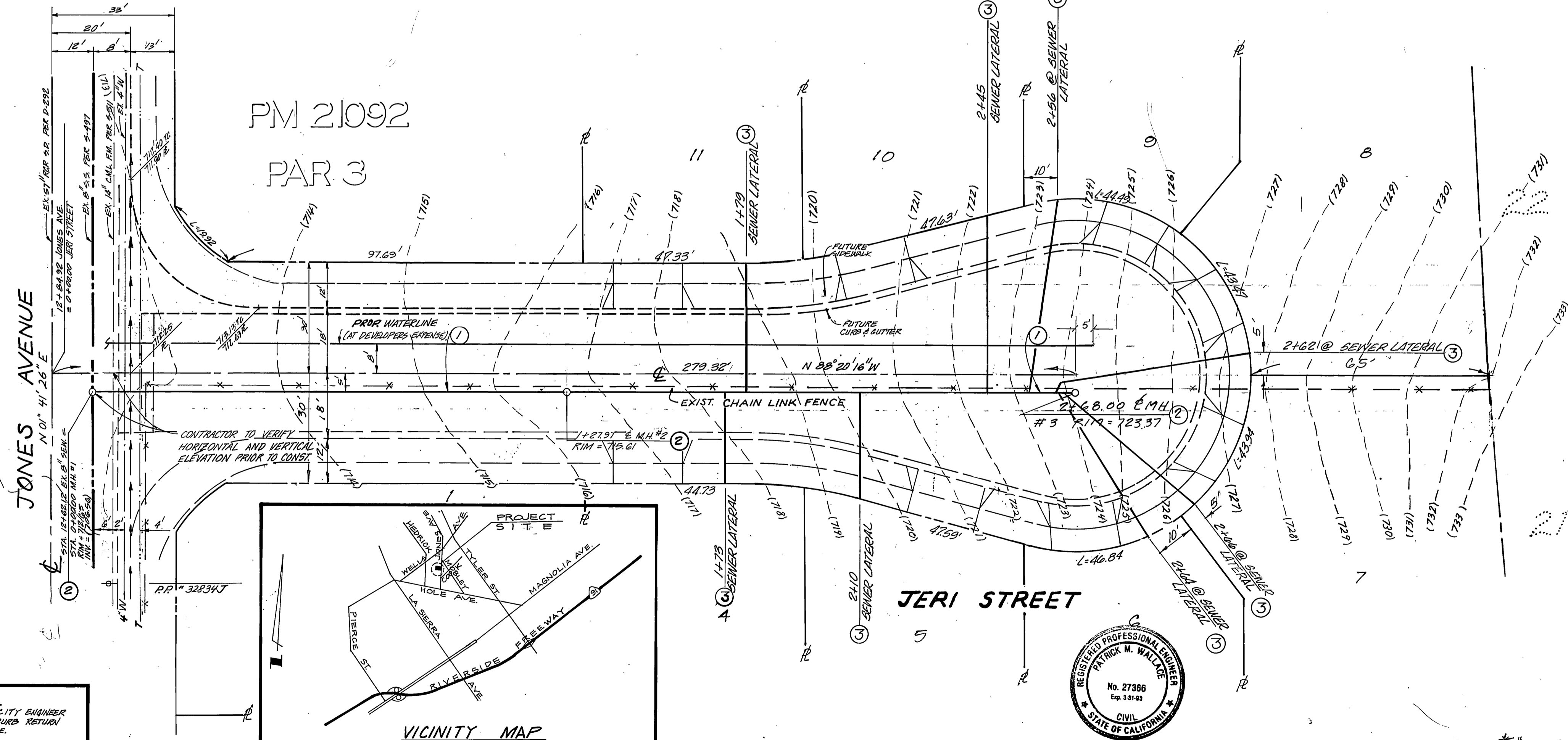

*"CONSTRUCTION RECORD DRAWING" PER COMMUNITY ENGINEERING SERVICES INC. B.E. 1/13/92

BENCH MARK
 P.M. = FE-L PK NAIL AND CITY ENGINEER TAG IN CENTER OF 3/4" CURB RETURN OF 4536 AVE. AT JONES AVE. ELEV. = 723.92'

PACIFIC TEL. CO.	CITY OF RIVERSIDE WATER SYSTEM	50 CALIFORNIA GAS CO.	CITY OF RIVERSIDE ELECTRICAL	COMMUNITY ENGINEERING SERVICES INC. 3225 CANYON CREST DRIVE BLDG. 200 SUITE 252 RIVERSIDE, CA. 92507 (714) 781-0950	CITY OF RIVERSIDE PUBLIC WORKS DEPARTMENT		SEWER IMPROVEMENT PLAN & PROFILE FOR JERI STREET TRACT 23932	ACCOUNT NO. 5-1555
DATE: 5-22-89	APPROVED: Richard L. Dulak 7-17-89	DATE: 7-24-89	DATE: 7/29/89	DATE: 5-5-89	APPROVED BY: [Signature]	DATE: 9/29/89	DATE: 9/29/89	SHEET 1 OF 1
				DESIGNED BY: J.R.W.	DRAWN BY: J.P.L.	CHECKED BY: J.E.M.	HORIZ. SCALE: 1" = 20'	VERT. SCALE: 1" = 8'
								INDEXED 5-9-90 4-11