

PROPERTY OF
CITY OF RIVERSIDE
DEPT. OF PUBLIC WORKS
ENGINEERING DIVISION

PROPERTY OF
CITY OF RIVERSIDE
DEPT. OF PUBLIC WORKS
ENGINEERING DIVISION

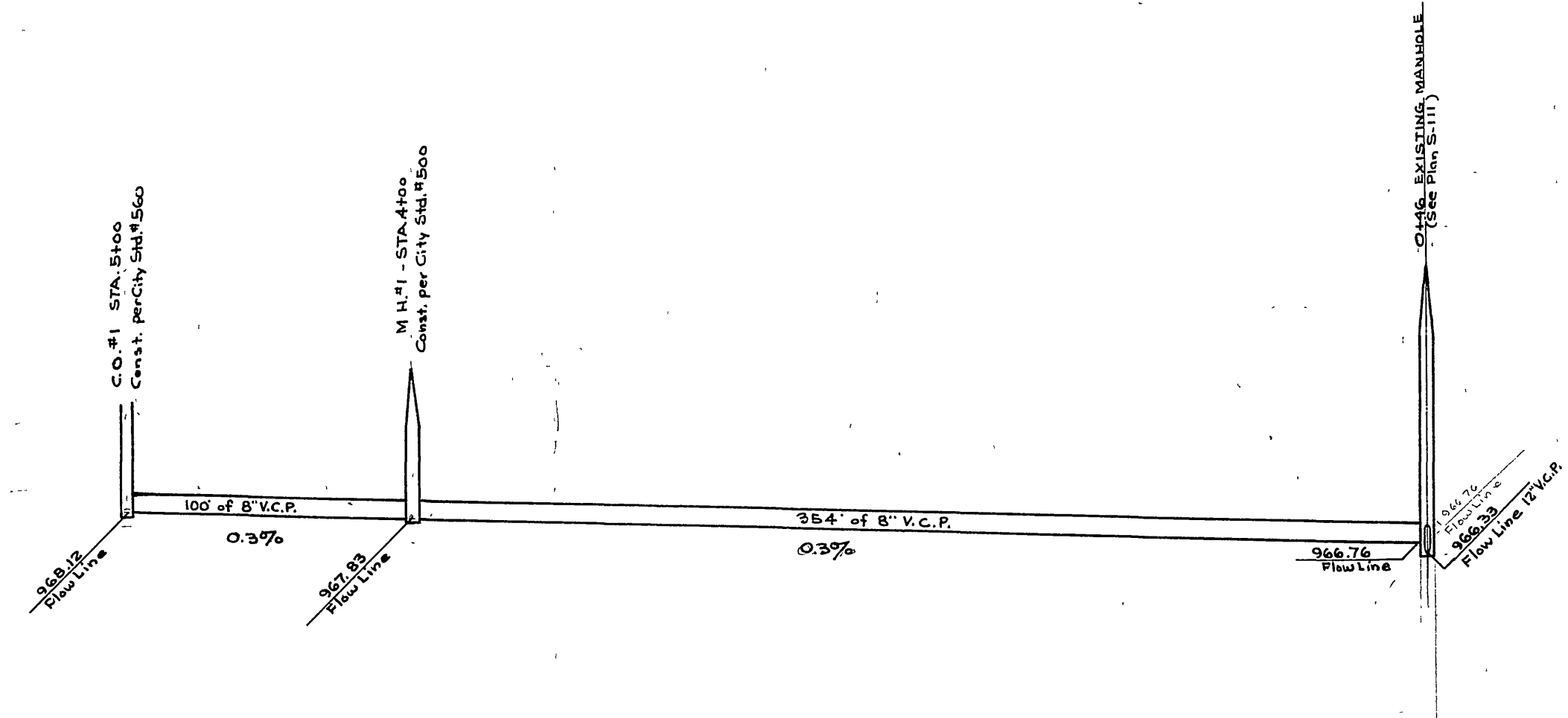

66

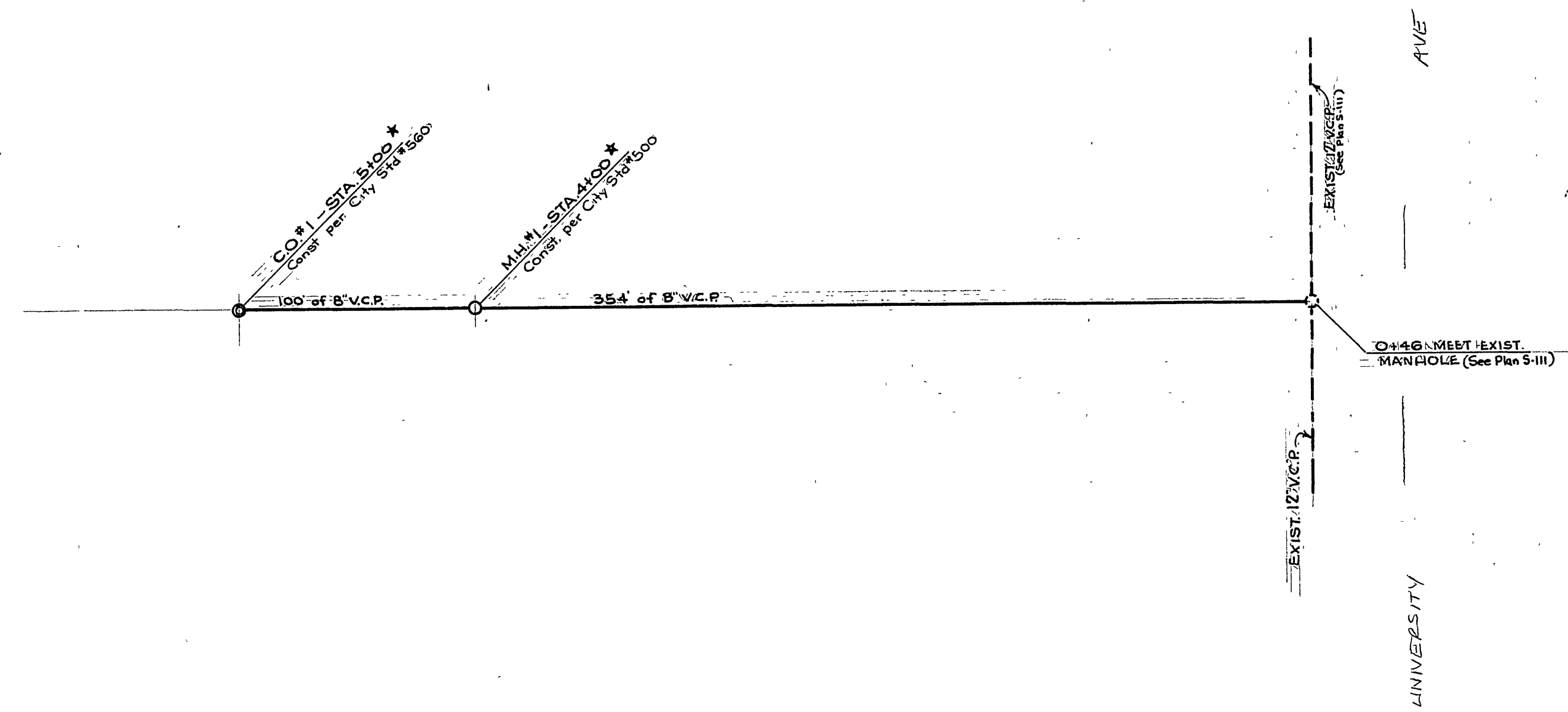

PROPERTY OF
CITY OF RIVERSIDE
DEPT. OF PUBLIC WORKS
ENGINEERING DIVISION

Plan No R-181 used for Base Map.

* 5-11-59 "As Built" H. Ball

CRANFORD AVENUE
SANITARY SEWER

UNIVERSITY AVE

PROPERTY OF
CITY OF RIVERSIDE
DEPT. OF PUBLIC WORKS
ENGINEERING DIVISION

Francis J. Tojiba

DMartinez
12/30/58

S-157

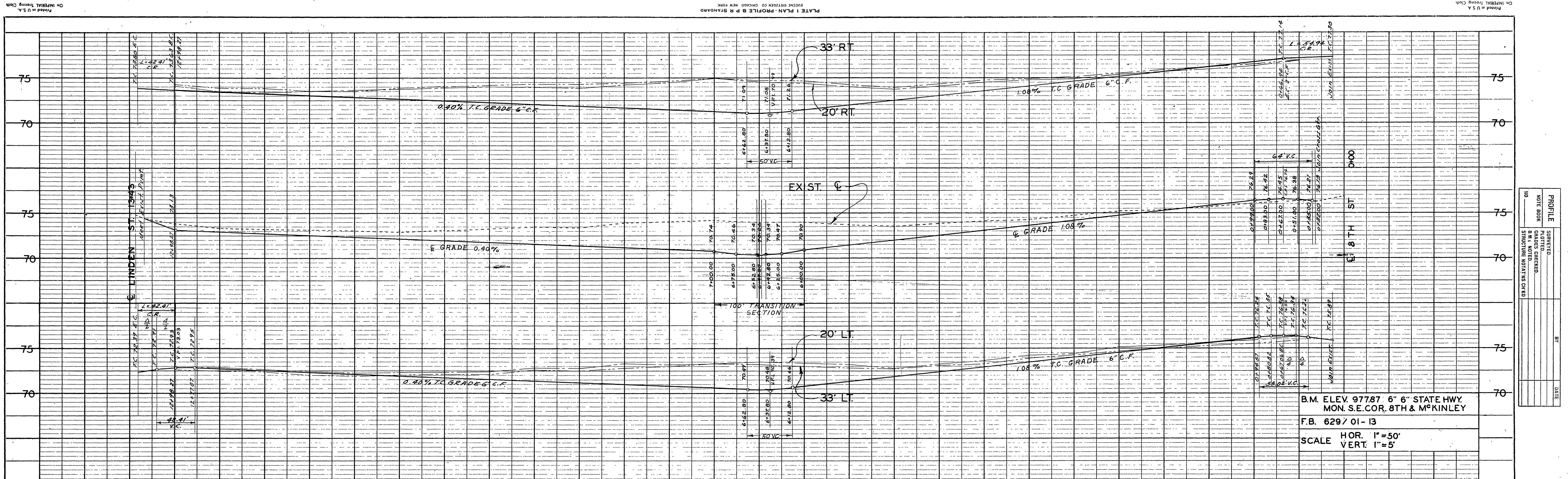

B.M. ELEV. 97787 6\"/>

F.B. 629/01-13

SCALE HOR. 1\"/>

PROFILE	DATE
SUBMITTED	
DESIGNED	
CHECKED	
BY	

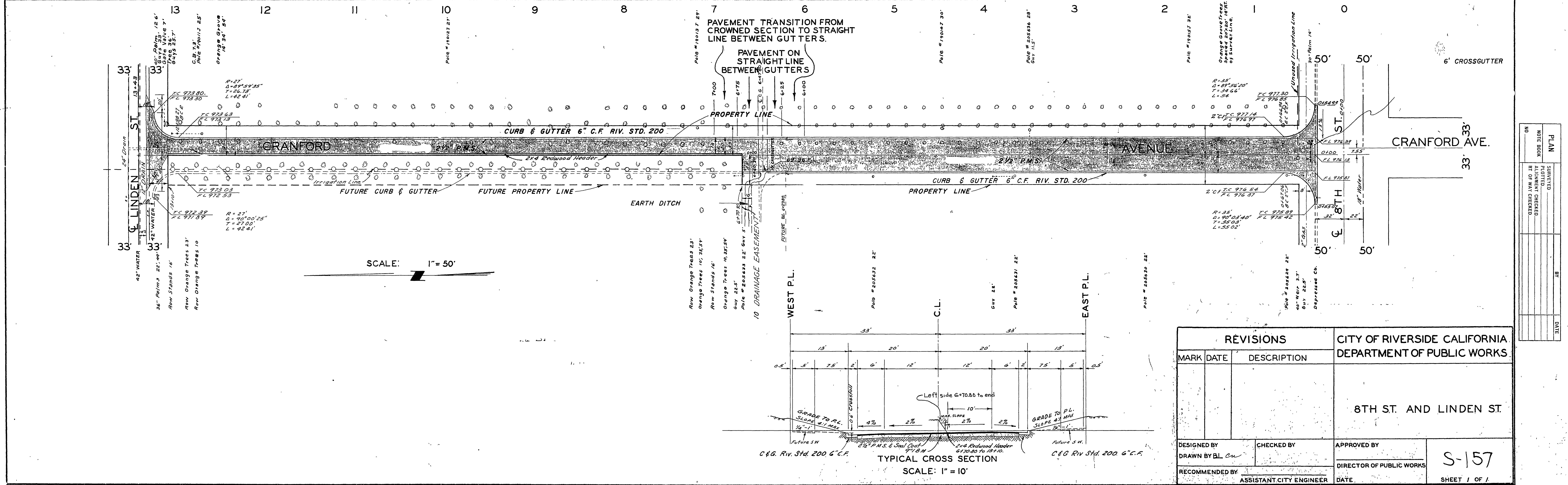

SCALE: 1\"/>

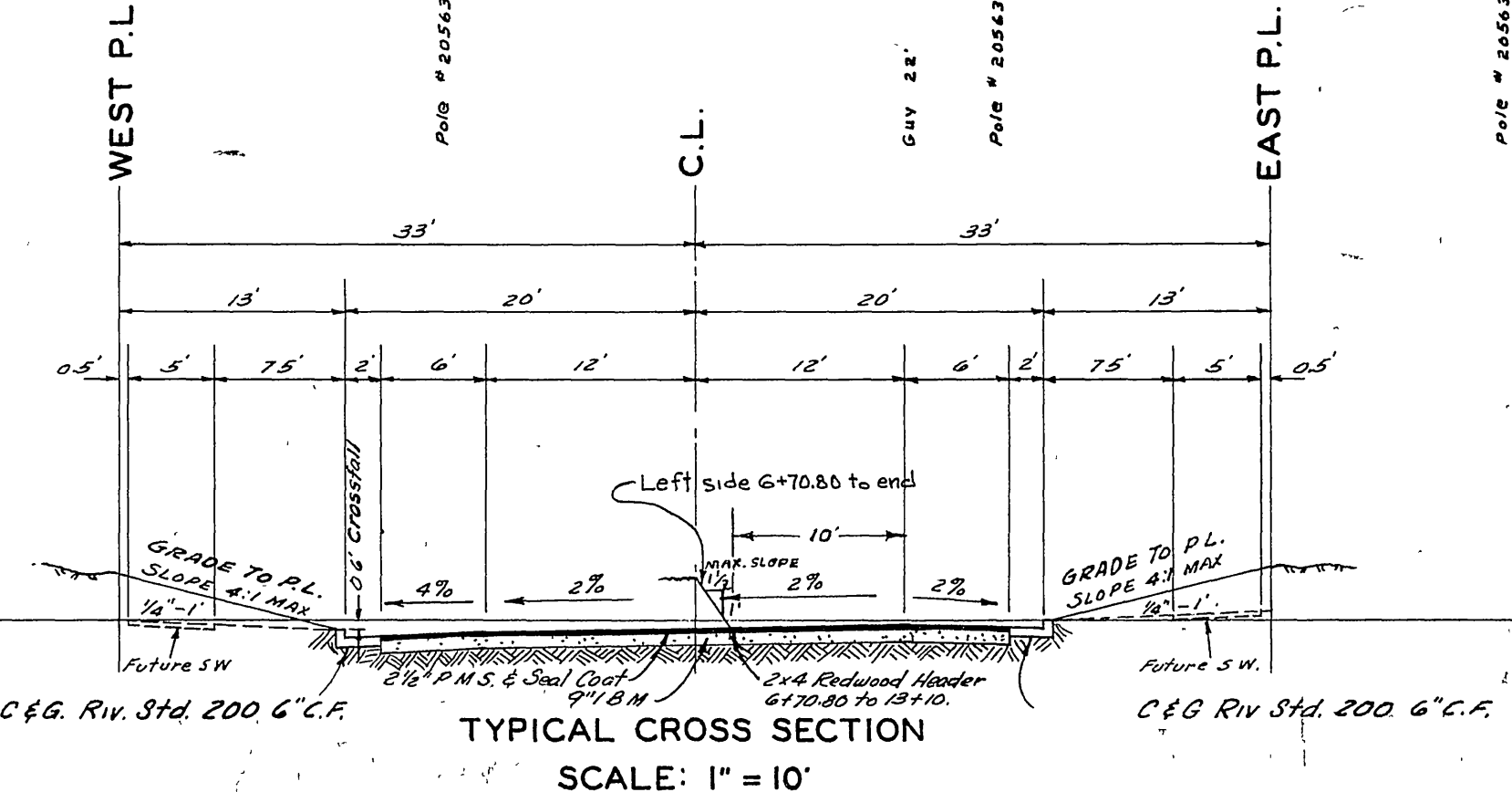

TYPICAL CROSS SECTION
SCALE: 1\"/>

REVISIONS		CITY OF RIVERSIDE CALIFORNIA DEPARTMENT OF PUBLIC WORKS
MARK	DATE	

DESIGNED BY	CHECKED BY	APPROVED BY
DRAWN BY <i>BL</i>		DIRECTOR OF PUBLIC WORKS
RECOMMENDED BY	ASSISTANT CITY ENGINEER	DATE

PLAN	DATE
SUBMITTED	
DESIGNED	
CHECKED	
BY	

S-157

SHEET 1 OF 1