

PROFILE	DESIGNED BY	REC	DATE	5-5-59
	CHECKED BY	REC		
NOTE BOOK	NO. 7117			
	SIGNED (NAME AND TITLE)			

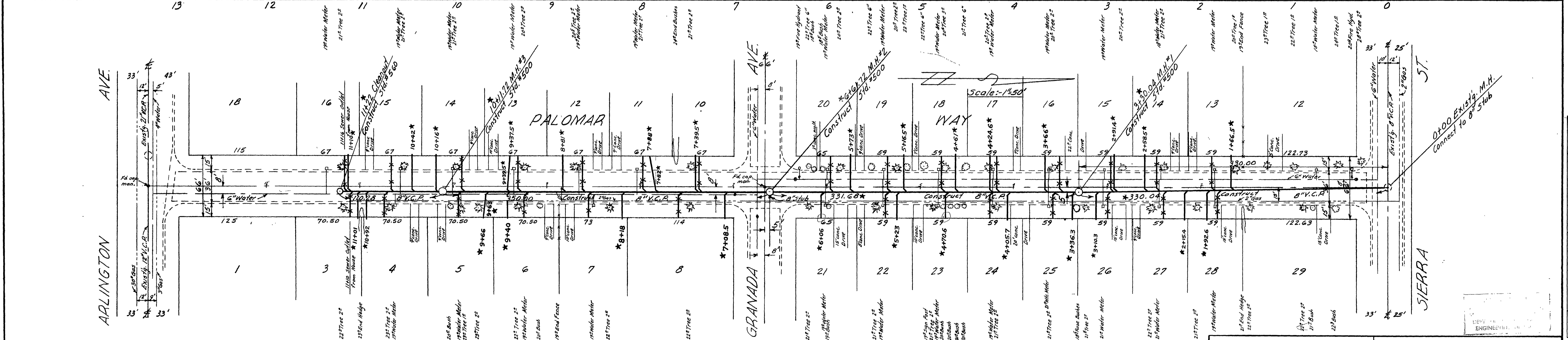

PLAN	DESIGNED BY	REC	DATE	5-5-59
	CHECKED BY	REC		
NOTE BOOK	NO. 7117			
	SIGNED (NAME AND TITLE)			

GENERAL NOTES
 House Connection Wyes shall be field located.
 Construction shall be in accordance with Specifications of the City of Riverside, Department of Public Works.

BENCH MARKS
 Spike and Lead in South East curb return 39' East of E Barcelona Way on Sierra St. Elev. 785.29, F.B. 1911A 1/64.
 Spike and Lead in North East curb return Arlington & Palomar Way. Elev. 797.78, F.B. 1911A 1/64.

QUANTITY ESTIMATE
 8" Vitrified Clay Pipe 1,122 lin. ft.
 4" Vitrified Clay Pipe 962 lin. ft.
 8"x4" Wyes 29
 Std. #500 Manholes 3
 Std. #500 Cleanout 1

REVISIONS			CITY OF RIVERSIDE CALIFORNIA DEPARTMENT OF PUBLIC WORKS	
MARK	DATE	DESCRIPTION		
*	9-25-59	As Built, N.B. 11		

DESIGNED BY	REC	CHECKED BY	Ernest N. Webb	APPROVED BY	[Signature]
DRAWN BY	REC	DATE	5-5-59	DIRECTOR OF PUBLIC WORKS	
RECOMMENDED BY	[Signature]	ASSISTANT CITY ENGINEER	DATE	March 13, 1959	

PALOMAR WAY SANITARY SEWER DISTRICT	
5-165	SHEET 1 OF 1

