

NOTES:

1. It Shall Be The Responsibility Of The Contractor To Clear The Right Of Way In Accordance With The Provisions Of The Law As It Affects Each Utility Including Irrigation Lines And Appurtenances And At No Cost To The City
2. Contractor Must Uncover Exist Sewer @ Clean Out & Have City Crews Take Elev. At End Of Pipe Before Cut Sheet Can Be Issued

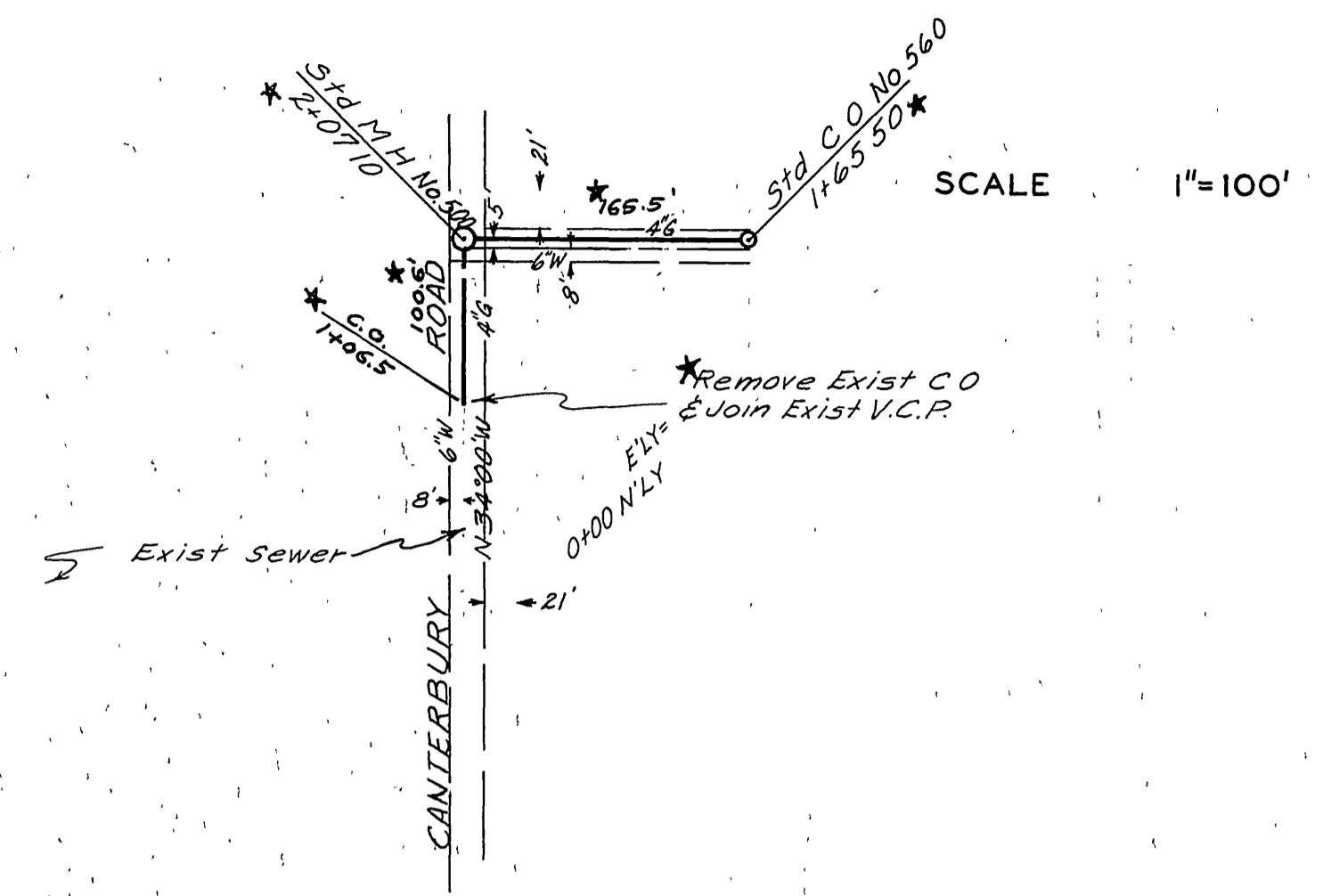

N 56°00' E

B.M. 764.36 S & L IN S. CB. VERBENA DR.  
AT F.H. 20' E. OF E. CB. ON ADAMS

F.B. 669/13

SCALE: 1"=100' HORIZ.  
1"=5' VERT.

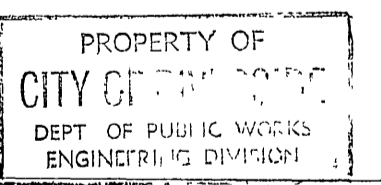
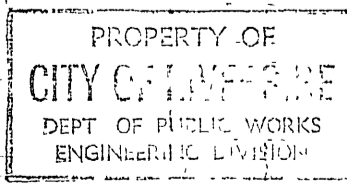
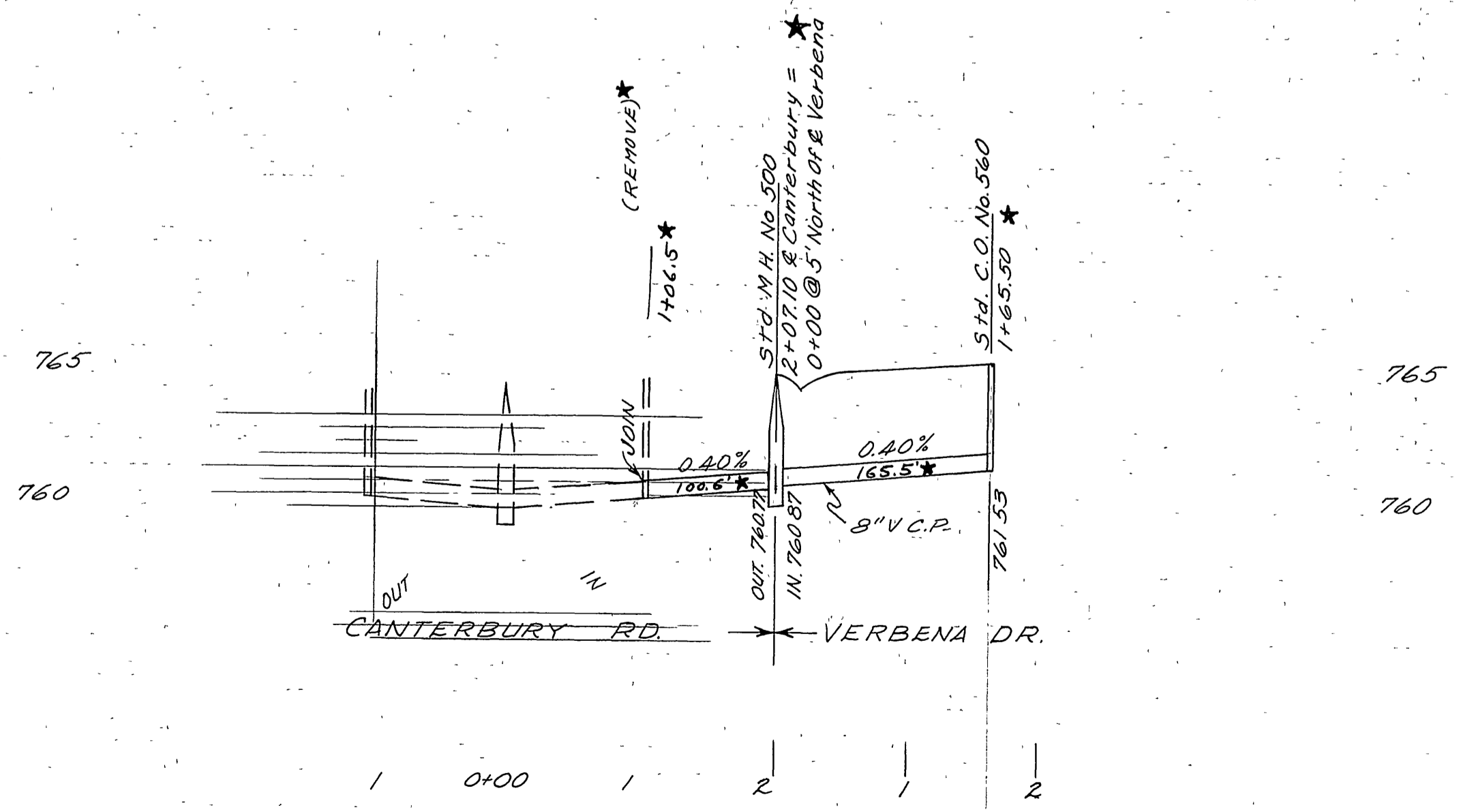

VERBENA SEWER  
FOR SERVICE TO  
WESLEY METHODIST CHURCH

L.P.

wals

James J. Tappan

June 15, 1959

S-175

